

Typical application

WCSF is a special purpose, nuclear grade, thick wall tubing which may be supplied with or without nuclear adhesive coating. It is used for splicing cables, sealing and corrosion protection, mechanical protection, or uncoated as a body shim. It may also be used as a component in several nuclear grade kits.

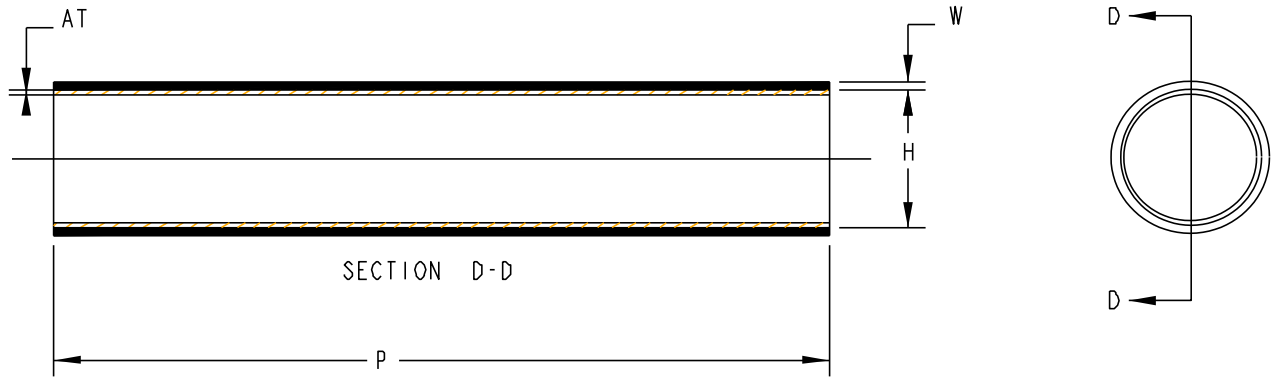

PRODUCT SIZE

DIMENSIONS

	H		W		AT*		P
	a min	b max	a nom	b min	a min	b min	
WCSF-050 (3/1)	0.13	0.050	0.02	0.035	-	0.006	STANDARD CUT LENGTHS SUPPLIED SUBJECT TO STANDARD CUTTING TOLERANCES.
WCSF-070 (6/2)	0.25	0.070	0.02	0.075	0.002	-	
WCSF-115 (9/3)	0.35	0.115	0.03	0.085	0.004	-	
WCSF-200 (18/5)	0.70	0.20	0.03	0.10	0.004	-	
WCSF-300 (28/8)	1.1	0.30	0.04	0.15	0.005	-	
WCSF-500 (38/13)	1.5	0.50	0.05	0.17	0.005	-	
WCSF-650 (50/17)	2.0	0.65	0.05	0.17	0.005	-	
WCSF-1000 (76/26)	3.0	1.0	0.05	0.17	0.005	-	
WCSF-1500 (114/38)	4.5	1.5	0.05	0.17	0.005	-	
WCSF-2500 (177/63)	7.0	2.5	0.05	0.17	0.005	-	

PRODUCT SIZE DIMENSIONS-METRIC

WCSF-050 (3/1)	(3.30)	(1.27)	(0.51)	(0.89)	-	(0.15)	STANDARD CUT LENGTHS SUPPLIED SUBJECT TO STANDARD CUTTING TOLERANCES.
WCSF-070 (6/2)	(6.35)	(1.78)	(0.51)	(1.91)	(0.05)	-	
WCSF-115 (9/3)	(9.00)	(2.92)	(0.76)	(2.16)	(0.10)	-	
WCSF-200 (18/5)	(18.0)	(5.08)	(0.76)	(2.54)	(0.10)	-	
WCSF-300 (28/8)	(28.0)	(7.6)	(1.0)	(3.8)	(0.13)	-	
WCSF-500 (38/13)	(38.1)	(12.7)	(1.3)	(4.3)	(0.13)	-	
WCSF-650 (50/17)	(50.8)	(16.5)	(1.3)	(4.3)	(0.13)	-	
WCSF-1000 (76/26)	(76.2)	(25.4)	(1.3)	(4.3)	(0.13)	-	
WCSF-1500 (114/38)	(114.3)	(38.1)	(1.3)	(4.3)	(0.13)	-	
WCSF-2500 (177/63)	(177.8)	(63.5)	(1.3)	(4.3)	(0.13)	-	

Notes:

1. Dimensions in inches (millimeters). a=as supplied, b=after free recovery
 2. Free recovery: unrestricted recovery after 15 minutes at 150 degrees C.
 3. Longitudinal change after free recovery all sizes: - 10% max.
 4. Material properties as described in PPS-3010/7 (RT 1508/1).
 5. Coating: "-S": (S1119) Adhesive, properties as described in PPS-3012/19 (RT1050/15). "-U": UNCOATED
 6. H dimension does not include adhesive thickness.
- * Applicable for "-N" coated tubing only.