

THIS DRAWING IS UNPUBLISHED. RELEASED FOR PUBLICATION
 © COPYRIGHT - By - ALL RIGHTS RESERVED.

LOC		DIST		REVISIONS			
P	LTR	DESCRIPTION		DATE	DWN	APVD	
-	-	A	RELEASED	10-2-12	CT	MS	

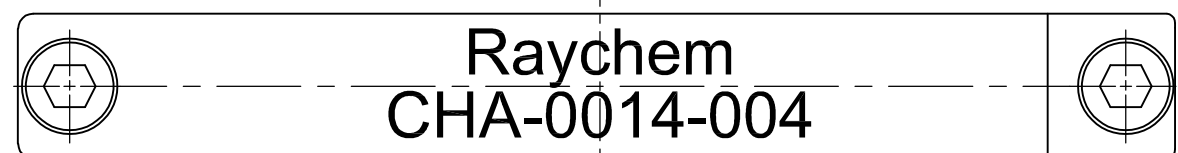
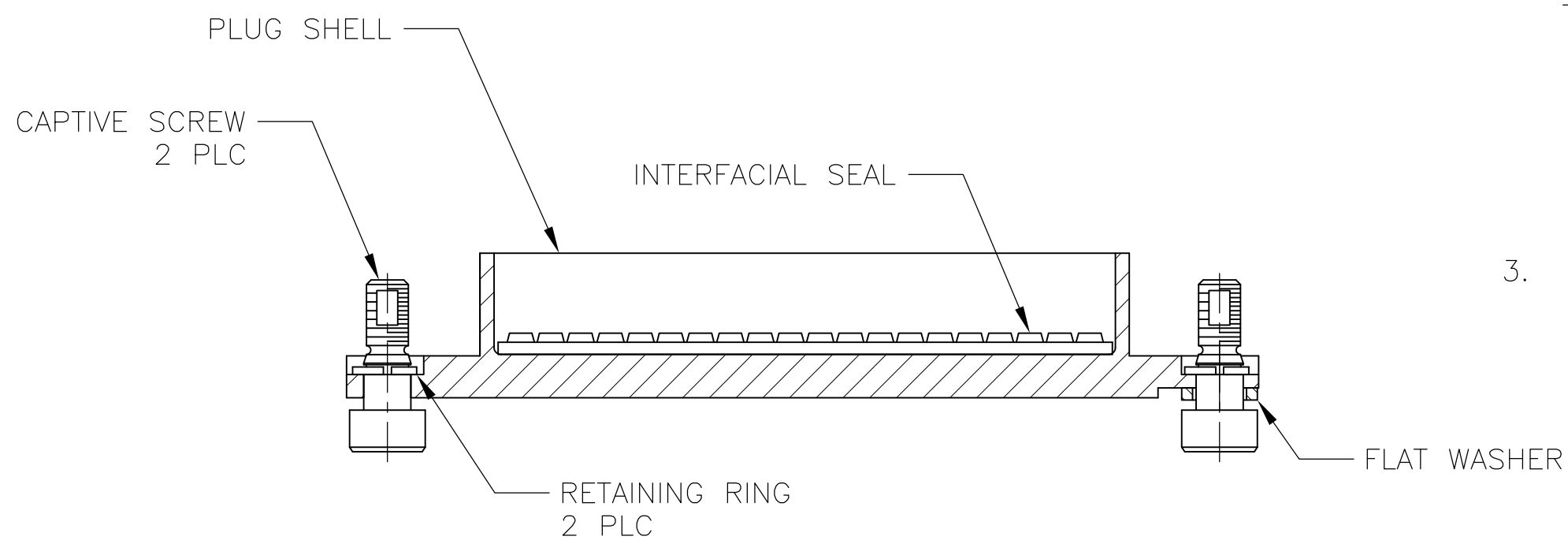
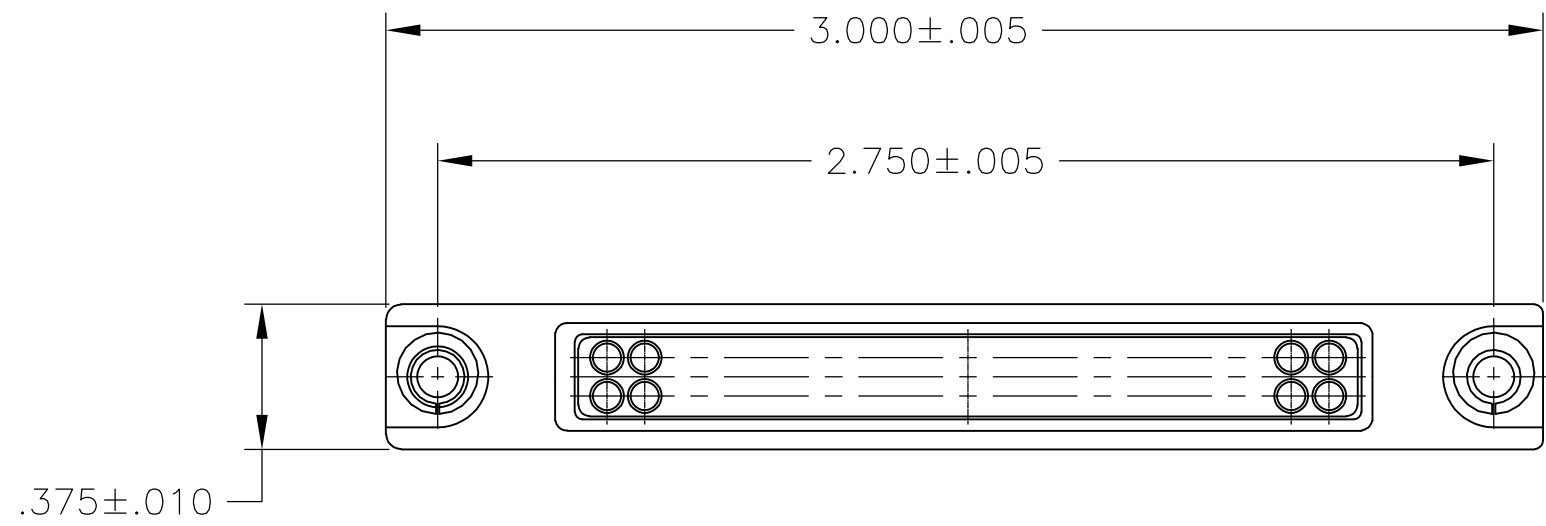

- PROTECTIVE CAP PLUG WITH PIN INSERT, MTC100 SERIES 2 INCH, DESIGNED TO ENVIRONMENTALLY SEAL THE MATING RECEPTACLE SHELL WITH SOCKET INSERT.
- PLUG SHELL:
 MATERIAL: ALUMINUM ALLOY PER ASTM B 211.
 FINISH: CADMIUM PLATED PER SAE-AMS-QQ-P-416 OVER NICKEL UNDER-PLATE.

INTERFACIAL SEAL:
 MATERIAL: FLUOROSILICONE ELASTOMER

CAPTIVE SCREW:
 MATERIAL: STAINLESS STEEL PER ASTM A 240 (QQ-S-766).
 FINISH: CADMIUM PLATED PER SAE-AMS-QQ-P-416.

RETAINING RING:
 MATERIAL: COPPER ALLOY 172 PER ASTM B194
 FINISH: CADMIUM PLATED PER SAE-AMS-QQ-P-416.

FLAT WASHER:
 MATERIAL: STAINLESS STEEL PER ASTM A 240/A 240M
 FINISH: CADMIUM PLATED PER SAE-AMS-QQ-P-416.
- WEIGHT: .0337 LBS (15.3 GRAMS) REF.

CHA-0014-004
 PART NUMBER

THIS DRAWING IS A CONTROLLED DOCUMENT.		DWN C.C.THOMAS 10-2-12	TE Connectivity	
DIMENSIONS: INCHES		CHK M.SPICER 10-2-12	NAME PROTECTIVE CAP, PLUG WITH PIN INTERFACIAL SEAL, 2 INCH MTC 100 SERIES	
TOLERANCES UNLESS OTHERWISE SPECIFIED: 0 PLC ± - 1 PLC ± - 2 PLC ± - 3 PLC ± .015 4 PLC ± - ANGLES ± -		APVD M.SPICER 10-2-12	DRAWING NO A2 06090	
MATERIAL SEE NOTES		FINISH SEE NOTES	SCALE 2:1	SHEET 1 of 1
WEIGHT -		CUSTOMER DRAWING		RESTRICTED TO -
SCALE 2:1		SHEET 1 of 1		REV A