

REVISIONS				
P	LTN	DESCRIPTION	DATE	APVD
A11		REVISED PER ECO-20-004256	25MAR2020	JM DS
A12		REVISED PER PCN E-20-016603	24NOV2020	PN DS
B		REVISED PER ECR-23-167643	10MAR2023	DK CB
B1		REVISED PER ECR-24-216938	13SEP2024	DK CB

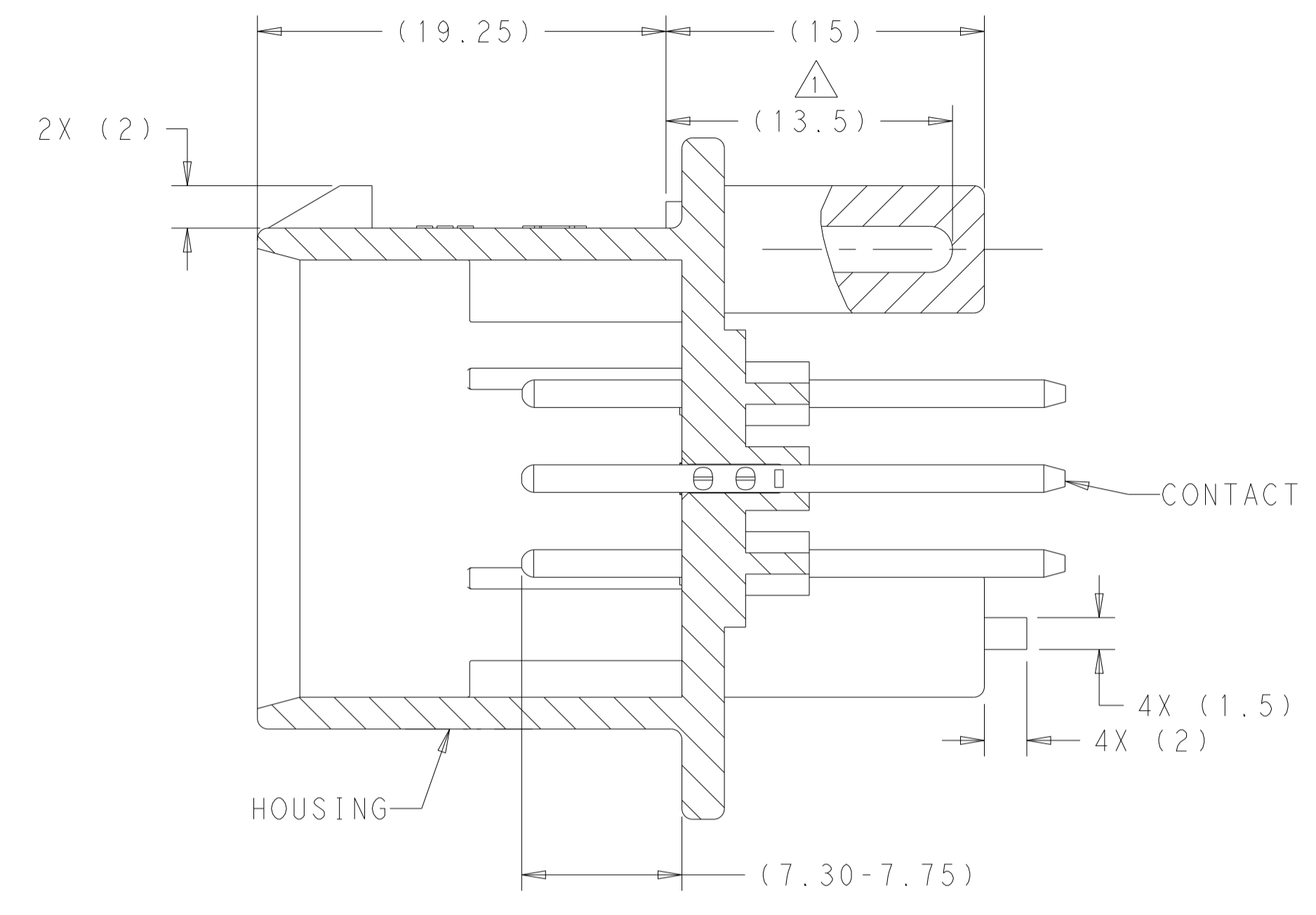

SECTION A-A

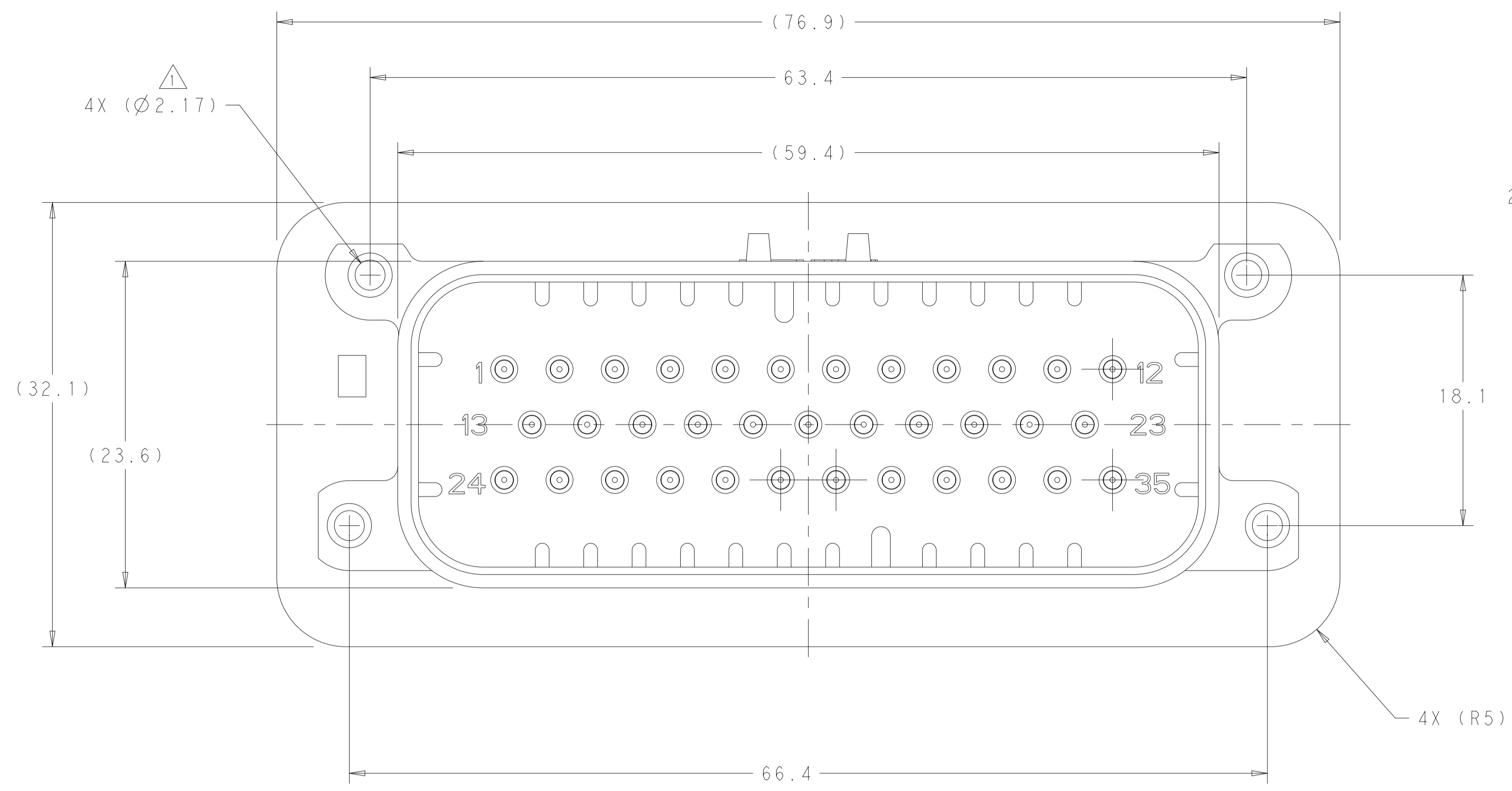
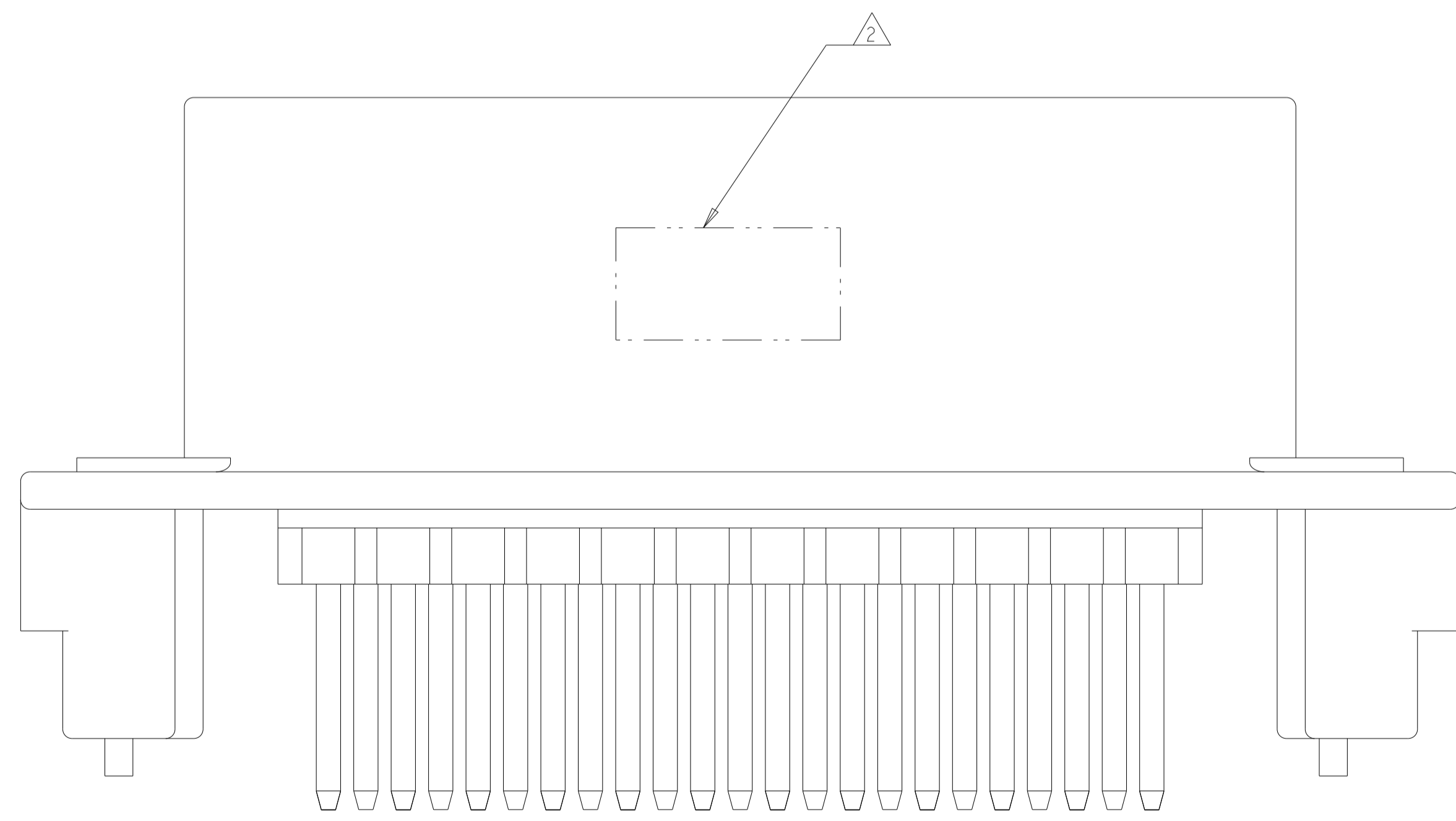

△ SUGGESTED MOUNTING SCREW SIZE IS Ø2.50mm [APPROX. 0.099 INCH] SELF TAPPING THREAD FORMING SCREW, SUCH AS DELTA PT, TO BE DRIVEN AT 0.6-0.8 N-m. THE CUSTOMER MUST TEST THE SCREW SIZE AND TYPE IN ORDER TO VERIFY THEIR SELECTION BEFORE USE IN APPLICATION

TO VALIDATE HEADER MOUNTING PERFORMANCE, TE CONNECTIVITY WILL CONTINUE TO UTILIZE THE FOLLOWING TORQUE VALIDATION PROCESS ACCORDING TO APPLICATION SPEC 114-16016:
 MOUNTING PANEL THICKNESS - 4.75 +/- 0.15mm
 SCREW - 2.5X12mm DELTA PT

CUSTOMERS MAY VALIDATE OTHER SCREW SIZES AND TYPES AT THEIR OWN DISCRETION

△ DATE CODE IN THIS LOCATION USING 5 DIGIT CODE
 FIRST 2 DIGITS = YEAR, SECOND 2 DIGITS = WEEK
 LAST DIGIT = DAY.

△ MATERIALS: HEADER HOUSING - GLASS FILLED PBT
 PINS - TIN OR GOLD PLATED BRASS

△ HOUSING COLORS ARE MECHANICALLY KEYPED TO MATE ONLY WITH IDENTICALLY COLORED PLUG ASSEMBLIES.

5. HEADER MATES TO PLUG ASSEMBLY 776164 WHICH USES REELED TERMINAL 770520 OR LOOSE PIECE TERMINAL 770854.

ORANGE	GOLD	1-776230-6
BLUE	GOLD	1-776230-5
GRAY	GOLD	1-776230-4
NATURAL	GOLD	1-776230-2
BLACK	GOLD	1-776230-1
BLUE	TIN	776230-5
GRAY	TIN	776230-4
NATURAL	TIN	776230-2
BLACK	TIN	776230-1
HEADER COLOR △	PLATING	PART NUMBER

776230-1 & 1-776230-1 SHOWN

THIS DRAWING IS A CONTROLLED DOCUMENT. DIMENSIONING AND TOLERANCING PER ASME Y14.5M-2009. TOLERANCES UNLESS OTHERWISE SPECIFIED:

mm	0 PLC	±
	1 PLC	±0.2
	2 PLC	±
	3 PLC	±
	4 PLC	±
	ANGLES	±
	FINISH	±

OWN: D. STRAUSSER 04FEB2010
 CHK: D. STRAUSSER 27MAR2010
 APVD: D. STRAUSSER 27APR2010
 NAME: D. STRAUSSER
 PRODUCT SPEC: 108-1329
 APPLICATION SPEC: 114-16016
 WEIGHT: 39.99g
 CUSTOMER DRAWING

SCALE: 4:1 SHEET 1 OF 2 REV: B1

TE Connectivity
 HEADER ASSEMBLY, 35 POSITION, VERTICAL, AMPSEAL

REVISIONS				
P	LTN	DESCRIPTION	DATE	APVD
-	-	SEE SHEET 1	-	-

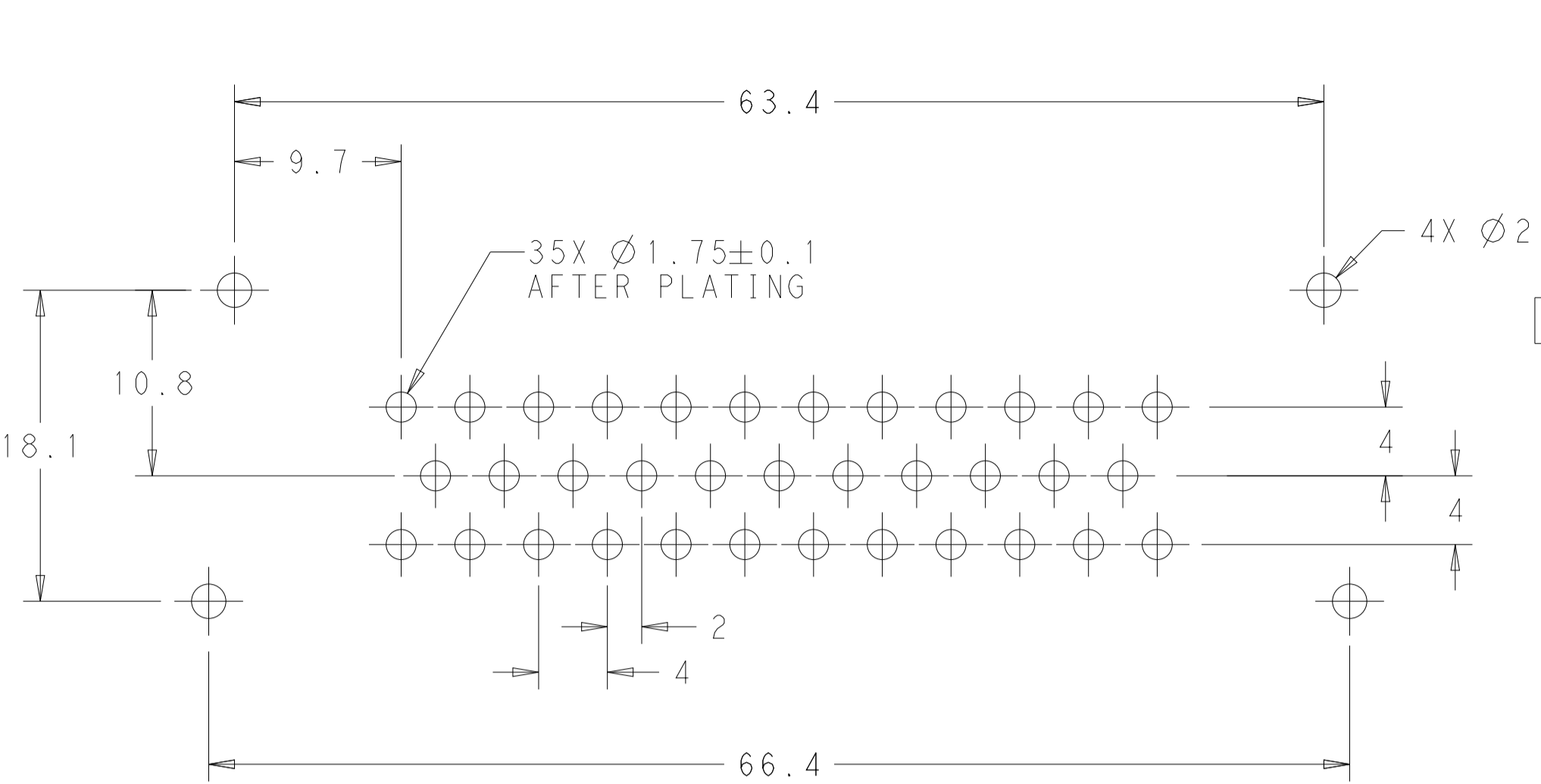

RECOMMENDED P.C. BOARD LAYOUT FOR 1.57 THICK P.C. BOARD

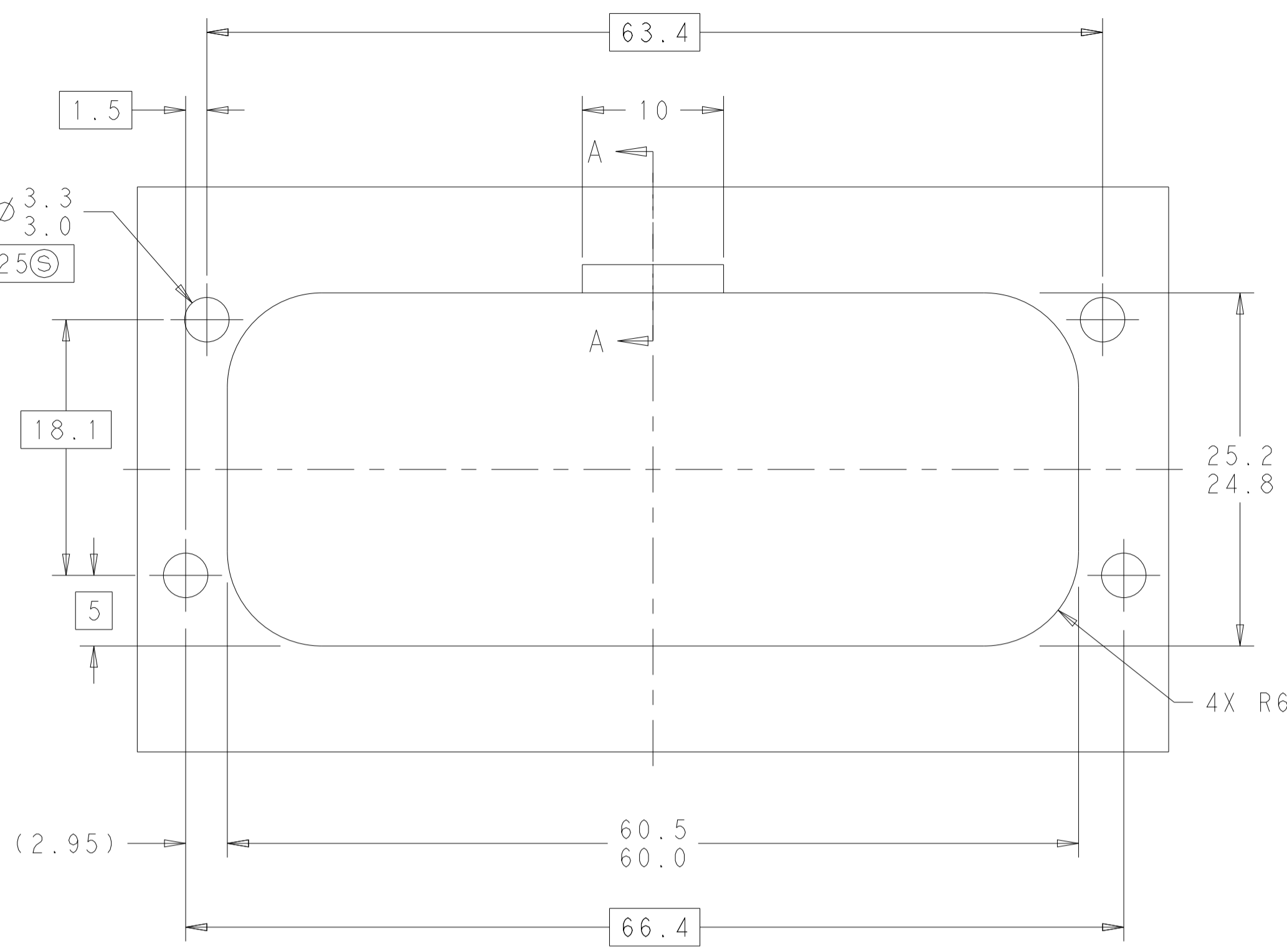

RECOMMENDED MOUNTING HOLE LAYOUT FOR 5.0 MAX THICK PANEL

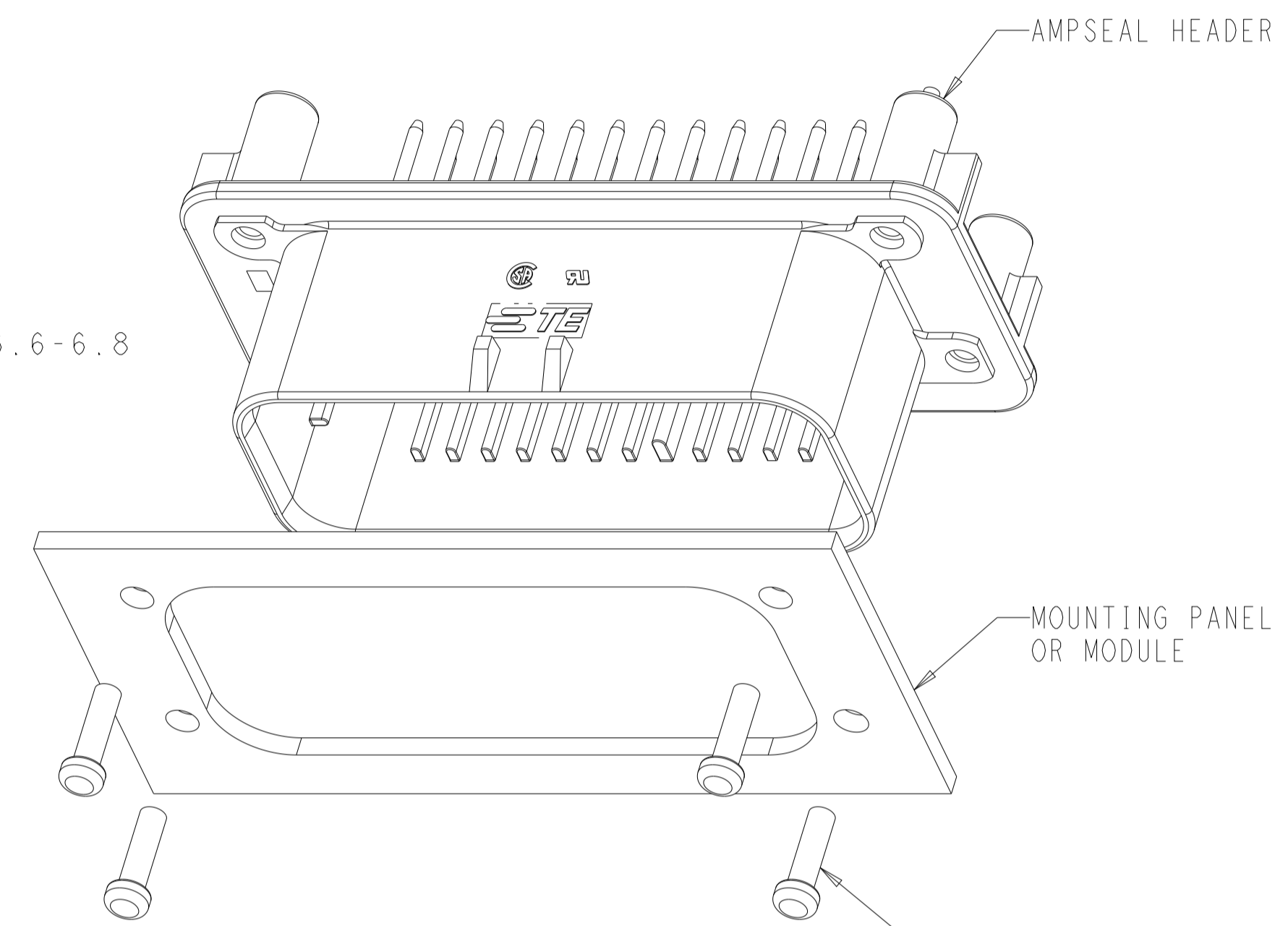

SCALE 2:1

MOUNTING SCREW (4)
TORQUE TO 0.6N-m TO 0.8N-m

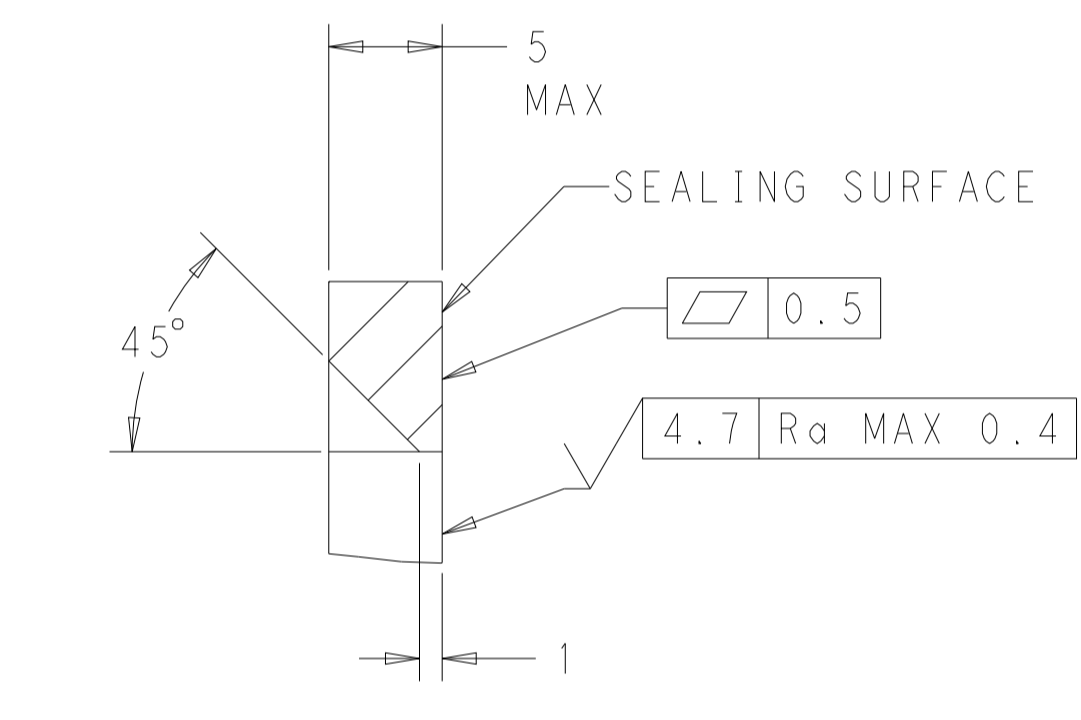
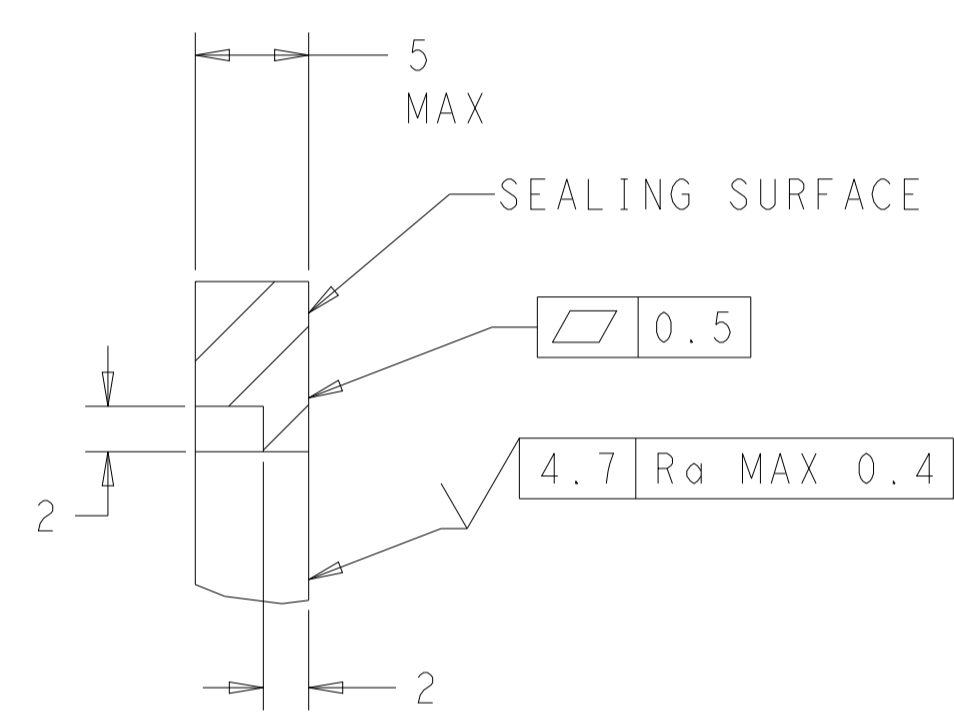

SECTION A-A
OPTIONAL CONSTRUCTION IF PANEL THICKNESS IS GREATER THAN 2.0

SECTION A-A
OPTIONAL CONSTRUCTION IF PANEL THICKNESS IS GREATER THAN 2.0

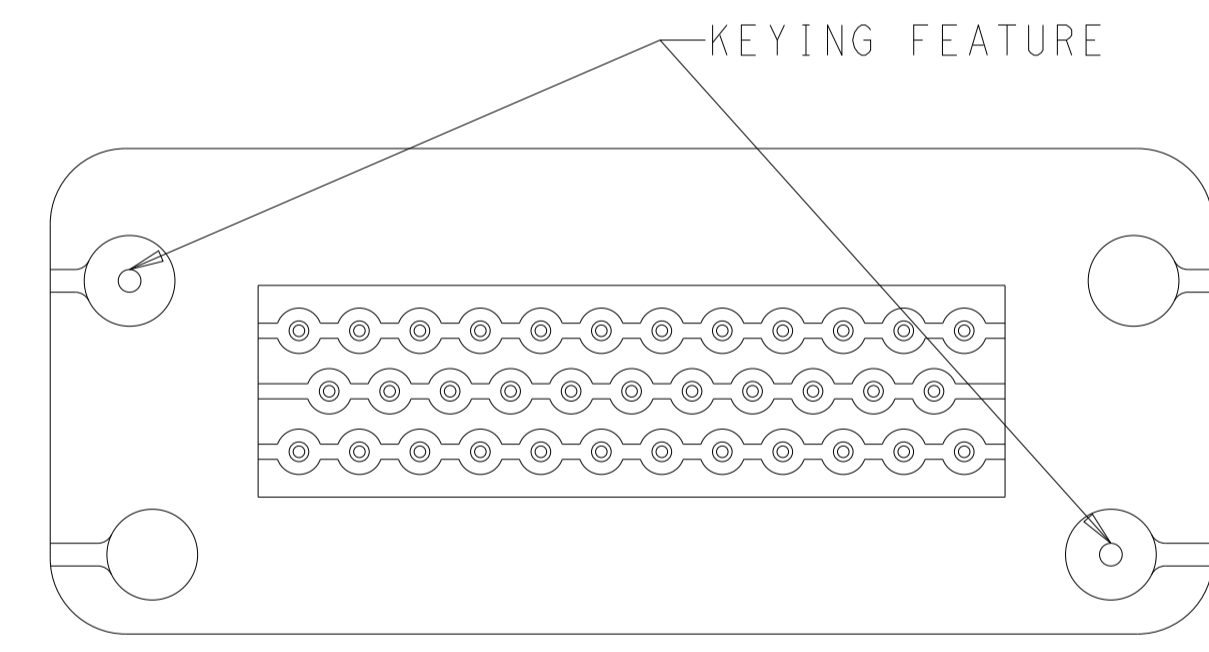

KEYING FOR 776230-1, 1-776230-1, 776230-4, 1-776230-4 AND 1-776230-6
SCALE 2:1

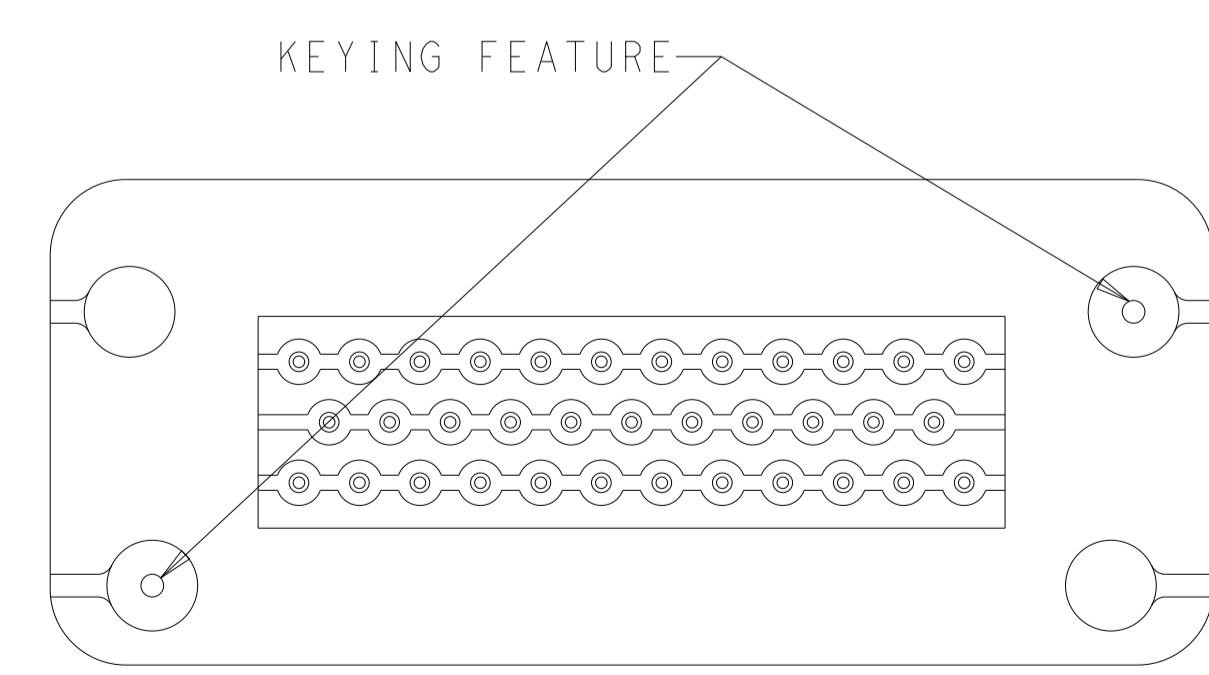

KEYING FOR 776230-2, 1-776230-2, 776230-5 AND 1-776230-5
SCALE 2:1

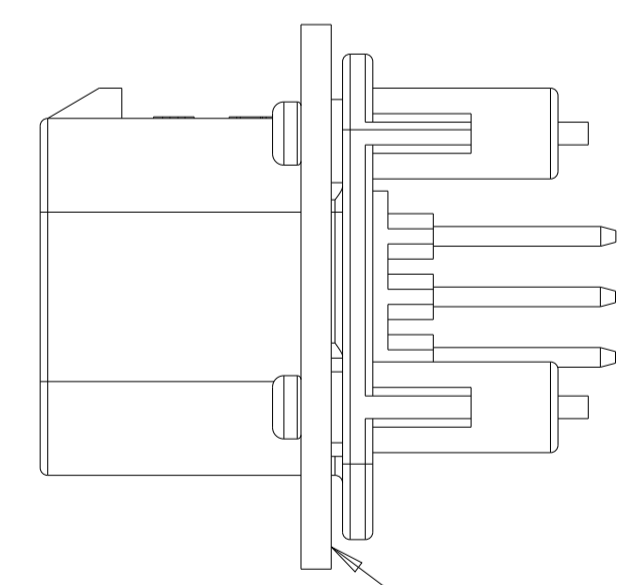

SCALE 2:1

ENSURE THE HEADER IS FLUSH TO THE PANEL FACE ALL AROUND BEFORE TIGHTENING TO FINAL TORQUE

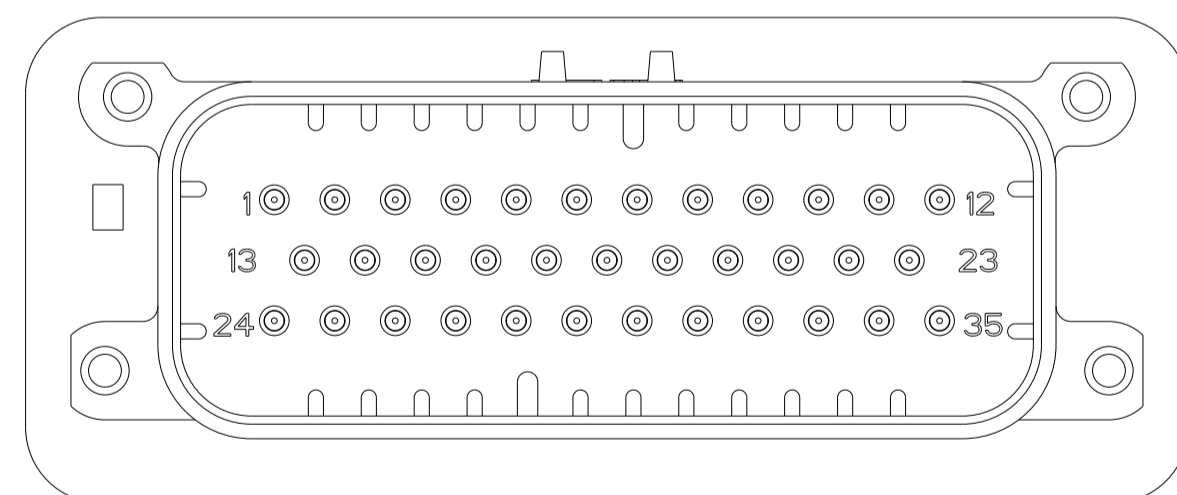

776230-2 & 1-776230-2
KEY LOCATION
SCALE 2:1

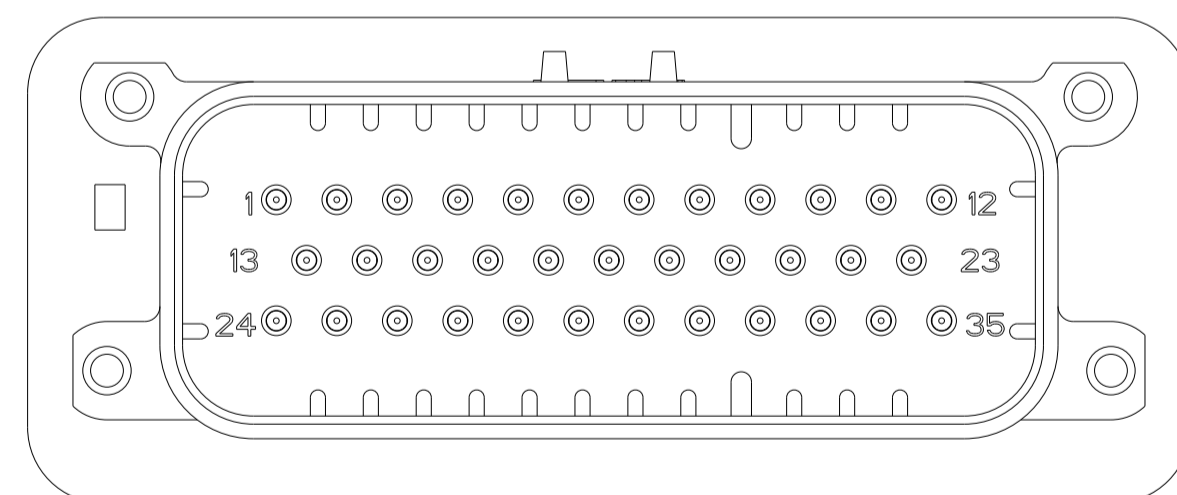

776230-4 & 1-776230-4
KEY LOCATION
SCALE 2:1

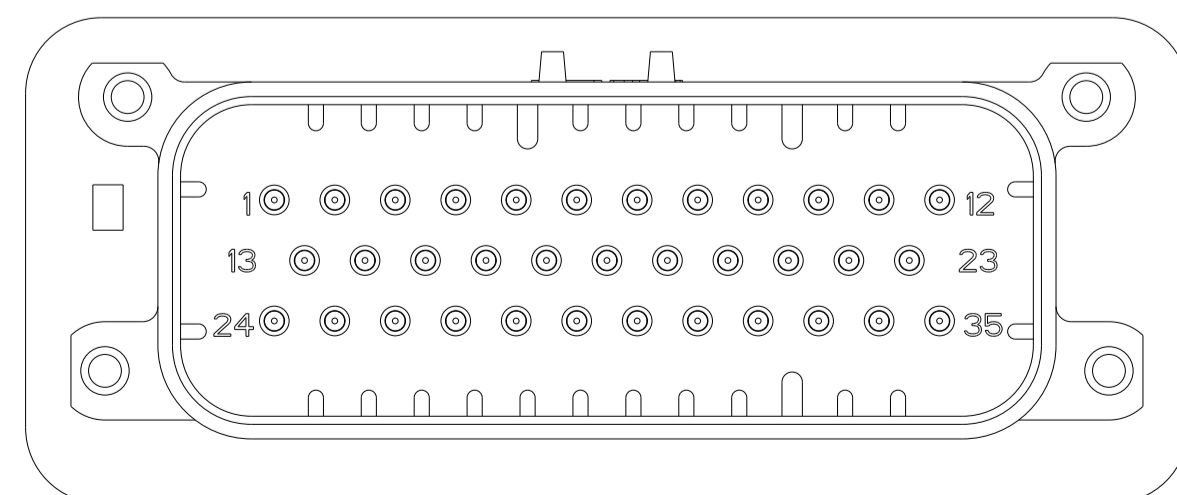

776230-5 & 1-776230-5
KEY LOCATION
SCALE 2:1

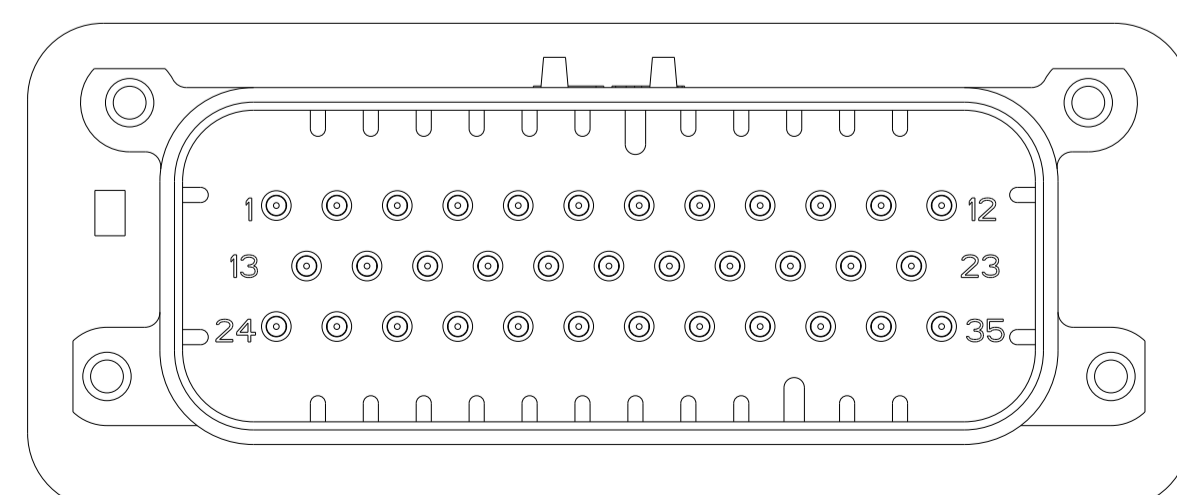

1-776230-6
KEY LOCATION
SCALE 2:1

THIS DRAWING IS A CONTROLLED DOCUMENT.		OWN: D. STRAUSSER 04FEB2010	TE Connectivity	
DIMENSIONS: mm		CHK: D. STRAUSSER 22MAR2010	NAME: HEADER ASSEMBLY, 35 POSITION, VERTICAL, AMPSEAL	
TOLERANCES UNLESS OTHERWISE SPECIFIED:		APVD: D. STRAUSSER 27APR2010	RESTRICTED TO	
0 PLC	±	PRODUCT SPEC	SIZE: CAGE CODE: DRAWING NO:	
1 PLC	±0.2	108-1329	A100779C=776230	
2 PLC	±	APPLICATION SPEC	SCALE: 4:1 SHEET 2 OF 2 REV: B1	
3 PLC	±	114-16016		
4 PLC	±	WEIGHT: 39.99g		
ANGLES	±	CUSTOMER DRAWING		
FINISH	±			