

THIS DRAWING IS UNPUBLISHED. RELEASED FOR PUBLICATION  
 © COPYRIGHT - BY TYCO ELECTRONICS CORPORATION. ALL RIGHTS RESERVED.

LOC	DIST	REVISIONS					
AJ	16	P	LTR	DESCRIPTION	DATE	DWN	APVD
			L	REVISED PER ECO-10-008433	20MAY10	HMR	KW

- 1. COPPER ALLOY
- △2 TIN-LEAD PL PER ASTM-B-545, 3.81μM [.000150] MIN THK, WITH SUPPLEMENTAL ANTI FRETTING LUBRICANT.
- △3 TIN PLATE PER ASTM B-545 WITH SUPPLEMENTAL ANTI-FRETTING LUBRICANT.

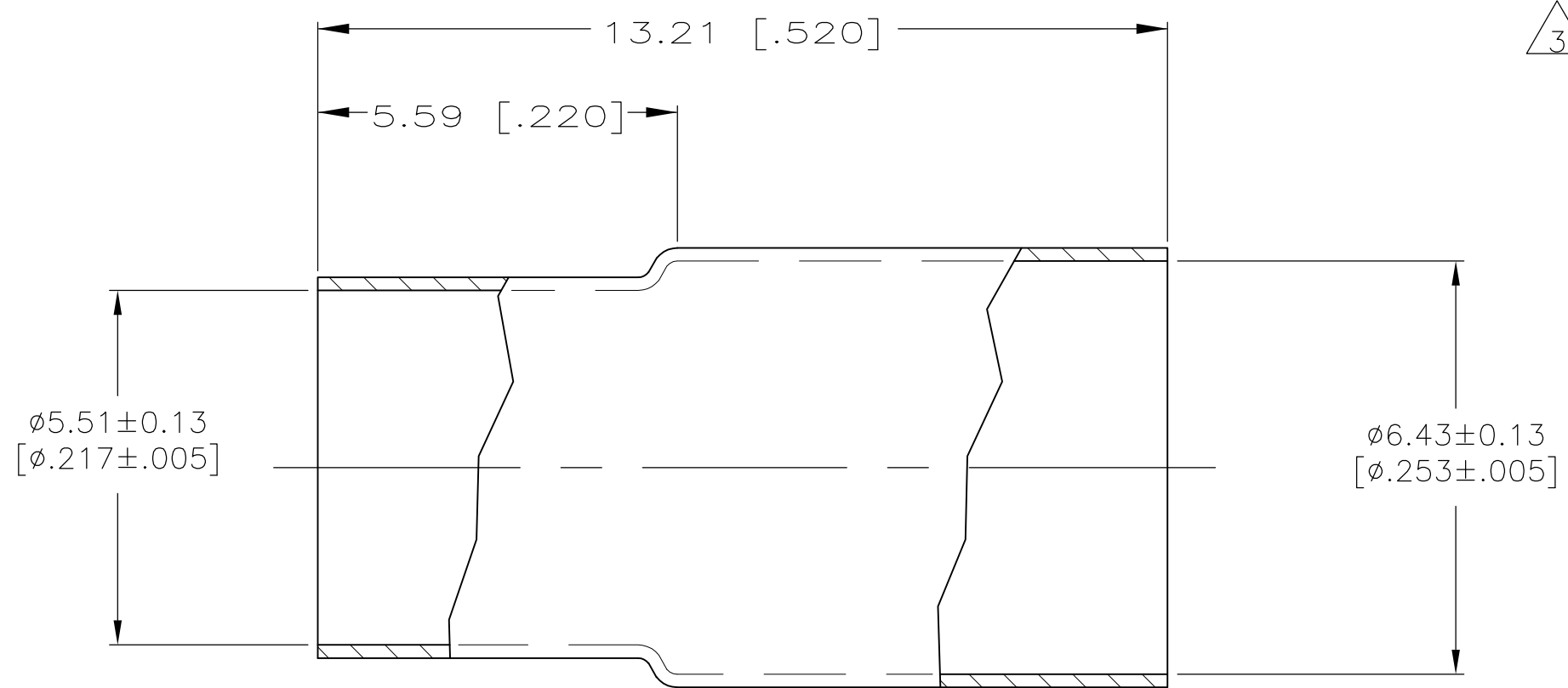

	△3	9-329006-0
OBSOLETE	△2	329006
	FINISH	PART NUMBER

THIS DRAWING IS A CONTROLLED DOCUMENT.		DWN	M. SNEED	1-30-92	Tyco Electronics Corporation Harrisburg, Pa 17105-3608		
DIMENSIONS: mm [INCHES]		CHK	R. HENRY	1-30-92	NAME		
TOLERANCES UNLESS OTHERWISE SPECIFIED:		APVD	R. HENRY	01-30-92	FERRULE		
0 PLC ± -		PRODUCT SPEC		-			
1 PLC ± -		APPLICATION SPEC		-			
2 PLC ± 0.20[.008]		SIZE	A3	CAGE CODE	00779	DRAWING NO	C-329006
3 PLC ± -		WEIGHT		-			
4 PLC ± -		CUSTOMER DRAWING		SCALE	10:1	SHEET	1 OF 1
ANGLES ± -		FINISH		SEE NOTES			
MATERIAL		SEE NOTES		RESTRICTED TO		-	
SEE NOTES		SEE NOTES		REV		L	