

P	LTR	DESCRIPTION	DATE	DWN	APVD
AN2		REVISED PER ECO-11-005140	31MAR2011	RK	-
AC3		PART STATUS UPDATED	31JAN2018	RK	
AD		STANDARDIZATION OF PLATING AND SPLICING	13AUG2024	GVP	KJK

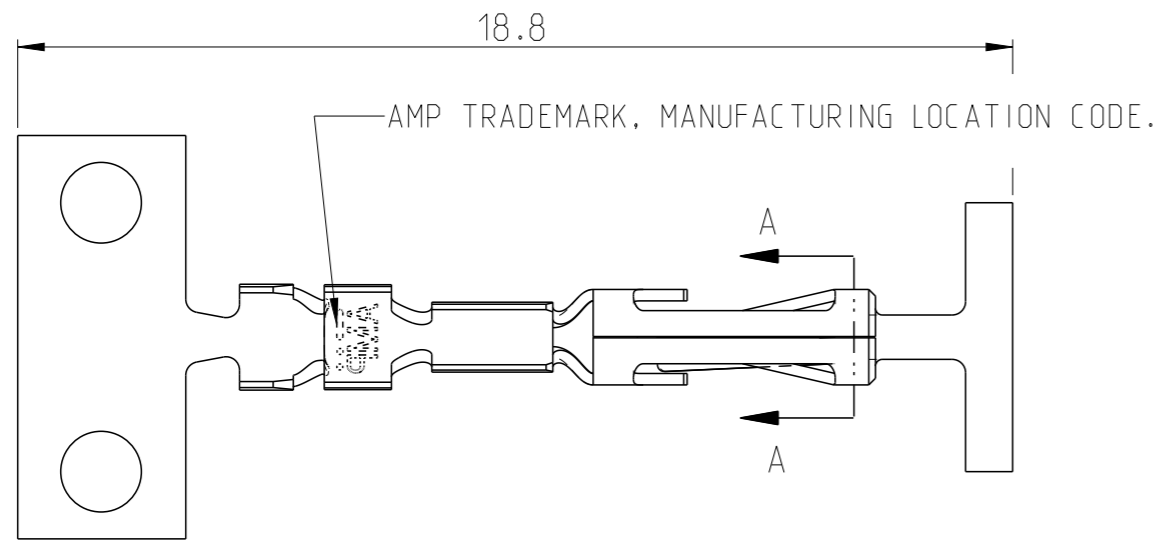

NOTE(NOTES)

- MATERIAL: PHOSPHOR BRONZE.
- FINISH : GOLD PLATED 0.4 μm IN CONTACT AREA AND GOLD FLASH ON REMAINDER EXCEPT CUTTING EDGE (GOLD FLASH IS NOT MANDATORY ON THE PILOTED CARRIER STRIP) OVER 1.3 μm NICKEL.
- FINISH : GOLD PLATED 0.4 μm IN CONTACT AREA AND GOLD FLASH ON REMAINDER (GOLD FLASH IS NOT MANDATORY ON THE PILOTED CARRIER STRIP) OVER 1.3 μm NICKEL.
- FINISH : GOLD PLATED 0.4 μm IN CONTACT AREA, OVER 1.3 μm NICKEL.
- FINISH : GOLD PLATED 0.8 μm IN CONTACT AREA AND GOLD FLASH ON REMAINDER EXCEPT FOR CUTTING EDGES, OVER 1.3 μm NICKEL.
- FINISH : GOLD PLATED 0.8 μm IN CONTACT AREA AND GOLD FLASH ON REMAINDER, OVER 1.3 μm NICKEL.
- FOR MINI-APPLICATOR P/N 781119-2.
- FOR STD. APPLICATOR.
- FOR HANDTOOL P/N 782116.
- OBSOLETE PARTS.
- SPLICING - MAXIMUM 1 LOOSE END PER REEL IS ALLOWED

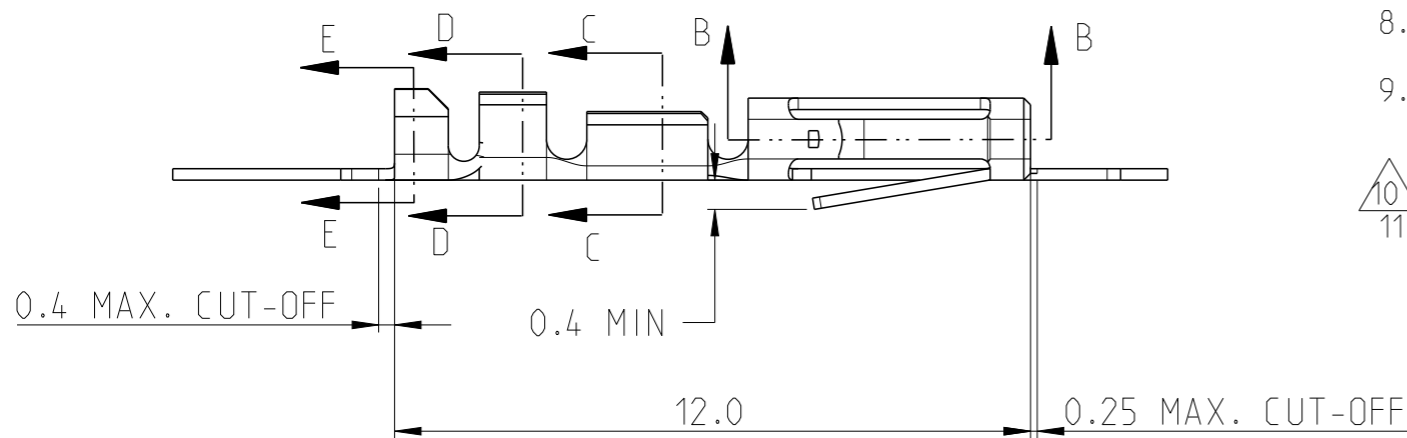

INS. DIA. RANGE.	WIRE RANGE
0.65-1.3MM	0.04-0.08MM ² (30-28 AWG)

NOTES 1&6	-	-	$\triangle 10$ -280422-5
NOTES 1&5	$\triangle 10$ -181271-4	$\triangle 10$ -1-280422-4	$\triangle 10$ -280422-4
NOTES 1&4	$\triangle 10$ -181271-3	$\triangle 10$ -1-280422-3	$\triangle 10$ -280422-3
NOTES 1&3	181271-2	1-280422-2	280422-2
NOTES 1&2	181271-1	1-280422-1	280422-1
MATL. & FINISH	LOOSE-PIECE PART NUMBER: NOTE 9	STRIP PART NUMBER: NOTE 8	STRIP PART NUMBER: NOTE 7

TOLERANCES, UNLESS OTHERWISE SPECIFIED
±0.3

THIS DRAWING IS A CONTROLLED DOCUMENT.		DWN G.CAMPBIA 29JUN1989
DIMENSIONS: mm		CHK -
TOLERANCES UNLESS OTHERWISE SPECIFIED: 0 PLC ±0.3 1 PLC ±0.3 2 PLC ±0.3 3 PLC ±0.3 4 PLC ±0.3 ANGLES ±		APVD -
MATERIAL SEE TABLE	FINISH SEE TABLE	PRODUCT SPEC 108-20025
		APPLICATION SPEC 114-20004
		WEIGHT -
		CUSTOMER DRAWING

TE TE Connectivity			
NAME AMP MODU II REC. CONTACT, STD PRESSURE, C.O.S.I.			
SIZE A3	CAGE CODE 00779	DRAWING NO C=280422	RESTRICTED TO -
SCALE 7:1		SHEET 1 OF 1	REV AD

