

⚠ LABEL INFORMATION: BARCODE FORMAT- 2D DATAMATRIX

PN: 2364071-X  
 REV: \_\_\_\_\_  
 MADE IN: \_\_\_\_\_  
 DATE: \_\_\_\_\_ S/N: \_\_\_\_\_

BARCODE INFO:  
 2364071-ddxxwyyrrssss  
 dd=DASH NUMBER  
 xx= MANUFACTURING SITE  
 (US=USA, CN=CHINA, MX=MEXICO)  
 ww= WEEK  
 yy= YEAR  
 rr= REVISION  
 sssss= SERIAL NUMBER 0000 THRU 9999

- EACH CABLE TESTED ON NETWORK ANALYZER, SERIALIZED AND DATA SAVED.
- EACH CABLE ASSEMBLY TESTED FOR CONTINUITY, OPENS, AND SHORTS.

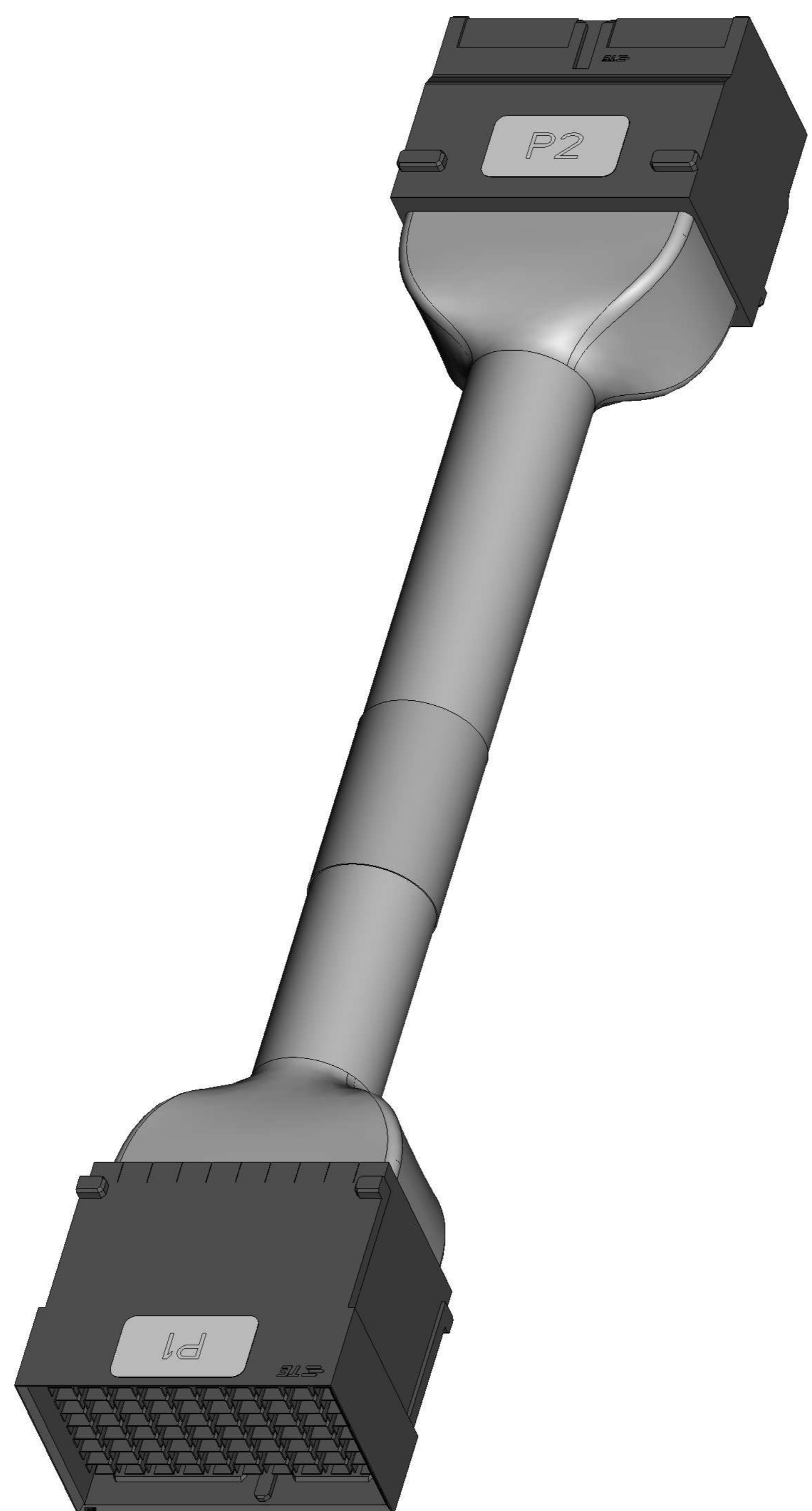

REVISIONS				
P	LYR	DESCRIPTION	DATE	OWN APVD
	A	RELEASED	17DEC2019	REH JR

4001.6	±20	9-2364071-9
3751.6	±10	9-2364071-8
3501.6		9-2364071-7
3251.6		9-2364071-6
3001.6		9-2364071-5
2901.6		9-2364071-4
2851.6		9-2364071-3
2801.6		9-2364071-2
2751.6		9-2364071-1
2701.6		9-2364071-0
2651.6		8-2364071-9
2601.6		8-2364071-8
2551.6		8-2364071-7
2501.6		8-2364071-6
2451.6		8-2364071-5
2401.6		8-2364071-4
2351.6		8-2364071-3
2301.6		8-2364071-2
2251.6		8-2364071-1
2201.6		8-2364071-0
2151.6		7-2364071-9
2101.6		7-2364071-8
2051.6	±20	7-2364071-7
2001.6	±15	7-2364071-6
1951.6	±10	7-2364071-5
1901.6		7-2364071-4
1851.6		7-2364071-3
1801.6		7-2364071-2
1751.6		7-2364071-1
1701.6		7-2364071-0
1651.6		6-2364071-9
1601.6		6-2364071-8
1551.6		6-2364071-7
1501.6		6-2364071-6
1451.6		6-2364071-5
1401.6		6-2364071-4
1351.6		6-2364071-3
1301.6		6-2364071-2
1251.6		6-2364071-1
1201.6		6-2364071-0
1151.6		5-2364071-9
1101.6		5-2364071-8
1051.6	±15	5-2364071-7
1001.6	±10	5-2364071-6
976.6	±5	5-2364071-5
951.6		5-2364071-4
926.6		5-2364071-3
901.6		5-2364071-2
876.6	±10	5-2364071-1
DIM	TOL	PART NUMBER
L		

851.6	±10	5-2364071-0
826.6	±5	4-2364071-9
801.6		4-2364071-8
776.6		4-2364071-7
751.6		4-2364071-6
726.6		4-2364071-5
701.6		4-2364071-4
676.6		4-2364071-3
651.6		4-2364071-2
626.6		4-2364071-1
601.6		4-2364071-0
576.6		3-2364071-9
551.6		3-2364071-8
526.6		3-2364071-7
501.6		3-2364071-6
491.6		3-2364071-5
481.6		3-2364071-4
471.6		3-2364071-3
461.6		3-2364071-2
451.6		3-2364071-1
441.6		3-2364071-0
431.6		2-2364071-9
421.6		2-2364071-8
411.6		2-2364071-7
401.6		2-2364071-6
391.6		2-2364071-5
381.6		2-2364071-4
371.6		2-2364071-3
361.6		2-2364071-2
351.6		2-2364071-1
341.6		2-2364071-0
331.6		1-2364071-9
321.6		1-2364071-8
311.6		1-2364071-7
301.6		1-2364071-6
291.6		1-2364071-5
281.6		1-2364071-4
271.6		1-2364071-3
261.6		1-2364071-2
251.6		1-2364071-1
241.6		1-2364071-0
231.6		2364071-9
221.6		2364071-8
211.6		2364071-7
201.6		2364071-6
191.6		2364071-5
181.6		2364071-4
171.6		2364071-3
161.6		2364071-2
151.6	±10	2364071-1
DIM	TOL	PART NUMBER
L		

THIS DRAWING IS A CONTROLLED DOCUMENT. **TE Connectivity**

DIMENSIONS: mm TOLERANCES UNLESS OTHERWISE SPECIFIED: 0 PLC ± 1 PLC ± 2 PLC ± 3 PLC ± 4 PLC ± ANGLES FINISH ±	OWN: HAMNER 13DEC2019 CHK: J. ROSSMAN 17DEC2019 APVD: J. ROSSMAN 17DEC2019 PRODUCT SPEC: 108-130001 APPLICATION SPEC: 114-130010 WEIGHT: - RESTRICTED CUSTOMER	NAME: CABLE ASSEMBLY, 100 OHM, PiR, 8 PAIR 10 COLUMN, HDR TO RECEPT, 2-2 WIRING, A-A SIZE: 114-130010 CAGE CODE: 00779 DRAWING NO: 2364071 SCALE: 2:1 SHEET: 1 OF 2 REV: A
--	--	--

**THIS PRODUCT HAS NOT COMPLETED VALIDATION AND QUALIFICATION TESTING**

REVISIONS				
#	DATE	DESCRIPTION	DATE	APPV
-	-	SEE SHEET 1	-	-

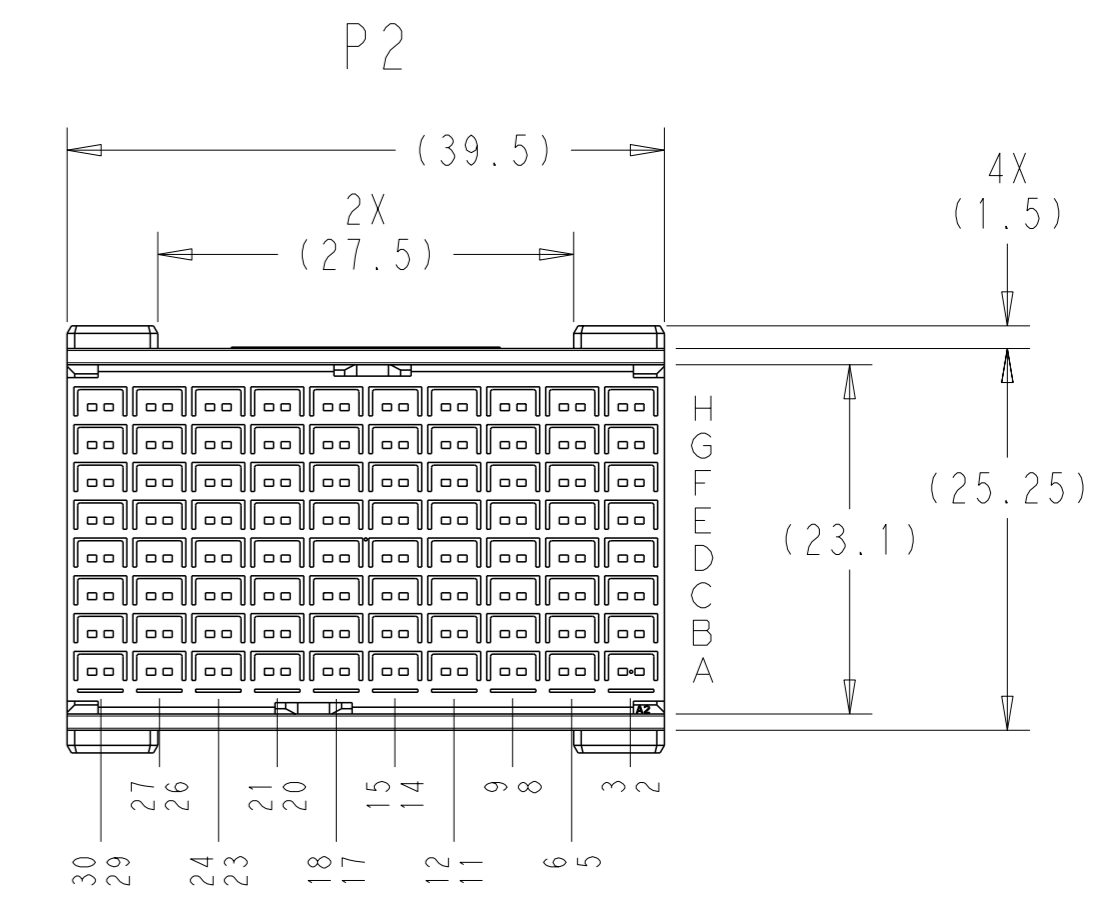
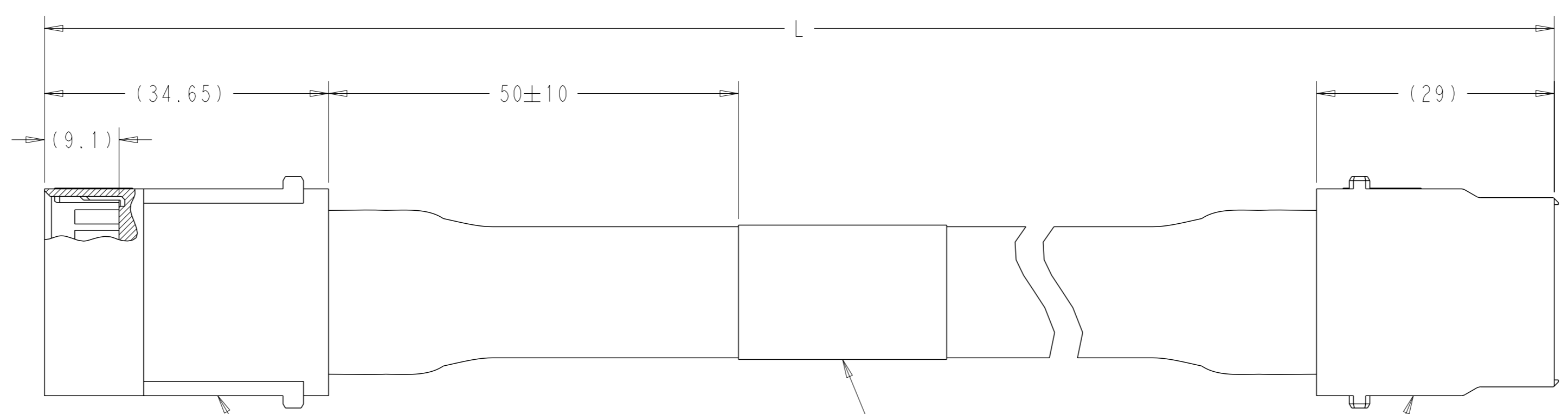
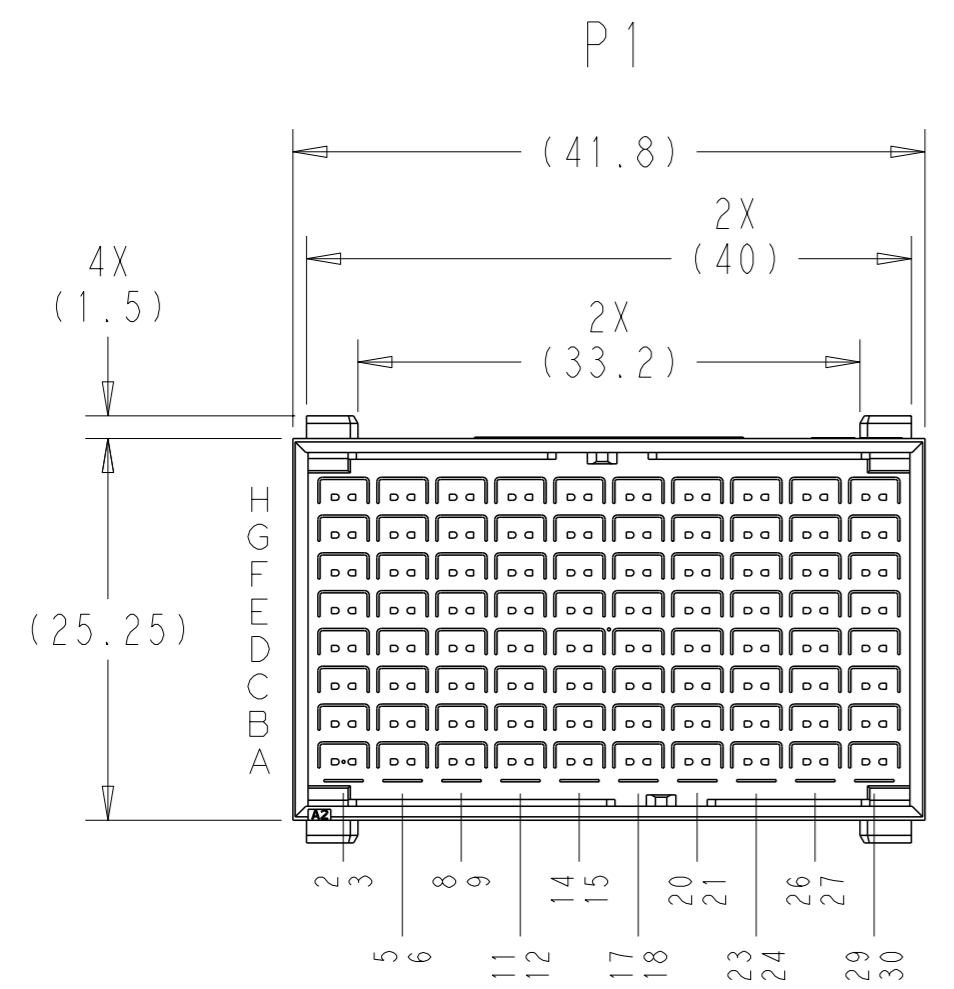
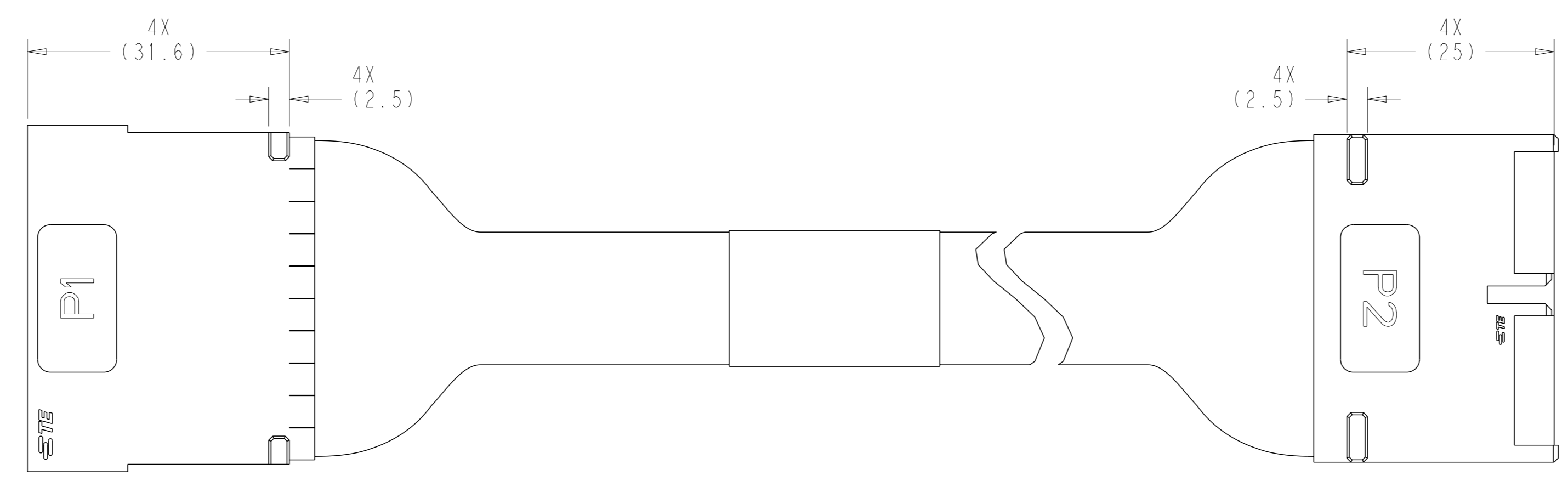

CABLED HEADER  
8 PAIR 10 COLUMN  
PiR, 100 OHM

CABLED RECEPTACLE  
8 PAIR 10 COLUMN  
PiR, 100 OHM

WIRING DIAGRAM

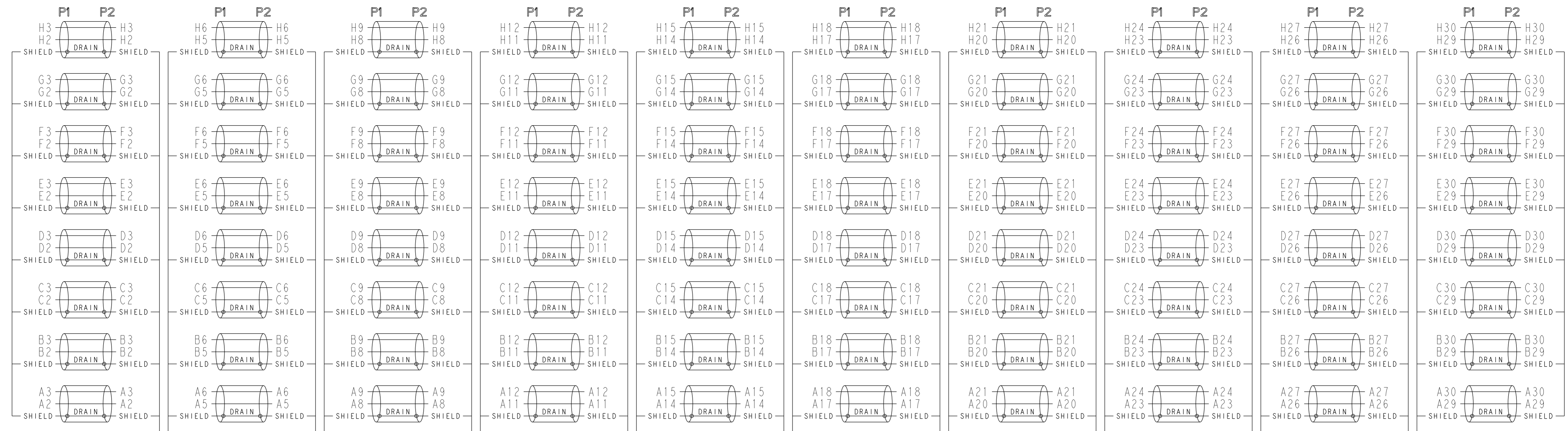

**THIS PRODUCT HAS NOT COMPLETED VALIDATION AND QUALIFICATION TESTING**

THIS DRAWING IS A CONTROLLED DOCUMENT.		OWN: HAMNER 13DEC2019	TE Connectivity
DIMENSIONS: mm		CHK: J. ROSSMAN 17DEC2019	
TOLERANCES UNLESS OTHERWISE SPECIFIED:		APVD: J. ROSSMAN 17DEC2019	NAME: CABLE ASSEMBLY, 100 OHM, PiR, 8 PAIR 10 COLUMN, HDR TO RECEPT, 2-2 WIRING, A-A SIZE: 108-130001 APPLICATION SPEC: 114-130010 WEIGHT: - RESTRICTED CUSTOMER
MATERIAL: -		FINISH: -	
SCALE: 2:1		SHEET: 2 OF 2	
REV: A		REV: A	