

P	LTR	DESCRIPTION	DATE	DWN	APVD
	A	ECO-20-012219	19NOV2020	GK	DR

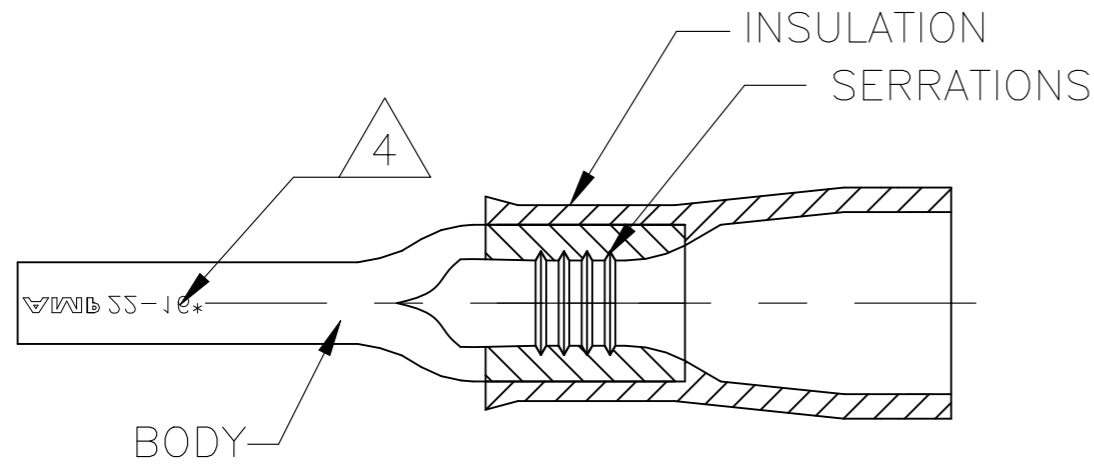

22-16 AWG STRANDED	22-16 AWG STRANDED

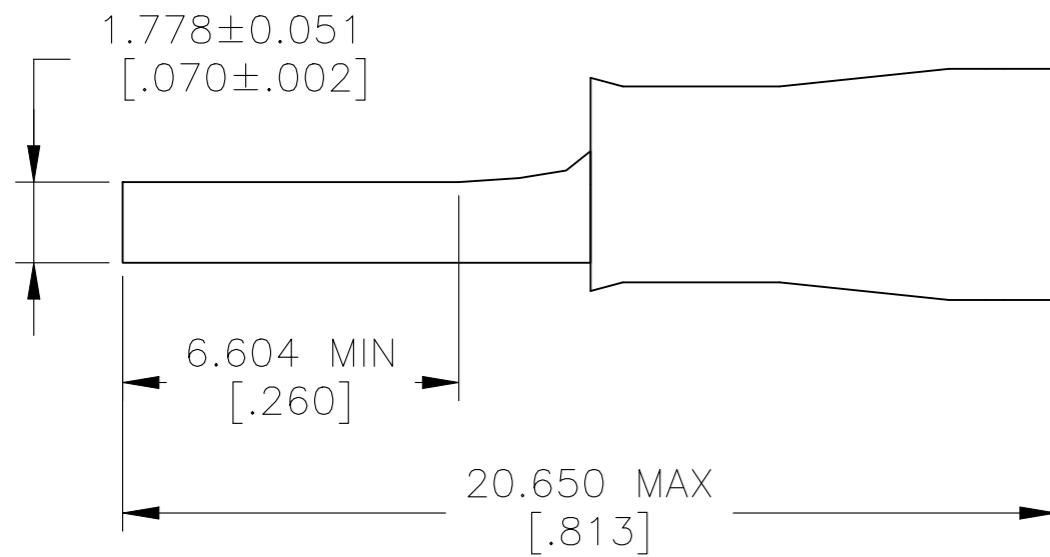

- 1. WIRE INSULATION DIAMETER: $\phi 3.556$ [.140] MAX
- 2 MATERIAL: BODY - CU PER ASTM B152
INSULATION - PVC
- 3 FINISH: BODY - TIN PLATE 0.00254 [.000100] MIN EXT THK PER ASTM B545
INSULATION COLOR - RED
- 4 STAMP AMP 22-16* APPROX AS SHOWN

100	WP015-V-R1	1SET151001R0000	165143
QTY	DESIGNATION	ENTRELEC PN	TE PN

MAX RECOMMENDED OPERATING TEMPERATURE: 105°C [221°F]
VOLTAGE RATING: 600 V MAX (1000 V SIGN OR FIXTURE)
CIRCULAR MIL AREA: 0.26-1.65 mm ² [509-3,260] STRANDED

THIS DRAWING IS A CONTROLLED DOCUMENT.	
DIMENSIONS: mm [INCHES]	TOLERANCES UNLESS OTHERWISE SPECIFIED:
	0 PLC ± - 1 PLC ± - 2 PLC ± - 3 PLC ± 0.127 [.005] 4 PLC ± - ANGLES ± -
MATERIAL - 2	FINISH - 3

DWN GOPALAKRISHNA HV 18NOV2020	ENTRELEC Electrical Solutions
CHK ROHDE DANIEL F 18NOV2020	
APVD ROHDE DANIEL F 18NOV2020	
PRODUCT SPEC UL 486A-B	
APPLICATION SPEC 114-2161	NAME TERMINAL, WIRE PIN, PLASTI-GRIP WIRE SIZE, 22-16 AWG
WEIGHT -	SIZE A3
CUSTOMER DRAWING	CAGE CODE 00779
	DRAWING NO C-1SET151001R0000
	RESTRICTED TO -
	SCALE 6:1
	SHEET 1 OF 1
	REV A