

P	LTR	DESCRIPTION	DATE	DWN	APVD
	A	ECO-20-012219	13NOV2020	GK	DR

 Listed	 Certified
22-16 AWG SOLID OR STRANDED	22-16 AWG SOLID OR STRANDED

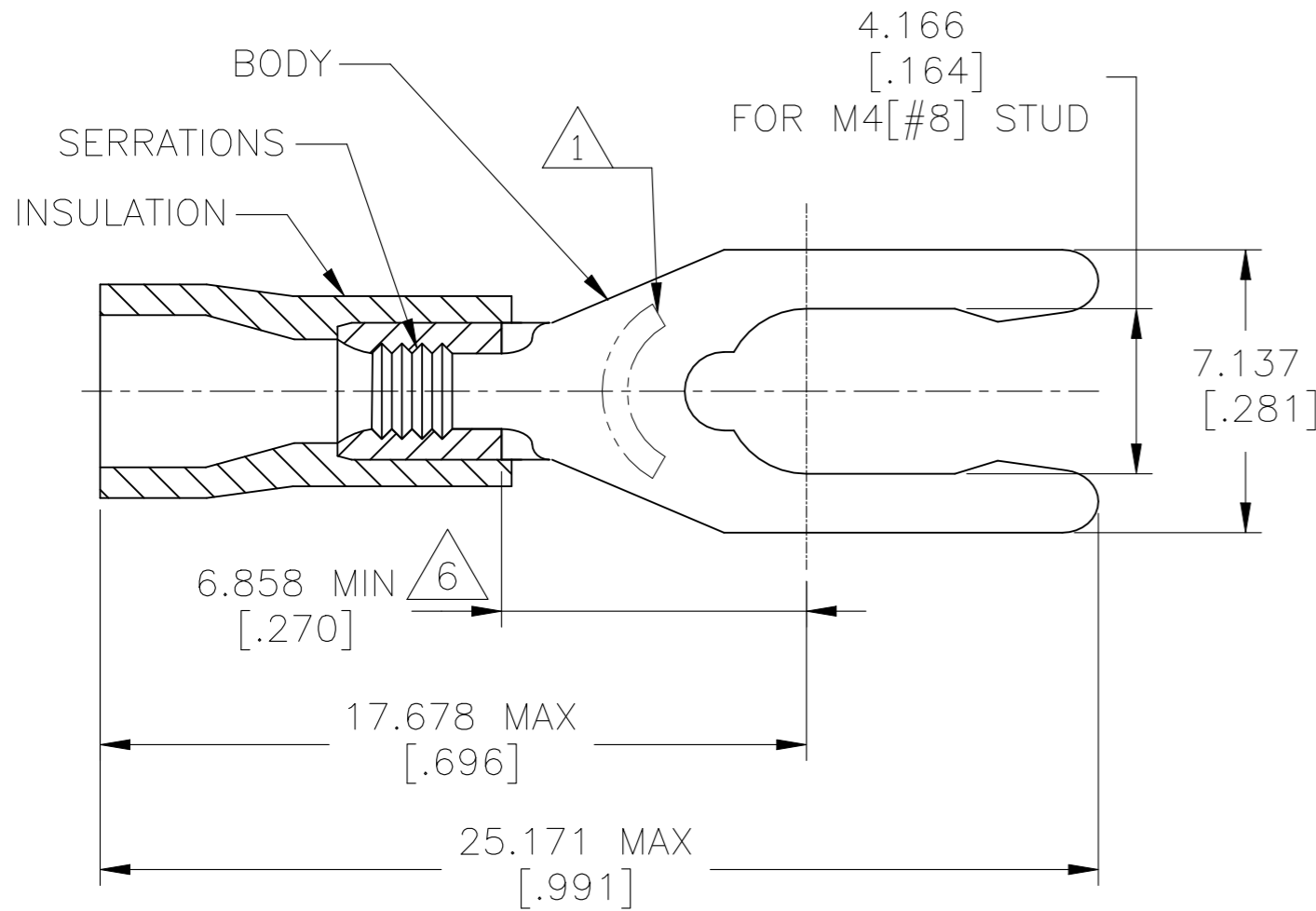

- 1 STAMP "8S AMP 22-18\*" APPROX AS SHOWN WIRE RANGE IS 22-16 AWG
- 2. WIRE INSULATION DIAMETER:  $\phi 2.667 - 3.556$  [ $\phi .105 - .140$ ]
- 3. BODY MATERIAL THK:  $0.787 \pm 0.051$  [ $.031 \pm .002$ ]
- 4 MATERIAL: BODY - BRASS PER ASTM B36 INSULATION - PVC
- 5 FINISH: BODY - TIN PLATE  $0.00254$  [ $.000100$ ] MIN EXT THK PER ASTM B545 INSULATION COLOR - RED
- 6 APPLIES FROM EDGE OF METAL WIRE BARREL TO CENTER OF STUD HOLE

100	SDL015-040-V	1SET134002R0000	52454
QTY	DESIGNATION	ENTRELEC PN	TE PN

MAX RECOMMENDED OPERATING TEMPERATURE: 105°C [221°F]  VOLTAGE RATING: 600V MAX (1000V FIXTURE OR SIGN)  CIRCULAR MIL AREA: 0.26-1.65mm² [509-3260] SOLID OR STRANDED	THIS DRAWING IS A CONTROLLED DOCUMENT.		DWN 13NOV2020 GOPALAKRISHNA HV CHK 13NOV2020 ROHDE DANIEL F APVD 13NOV2020 ROHDE DANIEL F		<b>ENTRELEC</b> Electrical Solutions  TERMINAL, SPRING SPADE, LONG, PLASTI-GRIP, WIRE SIZE: 22-16 AWG				
	DIMENSIONS: mm [INCHES]	TOLERANCES UNLESS OTHERWISE SPECIFIED: 0 PLC ± - 1 PLC ± - 2 PLC ± - 3 PLC ± 0.127[.005] 4 PLC ± - ANGLES ± -	PRODUCT SPEC UL 486A-B APPLICATION SPEC 114-2161						NAME
	MATERIAL	FINISH	WEIGHT - CUSTOMER DRAWING		A3 00779		C-1SET134002R0000		-
	- 4	- 5	SCALE 6:1		SHEET 1 OF 1		REV A		