

P	LTR	DESCRIPTION	DATE	DWN	APVD
	A	ECO-20-012219	11SEP2020	GK	DR

 Listed	 Certified
16-14 AWG SOLID OR STRANDED	16-14 AWG SOLID OR STRANDED

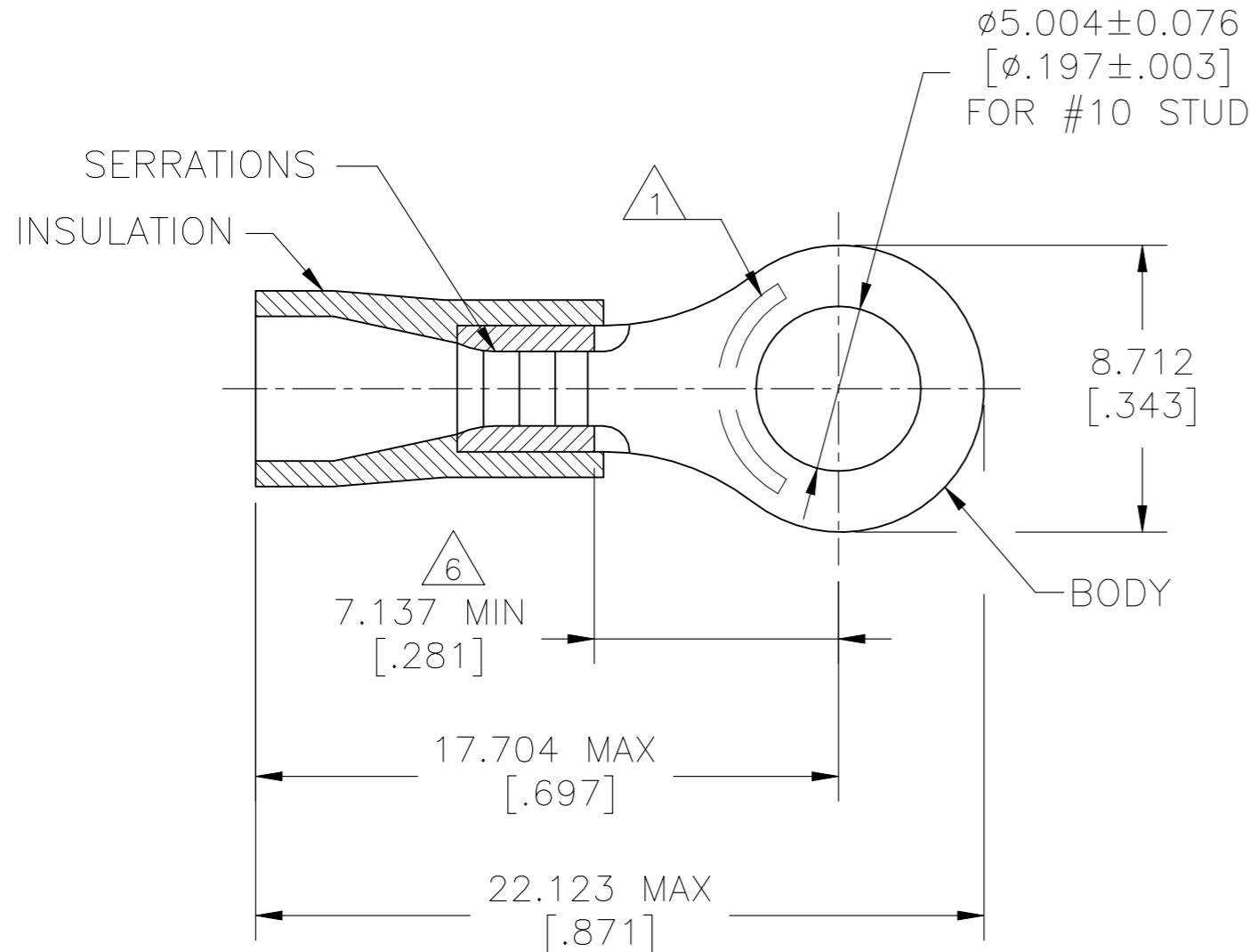

- 1 STAMP AMP 16-14\* APPROX AS SHOWN
- 2. BODY MATERIAL THK: 0.787±0.051 [.031±.002]
- 3 MATERIAL: BODY - CU PER ASTM B152  
INSULATION - PVC
- 4 FINISH: BODY - TIN PLATE 0.00254 [.000100] MIN EXT THK PER ASTM B545  
INSULATION COLOR - BLUE
- 5. WIRE INSULATION DIAMETER:  $\phi$ 2.997- 4.902 [ $\phi$ .118-.193]
- 6 APPLIES FROM EDGE OF METAL WIRE BARREL TO CENTER OF STUD HOLE

100	RT025-050-V	1SET121011R0000	34161
QTY	DESIGNATION	ENTRELEC PN	TE PN

MAX RECOMMENDED OPERATING TEMPERATURE: 105°C [221° F]  VOLTAGE RATING: 600V MAX (1000V FIXTURE OR SIGN)  CIRCULAR MIL AREA: 1.04-2.62mm <sup>2</sup> [2,050-5,180] SOLID OR STRANDED	THIS DRAWING IS A CONTROLLED DOCUMENT.		DWN 11SEP2020 GOPALAKRISHNA HV CHK 11SEP2020 ROHDE DANIEL F APVD 11SEP2020 ROHDE DANIEL F		<b>ENTRELEC</b> Electrical Solutions  TERMINAL, RING TONGUE, PLASTI-GRIP, WIRE SIZE: 16-14 AWG			
	DIMENSIONS: mm [INCHES]	TOLERANCES UNLESS OTHERWISE SPECIFIED: 0 PLC ± - 1 PLC ± - 2 PLC ± - 3 PLC ± 0.127[.005] 4 PLC ± - ANGLES ± -	PRODUCT SPEC UL 486A-B APPLICATION SPEC 114-2161					
	MATERIAL	- 3	FINISH	- 4	WEIGHT A300779			
	CUSTOMER DRAWING				SCALE 4:1	SHEET 1 OF 1	REV A	