

LOC	DIST	REVISIONS					
AP	-	P	LTR	DESCRIPTION	DATE	DWN	APVD
		A		CHANGED STATUS ECO-11-009594	26MAY2011	MAS	MG
		A1		REVISED DESIGN ECO-13-008307	21MAY2013	NCL	DAO

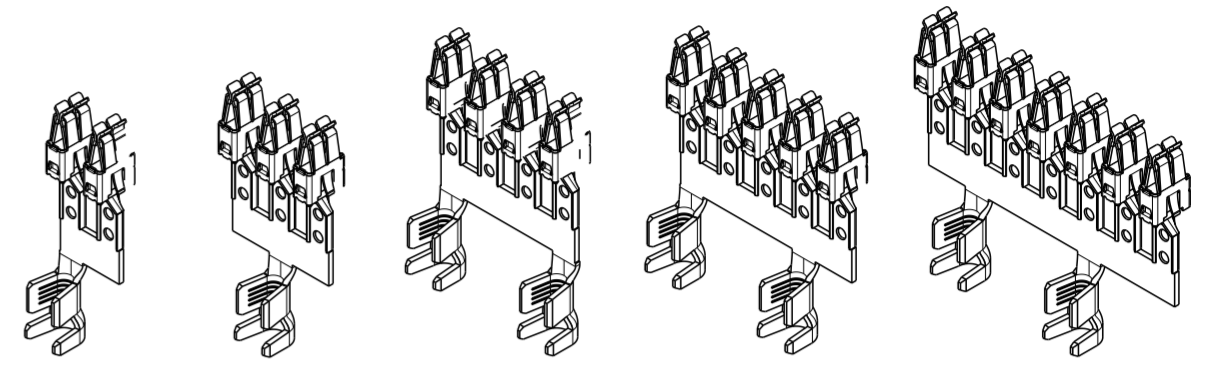

PERSPECTIVE VIEWS
SCALE 1:1

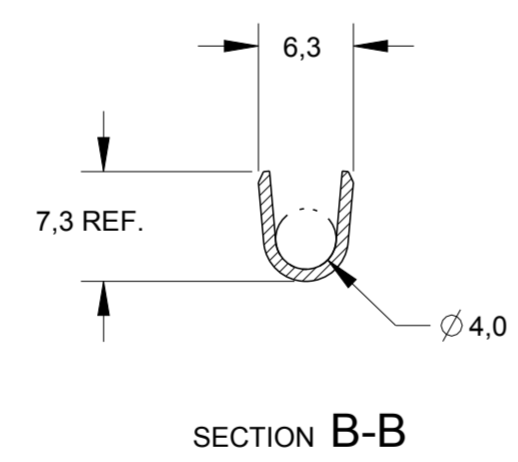
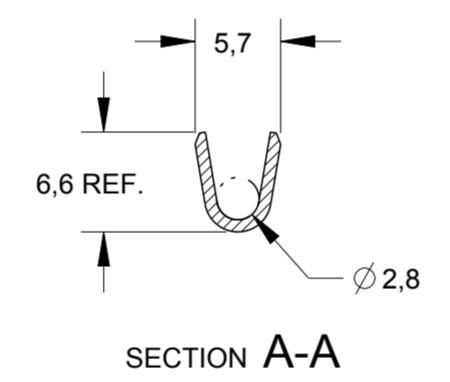
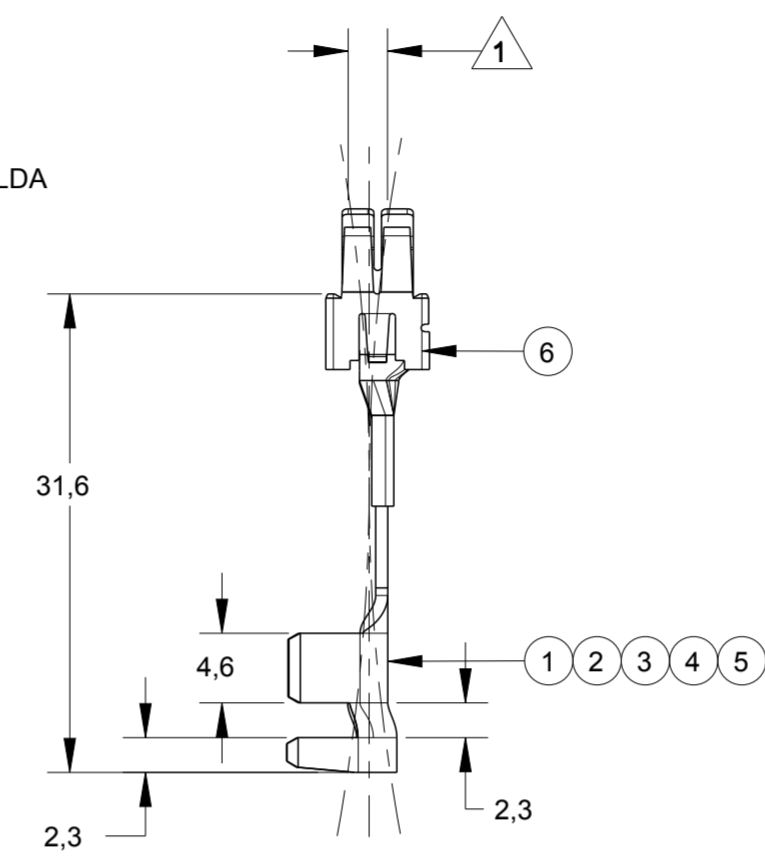
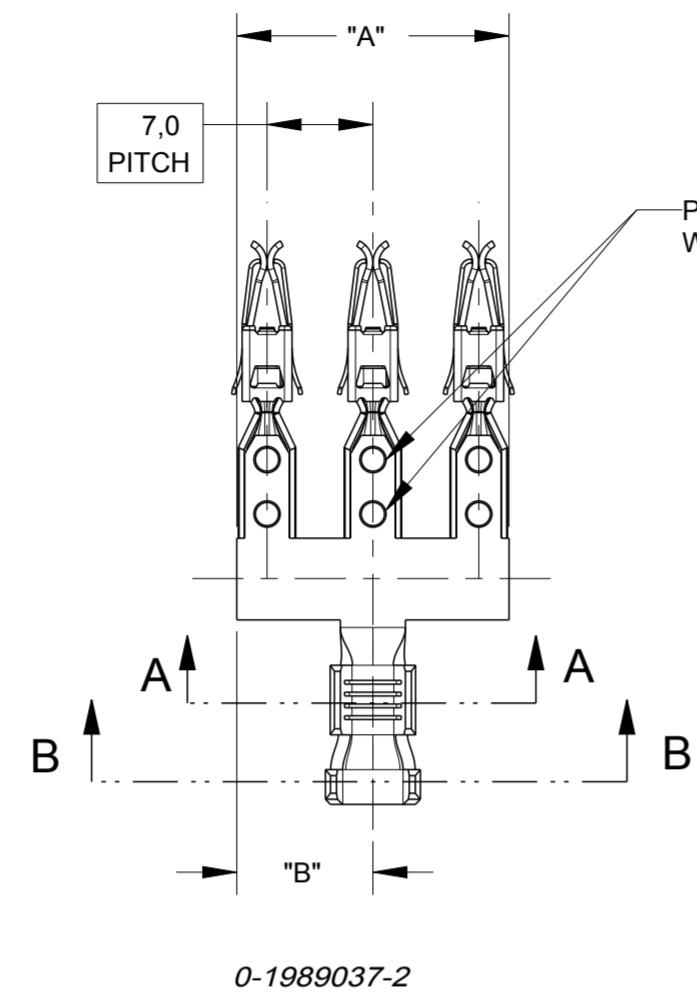
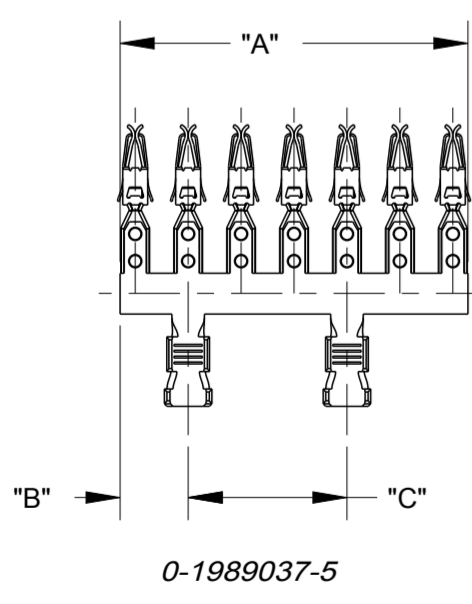
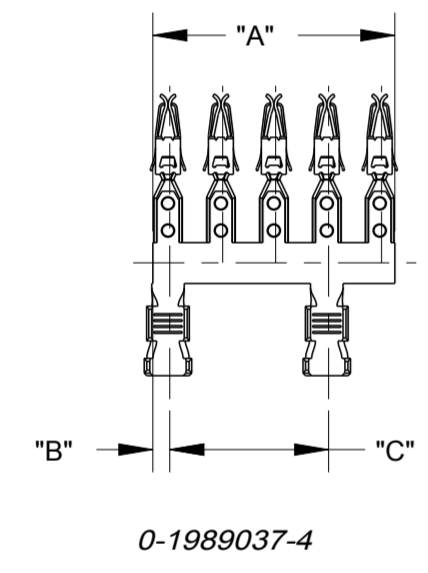
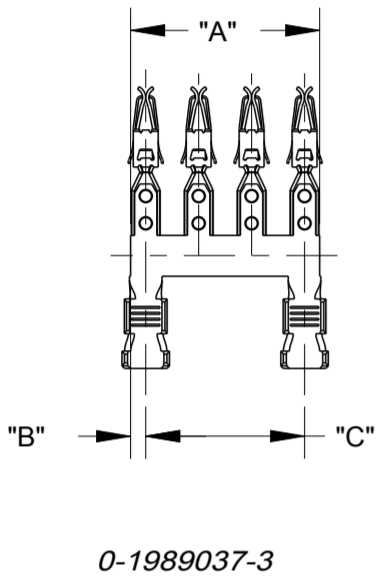
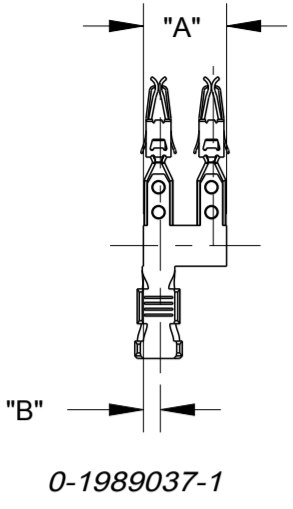

ASS'Y PN	No POSN.	"A"	"B"	"C"	MAXIMUM CURRENT
0-1989037-1	2	11,0	2,0	N/A	20A
0-1989037-2	3	18,0	9,0	N/A	20A
0-1989037-3	4	25,0	2,0	21,0	25A
0-1989037-4	5	32,0	2,0	21,0	25A
0-1989037-5	7	46,0	9,0	21,0	32A

1 - 0,15 mm DE DEFORMAÇÃO MÁXIMA PERMITIDA EM TODA EXTENSÃO
 - 0,15 mm ALLOWED MAXIMUM DEFORMATION IN ALL ESTENSION

ITEM	DESCRIPTION	MATERIAL	FINISH	
7	SPT, BUSBAR LOOSE-PIECE	BRONZE	TINNED	
1	COMB 7 POSN, SPT BUSBAR	CuSn 0,15	TINNED	
-	1 - - - - 4			COMB 5 POSN, SPT BUSBAR
-	- 1 - - - 3			COMB 4 POSN, SPT BUSBAR
-	- - 1 - - 2			COMB 3 POSN, SPT BUSBAR
-	- - - 1 - 1			COMB 2 POSN, SPT BUSBAR

WIRE RANGE:
4,0 mm²
INSUL. RANGE:
Ø 3,4-3,8mm

DIMENSIONS:	TOLERANCES UNLESS OTHERWISE SPECIFIED:
mm	0 PLC ±
	1 PLC ±0.3
	2 PLC ±
	3 PLC ±
	4 PLC ±
	ANGLES ±1°
	FINISH

THIS DRAWING IS A CONTROLLED DOCUMENT.

DWN: M.T.ONISHI 09AUG2006
 CHK: P.L.FARIA 09AUG2006
 APVD: D.OLIVEIRA 09AUG2006

PRODUCT SPEC: -
 APPLICATION SPEC: -
 WEIGHT: -

STE TE Connectivity

NAME: BUSBAR STANDARD POWER TIMER 2, 3, 4, 5, AND 7 POSN.

SIZE: A2 CAGE CODE: 00779 DRAWING NO: 1989037 RESTRICTED TO: -/-

CUSTOMER DRAWING SCALE: 2:1 SHEET 1 OF 1 REV: A1