

THIS DRAWING IS UNPUBLISHED. RELEASED FOR PUBLICATION 20
 © COPYRIGHT 20 BY - ALL RIGHTS RESERVED.

REVISIONS					
P	LTR	DESCRIPTION	DATE	DWN	APVD
B		ECR-13-017246	08NOV2013	KG	DW
BI		ECR-16-010381	10NOV2016	KG	DW
C		ECR-17-014250	17OCT2017	KG	DW

- USE WITH FERRULE ASSEMBLY KIT P/N 1985635-2 OR P/N 1985107-1. QUANTITY OF 8 REQUIRED.
- THIS PRODUCT HAS NOT COMPLETED VALIDATION TESTING.
- PROTECTIVE LABELS APPLIED AFTER FINAL CLEAN ROOM TEST TO PREVENT OPTICAL CAVITY CONTAMINATION. REMOVE ONLY WHEN READY TO ASSEMBLE.
- MULTIMODE IDENTIFIER.

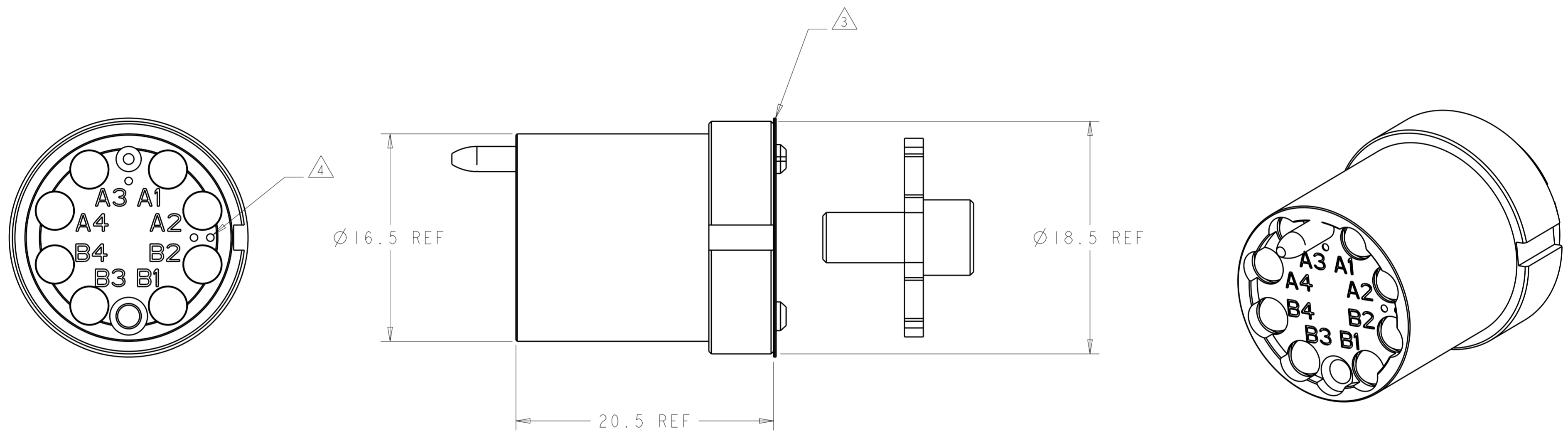

8 CHANNEL, 850/1300nm MM	1516256-1
DESCRIPTION	PART NUMBER

THIS DRAWING IS A CONTROLLED DOCUMENT.		DWN K. GLATFELTER 12AUG2009	TE Connectivity	
DIMENSIONS: mm		CHK D. WERTMAN 12AUG2009		
TOLERANCES UNLESS OTHERWISE SPECIFIED:		APVD D. WERTMAN 12AUG2009	NAME INSERT ASSEMBLY, 8 CH, MM, PRO BEAM SR.	
0 PLC ±	1 PLC ±	PRODUCT SPEC	SIZE A2	CAGE CODE
2 PLC ±	3 PLC ±	APPLICATION SPEC	DRAWING NO C-1516256	RESTRICTED TO
4 PLC ±	ANGLES ±	WEIGHT	SCALE 4:1	SHEET OF
MATERIAL	FINISH	Customer Drawing	REV C	