

P	LTR	DESCRIPTION	DATE	DWN	APVD
	B	REVISED PER ECR-23-181664	07AUG2023	AP	DSC

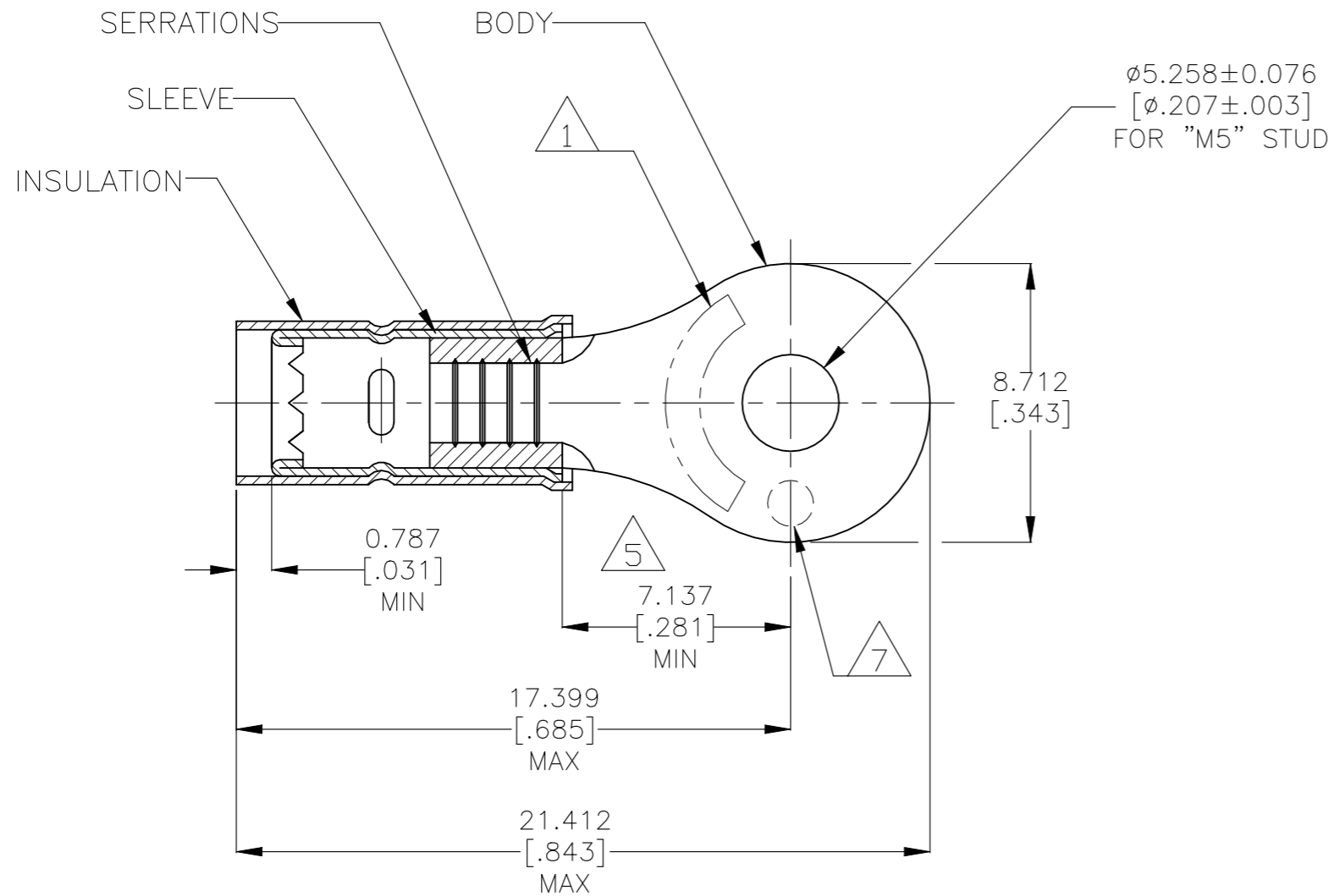

- 1 STAMP AMP 16-14\* APPROX AS SHOWN
- 2 WIRE INSULATION DIAMETER:  
 $\phi 2.591$  [.102] TO  $\phi 3.810$  [.150]
- 3 MATERIAL:  
BODY&SLEEVE: COPPER PER ASTM B152  
INSULATION: NYLON.
- 4 FINISH:  
BODY & SLEEVE - TIN PLATE 0.00254 [.000100]  
MIN EXT THK PER ASTM B545  
INSULATION COLOR - BLUE
- 5 APPLIES FROM CENTER OF STUD HOLE TO  
EDGE OF METAL WIRE BARREL
- 6 BODY MATERIAL THK:  $0.787 \pm 0.051$  [.031 ± .002]
- 7 DIMPLE STAMP MARK OPTIONAL

<b>AMP</b> WIRE RANGE	Listed FILE E13288	LR7189 Certified
16-14 AWG SOLID OR STRANDED	16-14 AWG SOLID OR STRANDED	16-14 AWG SOLID OR STRANDED

5000	TAPE&REEL	2-130663-1
1000	LOOSE PIECE	130663
PKG QTY	PACKAGE TYPE	PART NUMBER

AMP INCORPORATED CUSTOMER SERVICE SYSTEMS	
FOR ADDITIONAL PRODUCT INFORMATION OR COPIES OF DRAWINGS AND TECHNICAL DOCUMENTS	PRODUCT INFORMATION CENTER 1-800-522-6752
FOR APPLICATION TOOLING INFORMATION	TOOLING ASSISTANCE CENTER 1-800-722-1111
FOR ORDER ENTRY	1-800-526-5142

MAX RECOMMENDED OPERATING TEMPERATURE: 105°C [221°F]
VOLTAGE RATING: 300 V MAX
CIRCULAR MIL AREA: 1.04-2.62mm <sup>2</sup> [2050-5180] SOLID OR STRANDED
THIS DRAWING IS A CONTROLLED DOCUMENT FOR AMP INCORPORATED. IT IS SUBJECT TO CHANGE AND THE CONTROLLING ENGINEERING ORGANIZATION SHOULD BE CONTACTED FOR THE LATEST REVISION

THIS DRAWING IS A CONTROLLED DOCUMENT.	
DIMENSIONS: mm [INCHES]	TOLERANCES UNLESS OTHERWISE SPECIFIED:
	0 PLC ± - 1 PLC ± - 2 PLC ± - 3 PLC ± 0.127[.005] 4 PLC ± - ± - ANGLES ± -
MATERIAL 3	FINISH 4

DWN NAGALAKSHMI K 30OCT2015
CHK ROHDE DANIEL 30OCT2015
APVD ROHDE DANIEL 30OCT2015
PRODUCT SPEC UL 486A-B
APPLICATION SPEC 114-2157
WEIGHT -
CUSTOMER DRAWING

TE Connectivity			
NAME TERMINAL RING TONGUE, PIDG WIRE SIZE : 16-14 AWG			
SIZE A3	CAGE CODE 00779	DRAWING NO C-130663	RESTRICTED TO -
SCALE 8:1		SHEET 1 OF 1	REV B