

SK1 Installation Guide

includes SK1-250-3 and SK1-400-3

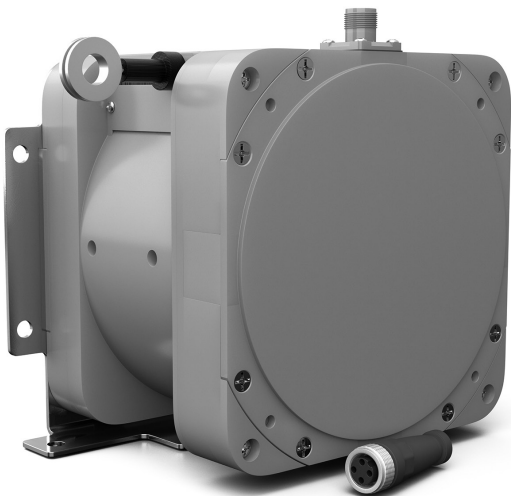

20630 Plummer Street • Chatsworth, CA 91311
tel: 800.423.5483 • +1.818.701.2750

Electrical Connection

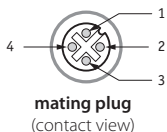

Pin#	Description
1	- +in
2	- common
3	- +out
4	- n/c

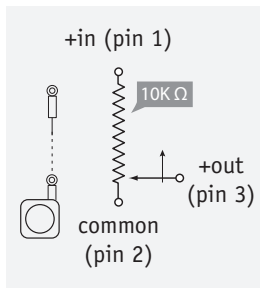

optional cordset
#9036810-0040

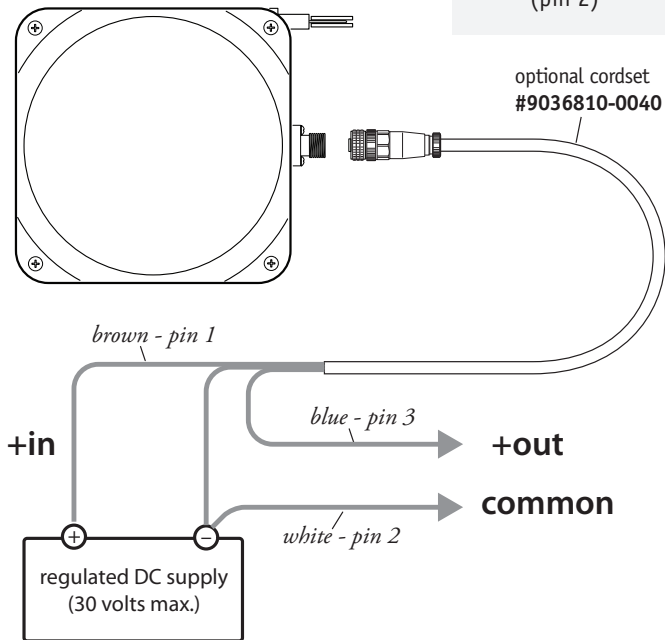

Outline Drawing (top view)

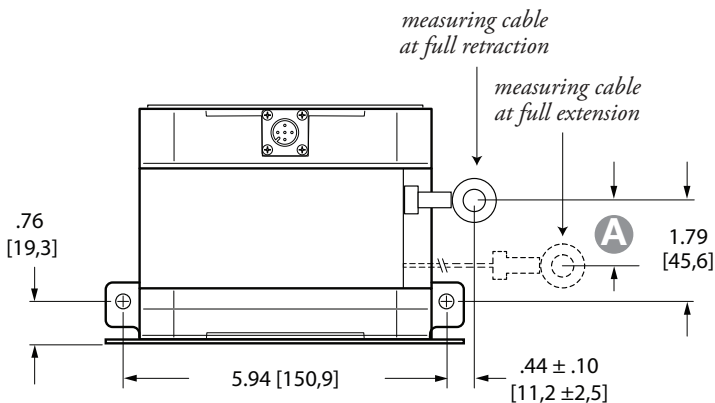

STROKE RANGE	A
250 in.	.62 [16]
400 in.	.99 [25]

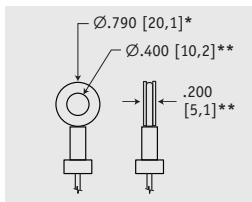

DIMENSIONS ARE IN INCHES [MM]
tolerances are 0.04 IN. [1,0 MM] unless otherwise noted.

* tolerance = +.005 -.001 [+0,1 -0,0]

** tolerance = +.005 -.005 [+0,1 -0,1]

Outline Drawing (side & front view)

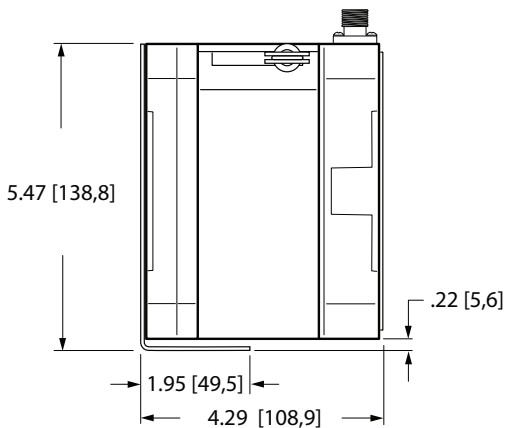
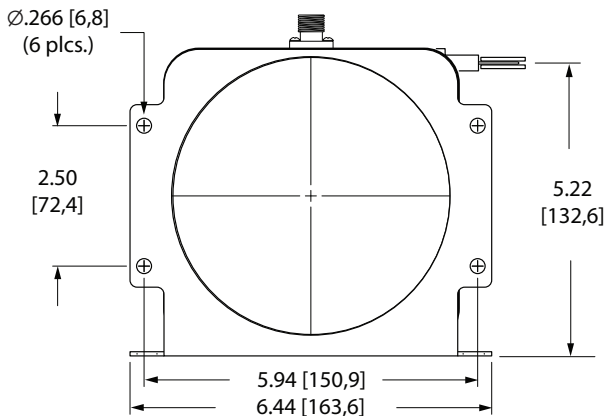

Mounting Options

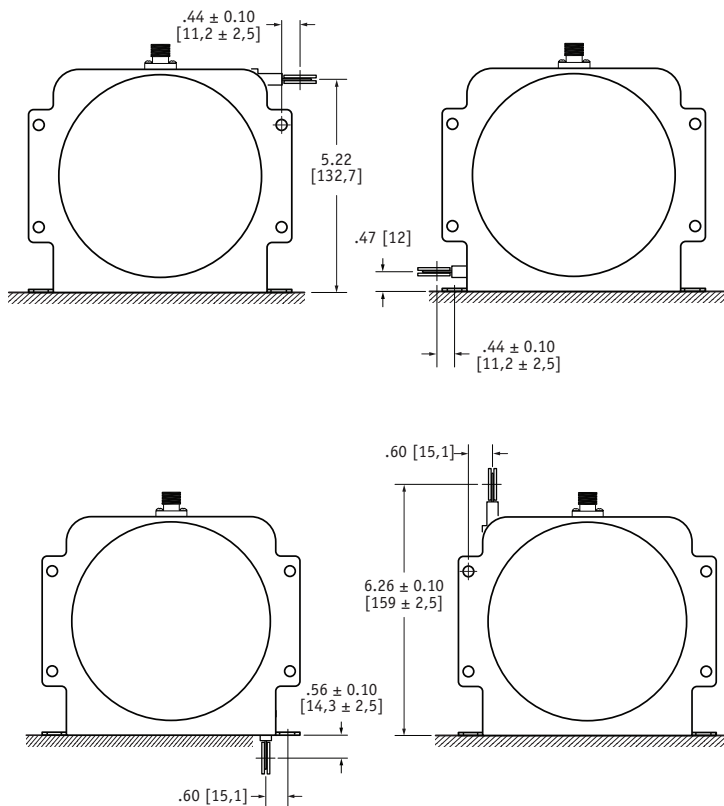

Changing Measuring Cable Exit

To change the measuring cable exit direction simply remove the 4 bracket mounting screws, rotate sensor body to desired direction and replace mounting screws.

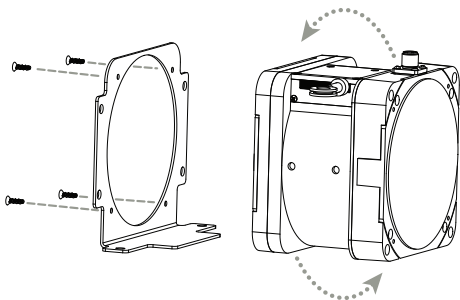

Changing Electrical Connector Orientation

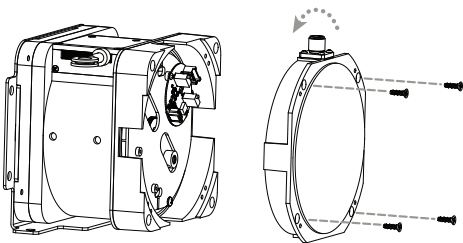

To change the direction of the electrical connector, remove the 4 rear screws and carefully remove the rear cover and rotate cover.

Specifications

Stroke Range Options	250 inches (6.4 m), 400 inches (10.2 m)
Output Signal	voltage divider (potentiometric)
Accuracy	.35% FS.
Repeatability	.05% FS.
Resolution	essentially infinite
Measuring Cable	.031-inch dia. bare stainless steel
Maximum Cable Velocity	60 inches per second
Maximum Cable Acceleration	5 g
Measuring Cable Tension	23 oz. (6.4 N) \pm 40%
Sensor	plastic-hybrid precision potentiometer
Input Resistance	10K ohms, \pm 10%
Power Rating, Watts	2.0 at 70°F
Recommended Maximum Input Voltage	30 V (AC/DC)
Sensitivity	940 \pm 40 mV/V
Cycle Life	\geq 250,000
Electrical Connection	4-pin M12 connector, mating plug included
Enclosure	glass-filled polycarbonate
Environmental	IP67
Operating Temperature	-40° to 185° F (-40° to 85° C)

