

Positioning the TPA

TE P/N	TRADE MARK DESCRIPTION
1599099-1	HOUSING ASS'Y 2 POSN. SENSOR FLAT, RCPT
1599099-2	HOUSING ASS'Y 2 POSN. SENSOR FLAT, RCPT
1480965-1	HOUSING ASS'Y 3 POSN. SENSOR FLAT, RCPT
1480968-1	HOUSING ASS'Y 4 POSN. SENSOR FLAT, RCPT
1480971-1	HOUSING ASS'Y 6 POSN. SENSOR FLAT, RCPT

This connector is supplied to the customer with Terminal Position Assurance (TPA) in pre-assembled position shown in Detail "A".

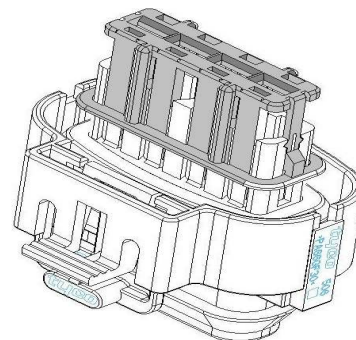

Detail "A" – Supplied with a preassembled TPA.

During shipping and handling, the TPA may be displaced to its locked position as shown in Detail "B". This can prevent proper contact insertion. The connector can be returned to proper function by retracting the TPA to position shown in Detail "A" above, using the following procedure:

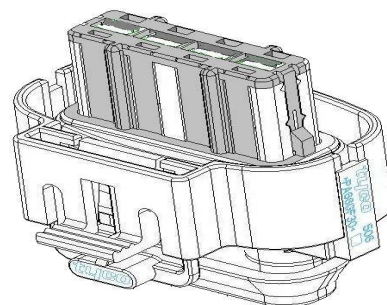

Detail "B" – Locked position of TPA.

Insert a small screwdriver or a similar tool and rotate to lift TPA slightly. Gently lift and push TPA until it locks into pre-lock position (Detail A), leaving a 4,5mm gap approximately as shown in Detail "C":

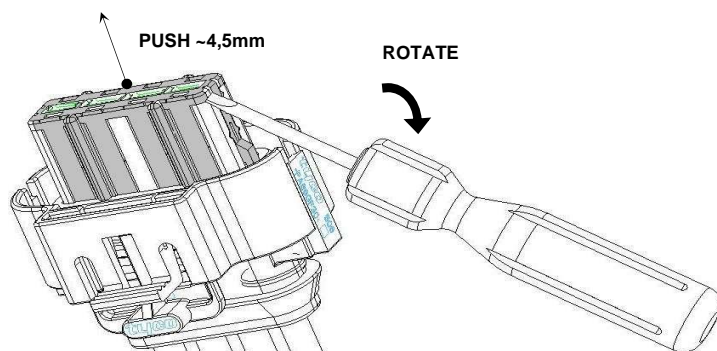

Detail "C"

Remarks : Refer to Details "B" and "C". Using care and moderate pressure will prevent damage to the connector components.

Revision Record					
Rev.	Date	Description	Edited	Checked	Approved
A	03-Jan-2012	Released	L. W. Prado	M. Rodrigues	J. Meneghin