

PROPER USE GUIDELINES

Cumulative Trauma Disorders can result from the prolonged use of manually powered hand tools. Hand tools are intended for occasional use and low volume applications. A wide selection of powered application equipment for extended-use, production operations is available.

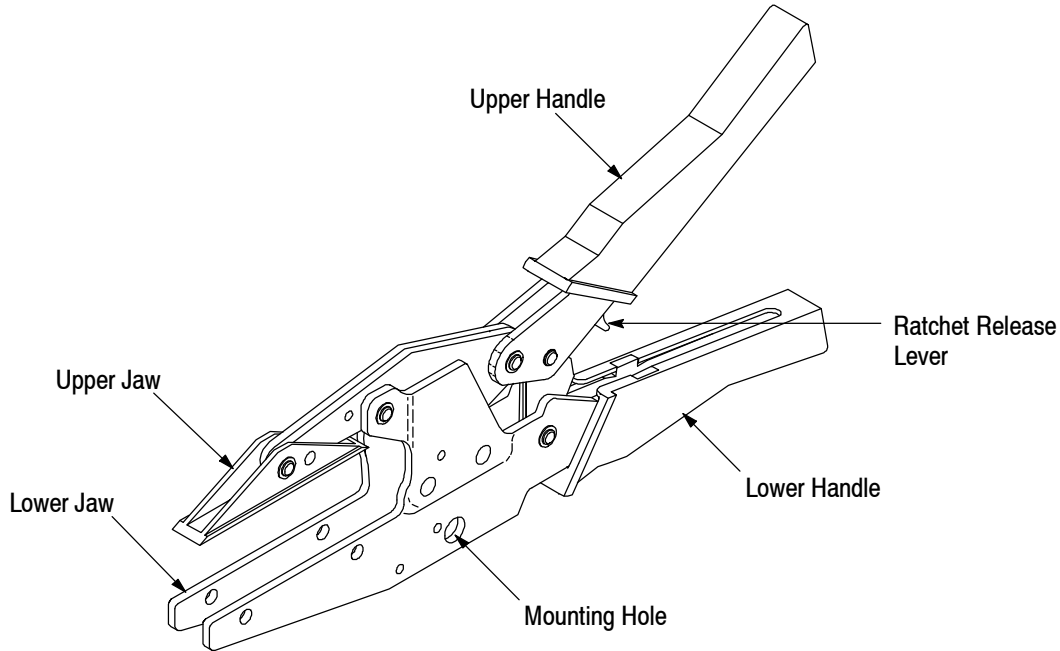

Figure 1

1. INTRODUCTION

Hand Tool Subassembly 768942-1 is used with Base Assembly Universal Hand Tool 768339-1 and various connector-specific kits to terminate AMP-LATCH low-profile connectors and CHAMP* latch low-profile connectors. For tooling installation procedures, cable requirements, and available connector-specific kits, refer to instruction sheet 408-9826 packaged with the base assembly universal hand tool.

The hand tool subassembly may be bench mounted using Bench Clamp Kit 543264-1 (available separately).

NOTE *Dimensions are in millimeters [and inches]. Figures are not drawn to scale.*

Reasons for reissue of this instruction sheet are provided in Section 6, REVISION SUMMARY.

2. DESCRIPTION (Figure 1)

The hand tool subassembly consists of an upper jaw, lower jaw, upper handle, and lower handle. The jaws

accept the tooling described in Section 1. The handles are designed with a ratchet to assure complete termination of the connector. The ratchet will not release until the handles have been fully closed.

NOTE *In the event that a connector or cable is misaligned in the tooling and must be removed or re-adjusted, a release lever is provided on the upper handle which will allow the operator to disengage the ratchet.*

3. BENCH-MOUNTING PROCEDURE (Figure 2)

To mount the hand tool subassembly to a bench, proceed as follows:

1. Choose a flat surface at the edge of a 50-mm [2-in.] thick (maximum) bench.
2. Place the bench stand at the edge of the bench.
3. Position the hand tool subassembly in the bench stand, and align the mounting hole with the slot at the top of the bench stand.
4. Place the clamp post through the bench stand and hand tool subassembly, then tighten the clamp.

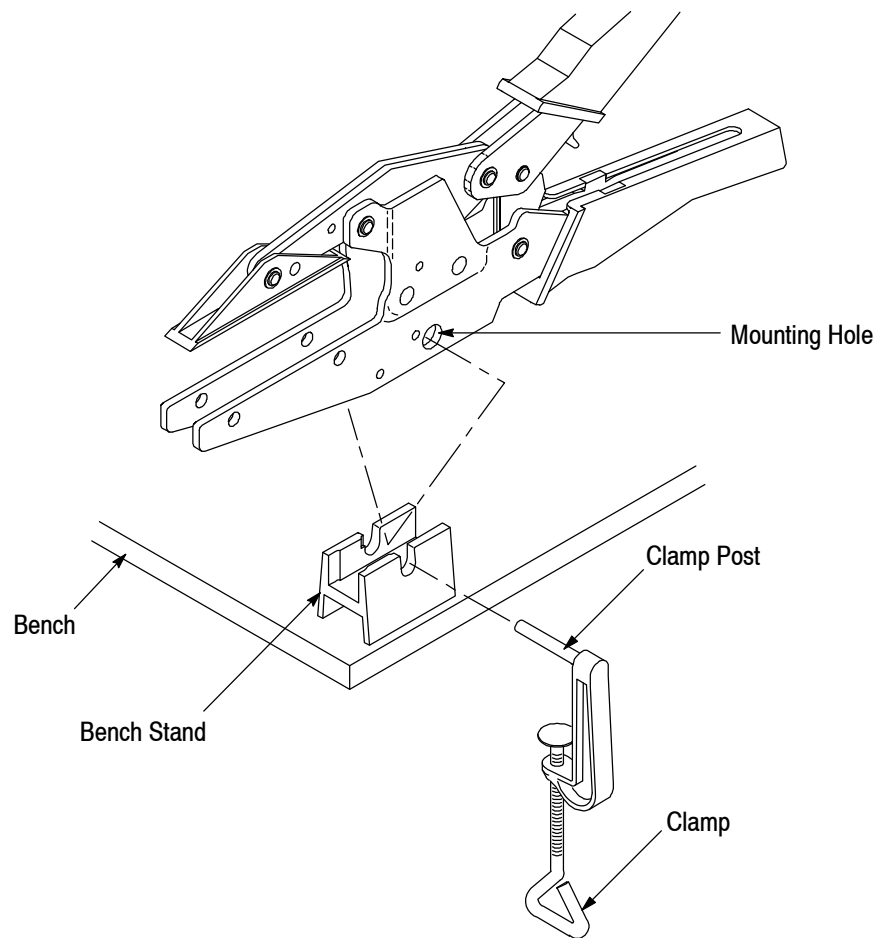

Figure 2

4. MAINTENANCE AND INSPECTION

Keep the hand tool subassembly clean with a clean, soft, lint-free cloth or a clean, soft brush. When not in use, store the hand tool subassembly in a clean, dry area.

It is recommended that the hand tool subassembly be inspected immediately upon arrival and at regularly-scheduled intervals thereafter to ensure that the hand tool subassembly has not been damaged during handling or use.

5. REPLACEMENT

Order replacement tools through your representative, or call 1-800-526-5142, or send a facsimile of your purchase order to 717-986-7605, or write to:

CUSTOMER SERVICE (038-035)
TYCO ELECTRONICS CORPORATION
PO BOX 3608
HARRISBURG PA 17105-3608

6. REVISION SUMMARY

Revisions to this instruction sheet include:

- Updated instruction sheet to corporate requirements