

1. INTRODUCTION

AMP Spool Kit 217435-1 consists of a spool return spring, two seals, and a spool valve end cap with an O-ring. These components are used to replace the worn components on AMP "6-26" Pneumatic Tooling Assembly 189721-1 (hand-actuated system without logic). For detailed information concerning the pneumatic tooling assembly, refer to AMP Customer Manual 409-5862.

NOTE

Kit components are not available separately. The table below lists manufacturer's part numbers.

2. ASSEMBLY PROCEDURE

1. DISCONNECT PNEUMATIC TOOL FROM MAIN AIR SUPPLY.
2. Remove the retaining screw on the end of the tool switch lever. Slide the pivot base until the end of the switch lever clears the hole in the top of the spool valve.
3. Push the spool assembly from the hole in the top of the spool valve until it falls out of the bottom.

4. Remove the spool return spring and seals from the spool assembly and discard; replace with the components from the spool kit. Remove the spool valve end cap with the O-ring from the hole in the top of the spool valve. Slide the new O-ring onto the new end cap, then push the end cap into the hole in the top of the spool valve.

5. Apply a thin coat of Dow Corning 55 Lubricant motor oil to the spool assembly.

6. Push the spool assembly (threaded end first) into the hole in the bottom of the spool valve until it butts against the end cap. Be sure the spool return spring is in position as shown below.

7. Slide the pivot base until the hole in the end of the switch lever is over the end cap. Replace the retaining screw.

8. Connect the pneumatic tool to the main air supply. Actuate the pneumatic tool to ensure proper operation.

DANGER

When tool is connected to main air supply, the piston will retract; when tool is actuated, piston will extend. To avoid personal injury, keep hands and fingers away from the front of the tool.

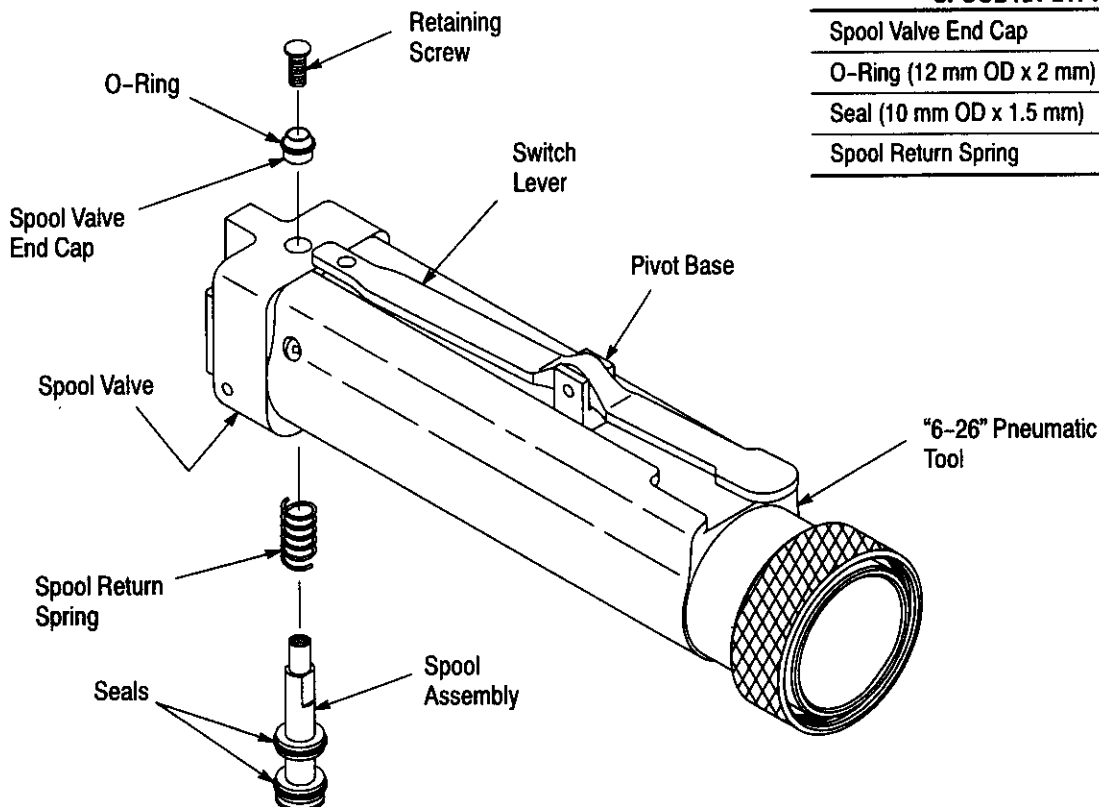

SPOOL KIT 217435-1

Spool Valve End Cap	Q3073A1W10D
O-Ring (12 mm OD x 2 mm)	HyD 8x2
Seal (10 mm OD x 1.5 mm)	PSD-10
Spool Return Spring	LC029E2MW