

## 1. INTRODUCTION

This instruction sheet provides mating and unmating procedures for the 96-Position GPEC II Sealed Connector System.

The connector system is pre-assembled and consists of a wire dress and a plug assembly with contacts. This plug assembly mates with a printed circuit board header assembly.

### NOTE



Figures and illustrations are not to scale and are for reference only. Wires not shown in figures for clarity.

## 2. ASSEMBLY PROCEDURES

### NOTE



Refer to Instruction Sheet 408-10229 for Assembly Procedures for the 96-Position GPEC II Sealed Connector Assembly.

### NOTE



The connector assembly is color keyed. The TPA color must match the header shroud color. Gray, tan, and brown are available. See the customer drawing for specific part numbers.

1. The connector assembly is received in the shipped position as shown in Figure 1A.

2. Depress locking mechanism to release locking lever as shown in Figure 1B. Rotate locking lever to the upright position. See Figure 1B.

### NOTE



An audible and tactile “click” will be heard and felt when the locking lever reaches the unlocked position.

### NOTE



The wire dress lever cannot be rotated once in the open position unless it is seated in the header assembly. Once seated in the header assembly, the side latches will be released to allow mating to the header assembly.

3. Align the plug and wire dress assembly with the header assembly by locating and aligning the polarization features designed in the housings. Refer to Figures 1C and 1D.

4. Push straight down on the wire dress assembly until an audible and tactile “click” is heard and felt. Then rotate the locking lever until it snaps into place. Pull up on lever to ensure it has been fully locked. The connector assembly is now complete. See Figure 1E.

## 3. UNMATING PROCEDURES

1. Push the release mechanism and rotate the wire dress locking lever.

2. Pull wire dress assembly straight up from header assembly.

## 4. REVISION SUMMARY

- Initial release of document

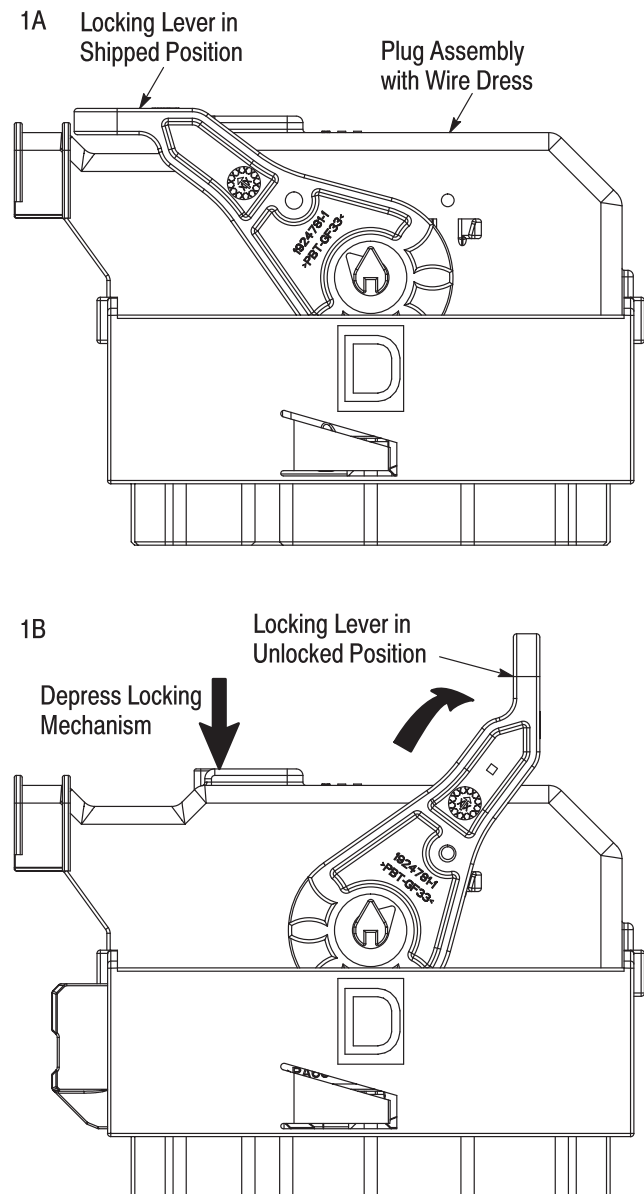
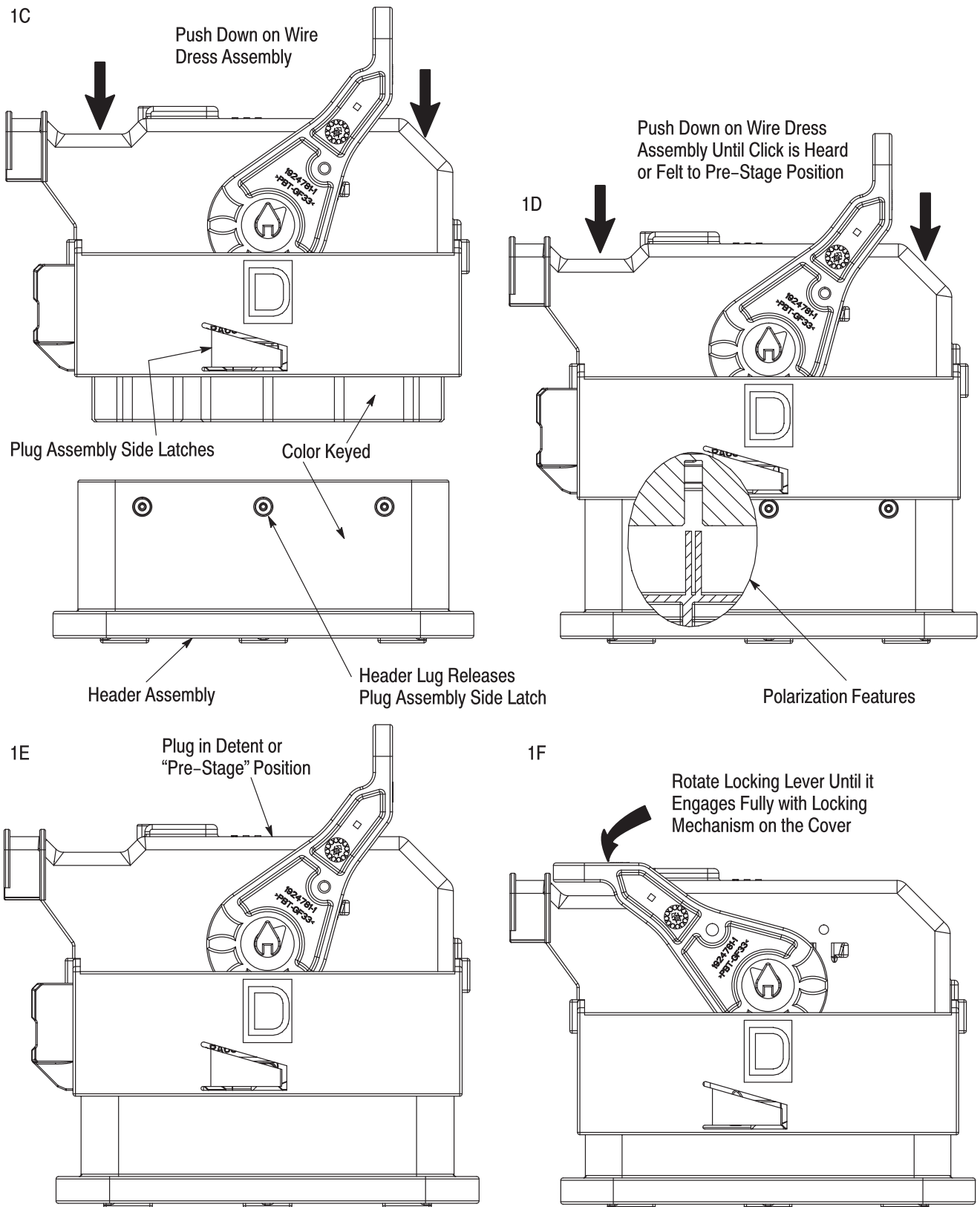

Figure 1 (cont'd)



Three Header Shroud Lugs Should be Hidden from View when Plug is Fully in Pre-Stage Position

Figure 1 (end)