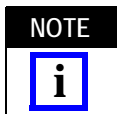

Figure 1

1. INTRODUCTION

CPC Series 45 Shielded Pass-Through Receptacle Kit 1986172-1 is designed for use in harsh environments. The receptacle engages with CPC shielded or unshielded plugs.

This receptacle kit is designed for front or rear panel-mount applications.



Instruction sheet 408-8951 provides assembly and engagement instructions for the plugs.

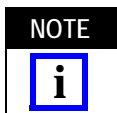

Dimensions in this instruction sheet are in metric units [with U.S. customary units in brackets]. Figures and illustrations are for reference only and are not drawn to scale.

2. DESCRIPTION

This receptacle kit consists of the components shown in Figure 1.

3. ASSEMBLY PROCEDURE

1. Align the locking tab of the coupler (mating face first) with the wide slot at the back (large diameter end) of the receptacle assembly. Depress the locking tab, and insert the coupler into the receptacle assembly until there is an audible "click." See Figure 2, Detail A.
2. Fit the flange seal over the mating face (small diameter end) of the receptacle assembly (for back panel mount) or the back of the receptacle assembly (for front panel mount) until it is flat against the flange. Make sure that the mounting holes align. See Figure 2, Detail B.

Assembling Receptacle Kit

Detail A

RJ45 In-Line Coupler Seated in Receptacle Assembly

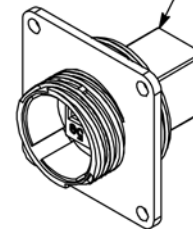

Detail B

Flange Seal Flat Against Flange of Receptacle Assembly (Shown Installed for Front Panel Mount)

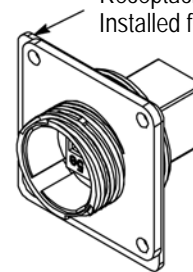

Figure 2

3. Cut the panel using the dimensions provided in Figure 3.

4. Insert the receptacle assembly into the panel until the flange seal is flat against the panel. See Figure 4.

5. Thread four No. 4 screws into the mounting holes, and tighten until secure.

Recommended Panel Cutout

Maximum Panel Thickness: 3.18 mm [.125 in.]

Note: Not to Scale

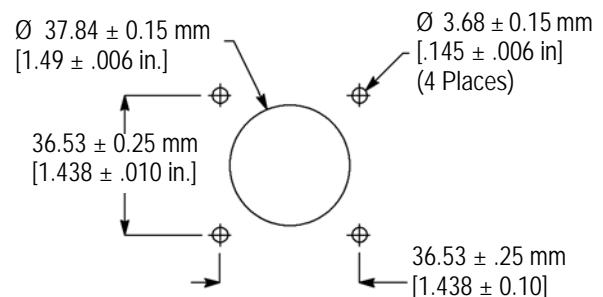

Figure 3

Panel Mounting

Note: Front Panel Mount Shown

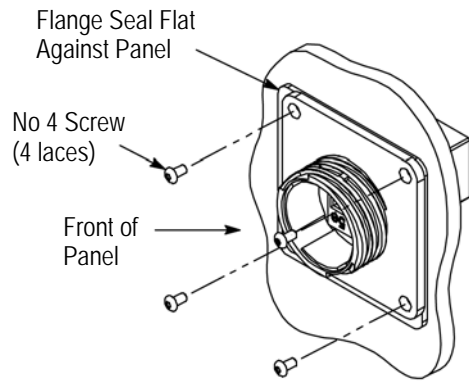

Figure 4

4. REPLACEMENT AND REPAIR

Components of the receptacle kit are not repairable. DO NOT use defective or damaged components.

5. REVISION SUMMARY

Since the previous release of this document, the new company logo was applied.