



40A MM crimp contact instruction

Table of contents

1.1	Prepare the crimp contact	2
1.2	Prepare the wire	3
1.3	Crimping the contact	4

1.1 Prepare the crimp contact

Pin contact is applicable to the conductor cross-sectional area: 1.0 mm² ~10.0 mm²

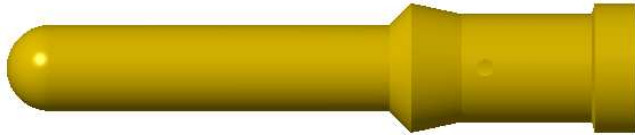

MM pin contact part number		Wire guage	
Silver plating	Gold plating	mm ²	AWG
T2040001010-000	T2040011010-000	1.0	18
T2040001015-000	T2040011015-000	1.5	16
T2040001025-000	T2040011025-000	2.5	14
T2040001040-000	T2040011040-000	4.0	12
T2040001060-000	T2040011060-000	6.0	10
T2040001100-000	T2040011100-000	10.0	8

Socket contact is applicable to the conductor cross-sectional area: 1.0 mm² ~10.0 mm²



MM socket contact part number		Wire guage	
Silver plating	Gold plating	mm ²	AWG
T2040002010-000	T2040012010-000	1.0	18
T2040002015-000	T2040012015-000	1.5	16
T2040002025-000	T2040012025-000	2.5	14
T2040002040-000	T2040012040-000	4.0	12
T2040002060-000	T2040012060-000	6.0	10
T2040002100-000	T2040012100-000	10.0	8

1.2 Prepare the wire

Stripping the wire per the below:

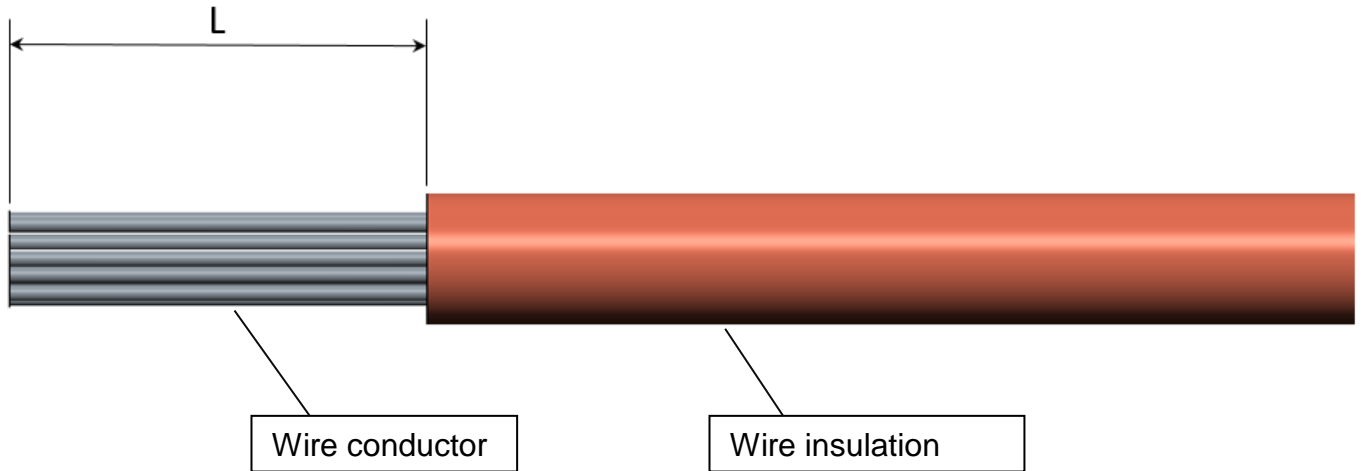
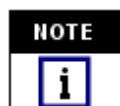

Table 1: Strip length for MM pin contact

Conductor cross-section (mm ²)	L : strip length (mm)
1.0	9.2 ^{+/-0.5}
1.5	9.2 ^{+/-0.5}
2.5	9.2 ^{+/-0.5}
4.0	9.2 ^{+/-0.5}
6.0	9.2 ^{+/-0.5}
10.0	9.2 ^{+/-0.5}

Table 2: Strip length for MM socket contact

Conductor cross-section (mm ²)	L : strip length (mm)
1.0	9.2 ^{+/-0.5}
1.5	9.2 ^{+/-0.5}
2.5	9.2 ^{+/-0.5}
4.0	9.2 ^{+/-0.5}
6.0	9.2 ^{+/-0.5}
10.0	9.2 ^{+/-0.5}



When stripping the wire, care must be taken to avoid scraping, nicking, or cutting the conductor.

1.3 Crimping the contact

1.3.1 Insert the wire into the wire barrel of pin contact or socket contact up to the stripping length.

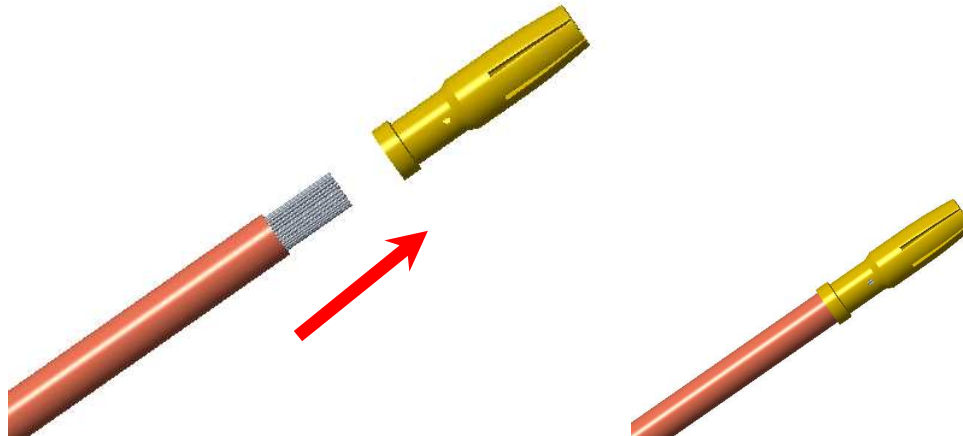
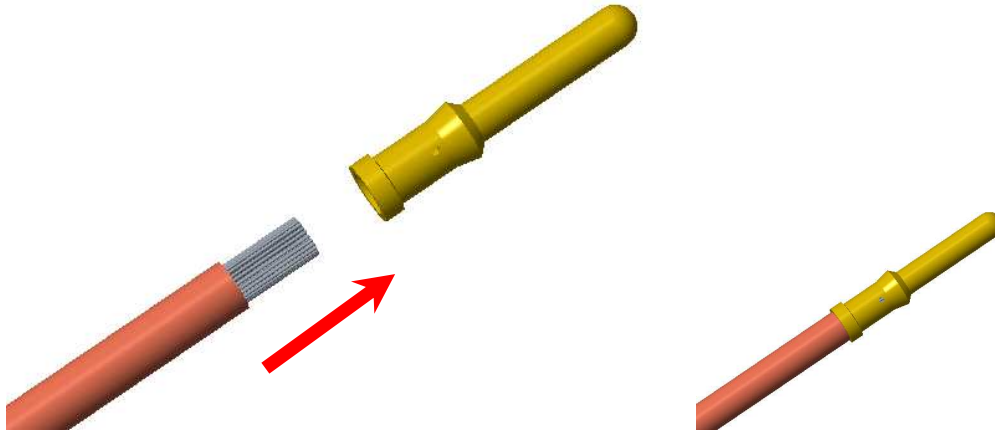

Fully insert wire into barrel

1.3.2 Put the contact into crimping tool, then crimp the contact. When crimping the contact, need to make sure the crimp tool fully press, then open the crimp tool and crimp the other contact.



NOTE



a. contact should be put the right position for crimping.

1.0/1.5/2.5 mm² crimp tool: T310000001-000 CRIMPBOX-0.5/4



4.0/6.0/10.0 mm² crimp tool: T3100001001-000 CRIMPBOX-4.0/10.0

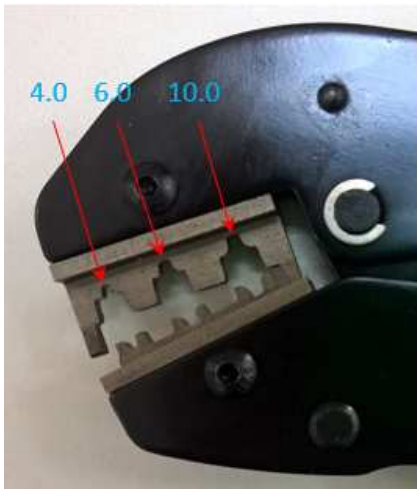

b. The right crimp area per the below crimp position:

MM pin contact: conductor cross-section 1.0 mm² ~10.0 mm²

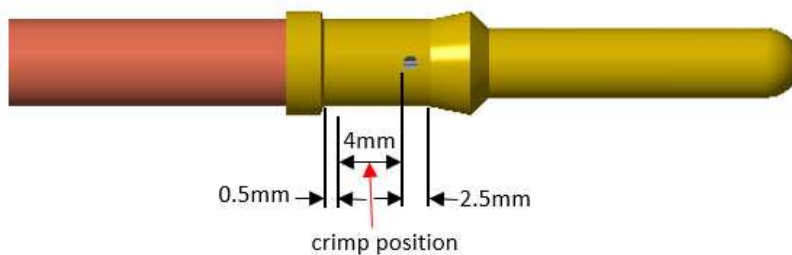

After crimping



MM socket contact: conductor cross-section 1.0 mm² ~10.0 mm²

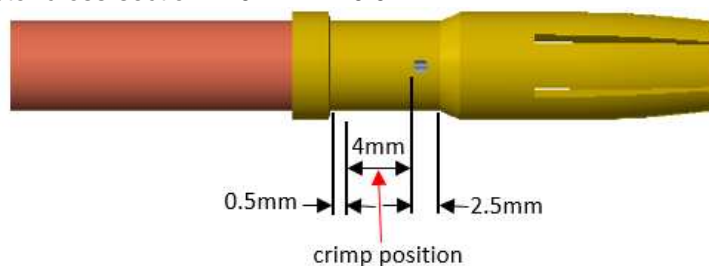

After crimping



c. after crimping, observe the wire conductor by observation hole.



after crimping, observe the wire conductor by observation hole.



-----END-----