



Packaging Requirements For DYNAMIC D1000_ TAB HOUSING

1. SCOPE

This specification covers the applicable packaging materials and procedures for packaging of the part numbers as below:

Part Number	Description
1-1903130-6	Dynamic D1200D, TAB Housing, 12Pos, X key, Black
2-1903130-6	Dynamic D1200D, TAB Housing, 12Pos, Y key, Black
1-2468186-3	Dynamic D1100D, TAB Housing, 26Pos, X key, Black
1-2350416-0	Dynamic D1100D, TAB Panel Housing, 40Pos, X key, Black

2. REFERENCE DOCUMENTS

Document Number	Description
107-24	Standard Packaging, Packing Marking and Palletizing Methods
115-59	Requirements for Electrostatic Protective Packaging Material
TEC-07-03	Product Packaging
TEC-107-224	Global packaging guidelines
TEC-107-115	Packaging and Marking Requirements for Global TE Connectivity Companies, Freight Forwarders, 3rd Party Logistics (3PL's) and Suppliers
TEC-202-37	Marking Guidelines for Product and Packaging
TEC-207-1	Definitions

3. MATERIALS

Part Number	Poly Bag	Foam	Box	Air Cap Sheet	Label	Shipping Box
1-1903130-6	9-720996-2	720992-1	912013-2	720992-1	999639	1-912011-4
2-1903130-6	9-720996-2	720992-1	912013-2	720992-1	999639	1-912011-4
1-2468186-3	9-720996-2	720992-1	912013-2	720992-1	999639	1-912011-4
1-2350416-0	9-720996-2	720992-1	912013-2	720992-1	999639	1-912011-5

4. PACKAGING STEPS

4.1. Preparation

4.1.1. Set up shipping box, close bottom with adhesive tape.

4.2. Steps

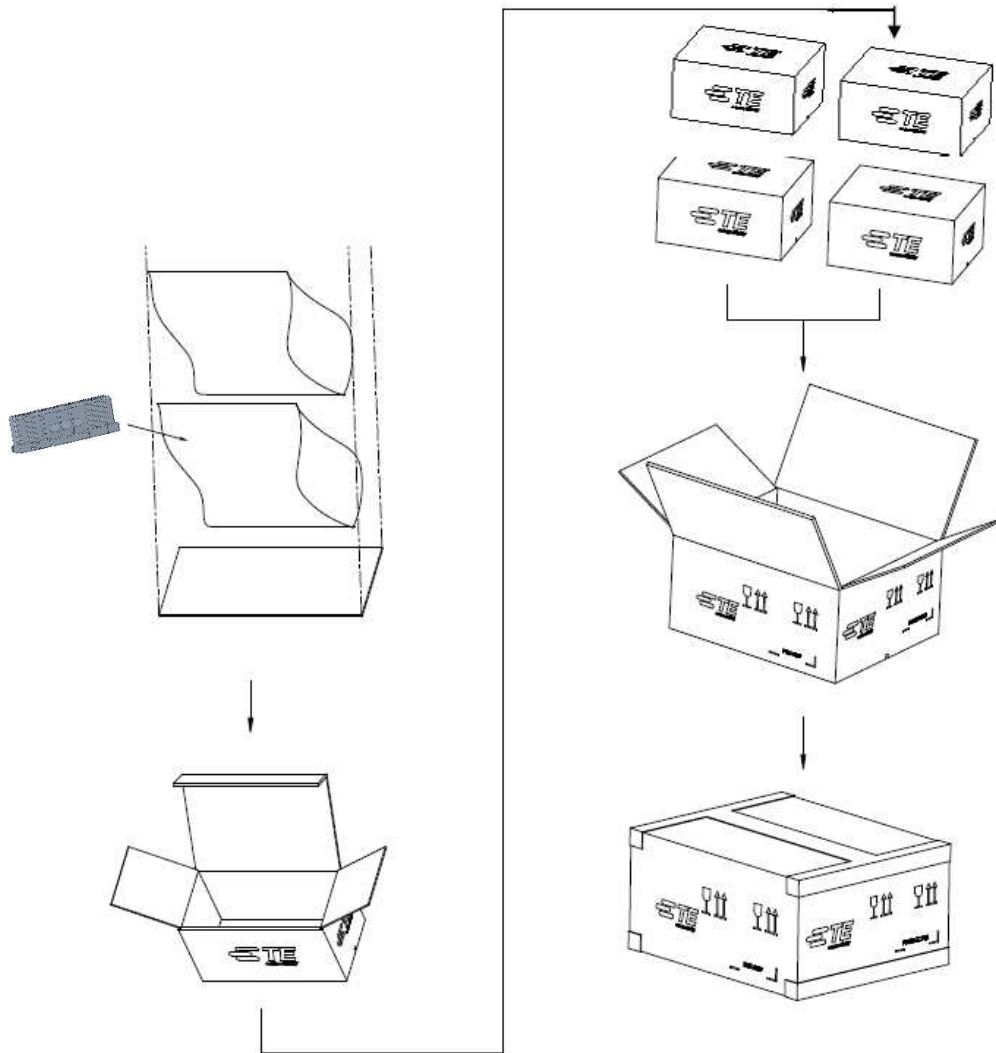

Step 1: Put the urethane foam on the bottom of inner box.

Step 2: put the housing into the poly bag, and heat sealing the bag, quantity as the table below shown.

Step 3: Put the bag into the box (Reference 5. Package quantity) , and cover with air cap sheet, then close the box.

Step 4: Put the box into the shipping box (Reference 5. Package quantity), and sealing the tape with adhesive tape.

5. PACKAGE QUANTITY

Part Number	Q'ty / Bag	Q'ty / Box	Q'ty / Shipping Box	Remark
1-1903130-6	300	600	2400	Box: 359L*309W*318H Ref
2-1903130-6	300	600	2400	Box: 359L*309W*318H Ref
1-2468186-3	100	400	1600	Box: 359L*309W*318H Ref
1-2350416-0	70	210	420	Box: 360L*307W*162H Ref

6. REVISION HISTORY

Revision	Description	Date
Rev. A	Initial Release	2023-10-26
Rev. B	Add New P/N	2023-11-14