



Packaging Requirements For DYNAMIC D1000_ REC HOUSING

1. SCOPE

This specification covers the applicable packaging materials and procedures for packaging of the part numbers as below:

Part Number	Description
1-2349949-2	Dynamic D1200D, REC Housing, 4Pos, X key, Black
2-2349949-6	Dynamic D1200D, REC Housing, 12Pos, Y key, Black
1-2333149-0	Dynamic D1100D, REC Housing, 20Pos, X key, Black
1-2333134-3	Dynamic D1100D, REC Housing, 26Pos, X key, Black
1-2333134-4	Dynamic D1100D, REC Housing, 28Pos, X key, Black
1-2333134-5	Dynamic D1100D, REC Housing, 30Pos, X key, Black
1-2333134-7	Dynamic D1100D, REC Housing, 34Pos, X key, Black
1-2349949-4	Dynamic D1200D, REC Housing, 8Pos, X key, Black
1-2349949-0	Dynamic D1200D, REC Housing, 20Pos, X key, Black

2. REFERENCE DOCUMENTS

Document Number	Description
107-24	Standard Packaging, Packing Marking and Palletizing Methods
115-59	Requirements for Electrostatic Protective Packaging Material
TEC-07-03	Product Packaging
TEC-107-224	Global packaging guidelines
TEC-107-115	Packaging and Marking Requirements for Global TE Connectivity Companies, Freight Forwarders, 3rd Party Logistics (3PL's) and Suppliers
TEC-202-37	Marking Guidelines for Product and Packaging
TEC-207-1	Definitions

3. MATERIALS

Part Number	Poly Bag	Foam	Box	Air Cap Sheet	Label	Shipping Box
1-2349949-2	9-720996-2	720992-1	912013-2	720992-1	999639	1-912011-4
2-2349949-6	9-720996-2	720992-1	912013-2	720992-1	999639	1-912011-4
1-2333149-0	9-720996-2	720992-1	912013-2	720992-1	999639	1-912011-4
1-2333134-3	9-720996-2	720992-1	912013-2	720992-1	999639	1-912011-4
1-2333134-4	9-720996-2	720992-1	912013-2	720992-1	999639	1-912011-4
1-2333134-5	9-720996-2	720992-1	912013-2	720992-1	999639	1-912011-4
1-2333134-7	9-720996-2	720992-1	912013-2	720992-1	999639	1-912011-4
1-2349949-4	9-720996-2	720992-1	912013-2	720992-1	999639	1-912011-4
1-2349949-0	9-720996-2	720992-1	912013-2	720992-1	999639	1-912011-4

4. PACKAGING STEPS

4.1. Preparation

4.1.1. Set up shipping box, close bottom with adhesive tape.

4.2. Steps

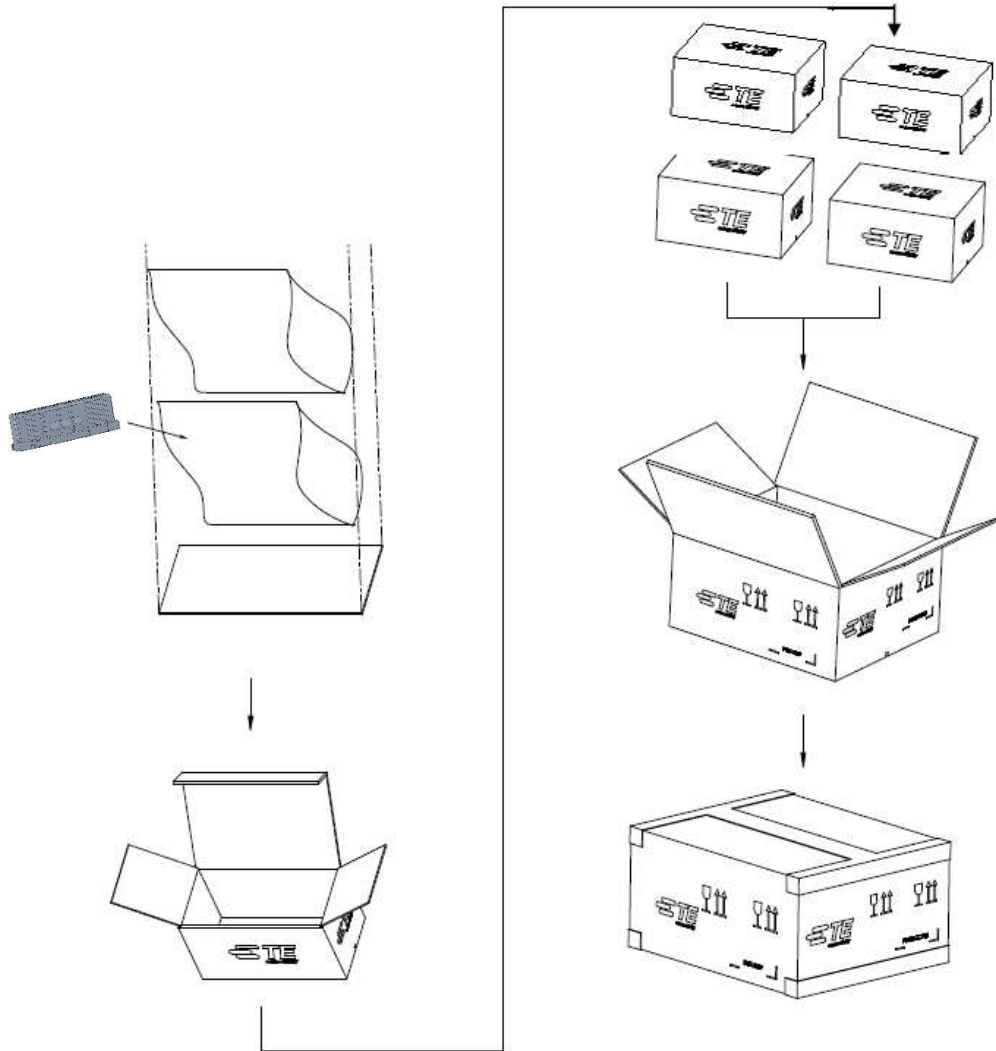

Step 1: Put the urethane foam on the bottom of inner box.

Step 2: put the housing into the poly bag, and heat sealing the bag, quantity as the table below shown.

Step 3: Put the bag into the box (Reference 5. Package quantity) , and cover with air cap sheet, then close the box.

Step 4: Put the box into the shipping box (Reference 5. Package quantity) , and sealing the tape with adhesive tape.

5. PACKAGE QUANTITY

Part Number	Q'ty / Bag	Q'ty / Box	Q'ty / Shipping Box	Remark
1-2349949-2	800	1600	6400	Box: 359L*309W*318H Ref
2-2349949-6	400	800	3200	Box: 359L*309W*318H Ref
1-2333149-0	150	600	2400	Box: 359L*309W*318H Ref
1-2333134-3	100	600	2400	Box: 359L*309W*318H Ref
1-2333134-4	100	600	2400	Box: 359L*309W*318H Ref
1-2333134-5	100	500	2000	Box: 359L*309W*318H Ref
1-2333134-7	100	500	2000	Box: 359L*309W*318H Ref
1-2349949-4	500	1000	4000	Box: 359L*309W*318H Ref
1-2349949-0	100	400	1600	Box: 359L*309W*318H Ref

6. REVISION HISTORY

Revision	Description	Date
Rev. A	Initial Release	2023-10-26
Rev. B	Add New P/N	2023-11-14