

PART NUMBER	REV	DESCRIPTION	FIRST USED
2510896-1	A	SRC APPLICATOR UNIT, MID FORCE - LP	2348822-1] REVISIONS D AND HIGHER ONLY

REVISIONS				
P	LTN	DESCRIPTION	DATE	APVD
1		DEVELOPMENT	23FEB2023	LS MP
2		REVISED	14SEP2023	JL YY
3		REVISED	02JAN2024	JL YY
A		RELEASED	31JAN2024	JL YY

- DETAILED INFORMATION TO FIND ON ASSEMBLY DRAWINGS.
- TORQUE RECOMMENDATIONS PER 101-35000 UNLESS OTHERWISE SPECIFIED.
- RECOMMENDED TERMINATOR:
 HV-20 TERMINATOR
 TCPN 2348822-1 OR 2348822-2
 *ONLY TO USE WITH BASE PLATE ASSEMBLY,
 TCPN 2384466-4.

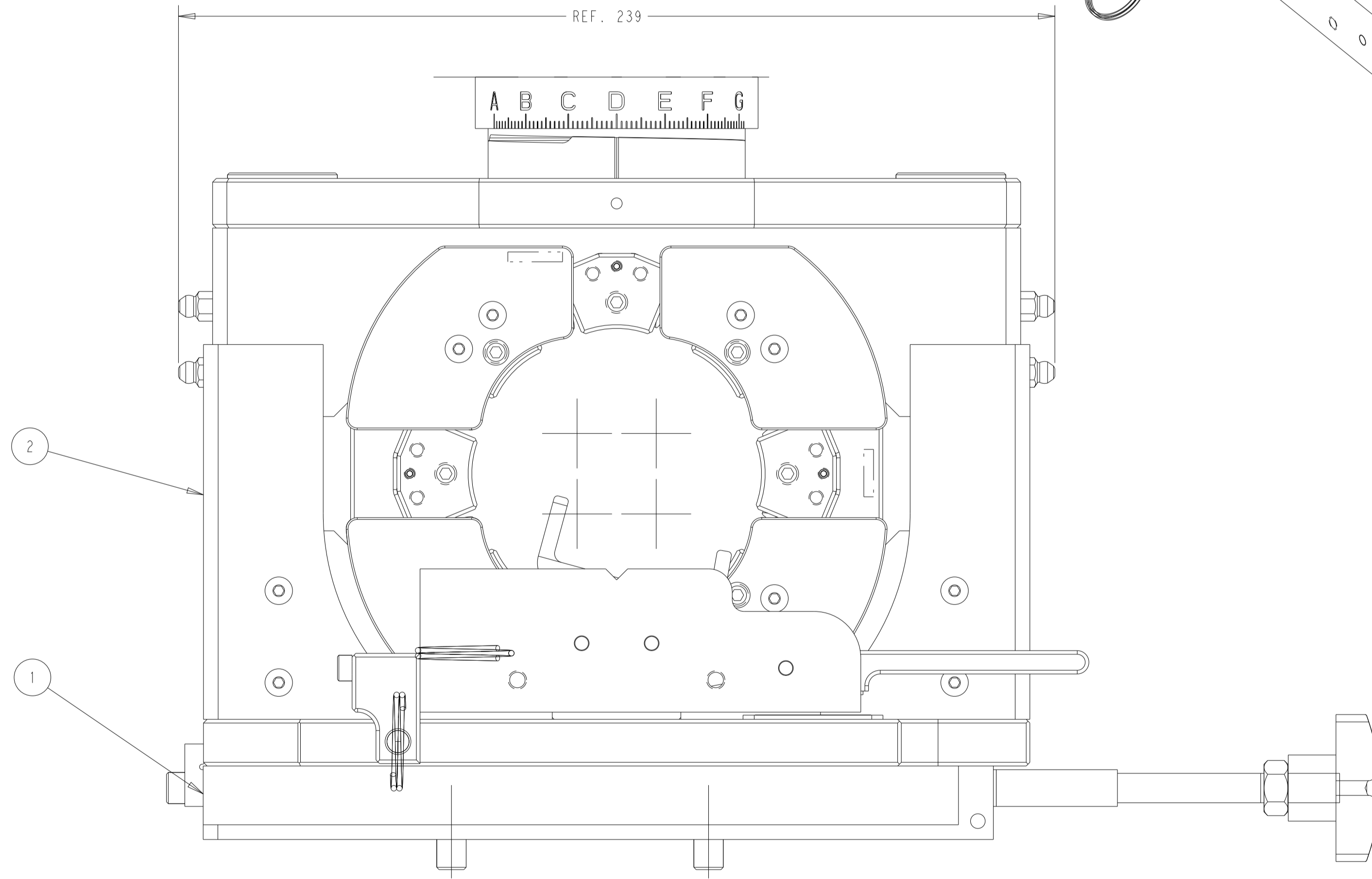
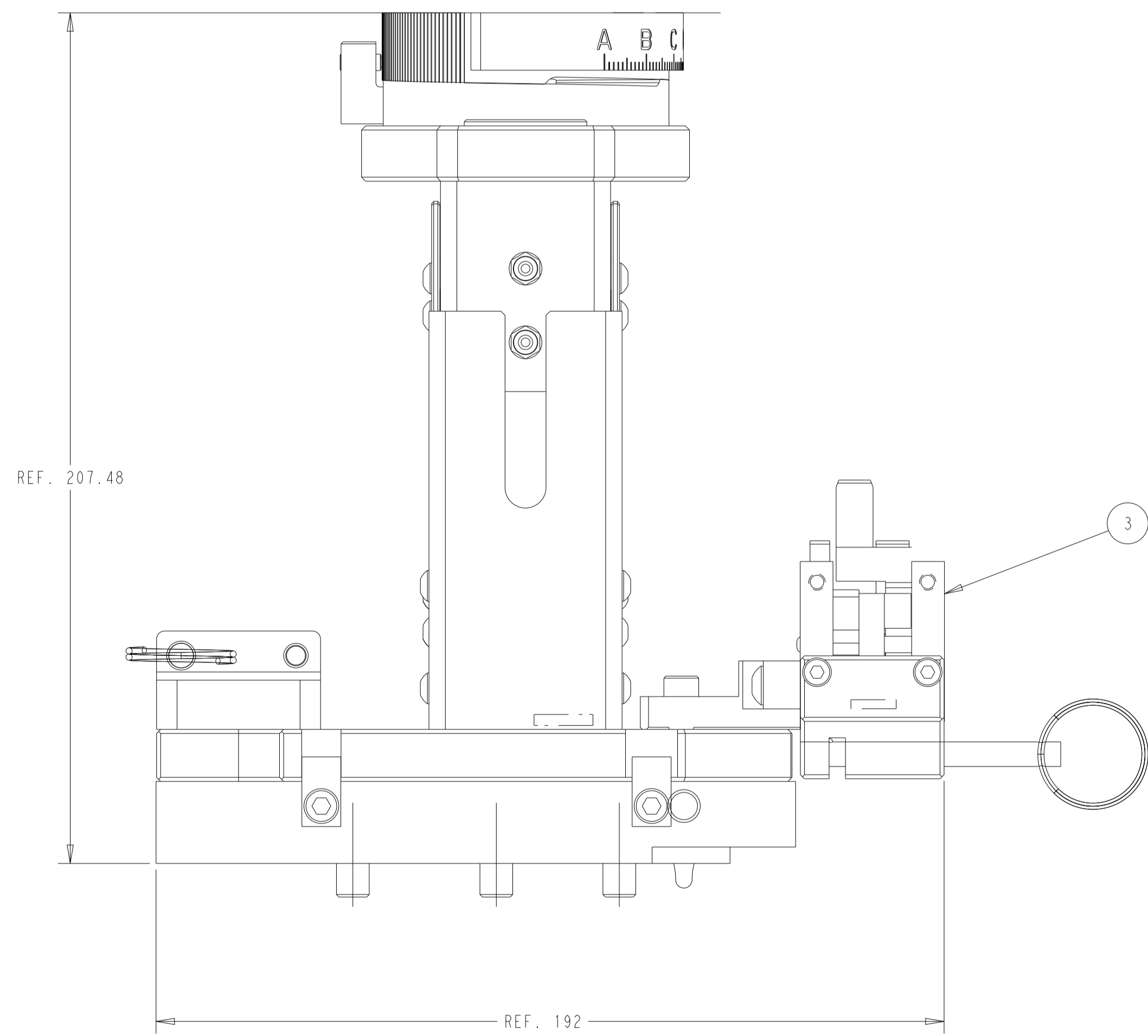
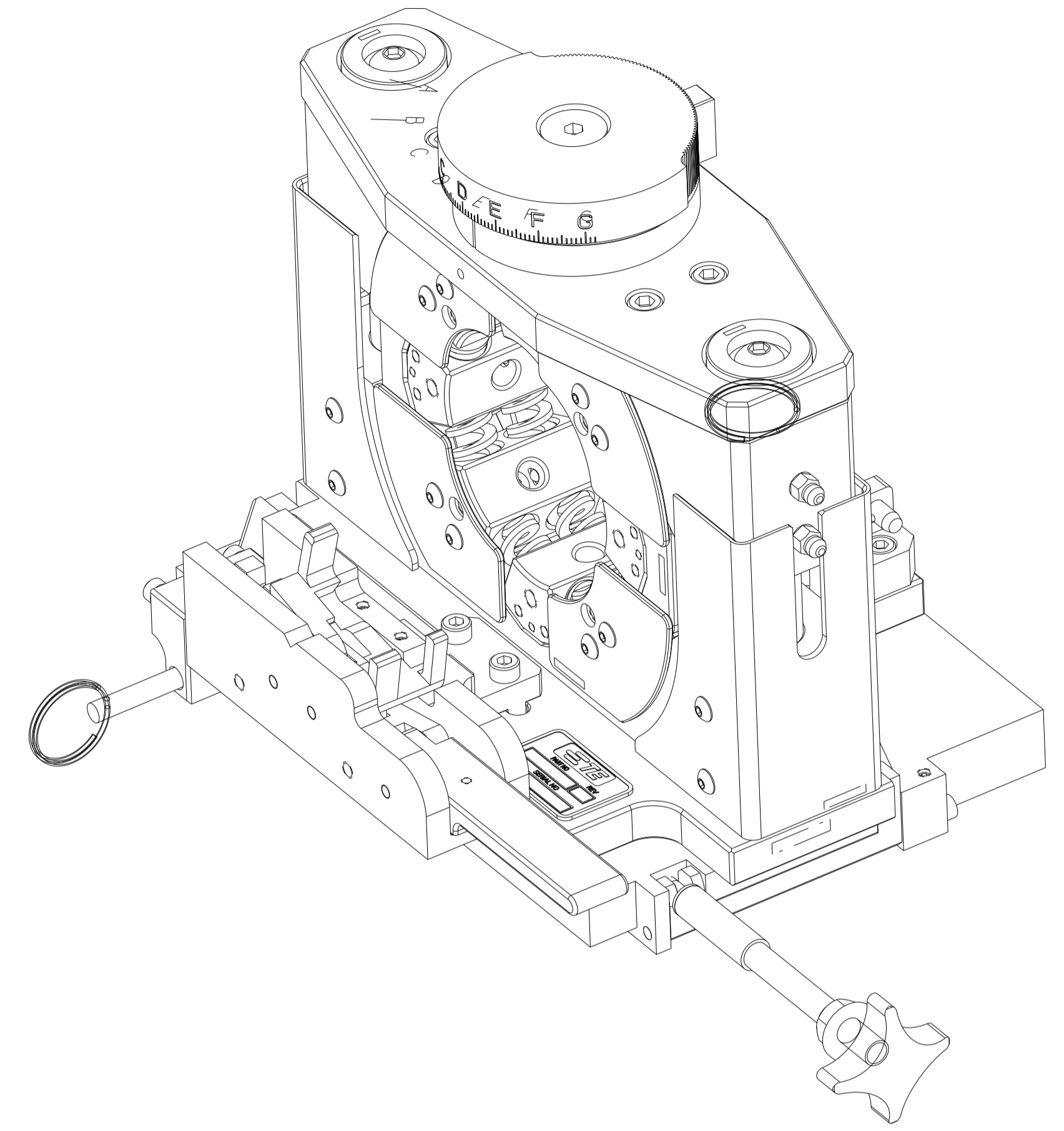

1	-	2364330-5	CABLE CLAMP	3
1	-	2440896-1	SRC APPLICATOR, MID FORCE - LP	2
1	-	2384466-4	BASE PLATE ASSEMBLY	1
- 1	U/M	PART NO	DESCRIPTION	ITEM NO

THIS DRAWING IS A CONTROLLED DOCUMENT.		OWN L. SANDHU 23FEB2023	TE Connectivity	
DIMENSIONS:		CHK L. SANDHU 23FEB2023	NAME SRC APPLICATOR UNIT, MID FORCE - LP	
TOLERANCES UNLESS OTHERWISE SPECIFIED:		APVD M. PAJUELO 23FEB2023	PRODUCT SPEC	
mm		APPLICATION SPEC		
0 PLC ±		SIZE		
1 PLC ±		CAGE CODE		
2 PLC ±		DRAWING NO		
3 PLC ±		RESTRICTED TO		
4 PLC ±		WEIGHT		
ANGLES ±		A 00779 C=2510896		
FINISH ±		CUSTOMER ACCESSIBLE PRODUCTION DRAWING		
		SCALE 1:1 SHEET 1 OF 1 REV A		