

# COMPACT POWER BLOCKS

ENTRELEC Terminal blocks

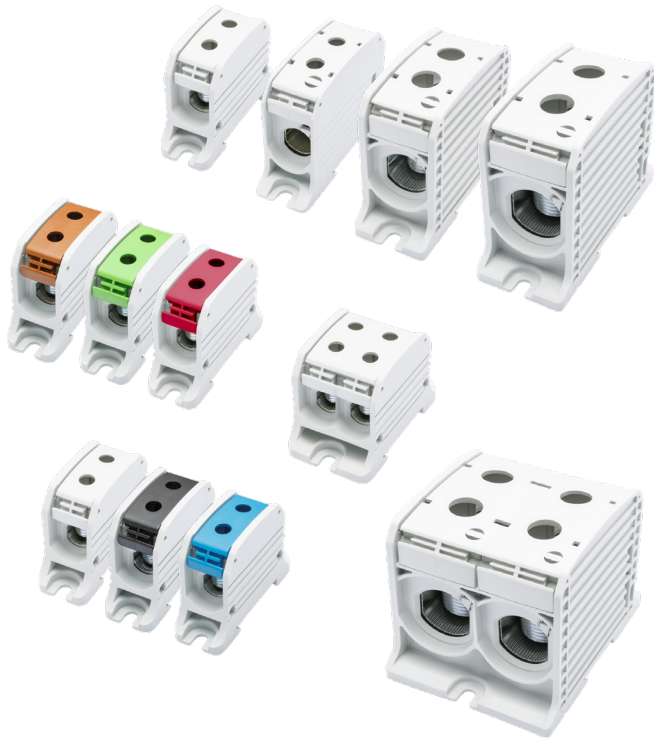

# THE COMPACT SECURED AND COST-EFFECTIVE SOLUTION FOR POWER CONNECTION.

The Compact Terminal Blocks cover a wide variety of applications from mechanical engineering, industrial equipment, automation to wind turbines, solar energy or switchgears. They offer cost, weight and space savings from optimized aluminum body and compact design.

The range offers connection capacity from 50 to 300 mm<sup>2</sup> and TS35 rail or panel mount.

## BENEFIT STATEMENTS

### Highly versatile

#### Large scope of conductors accepted

The aluminum body combined with specific coating allow the use of aluminum & copper conductors whether round or sector-shaped, solid, stranded or flexible with ferrule.

#### Modularity

- Available in 2 connection for power connection as well as 4 connections for power distribution purposes.
- Up to 6 colors for convenient phase identification purposes as per IEC/NEC wiring guidelines.

#### Easy monitoring or supply

Blocks from 95 to 300 mm<sup>2</sup> have an extra built-in measurement tapping connection to provide main supply monitoring or to provide supply to a control equipment.

### Secured and compact connection

#### Protection of connection process, conductor and the operator

- Hexagon drive with hex-wrenge for transmission of high torque moments.
- The fine pitch thread allows transmission of high torque moments.
- The turned screw ends prevent damage to the relatively soft aluminium conductor material on installation.
- Reinforced finger safe and dust protection by side cover when block is not wired.

#### Reduced oxidation risks

- Specific coating reduces oxidation risks with aluminum or copper conductors.
- Push-through plastic protection keep conductors from touching in the middle.

### Easy to install and use

#### Compact and firm grip

The compact body combines easy snap-on the rail with high and firm grip after being installed. Low drift firm body & cover keeps good alignment even under high torque and cable weight.

#### Light weight body

The aluminum body offers a lightweight product easier to stock & install.

#### Two mounting options

All blocks can be mounted on mounting plates or TS 35 rails according to IEC 60715 / DIN EN 50022.

#### Easy identification

The large area on top cover of the block allow easy identification with standard or custom labels.

## KEY FEATURES

- Screw-clamp technology
- From 50 mm<sup>2</sup> to 300 mm<sup>2</sup> (0 AWG to 600 Kcmil)
- 1000V IEC/UL rated
- Current rating 150 to 520A (IEC) & 150 to 420A (UL)
- Single pole and double poles versions
- 6 colors (grey, blue, green, black, brown, red)
- Aluminum tin plated body
- Panel and Din-rail mounting

## APPLICATIONS

- Electrical cabinet builder - Main power control cabinet
- Automation control
- Battery energy storage systems (BESS)
- Electrical vehicle infrastructures (EVI)
- Solar inverters & combiner boxes
- Motion & Drives
- HVAC
- Machinery switchboard where compactness matters

# PRODUCT FEATURES

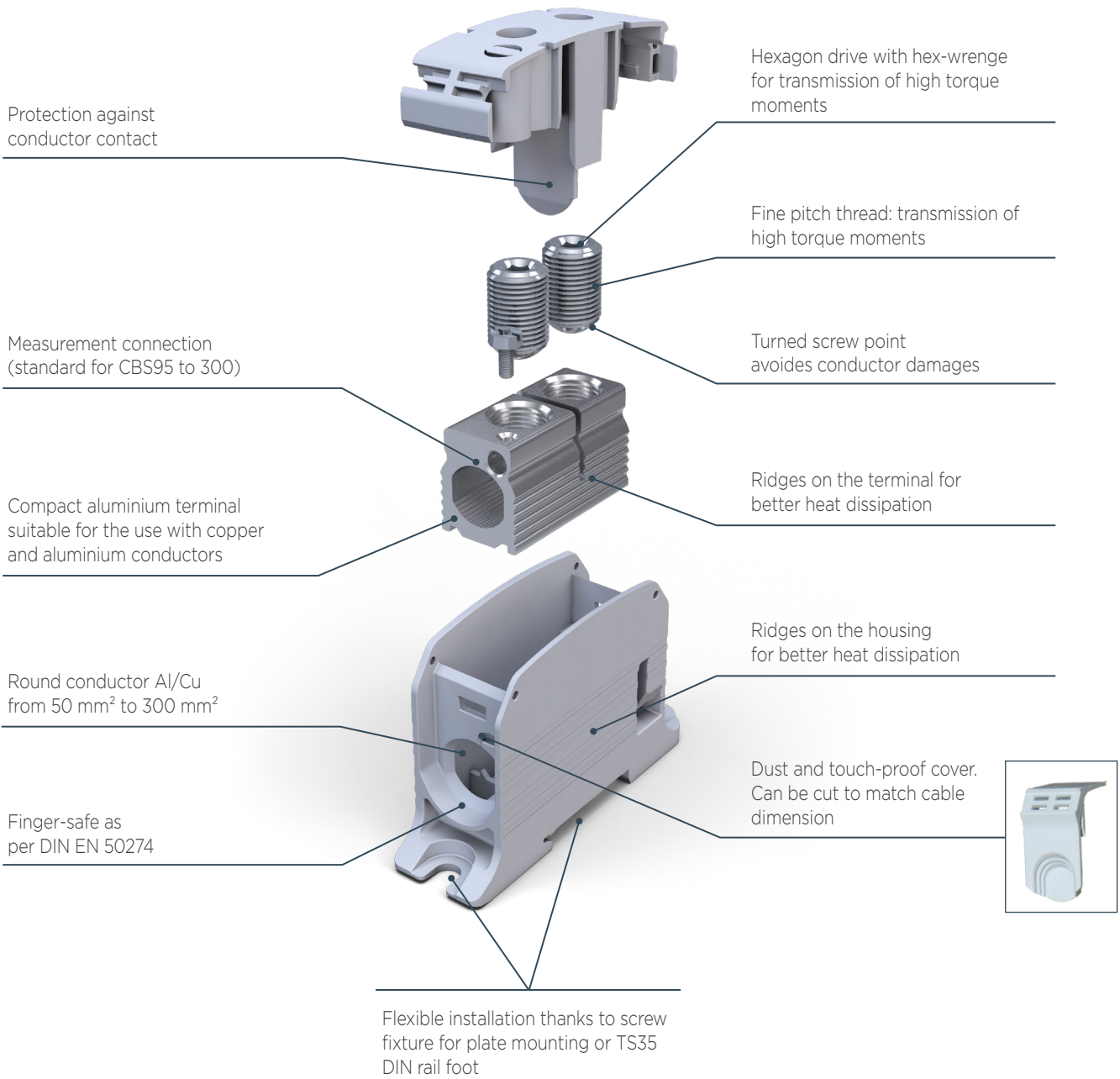

### Approvals









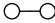

- IEC 60947-7-1
- IEC 61238-1 (Class A)
- UL-1059
- UL 486E
- CSA C22.2 No.158-10



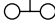

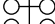

### Conformity



# PRODUCT ORDERING INFORMATION

	Main	Tapping	Spacing		Current		Voltage	Function	Color	Type	Part Number	Accessories Cover/Markers	Packing
	Cross section mm <sup>2</sup> /AWG	mm <sup>2</sup> /AWG	mm	in	IEC Cu/AL	UL Cu/AL	IEC/UL V						
	4-35 / 12-2		22	0.87	150 / 150 A	150 / 120 A	1000 / 1000		Grey	CBS50-2P	ISNF516011R0000		9
									Grey/Blue	CBS50-2P-BL	ISNF516021R0000		9
									Grey/Green	CBS50-2P-GR	ISNF516031R0000		9
									Grey/Brown	CBS50-2P-BR	ISNF516041R0000		9
									Grey/Black	CBS50-2P-BK	ISNF516051R0000		9
									Grey/Red	CBS50-2P-RD	ISNF516061R0000		9
	6-50 / 10-0		35.6	1.4					Grey	CBS50-4P	ISNF516111R0000		5
									Grey/Blue	CBS50-4P-BL	ISNF516121R0000		5
									Grey/Green	CBS50-4P-GR	ISNF516131R0000		5
									Grey/Brown	CBS50-4P-BR	ISNF516141R0000		5
									Grey/Black	CBS50-4P-BK	ISNF516151R0000		5
									Grey/Red	CBS50-4P-RD	ISNF516161R0000		5
	10-70 / 8-00	15-6 / 10-16	25.5	1	232 / 200 A	200 / 155 A	1000 / 1000		Grey	CBS95-2P	ISNF526011R0000		2
									Grey/Blue	CBS95-2P-BL	ISNF526021R0000		2
									Grey/Green	CBS95-2P-GR	ISNF526031R0000		2
									Grey/Brown	CBS95-2P-BR	ISNF526041R0000		2
									Grey/Black	CBS95-2P-BK	ISNF526051R0000		2
									Grey/Red	CBS95-2P-RD	ISNF526061R0000		2
	16-95 / 6-000	15-10 / 8-16	47	1.85					Grey	CBS95-4P	ISNF526111R0000		1
									Grey/Blue	CBS95-4P-BL	ISNF526121R0000		1
									Grey/Green	CBS95-4P-GR	ISNF526131R0000		1
									Grey/Brown	CBS95-4P-BR	ISNF526141R0000		1
									Grey/Black	CBS95-4P-BK	ISNF526151R0000		1
									Grey/Red	CBS95-4P-RD	ISNF526161R0000		1
	35-150 / 00-300 Kcmil	15-6 / 8-16	37.5	1.47	353 A / 250 A	310 / 250 A	1000 / 1000		Grey	CBS185-2P	ISNF536011R0000		1
									Grey/Blue	CBS185-2P-BL	ISNF536021R0000		1
									Grey/Green	CBS185-2P-GR	ISNF536031R0000		1
									Grey/Brown	CBS185-4P-BR	ISNF536041R0000		1
									Grey/Black	CBS185-4P-BK	ISNF536051R0000		1
									Grey/Red	CBS185-4P-RD	ISNF536061R0000		1
	50-240 / 250-500 Kcmil	15-6 / 8-16	45	1.77	520 A / 340 A	420 / 340 A	1000 / 1000		Grey	CBS300-2P	ISNF546011R0000		1
									Grey/Blue	CBS300-2P-BL	ISNF546021R0000		1
									Grey/Green	CBS300-2P-GR	ISNF546031R0000		1
									Grey/Brown	CBS300-2P-BR	ISNF546041R0000		1
									Grey/Black	CBS300-2P-BK	ISNF546051R0000		1
									Grey/Red	CBS300-2P-RD	ISNF546061R0000		1

 <p><b>Not allowed</b> Flexible without ferrule (IEC V-K &amp; UL: class 5/6)</p>	 <p>Flexible with insulated ferrule (IEC V-K &amp; UL: class 5/6)</p>	 <p>Rigid Solid (IEC V-U class 1, UL solid)</p>	 <p>Rigid Stranded (IEC V-R class 2, UL class B/C)</p>
--	---	--	---

## DIMENSIONS & ELECTRICAL CHARACTERISTICS

Power loss for single pole & double pole

**50 mm<sup>2</sup>**

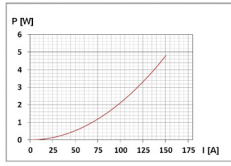

Dimensions

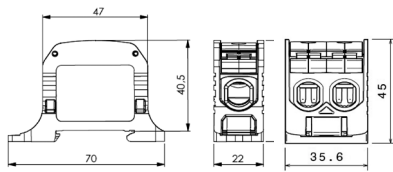

**185 mm<sup>2</sup>**

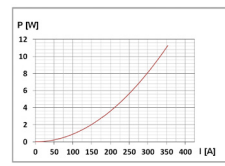

Dimensions

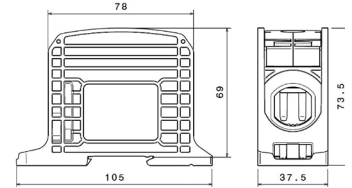

**95 mm<sup>2</sup>**

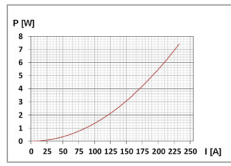

Dimensions

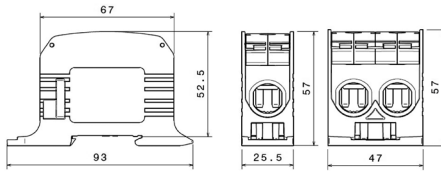

**300 mm<sup>2</sup>**

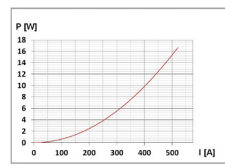

Dimensions

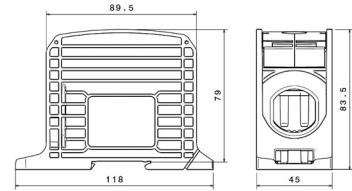

---

## Connect With Us

### Get Answers to Your Questions Now.

We make it easy to connect with our experts and are ready to provide the support you need, including:

- Product information
- Product comparisons for your project
- Discussions with TE engineers and product experts
- Project consultations
- TE design resources and tools

---

## te.com

©2024 TE Connectivity. All Rights Reserved.

TE Connectivity, TE, TE connectivity (logo), EVERY CONNECTION COUNTS, and ENTRELEC are trademarks owned or licensed by TE Connectivity. All other logos, products and/or company names referred to herein might be trademarks of their respective owners.

The information given herein, including drawings, illustrations and schematics which are intended for illustration purposes only, is believed to be reliable. However, TE Connectivity makes no warranties as to its accuracy or completeness and disclaims any liability in connection with its use. TE Connectivity's obligations shall only be as set forth in TE Connectivity's Standard Terms and Conditions of Sale for this product and in no case will

TE Connectivity be liable for any incidental, indirect or consequential damages arising out of the sale, resale, use or misuse of the product. Users of TE Connectivity products should make their own evaluation to determine the suitability of each such product for the specific application.

INDUSTRIAL / ENTRELEC COMPACT POWER BLOCKS / BROCHURE / EN / V2

04/24

TE Connectivity

3, rue Jean Perrin  
69680 Chassieu  
cedex France