

PRE-INSULATED JUNCTION SLEEVES MJPT

FOR LOW VOLTAGE INSULATED CABLE JUNCTIONS



**WATER RESISTANT AND PASS THE
DIELECTRIC TEST OF 6 kV IN WATER**

APPLICATIONS

- Low Voltage Insulated Overhead Lines

RELEVANT STANDARDS AND TEST REPORTS

- Exceeds requirements according to EN 50483-4 class 1 and NFC 33 021

KEY FEATURES

- Suitable for stranded Aluminium conductors
- Only two crimping die sizes (E173, E215) cover complete connector range
- A colour code of elastomeric sealing ring allows an easy identification of the cross sections
- Inner aluminum sleeve filled with contact grease
- Insulation material made of weather and UV resistant polymer

TE Connectivity's (TE) pre-insulated junction sleeves MJPT are used to make a junction (full tension) between two low voltage overhead insulated (LV ABC) cables. These pre-insulated sleeves are suitable for insulated stranded aluminium conductors. Three connector versions are available to meet the mechanical load requirements for self-supporting systems (type MJPT Alus) and systems with a neutral messenger. Stripped cables are inserted up to the stop in the connector.

Crimping is done according to the marks with appropriate crimping die over the plastic insulation. The electrical contact and the sealing by the elastomeric ring are achieved during the crimping process—the uniform connector length of 100 mm, except for neutral messengers of 170 mm.

Our MJPT pre-insulated junction sleeves are made of an aluminium (phase) or aluminium alloy (neutral) sleeve with a stop in the middle, a black thermoplastic sleeve sealed with a flexible elastomer ring at each side, and neutral contact grease in the tube, which improves the contact area and protects the aluminium against oxidation.

The crimping is realized on the plastic part according to the marks on the body of the sleeve. MJPT sleeves withstand the tests described in the French standard NFC 33 021 and EN 50483-4.

Option Available: MJPT pre-insulated sleeves can be ordered as a kit having 3 phase connectors and 1 neutral connector. This is delivered under EJPT reference.

TECHNICAL SPECIFICATIONS

COLOR CODE FOR CABLE SIZE CHECK

16 mm ²	blue
25 mm ²	orange
35 mm ²	red
50 mm ²	yellow
54,6 mm ²	Black
70 mm ²	white
95 mm ²	grey
120 mm ²	pink
150 mm ²	purple

MJPT SLEEVES ARE WATER RESISTANT AND PASS THE DIELECTRIC TEST OF 6 kV IN WATER. THEY WITHSTAND:

60% of the mechanical phase breaking load

95% of the mechanical neutral messenger breaking load

85% of the conductor load in the self supporting version (MJPT type Alus)

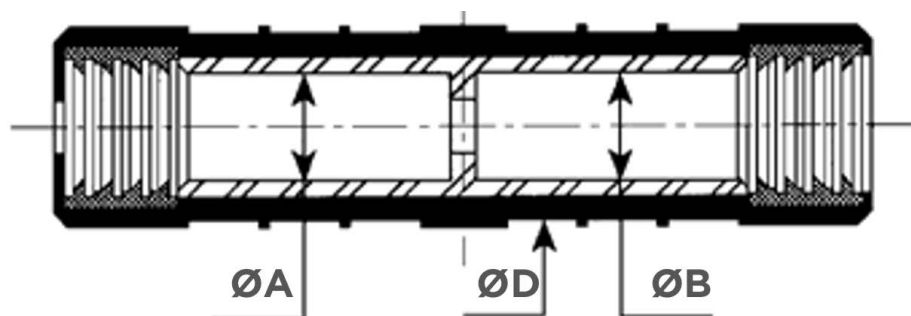

MJPT FOR LV ABC SYSTEM WITH INSULATED NEUTRAL MESSENGER SYSTEM: SLEEVES FOR JUNCTION OF 2 INSULATED PHASES

Designation	TCPN	Cross Section (mm ²)	Colour Code A/B	Dimensions (mm)			Crimping Die	Weight (g)	Standard Packaging (Qty)
				Dia A	Dia B	Dia D			
MJPT 16	709357-2	16	Blue	5.5	5.5	20	E173	55	10
MJPT 25	709357-3	25	Orange	6.5	6.5	20	E173	50	10
MJPT 35	708007-2	35	Red	8	8	20	E173	50	10
MJPT 35-25	1-708007-2	35-25	Red/Orange	8	6.5	20	E173	50	10
MJPT 50	708007-3	50	Yellow	9	9	20	E173	50	10
MJPT 50-35	1-708007-0	50-35	Yellow/Red	9	8	20	E173	50	10
MJPT 70	708007-7	70	White	10.5	10.5	20	E173	45	10
MJPT 70-35	708007-5	70-35	White/Red	10.5	8	20	E173	45	10
MJPT 70-50	708007-8	70-50	White/Yellow	10.5	9	20	E173	45	10
MJPT 95	1-709357-3	95	Grey	12.2	12.2	20	E173	40	10
MJPT 95-35	2-709357-3	95-35	Grey/Red	12.2	8	20	E173	45	10
MJPT 95-50	1-709357-6	95-50	Grey/Yellow	12.2	9	20	E173	40	10
MJPT 120 D25	708022-3	120	Pink	14.2	14.2	25	E215	85	10
MJPT 150	708022-1	150	Purple	15.5	15.5	25	E215	80	10
MJPT 150-70	708022-2	150-70	Purple/White	15.5	10.5	25	E215	90	10
MJPT 150-70	708022-4	150-95	Purple/Grey	15.5	12.2	25	E215	85	10
MJPT 150-120 D25	708022-5	150-120	Purple/Pink	15.5	14.2	25	E215	85	10

MJPT FOR LV ABC SYSTEM WITH INSULATED NEUTRAL MESSENGER SYSTEM: SLEEVES FOR JUNCTION OF 2 INSULATED NEUTRAL MESSENGER

Designation	TCPN	Cross Section (mm ²)	Colour Code A/B	Dimensions (mm)			Crimping Die	Weight (g)	Standard Packaging (Qty)
				Dia A	Dia B	Dia D			
MJPT 54	709347-2	54	Black	10	10	20	E173	80	10
MJPT 70N	709347-4	70N	White	10.8	10.8	20	E173	80	10
MJPT 70N-54	709347-3	70N-54,6	White/Black	10.8	10	20	E173	80	10

MJPT FOR LV ABC SELF SUPPORTING SYSTEM

Designation	TCPN	Cross Section (mm ²)	Colour Code A/B	Dimensions (mm)			Crimping Die	Weight (g)	Standard Packaging (Qty)
				Dia A	Dia B	Dia D			
MJPT 25 Alus	709185-2	25	Orange	6.5	6.5	20	E173	55	12
MJPT 35 Alus	708185-5	35	Red	8	8	20	E173	55	12
MJPT 50 Alus	709185-4	50	Yellow	9	9	20	E173	50	12
MJPT 50-25 Alus	709185-3	50-25	Yellow/Orange	9	6.5	20	E173	50	12
MJPT 50-35 Alus	2456768-1	50-35	Yellow/Red	9	8	20	E173	50	12
MJPT 70 Alus	709185-6	70	White	10.5	10.5	20	E173	45	12
MJPT 95-35 Alus	2456746-1	95-35	Grey/Red	12.2	8	20	E173	50	12
MJPT 95-50 Alus	2456746-2	95-50	Grey/Yellow	12.2	9	20	E173	50	12
MJPT 95-70 Alus	2456746-3	95-70	Grey/White	12.2	10.5	20	E173	50	12
MJPT 95 Alus D25	709186-1	95	Grey	12.2	12.2	25	E215	75	10
MJPT 120-95 ALUS	2430641-1	120-95	Pink/Grey	14.2	12.2	25	E215	75	10
MJPT 120 ALUS	1229528-1	120	Pink	14.2	14.2	25	E215	75	12

OPTION: FOR LV ABC SYSTEM WITH INSULATED NEUTRAL MESSENGER SYSTEM, MJPT CAN BE SUPPLIED IN KIT FORM, CONSISTING OF 3 MJPT PHASE + 1 MJPT NEUTRAL

Designation	TCPN	Cables Combinations	Weight (g)	Standard Packaging (Qty)
EJPT 35-54.6	716507-1	3x35+54,6 / 3x35+54,6	250	1
EJPT 50-35-54.6	716513-1	3x50+54,6 / 3x35+54,6	240	1
EJPT 50-54.6	716508-1	3x50+54,6 / 3x50+54,6	240	1
EJPT 70-54.6	716509-1	3x70+54,6 / 3x70+54,6	230	1
EJPT 70-35-54.6	716522-1	3x70+54,6 / 3x35+54,6	230	1
EJPT 70-50-54.6	716514-1	3x70+54,6 / 3x50+54,6	230	1
EJPT 70-70N/35-54.6	707999-1	3x70+70N / 3x35+54,6	235	1
EJPT 70-70N/50-54.6	707998-1	3x70+70N / 3x50+54,6	235	1
EJPT 70-70N/70-54.6	707997-1	3x70+70N / 3x70+54,6	235	1
EJPT 70-70N	709979-1	3x70+70N / 3x70+70N	215	1
EJPT 150-70/70-54.6	711731-1	3x150+70N / 3x70+54,6	330	1
EJPT 150-70/70-70N	707989-1	3x150+70N / 3x70+70N	350	1
EJPT 150-70N	711641-1	3x150+70N / 3x150+70N	320	1

Learn more: [TE.com/energy](https://www.te-connectivity.com/energy)

© 2024 TE Connectivity. All Rights Reserved. EPP-4371-DDS-8/24

TE, TE Connectivity, TE connectivity (logo), EVERY CONNECTION COUNTS are trademarks owned or licensed by TE Connectivity. Other logos, product and company names mentioned herein may be trademarks of their respective owners. While TE has made every reasonable effort to ensure the accuracy of the information in this brochure, TE does not guarantee that it is error-free, nor does TE make any other representation, warranty or guarantee that the information is accurate, correct, reliable or current. TE reserves the right to make any adjustments to the information contained herein at any time without notice. TE Connectivity's obligations shall only be as set forth in TE Connectivity's Standard Terms and Conditions of Sale for this product and in no case will TE Connectivity be liable for any incidental, indirect or consequential damages arising out of the sale, resale, use or misuse of the product. TE expressly disclaims all implied warranties regarding the information contained herein, including, but not limited to, any implied warranties of merchantability or fitness for a particular purpose. The dimensions, specifications, and/or information contained herein are for reference purposes only and are subject to change without notice. Consult TE for the latest dimensions, specifications, and/or information. Users of TE Connectivity products should make their own evaluation to determine the suitability of each such product for the specific application.

Connect with us:
[TE.com/energy-contact](https://www.te-connectivity.com/energy-contact)