

6-6 SHAPE GROUNDING CONNECTOR

IRREVERSIBLE CRIMP-TYPE GROUNDING CONNECTOR

KEY FEATURES

- Manufactured from Copper with high purity & conductivity
- Non-hazardous installations
- Prefilled with oxide-inhibiting compound
- Helps Reduce inventory. Connects wide range of conductors, Ground rods & rebars with 6 sizes
- Conductor size range: #6 - 500 kcmil
- Ground rod size range: 1/2" - 3/4"
- Compatible with wide range of available industrial crimping tools

TE Connectivity's (TE) 6-6 shape crimp type grounding connectors form an integral part of a grounding system of a structure. Versatile in design, these connectors provide jointing mechanism for copper to copper conductors and ground rods.

The shape selection depends on the element that will be crimped and conductor configuration. The product family covers a wide range of conductors (#6 AWG sol -500 kcmil copper) and ground rod sizes (1/2", 5/8" & 3/4").

These connectors form a permanent joint when crimped using a hydraulic crimp tool. The resulting maintenance-free joint ensures high electrical conductivity and offers superior resistance from corrosion, making the connectors ideal for buried applications.

Our grounding connectors are designed and manufactured in accordance with Industry standard UL-467.

Customers can count on consistent, high quality products, driven by TE's proven innovation and backed by our extraordinary customer support.

6-6 Shape Grounding Connector

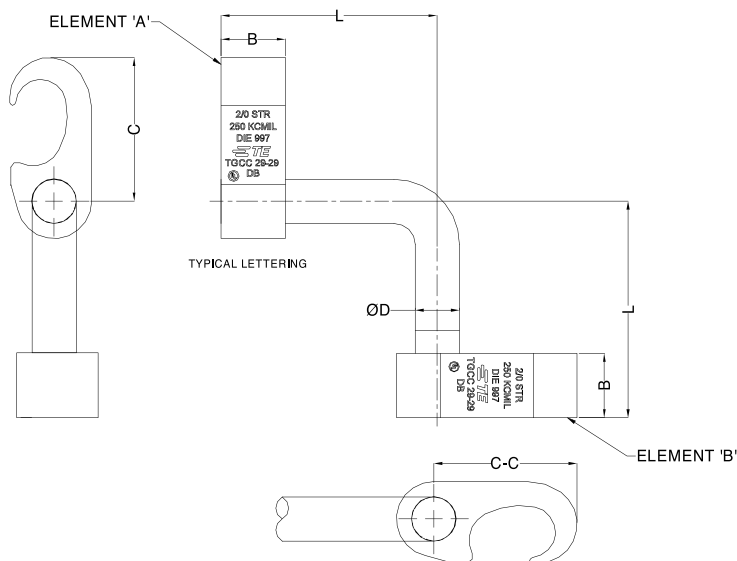

6-6 SHAPE GROUNDING CONNECTORS

Catalog No.	Part No.	Cable to Cable		Cable to Ground Rod		B Inch (mm)	C Inch (mm)	C-C Inch (mm)	Ø D Inch (mm)	L Inch (mm)
		Element A AWG (Sq.mm)	Element B AWG (Sq.mm)	Element A Inch (mm)	Element B Inch (mm)					
TGCC 2-2	EN3751-301	#6 Str. - #2 Str. (10 mm ² - 35 mm ²)	#6 Str. - #2 Str. (10 mm ² - 35 mm ²)	-	-	0.75 (19.0)	1.09 (27.7)	1.09 (27.7)	0.31 (8.0)	2.52 (64.0)
TGCC 29-2	EN3751-302	#1 Str. - 250 MCM (40 mm ² - 120 mm ²)	#6 Str. - #2 Str. (10 mm ² - 35 mm ²)	1/2" - 5/8" Rod (12.7 - 16.0)	#6 Str. - #2 Str. (10 mm ² - 35 mm ²)	0.75 (19.0)	1.66 (42.2)	1.09 (27.7)	0.31 (8.0)	2.52 (64.0)
TGCC 29-29	EN3751-303	#2 Str. - 250 MCM (35 mm ² - 120 mm ²)	#2 Str. - 250 MCM (35 mm ² - 120 mm ²)	1/2" - 5/8" Rod (12.7 - 16.0)	#2 Str. - 250 MCM (35 mm ² - 120 mm ²)	0.75 (19.0)	1.66 (42.2)	1.66 (42.2)	0.50 (12.7)	2.62 (66.7)
TGCC 34-2	EN3751-304	250 MCM - 500 MCM (120 mm ² - 240 mm ²)	#6 Str. - #2 Str. (10 mm ² - 35 mm ²)	5/8" - 3/4" Rod (14.2 - 19.0)	#6 Str. - #2 Str. (10 mm ² - 35 mm ²)	0.75 (19.0)	2.09 (53.1)	1.09 (27.7)	0.31 (8.0)	2.52 (64.0)
TGCC 34-29	EN3751-305	#6 Str. - #2 Str. (10 mm ² - 35 mm ²)	#2 Str. - 250 MCM (35 mm ² - 120 mm ²)	5/8" - 3/4" Rod (14.2 - 19.0)	#2 Str. - 250 MCM (35 mm ² - 120 mm ²)	0.75 (19.0)	2.09 (53.1)	1.66 (42.2)	0.50 (12.7)	2.62 (66.7)
TGGL 34-34	EN3751-306	250 MCM - 500 MCM (120 mm ² - 240 mm ²)	250 MCM - 500 MCM (120 mm ² - 240 mm ²)	5/8" - 3/4" Rod (14.2 - 19.0)	250 MCM - 500 MCM (120 mm ² - 240 mm ²)	1.10 (28.0)	2.28 (57.9)	2.28 (57.9)	0.75 (19.1)	2.93 (74.5)

Material: High conductive copper
Finish: Natural



Learn more: [TE.com/energy](https://www.te-connectivity.com/energy)

© 2022 TE Connectivity. All Rights Reserved. EPP-3947-DDS-2/22 for 6-6 shape grounding connector

TE, TE Connectivity, TE connectivity (logo), EVERY CONNECTION COUNTS are trademarks owned or licensed by TE Connectivity. Other logos, product and company names mentioned herein may be trademarks of their respective owners. While TE has made every reasonable effort to ensure the accuracy of the information in this brochure, TE does not guarantee that it is error-free, nor does TE make any other representation, warranty or guarantee that the information is accurate, correct, reliable or current. TE reserves the right to make any adjustments to the information contained herein at any time without notice. TE Connectivity's obligations shall only be as set forth in TE Connectivity's Standard Terms and Conditions of Sale for this product and in no case will TE Connectivity be liable for any incidental, indirect or consequential damages arising out of the sale, resale, use or misuse of the product. TE expressly disclaims all implied warranties regarding the information contained herein, including, but not limited to, any implied warranties of merchantability or fitness for a particular purpose. The dimensions, specifications, and/or information contained herein are for reference purposes only and are subject to change without notice. Consult TE for the latest dimensions, specifications, and/or information. Users of TE Connectivity products should make their own evaluation to determine the suitability of each such product for the specific application.

Connect with us:

[TE.com/energy-contact](https://www.te-connectivity.com/energy-contact)