

## RAYCHEM COLD SHRINK TERMINATIONS CST FOR POLYMERIC CABLES UP TO 35 kV

### KEY FEATURES

- Spiral holdout with pull direction toward the lug provides easy installation
- Extra-long, integrated geometric stress control and void-filling mastic to reduce termination positioning errors
- Outstanding weathering, UV and ozone resistance
- Chemical-resistant and fungus-resistant
- A mastic sealed version of the product is available for 25 kV/36 kV
- Hydrophobic silicone material to repel water

Our Class 1 A Cold Shrink Terminations CST are the one-piece solution for high performance in cold applied terminations for polymeric cables up to 35 kV. Our CST offer a reliable, fast and easy-to-install system to ensure trouble-free service.

Our components are pre-expanded on an easy-to-remove spiral holdout, allowing installation in compact environments on prepared cable.

The silicone body is specially formulated for excellent tracking and erosion resistance. The extra-long stress cone aids in correct positioning and integrated void-filling mastic eliminates the need for silicone grease. Sealing mastic for the lug end is built into the expanded termination eliminating the need for additional sealing tapes. Shear bolt and compression style terminals and pin connectors are available to provide reliable connection to a variety of conductors.

The CST components have full traceability to raw materials and are in compliance with the IEEE-48, CENELEC HD 629.1.S2 standards including IEC, BS, VDE and other international specifications.

**Customers can count on consistent, high quality products, driven by TE's proven innovation and backed by our extraordinary customer support.**

# Cold Shrink Terminations CST



## HOW TO ORDER

1	2		3		4	
Prefix	Indoor / Outdoor		Type		1 or 3/C	
Code	Code		Code		Code	
CST	I *	Indoor	blank	standard	blank	1/C
CST	O	Outdoor	L	Long neck	-3	3/C

Sample part number:

CSTO-153J-CP5-B2

5		6							
Voltage Rating	Body Size*	Nominal AWG Cable Sizes							
		Code	Code	Cable Insulation O.D. Range	5 kV 133% / 8 kV 100%	15 kV 100%	15 kV 133%	25 kV 100%	28 kV 100%
-15	2	0.65 - 1.06 in	16.5 - 27.0 mm	2/0 - 350 kcmil	#2 - 250 kcmil	#2 - 4/0	-	-	-
	3	0.97 - 1.35 in	24.5 - 34.5 mm	500 - 750 kcmil	350 - 500 kcmil	4/0 - 500 kcmil	-	-	-
	4	1.28 - 2.04 in	32.5 - 52.0 mm	1000 kcmil	600 - 1250 kcmil	500 - 1250 kcmil	-	-	-
-28	2	0.65 - 1.06 in	16.5 - 27.0 mm	2/0 - 500 kcmil	#2 - 250 kcmil	#2 - 4/0	#1 - 3/0	#1 - 3/0	-
	3	0.97 - 1.35 in	24.5 - 34.5 mm	500 - 1000 kcmil	350 - 500 kcmil	4/0 - 500 kcmil	2/0 - 350 kcmil	2/0 - 350 kcmil	-
	4	1.28 - 2.04 in	32.5 - 52.0 mm	1000 kcmil	600 - 1250 kcmil	500 - 1250 kcmil	500 - 1250 kcmil	500 - 1250 kcmil	-
-35	2	0.95 - 1.41 in	24.3 - 36.0 mm	750 - 1000 kcmil	250 - 750 kcmil	4/0 - 500 kcmil	2/0 - 500 kcmil	1/0 - 500 kcmil	1/0 - 350 kcmil
	3	1.27 - 1.89 in	32.4 - 48.0 mm	-	750 - 1500 kcmil	350 - 1500 kcmil	350 - 1250 kcmil	350 - 1250 kcmil	250 - 1000 kcmil
	4	1.70 - 2.52 in	43.2 - 64.0 mm	-	1250 - 2000 kcmil	1250 - 2000 kcmil	1250 - 2000 kcmil	1000 - 2000 kcmil	750 - 2000 kcmil

\* CSTI terminations have small skirts to increase creepage and dry flashover distance and therefore cannot be inverted.

\*\* Select Body Size Code ( 2, 3, 4, ) based on Outside Diameter of insulation. Selections are based on the typical dimensions of Concentric-Stranded insulated cables and the dimensions of commonly used connectors manufactured in accordance with AEIC standard. Nominal insulation thicknesses: 15 kV 100% (175 mils), 15 kV 133% (220 mils), 25 kV 100% (260 mils), 28 kV (280 mils), 35 kV (345) mils.

\*\* High current ground for longitudinally corrugated or flat strap shielded cables.

7	
Cable Neutral Type	
Code	Type
G	Copper tape
J	JCN
HCG	LF/FS**

8			
Connector Type and Size			
Code	Type	Use Range (in)	Size
blank	no connector included		
-CP0	Compression pin (12 inches)		#2
-CP1	Compression pin (12 inches)		#1
-CP2	Compression pin (12 inches)		1/0
-CP3	Compression pin (12 inches)		2/0
-CP4	Compression pin (12 inches)		3/0
-CP5	Compression pin (12 inches)		4/0
-CL0	Copper Compression lug		#2
-CL1	Copper Compression lug		#1
-CL2	Copper Compression lug		1/0
-CL3	Copper Compression lug		2/0
-CL4	Copper Compression lug		3/0
-CL5	Copper Compression lug		4/0
-CL6	Copper Compression lug		350
-CL7	Copper Compression lug		500
-CL8	Copper Compression lug		750
-CL9	Copper Compression lug		1000
-SP0	Shear Bolt pin	0.258 - 0.373	#2 - 1/0
-SP1	Shear Bolt pin	0.376 - 0.528	2/0 - 4/0
-SL0	Shear Bolt lug	0.268 - 0.528	#2 - 4/0
-SL1	Shear Bolt lug	0.268 - 0.681	#2 - 350
-SL2	Shear Bolt lug	0.616 - 0.998	350 - 750***
-SL3	Shear Bolt lug	0.813 - 1.152	600 - 1000***
-SL4	Shear Bolt lug	1.19 - 1.25	1250***

\*\*\* Contact TE Technical Support for long neck body requirements with this shear bolt.

Aluminum connectors are tin plated and can be used on copper or aluminum conductors.

Compression and shear bolt lugs are 2-hole NEMA type.

Other connectors such as 4-hole NEMA and other pin lengths are available.

9		
Bracket		
Code	Use Range (in)	Size
blank	not included	n/a
-B1	0.80 - 1.25	straight
-B2	1.10 - 1.50	straight
-B3	1.45 - 1.95	straight
-B4	1.80 - 2.40	straight
-B5	0.80 - 1.25	90 degree
-B6	1.10 - 1.50	90 degree
-B7	1.45 - 1.95	90 degree
-B8	1.80 - 2.40	90 degree

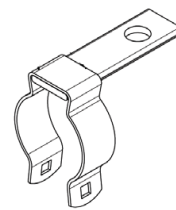

Straight Bracket



90 Degree Bracket

### FOR MORE INFORMATION: TE Technical Support Centers

USA:	+ 1 800 327 6996
Canada:	+ 1 (905) 475-6222
Mexico:	+ 52 (0) 55-1106-0800
Latin/S. America:	+ 54 (0) 11-4733-2200
France:	+ 33 380 583 200
UK:	+ 44 0870 870 7500
Germany:	+ 49 896 089 903
Spain:	+ 34 916 630 400
Italy:	+ 39 333 250 0915
Benelux:	+ 32 16 508 695
Russia:	+ 7 495-790 790 2-200
China:	+ 86 (0) 400-820-6015

te.com/energy

© 2019 TE Connectivity. All Rights Reserved. EPP-2629-07/19-AMS

Raychem, TE Connectivity and TE connectivity (logo) are trademarks. Other logos, product and/or company names might be trademarks of their respective owners. While TE has made every reasonable effort to ensure the accuracy of the information in this brochure, TE does not guarantee that it is error-free, nor does TE make any other representation, warranty or guarantee that the information is accurate, correct, reliable or current. TE reserves the right to make any adjustments to the information contained herein at any time without notice. TE expressly disclaims all implied warranties regarding the information contained herein, including, but not limited to, any implied warranties of merchantability or fitness for a particular purpose. The dimensions in this catalog are for reference purposes only and are subject to change without notice. Specifications are subject to change without notice. Consult TE for the latest dimensions and design specifications.