

UTILUX ALUMINIUM CRIMP LUGS AG TYPE

KEY FEATURES

- 99.9% pure high conductivity aluminium
- Forged from solid AL billets
- Solid palm, therefore eliminating the ingress of moisture
- Pre-filled with jointing compound
- Individually packed in sealed plastic

Utilux is a brand that has built an enviable reputation for high quality, reliable electrical connectors. For over 90 years, this dynamic Australian brand has been a leader in the field of interconnection systems.

Our aim is to provide the best possible products and services to keep our customers at the cutting edge of industry standards - internationally.

You can be sure that Utilux branded products are fabricated from the finest materials and produced to exacting tolerances. They represent the latest technology and the best design for the tasks they are required to perform.

Utilux is a leading brand of electrical connectors sold to original equipment manufacturers and electrical distribution companies throughout Australia, New Zealand and Asia. A comprehensive range, the most up to date production technology and the highest quality control standards ensure that there are Utilux connectors, of optimum reliability and durability, for all major power distribution applications.

As part of the worlds largest electrical connector company, TE Connectivity, the development of products is an ongoing commitment. It is done on a global basis, utilising the talents of many people throughout the organisation to ensure a global product for a local market.

Customers can count on consistent, high quality products, driven by TE's proven innovation and backed by our extraordinary customer support.

UTILUX ALUMINIUM CRIMP LUGS



Utilux Aluminium Lugs and Links are manufactured from high conductivity aluminium. The lugs are forged to maximise conductivity and strength and also eliminate any moisture seepage.

Markings are used to clearly identify the cable to be used, die combination and crimping position.

Care should be taken in the preparation of aluminium conductors to ensure proper scratch brushing and inhibiting compound is applied.

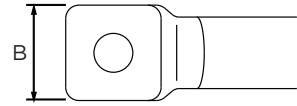
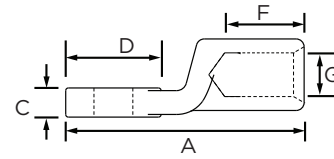

PRODUCT SELECTION INFORMATION										
Catalogue Number	Conductor Area (mm ²)	Conductor Stranding	Stud Size	Dimensions (mm)						Crimping Die
				A	B	C	D	F	G	
AG6MB	6	7/1.04	MB	65	22	5	22	32	3.5	38-90AL
AG6M6			M6							
AG10MB	10	7/1.35	MB	65	22	5	22	32	4.5	38-90AL
AG10M6			M6							
AG16MB	16	7/1.70	MB	65	22	5	22	32	5.5	38-90AL
AG16M10			M10							
AG25MB	25	19/1.35	MB	65	22	5	22	32	7	38-90AL
AG25M10			M10							
AG35MB	35	19/1.53	MB	65	22	5	22	32	8.5	38-90AL
AG35M10			M10							
AG50MB	50	19/1.78	MB	73	26	8	28	32.5	9.5	38-132AL
AG50M10			M10							
AG70MB	70	19/2.14	MB	73	26	8	28	32.5	11	38-132AL
AG70M10			M10							
AG70M12			M12							
AG95MB	95	37/1.78	MB	80	30	10	35	37	13	38-173AL 40-172AL
AG95M10			M10							
AG95M12			M12							
AG120MB	120	37/2.03	MB	80	30	10	35	37	15	38-173AL 40-172AL
AG120M10			M10							
AG120M12			M12							

Stud size "MB" means blank palm.

800 - 1000mm² tube Aluminium Crimp Lugs made to approved minimum quantities only.

PRODUCT SELECTION INFORMATION										
Catalogue Number	Conductor Area (mm ²)	Conductor Stranding	Stud Size	Dimensions (mm)						Crimping Die
				A	B	C	D	F	G	
AG150MB	150	37/2.25	MB	90	36	11	36	37	16.5	38-220AL 40-220AL
AG150M10			M10							
AG150M12			M12							
AG150M16			M16							
AG185MB	185	37/2.52	MB	90	36	11	36	36	18.5	38-220AL 40-220AL
AG185M12			M12							
AG185M16			M16							
AG240MB	240	61/2.25	MB	115	46	12	50	42	21	38-284AL 40-283AL
AG240M12			M12							
AG240M16			M16							
AG300MB	300	61/2.52	MB	115	46	12	50	41	23.5	38-284AL 40-283AL
AG300M12			M12							
AG300M16			M16							
AG400MB	400	61/2.85	MB	150	54	15	54	68	26.5	40-390AL
AG400M12			M12							
AG400M16			M16							
AG500MB	500	61/3.20	MB	150	54	15	54	68	29.5	40-390AL
AG500M12			M12							
AG500M16			M16							
AG630MB	630	127/2.52	MB	159.5	60	15	60	68	33.5	40-432AL
AG630M16			M16							

te.com/energy

©2016 TE Connectivity Ltd. family of companies. All Rights Reserved. EPP-2487-DDS14-AU-2/16

Utilux, TE Connectivity and TE Connectivity (logo) are trademarks. Other logos, product and/or company names might be trademarks of their respective owners. While TE has made every reasonable effort to ensure the accuracy of the information in this brochure, TE does not guarantee that it is error-free, nor does TE make any other representation, warranty or guarantee that the information is accurate, correct, reliable or current. TE reserves the right to make any adjustments to the information contained herein at any time without notice. TE expressly disclaims all implied warranties regarding the information contained herein, including, but not limited to, any implied warranties of merchantability or fitness for a particular purpose. The dimensions in this catalog are for reference purposes only and are subject to change without notice. Specifications are subject to change without notice. Consult TE for the latest dimensions and design specifications.

FOR MORE INFORMATION:

TE Customer Support Centers

NSW/QLD/NT/ACT: +61 (2) 9554 2695
 VIC/TAS/SA: +61 (3) 9271 5243
 WA: +61 (8) 9358 7806
 New Zealand: +64 (9) 634 4580