

## UNDERGROUND CABLE BRANCH JOINT SYSTEM MMY/HMY

FOR POLYMERIC AND PAPER INSULATED LV CABLES UP TO 240 mm<sup>2</sup>

### KEY FEATURES

- Impact resistant
- Grey housing
- Polypropylene
- Robust bolted design with labyrinth sealing
- HMY-66x with integrated strain relief clamps
- Available with environment-friendly and label-free resin GUROFLEX

TE Connectivity's (TE's) Underground Cable Joint System (MMY/HMY) with Y-Branch is available in many different types. The joint is suitable for ring connectors, single branch connectors, and hot casing materials.

The MMY-330 is a compact house connection joint with Y-branch for main cables from 95 up to 150 mm<sup>2</sup> with ring connectors only.

The MMY-450 is a house connection joint installation with Y-branch for main cables from 95 up to 185 mm<sup>2</sup> with convenient installation space for ring connectors or single clamps.

The HMY-660 and HMY-661 are distribution branch joints for main cables from 150 up to 240 mm<sup>2</sup>.

When using the blind plug for the branch opening, all types can be applied as straight joint.

Customers can count on consistent, high quality products, driven by TE's proven innovation and backed by our extraordinary customer support.

## Underground Cable Branch Joint System MMY/HMY



Joints are tested according to CENELEC EN 50393.

### PRODUCT DIMENSIONS

	MMY 330/450	HMY 660/661
A	146/151	200
B	200/300	475
C	240/340	515
D	120/130	160
E	220	310
F	330/450	650
G	40/43	51/51
H	50/55	51/65

Dimensions in mm

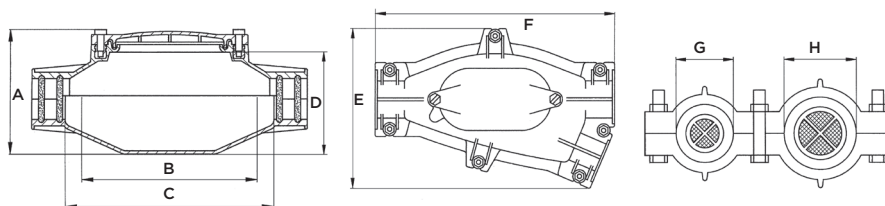

### PRODUCT SELECTION INFORMATION

Description	Connectors	Filler Type	Cable Sealing	Volume	Cable Cross Section Mains [mm <sup>2</sup> ]	Cable Cross Section Branch [mm <sup>2</sup> ]	Part Number
MMY-330-EM	without	without	without	2,45 l	4 x 95-150	4 x 25-70	728448-000
MMY-330-GD245	without	GUROFLEX	included	2,45 l	4 x 95-150	4 x 25-70	552806-000
MMY-450-EM	without	without	without	3,75 l	4 x 95-185	4 x 50-95	277264-000
MMY-450-GD375	without	GUROFLEX	included	3,75 l	4 x 95-185	4 x 50-95	602578-000
HMY-660-EM	without	without	without	6,45 l	4 x 70-150 3 x 70/35 - 3 x 150/150 4 x 50/25 - 4 x 120/70	4 x 70-150 3 x 70/35 - 3 x 150/150 4 x 50/25 - 4 x 120/70	305398-000
HMY-660-GD645	without	GUROFLEX	included	6,45 l	4 x 70-150 3 x 70/35 - 3 x 150/150 4 x 50/25 - 4 x 120/70	4 x 70-150 3 x 70/35 - 3 x 150/150 4 x 50/25 - 4 x 120/70	221576-000
HMY-661-EM	without	without	without	6,45 l	4 x 150-240 3 x 150/70 - 3 x 240/120 4 x 120/70 - 4 x 150/70	4 x 70-150 3 x 70/35 - 3 x 150/150 4 x 50/25 - 4 x 120/70	197914-000
HMY-661-GD645	without	GUROFLEX	included	6,45 l	4 x 150-240 3 x 150/70 - 3 x 240/120 4 x 120/70 - 4 x 150/70	4 x 70-150 3 x 70/35 - 3 x 150/150 4 x 50/25 - 4 x 120/70	595488-000

Stated smallest cross sections can be covered with supplied cable entry sealing material and filler volume. Smaller cross sections may require additional sealing or filler.

### ACCESSORIES

Description	Part Number
FOAM-TAPE-90X3X2	048402-000
FOAM-TAPE-120X3X2,5	955336-000
<b>Blind Plugs</b>	
GURO-BP-MMY-330	856628-000
GURO-BP-MMY-450	831678-000
GURO-BP-HMY-66X	633852-000
<b>Earthing Bolt</b>	
GURO-EB-HMY-660	CF2142-000

[te.com/energy](http://te.com/energy)

©2014 TE Connectivity Ltd. family of companies. All Rights Reserved. EPP-2314-10/14

TE Connectivity and TE connectivity (logo) are trademarks. Other logos, product and/or company names might be trademarks of their respective owners. While TE has made every reasonable effort to ensure the accuracy of the information in this brochure, TE does not guarantee that it is error-free, nor does TE make any other representation, warranty or guarantee that the information is accurate, correct, reliable or current. TE reserves the right to make any adjustments to the information contained herein at any time without notice. TE expressly disclaims all implied warranties regarding the information contained herein, including, but not limited to, any implied warranties of merchantability or fitness for a particular purpose. The dimensions in this catalog are for reference purposes only and are subject to change without notice. Specifications are subject to change without notice. Consult TE for the latest dimensions and design specifications.

### FOR MORE INFORMATION: TE Technical Support Centers

USA:	+ 1 800 327 6996
France:	+ 33 380 583 200
UK:	+ 44 0870 870 7500
Germany:	+ 49 896 089 903
Spain:	+ 34 916 630 400
Benelux:	+ 32 16 351 731
Canada:	+ 1 (905) 475-6222
Mexico:	+ 52 (0) 55-1106-0800
Latin/S. America:	+ 54 (0) 11-4733-2200
China:	+ 86 (0) 400-820-6015