



GEL H-FRAME CLOSURE - 1000V (GHFC)

FAST AND EASY TO USE AND INSTALL

KEY FEATURES

- PowerGel sealant filled splice for buried, underground, and overhead applications
- Fast and simple to install
- PowerGel sealant easily peels away leaving a clean connection
- Can be used on aluminum or copper cables
- Meets requirements of ANSI C119.1

GHFC gel H-frame closure provides a fast and simple method for insulating and environmentally sealing low-voltage cable taps and splices made with H-frame compression connectors.

Simply place the connection on the closure and press the closure together. It's that easy—no tapes, mastics, tools, or mixing are required. The closure can be easily installed with one hand, even while wearing high voltage gloves.

The closure utilizes TE's innovative PowerGel sealing gel to protect the connection from moisture ingress, corrosion, and pollution. TE's pre-cured polymer gels are blended together and crosslinked to give high elasticity, high cohesiveness, and temperature stability. They have been in use in other applications for over 10 years.

TE's gels are ideal for sealing electrical connections from moisture, dirt, and other contaminants. There is no need to apply heat or use sealants that would make re-entry difficult or impossible. When compressed, gels will coat and adhere to surfaces; they can be easily removed by pulling or peeling them off.

Customers can count on consistent, high quality products, driven by TE's proven innovation and backed by our extraordinary customer support.

Gel H-Frame Closure - 1000V (GHFC)



The low-voltage H-frame closure is ideal for both underground and overhead applications and is especially useful for street lighting applications

Molded cover of UV stable, impact resistant polypropylene provides rugged protection for underground or overhead applications.

Frangible fingers provide wide cable range.

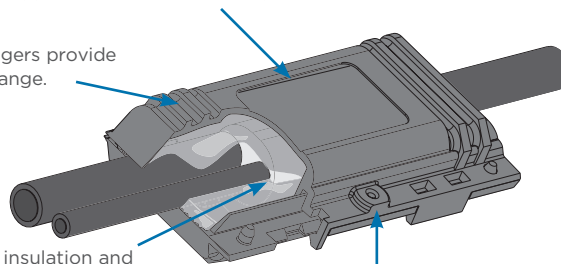

Silicone gel is high dielectric insulation and provides constant pressure on cable and connector to provide waterseal. PowerGel sealing gel is specially formulated for high temperature environments.

Snap-lock ensures that cover remains closed.

TESTING

TE's GHFC gel H-frame closure has been tested to and meets the following requirements:

Testing	Test Conditions
Underground Splicing	ANSI C119.1 - 1986
Fungus Resistance	ASTM G - 21

PRODUCT SELECTION INFORMATION

Description	Conductor Size (AWG/mm ²)			Standard Package
	Main	Die	Tap	
GHFC - 1 - 90	#6 - #2 (16 - 35)	#14 - #8 (2.5 - 10)	"BG"	10 each
GHFC - 2 - 90	#2 - 2/0 (35 - 70)	#14 - #6 (2.5 - 16)	"O"	10 each
GHFC - 2.5 - 90	1/0 - 4/0 (50 - 95)	#6 - 3/0 (16 - 85)	"D"	30 each
GHFC - 3 - 90	350 (185)	#4/0 (95)	"N"	6 each

ORDERING INFORMATION

Select the appropriate catalog number. Selections are based on typical dimensions for low-voltage, insulated cable and connectors. Approved connectors include, but are not limited to:

Product	Approved Connectors
GHFC - 1 - 90	Homac UB214; T&B 63105; Blackburn WR9; Burndy YPC2A8U
GHFC - 2 - 90	Homac OB22, OB44, OB102, OB103; Burndy YHO - 1, YHO - 2, YHO100, YHO125, YHO150; Blackburn WR139, WR159, WR179, WR199; ILSCO AH1; T&B 63110; UTILCO HT1, HT2

TEST REPORT

Related Product Information: EDR-5264 Test Report

te.com/energy

©2019 TE Connectivity. All Rights Reserved. EPP-3400-07/19-EN

Raychem, TE, TE Connectivity and the TE connectivity (logo) are trademarks of the TE Connectivity Ltd. Family of companies. Other logos, product and Company names mentioned herein may be trademarks of their respective owners. While TE has made every reasonable effort to ensure the accuracy of the information in this brochure, TE does not guarantee that it is error-free, nor does TE make any other representation, warranty or guarantee that the information is accurate, correct, reliable or current. TE reserves the right to make any adjustments to the information contained herein at any time without notice. TE expressly disclaims all implied warranties regarding the information contained herein, including, but not limited to, any implied warranties of merchantability or fitness for a particular purpose. The dimensions in this brochure are for reference purposes only and are subject to change without notice. Specifications are subject to change without notice. Consult TE for the latest dimensions and design specifications

FOR MORE INFORMATION: TE Technical Support Centers

USA:	+ 1 800 327 6996
France:	+ 33 380 583 200
UK:	+ 44 0870 870 7500
Germany:	+ 49 896 089 903
Spain:	+ 34 916 630 400
Italy:	+ 39 333 250 0915
Benelux:	+ 32 16 508 695
Canada:	+ 1 (905) 475-6222
Mexico:	+ 52 (0) 55-1106-0800
Latin/S. America:	+ 54 (0) 11-4733-2200
China:	+ 86 (0) 400-820-6015