

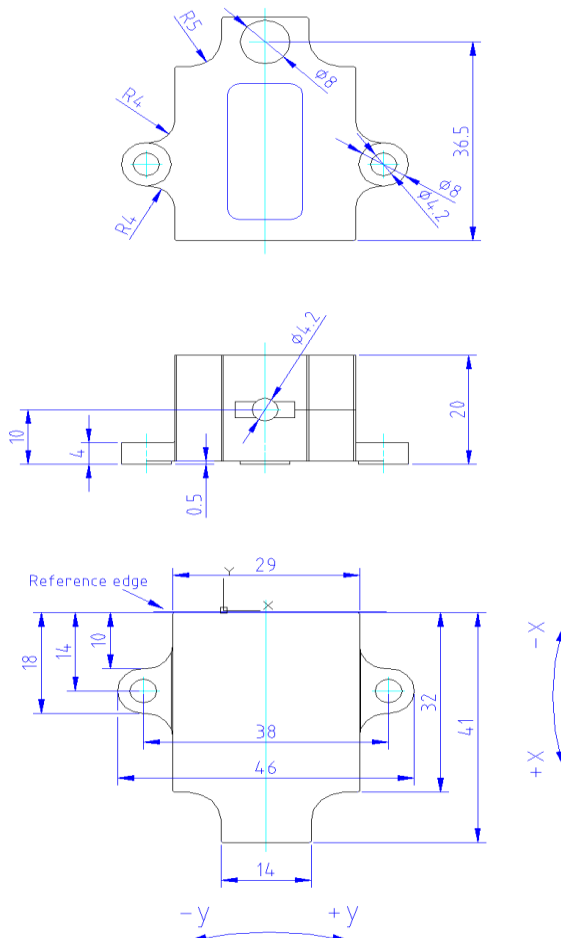

dimensions [mm]



DQG-SERIES INCLINOMETER

SPECIFICATIONS

- Dual axis inclinometer
- Measurement range $\pm 25^\circ$
- Voltage output signal

The **DQG-Series** is a small inclinometer based on dual axis tilt sensor for horizontal mounting, which works based on the conductivity principle.

This microprocessor controls the inclino-meter with a linearized and temperature compensated angle output signal. The unit has metal housing and exhibits an 8...30VDC power supply.

FEATURES

- Robust IP 66 housing
- Cable integrated
- Voltage output signal
- Temperature compensated
- Small size
- Fast response time
- Easy to handle

APPLICATIONS

- Alignment and level control
- Mobile and stationary cranes
- Man lift
- Forklift truck
- Harvester
- Vehicle applications

PARAMETERS

	Conditions	Min	Type	Max	Unit
Measurement range		-25		+25	°
Sensitivity			80		mV/ °
Offset			2.5		V
Initial Offset	Ta = 25°C		±0.2		°
Offset temperature drift error	Ta = 0°C...+50°C		±0.1		°
	Ta = -40°C... +85°C		±0.5		°
Sensitivity temperature drift error	Ta = 0°C...+50°C		±0.5		%
	Ta = -40°C... +85°C		±1.0		%
Resolution			0.1		°
Output signal	to GND	0.3		4.7	VDC
Power supply		8		30	VDC
Current consumption			10		mA
Operation temperature range		-40		+85	°C
Storage temperature range		-40		+85	°C
Weight			40		g
Cable, pigtail			500		mm
Dimensions	W x D x H		41 x 46 x 20		mm

TERMINAL CONNECTIONS

Pin	Name	Description	Type	Color
1	YOut	Y-axis output signal	output	Green
2	XOut	X-axis output signal	output	Brown
3	GND	negative power supply, ground	supply	Yellow
4	Vcc	positive power supply +8...+30VDC	supply	White

ORDERING INFORMATION

PART NUMBER	UNIT	SHORT DESCRIPTION
G - NSDQL - 004	NS-25/DQG2-XUA	Range +/-25°, Vcc +8...+30VDC, output +0.3...+4.7VDC

NORTH AMERICA

Measurement Specialties, Inc.,
a TE Connectivity Company
Phone: 800-522-6752
Email: customercare.hmpt@te.com

EUROPE

MEAS Deutschland GmbH (Europe)
a TE Connectivity Company
Phone: 800-440-5100
Email: customercare.tlse@te.com

ASIA

Measurement Specialties (China), Ltd.,
a TE Connectivity Company
Phone: 0400-820-6015
Email: customercare.shzn@te.com

TE.com/sensorsolutions

Measurement Specialties, Inc., a TE Connectivity company.

Measurement Specialties, TE Connectivity, TE Connectivity (logo) and EVERY CONNECTION COUNTS are trademarks. All other logos, products and/or company names referred to herein might be trademarks of their respective owners.

The information given herein, including drawings, illustrations and schematics which are intended for illustration purposes only, is believed to be reliable. However, TE Connectivity makes no warranties as to its accuracy or completeness and disclaims any liability in connection with its use. TE Connectivity's obligations shall only be as set forth in TE Connectivity's Standard Terms and Conditions of Sale for this product and in no case will TE Connectivity be liable for any incidental, indirect or consequential damages arising out of the sale, resale, use or misuse of the product. Users of TE Connectivity products should make their own evaluation to determine the suitability of each such product for the specific application.

© 2015 TE Connectivity Ltd. family of companies All Rights Reserved.