



HIRSCHMANN MOBILITY

Cellular Outdoor Antenna

CEL 8026 STAT/Series

Part Number 602-458-XXX

Features

- For fix wall mounting
- Omnidirectional radiation

Technical Data

Dimensions (without bracket)	275 mm x 16 mm
Housing materials	PE UV-resistant
Bracket Material	Stainless steel
Weight	355 g
Temperature range	-30°C - +80°C
Protection class	IP66 (acc. IEC 60529)
Cable type	RG 58

Technical Data

Cellular	
Frequency range	Low: 790 - 960 MHz High: 1710 - 2700 MHz
Services	2G: GSM 850/900 MHz GSM 1800/1900 MHz 3G: UMTS 4G: LTE-bands 1 - 10; 14 - 20; 23; 25; 26; 30; 34 - 41)
Impedance	50 Ohm
Return loss (VSWR)	< 2.0
Radiation pattern	omnidirectional (horizontal)
Load capacity	max. 10 W (c.w.)
Polarization	vertical
Gain	2 dBi*

* dBi: referenced to an isotropic radiator

Versions

PN	Description	CELL
602-458-001	CEL 8026 STAT/FME/5.0	5000 +50 mm FMEf
602-458-002	CEL 8026 STAT/SMA/5.0	5000 +50 mm SMAm

Technical Drawing

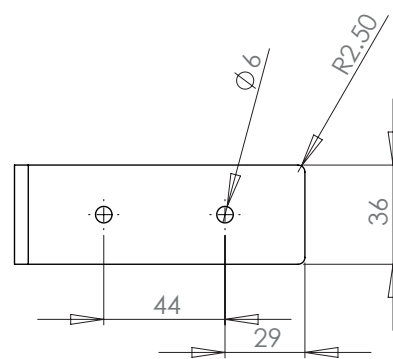
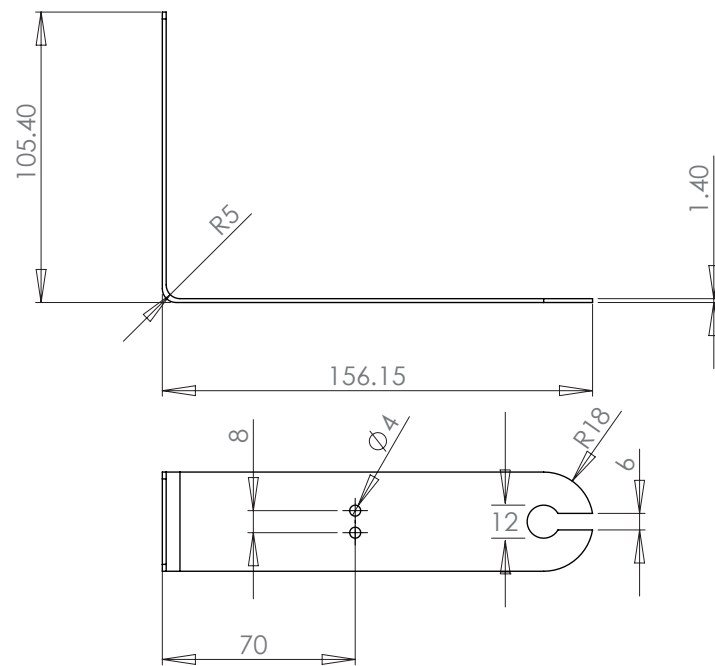
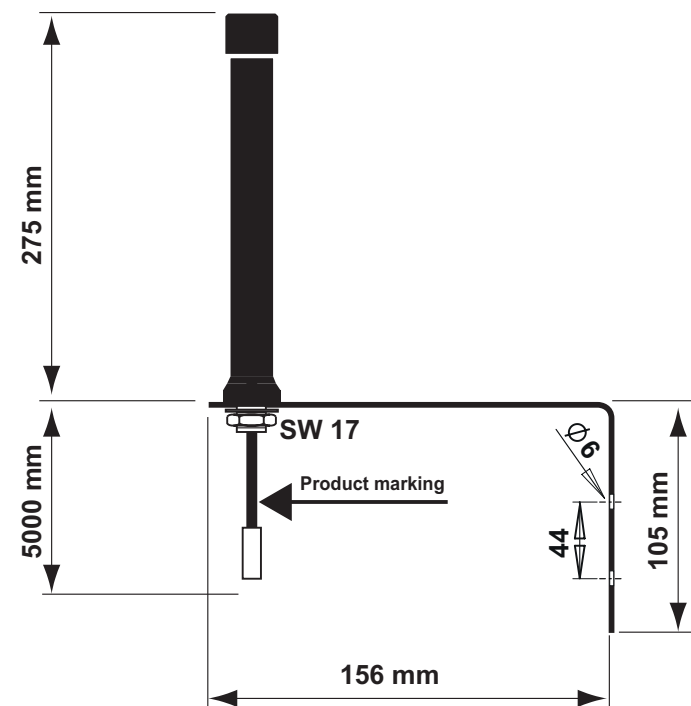

te.com/hirschmann-mobility

hirschmann-mobility@te.com

Hirschmann Car Communication GmbH,
a TE Connectivity Company
Stuttgarter Strasse 45-51
72654 Neckartenzlingen | Germany
Phone: +49 7127 14-0 | Fax: +49 7127 14-1428

TE, TE Connectivity, and TE connectivity (logo) are trademarks.
Hirschmann, LTE, GSM and UMTS are trademarks.
Other products and/or company names might be trademarks of their respective owners.

DISCLAIMER While TE Connectivity (TE) has made every reasonable effort to ensure the accuracy of the information in this data sheet, TE does not guarantee that it is error-free, nor does TE make any other representation, warranty or guarantee that the information is accurate, correct, reliable or current. TE reserves the right to make any adjustments to the information contained herein at any time without notice. TE expressly disclaims all implied warranties regarding the information contained herein, including, but not limited to, any implied warranties of merchantability or fitness for a particular purpose. The dimensions in this data sheet are for reference purposes only and are subject to change without notice. Specifications are subject to change without notice. Consult TE for the latest dimensions and design specifications.

© 2022 TE Connectivity. All Rights Reserved. | Published 03-2022