

P	LTR	DESCRIPTION	DATE	DWN	APVD
	B	REDRAWN FOR RELEASE	21MAR2023	BDA	MB

## VERSAFIT (2:1 RATIO)

SINGLE WALL TUBE. A PREMIUM GRADE HEAT SHRINK TUBE PRIMARILY USED FOR ELECTRICAL INSULATION. HAS A UL224 APPROVAL AND SEVERAL MILITARY RELATED APPROVALS. AVAILABLE IN SEVERAL COLOURS.

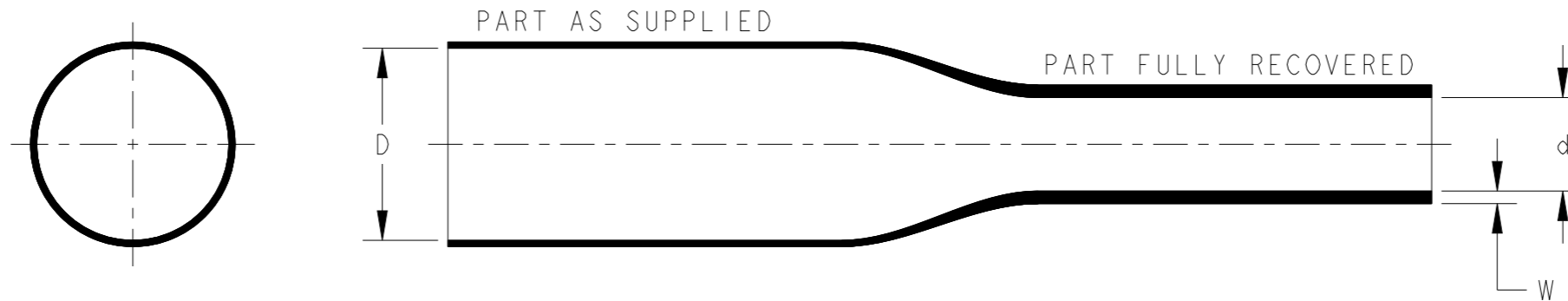

### PRODUCT DIMENSIONS

SIZE	AS SUPPLIED		RECOVERED							
	INSIDE DIAMETER (D)		INSIDE DIAMETER MAXIMUM (d)	WALL THICKNESS (W)						
	mm.	in.		MINIMUM		MAXIMUM		NOMINAL		
	mm.	in.	mm.	in.	mm.	in.	mm.	in.	mm.	in.
3/64	1.63±0.20	0.064±0.008	0.58	0.023	0.32	0.013	0.48	0.019	0.40	0.016
1/16	1.85±0.20	0.073±0.008	0.79	0.031	0.35	0.014	0.51	0.020	0.43	0.017
3/32	2.79±0.20	0.110±0.008	1.17	0.046	0.43	0.017	0.59	0.023	0.51	0.020
1/8	3.43±0.20	0.135±0.008	1.57	0.062	0.43	0.017	0.59	0.023	0.51	0.020
3/16	5.21±0.30	0.205±0.012	2.36	0.093	0.43	0.017	0.59	0.023	0.51	0.020
1/4	7.11±0.30	0.280±0.012	3.17	0.125	0.56	0.022	0.72	0.028	0.64	0.025
3/8	10.16±0.40	0.400±0.016	4.74	0.187	0.56	0.022	0.72	0.028	0.64	0.025
1/2	13.72±0.40	0.540±0.016	6.35	0.250	0.56	0.022	0.72	0.028	0.64	0.025
5/8	16.90±0.40	0.665±0.016	8.00	0.315	0.68	0.027	0.84	0.033	0.76	0.030
3/4	20.45±0.40	0.805±0.016	9.52	0.375	0.68	0.027	0.84	0.033	0.76	0.030
1	26.80±0.40	1.055±0.016	12.70	0.500	0.76	0.030	1.01	0.040	0.88	0.035
1-1/4	33.40±0.70	1.315±0.028	15.88	0.625	0.86	0.034	1.17	0.046	1.01	0.040
1-1/2	39.88±0.80	1.570±0.031	19.05	0.750	0.86	0.034	1.17	0.046	1.01	0.040
2	52.83±1.00	2.080±0.039	25.40	1.000	0.96	0.038	1.32	0.052	1.14	0.045
3	78.49±1.00	3.090±0.039	38.10	1.500	1.17	0.046	1.47	0.058	1.32	0.052
4	104.14±1.30	4.100±0.051	50.80	2.000	1.17	0.046	1.63	0.064	1.39	0.055

### PRODUCT INFORMATION

SHRINK RATIO - 2:1

LONGITUDINAL SHRINKAGE ON FULL RECOVERY +1 TO -5%

STANDARD COLOURS: BLACK, WHITE, RED, BLUE, YELLOW.  
NON-STANDARD COLOURS: BROWN, ORANGE, GREEN, VIOLET, GREY  
FLAME RETARDANT

TUBING CUT TO SPECIFIC LENGTHS CAN BE SUPPLIED FROM THE PRODUCT SIZES REFERENCED WITHIN THIS DRAWING.

STANDARD CUTTING TOLERANCES (mm)	
CUT LENGTH	TOLERANCE
UPTO TO 9.90mm	±1.50mm
10mm TO 24.90mm	±1.50mm
25mm TO 54.90mm	±1.50mm
55mm TO 99.90mm	±3.00mm
100mm TO 149.90mm	±4.00mm
150mm TO 499.90mm	±5.00mm
500mm AND GREATER	±25.40mm

THIS DRAWING IS A CONTROLLED DOCUMENT.

DIMENSIONS:  
mm (Inches)

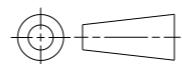

MATERIAL  
SEE NOTE

TOLERANCES UNLESS OTHERWISE SPECIFIED:

0 PLC	±
1 PLC	±0.1
2 PLC	±0.01
3 PLC	±0.001
4 PLC	±0.0001
ANGLES	±
FINISH	-

DWN	06MAR2023
BASAVARAJA D A	
CHK	06MAR2023
SELVAPANDIAN B	
APVD	06MAR2023
MAYO BAKARE	
PRODUCT SPEC	RW-3009
APPLICATION SPEC	114-120022
WEIGHT	-
CUSTOMER DRAWING	

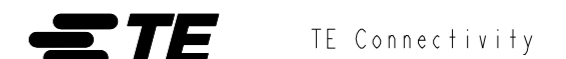

NAME  
VERSAFIT(2:1 RATIO)-IRRADIATED  
MODIFIED POLYOLEFIN SINGLE WALL  
HEAT SHRINK TUBING

SIZE	CAGE CODE	DRAWING NO	RESTRICTED TO
A3	-	VERSAFIT_2_TO_1	-
SCALE	SHEET	OF	REV
NTS	1	1	B