

NOTES:

General Note:

1. All assemblies must be 100% tested for VSWR
2. No component substitutions are permitted

Mechanical Note:

1. Overall Height: 84 mm from G.P.
2. Weight: 3.4 oz
3. IP Rating: IP67
4. Operating temp: -30C to +80C
5. Color: Black
6. Mounting: NMO
7. Installation Torque: 4 - 6 ft*lbs

Electrical Note:

1. Frequency Range: 698 - 960 MHz; 1710 - 2700 MHz
2. VSWR: $\leq 2.3:1 @ 698\text{MHz}$, $\leq 2:1 @ 1710\text{MHz}$
3. Nominal Impedance: 50 OHM
4. Gain (dBi): 3 dBi
5. Polarization: Vertical
6. Pattern: Omnidirectional
7. Ground Plane: Tested on 2' x 2' G.P.

Packaging Note:

1. TE Part Number: TRA6927M3NB-001
2. Package: S1136
3. Units per Package: 1
4. Package Label: Printed Bag
5. Box: N/A
6. Units per Box: N/A
7. Box Label: N/A

REVISIONS					
ZONE	REV.	DESCRIPTION	DATE	DRAWN BY	ECR NUMBER
	A	Initial Release	1/26/2012	BPH	N/A
B2	B	Frequency Range was 698-896 MHz	25APR14	RLS	ECN 2365

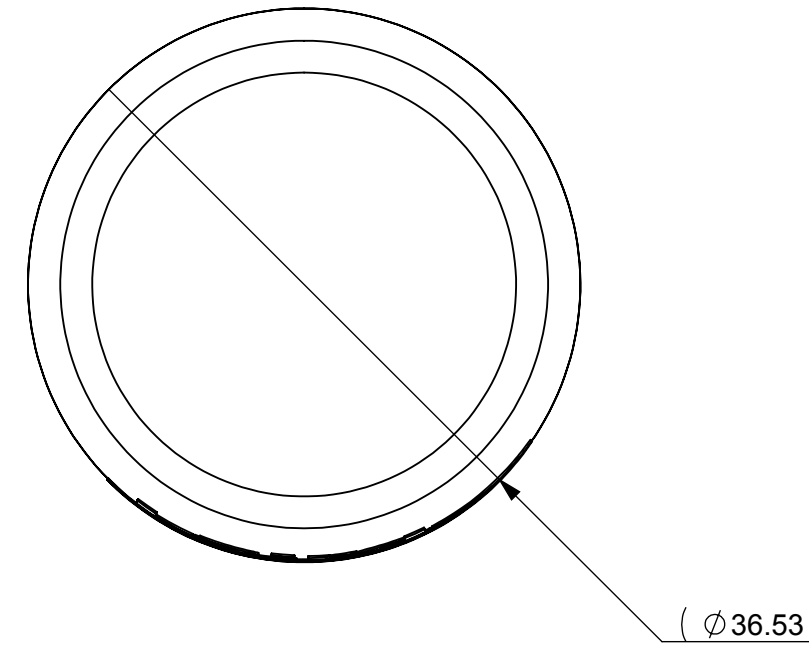

High Strength Impact Resistant ABS Radome

Rugged Insert Molded Design

O-ring must be in place during installation and must get full compression on the ground plane or surface



(84)

THIS DRAWING IS UNPUBLISHED.	RELEASED FOR PUBLICATION
© Copyright 2022 TE Connectivity Ltd.	ALL RIGHTS RESERVED.

MATERIAL: N/A		THIRD ANGLE PROJECTION	
FINISH: N/A			
APPROVALS	DATE	INTERPRET DIMENSIONING AND TOLERANCING IN ACCORDANCE WITH ASME Y14.5M-1994	
ME: S. SAFVI	25APR14	DO NOT SCALE DRAWING	
RF: R. HARO	25APR14	TOLERANCES UNLESS OTHERWISE SPECIFIED	
EM:		DIMENSIONS ARE IN MILLIMETERS	
Prod:		ANGLE: $\pm 30'$ 0 PLACE DECIMAL: ± 0.5 1 PLACE DECIMAL: ± 0.25 2 PLACE DECIMAL: ± 0.13	
WEIGHT:		PREVIOUS#	SCALE:
			SHEET 1 OF 1
		SIZE DWG NO.	REV
		A2 TRA6927M3NB-001 - MO	B