

REVISIONS				
P	LTN	DESCRIPTION	DATE	APVD
A		NEW DRAWING	14AUG2023	BDA VN
A1		DRAWING CLARIFICATION	26FEB2024	AN VN

COMPONENT 1  
(DIMENSIONS REFER FROM  
STANDARD SIZES DRAWING AS PER BELOW TABLE)

COMPONENT 2  
GENERIC VIEW

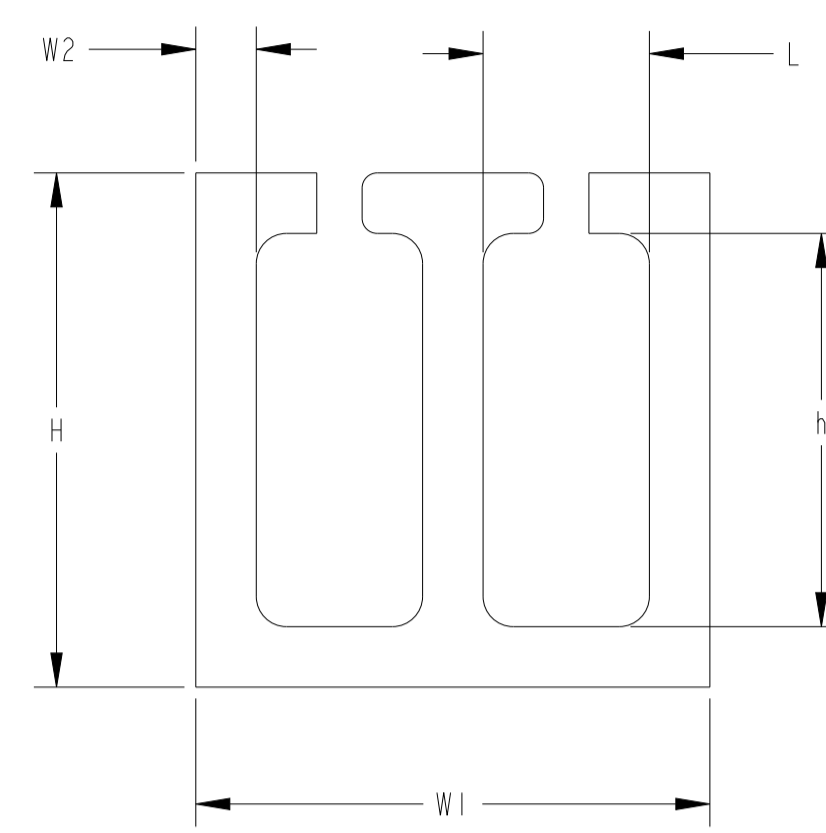
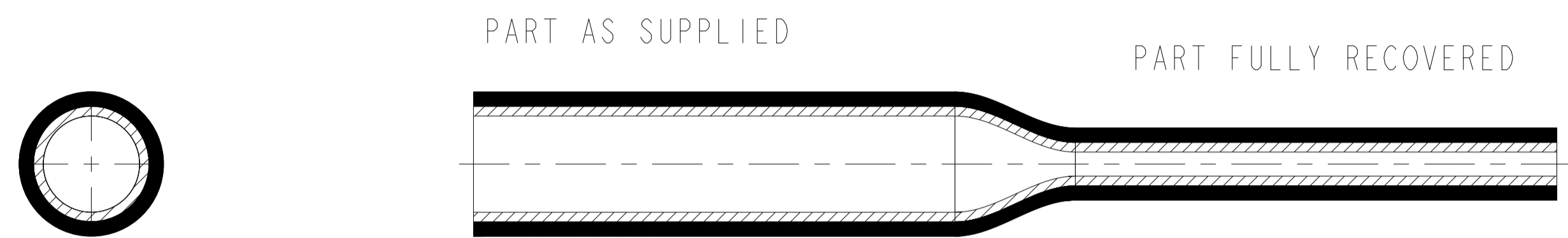

PRODUCT DIMENSIONS

PART NUMBER	COMPONENT 1 (DIMENSIONS REFER FROM STANDARD DRAWING)	PART DESCRIPTION	COMPONENT 2										CHANNELS	PRODUCT INDIVIDUAL CHANNELS VIEW	SUPPLIED CUT LENGTH
			H ±20 %		h ±20 %		L ±20 %		W1 ±20 %		W2 ±30 %				
			mm	in.	mm	in.	mm	in.	mm	in.	mm	in.			
EL6510-000 RBK-85-KIT-0102-AX	RPPM-12/3-X-34MM RPPM	RBK-85-NR5020/A-X-8MM	8.50	0.335	6.50	0.256	2.75	0.108	8.50	0.335	1.00	0.039	2		8.00
EL6516-000 RBK-85-KIT-0102-A0	ATUM-12/3-0-40MM ATUM_4_to_RATIO_STANDARD_SIZES														
EM9002-000 RBK-85-KIT-1202-A0	ATUM-12/3-0-35MM ATUM_4_to_RATIO_STANDARD_SIZES														
EL6473-000 RBK-85-KIT-0103-AX	RPPM-16/4-X-33MM RPPM	RBK-85-NR5030/A-X-8MM	8.55	0.337	6.50	0.256	2.75	0.108	12.25	0.482	1.00	0.039	3		8.00
EL6529-000 RBK-85-KIT-0203-A0	ATUM-24/6-0-47MM ATUM_4_to_RATIO_STANDARD_SIZES														
EL6479-000 RBK-85-KIT-0405-A0	ATUM-24/6-0-45MM ATUM_4_to_RATIO_STANDARD_SIZES	RBK-85-NR5040/A-X-8MM	8.50	0.335	6.50	0.256	2.75	0.108	16.00	0.630	1.00	0.039	4		8.00
EM9004-000 RBK-85-KIT-0104-AX	RPPM-16/4-X-44MM RPPM														
EM9005-000 RBK-85-KIT-0504-A0	ATUM-16/4-0-40MM ATUM_4_to_RATIO_STANDARD_SIZES														
EL6517-000 RBK-85-KIT-0705-A0	ATUM-24/6-0-32MM ATUM_4_to_RATIO_STANDARD_SIZES	RBK-85-NR5050/A-X-8MM	8.55	0.337	6.50	0.256	2.75	0.108	21.00	0.827	1.00	0.039	5		8.00

PRODUCT INFORMATION

- COMPONENT 2 MATERIAL: HOT MELT ADHESIVE COLOUR: AMBER
- TUBING CUT TO SPECIFIC LENGTHS CAN BE SUPPLIED FROM THE PRODUCT SIZES REFERENCED WITHIN THIS DRAWING

STANDARD CUTTING TOLERANCES (mm)	
CUT LENGTH	TOLERANCE
UPTO TO 9.90mm	±1.50mm
10mm TO 24.90mm	±1.50mm
25mm TO 54.90mm	±1.50mm
55mm TO 99.90mm	±3.00mm
100mm TO 149.90mm	±4.00mm
150mm TO 499.90mm	±5.00mm
500mm AND GREATER	±25.40mm

THIS DRAWING IS A CONTROLLED DOCUMENT.

DIMENSIONS: mm

TOLERANCES UNLESS OTHERWISE SPECIFIED:

0 PLC	±
1 PLC	±
2 PLC	±
3 PLC	±
4 PLC	±
ANGLES	±
FINISH	±

MATERIAL: SEE NOTES

DATE: 14AUG2023

BY: BASAVARAJA D A

CHK: SELVAPANDIAN B

APVD: VLADIMIR NEMEC

PRODUCT SPEC: 108-120025

APPLICATION SPEC: 114-120023

WEIGHT: -

CUSTOMER DRAWING

TE Connectivity

NAME: RBK-85-KIT-STANDARD\_SIZES

SIZE: A1

CAGE CODE: -

DRAWING NO: RBK-85-KIT-STANDARD\_SIZES

RESTRICTED TO: -

SCALE: NTS

SHEET: 1 OF 2

REV: A1

REVISIONS				
P	LTN	DESCRIPTION	DATE	APVD
-		SEE SHEET 1	-	-

PART NUMBER	COMPONENT 1 (DIMENSIONS REFER FROM STANDARD DRAWING)	PART DESCRIPTION	COMPONENT 2										CHANNELS	PRODUCT INDIVIDUAL CHANNELS VIEW	SUPPLIED CUT LENGTH
			H ±20 %		h ±20 %		L ±20 %		W1 ±20 %		W2 ±30 %				
			mm	.in	mm	.in	mm	.in	mm	.in	mm	.in			
EL6597-000 RBK-85-KIT-0105-B0	ATUM-16/4-0-23MM ATUM_4_+o_RATIO_STANDARD_SIZES	RBK-85-NR5050/B-X-8MM	5.80	0.228	4.20	0.165	2.50	0.098	15.50	0.610	0.50	0.020	5		8.00
EL6483-000 RBK-85-KIT-0107-A0	ATUM-24/6-0-65MM ATUM_4_+o_RATIO_STANDARD_SIZES	RBK-85-NR5070/A-X-8MM	8.55	0.337	6.50	0.256	2.75	0.108	27.25	1.073	1.00	0.039	7		8.00
EM9006-000 RBK-85-KIT-1007-A0	ATUM-24/6-0-65MM ATUM_4_+o_RATIO_STANDARD_SIZES														
EM9007-000 RBK-85-KIT-1107-AX	RPPM-16/4-X-44MM RPPM														
EL6513-000 RBK-85-KIT-0208-AX	ATUM-24/8-X-47MM ATUM_3_+o_I_RATIO_STANDARD_SIZES	RBK-85-NR5080/A-X-8MM	8.50	0.335	6.50	0.256	2.75	0.108	31.00	1.220	1.00	0.039	8		8.00
EM9010-000 RBK-85-KIT-1308-A0	ATUM-24/6-0-47MM ATUM_4_+o_RATIO_STANDARD_SIZES														
EM8997-000 RBK-85-KIT-0510-A0	ATUM-32/8-0-55MM ATUM_4_+o_RATIO_STANDARD_SIZES	RBK-85-NR5100/A-X-12MM	8.50	0.335	6.50	0.256	2.75	0.108	38.50	1.516	1.00	0.039	10		12.00
EM9009-000 RBK-85-KIT-2110-A0	ATUM-32/8-0-100MM ATUM_4_+o_RATIO_STANDARD_SIZES														

THIS DRAWING IS A CONTROLLED DOCUMENT.

DIMENSIONS: mm  
 TOLERANCES UNLESS OTHERWISE SPECIFIED:  
 0 PLC ±  
 1 PLC ±  
 2 PLC ±  
 3 PLC ±  
 4 PCC ±  
 ANGLES ±  
 FINISH ±

MATERIAL: SEE NOTES  
 WEIGHT: -  
 FINISH: -

DWN: BASAVARAJA D A 14AUG2023  
 CHK: SELVAPANDIAN B 14AUG2023  
 APVD: VLADIMIR NEBEC 14AUG2023  
 PRODUCT SPEC: 108-120025  
 APPLICATION SPEC: 114-120023  
 CUSTOMER DRAWING

NAME: RBK-85-KIT-STANDARD\_SIZES  
 SIZE: A1  
 CAGE CODE: -  
 DRAWING NO: 114-120023  
 RESTRICTED TO: -  
 SCALE: NTS  
 SHEET: 2 OF 2  
 REV: A1