

P	LTR	DESCRIPTION	DATE	DWN	APVD
	A	TE STANDARD FORMAT UPDATED	06FEB2024	KS	RB

NOTES  
Bemerkungen:

1 TE-CONNECTIVITY ORDER-NUMBER  
TE-Connectivity Bestellnummer

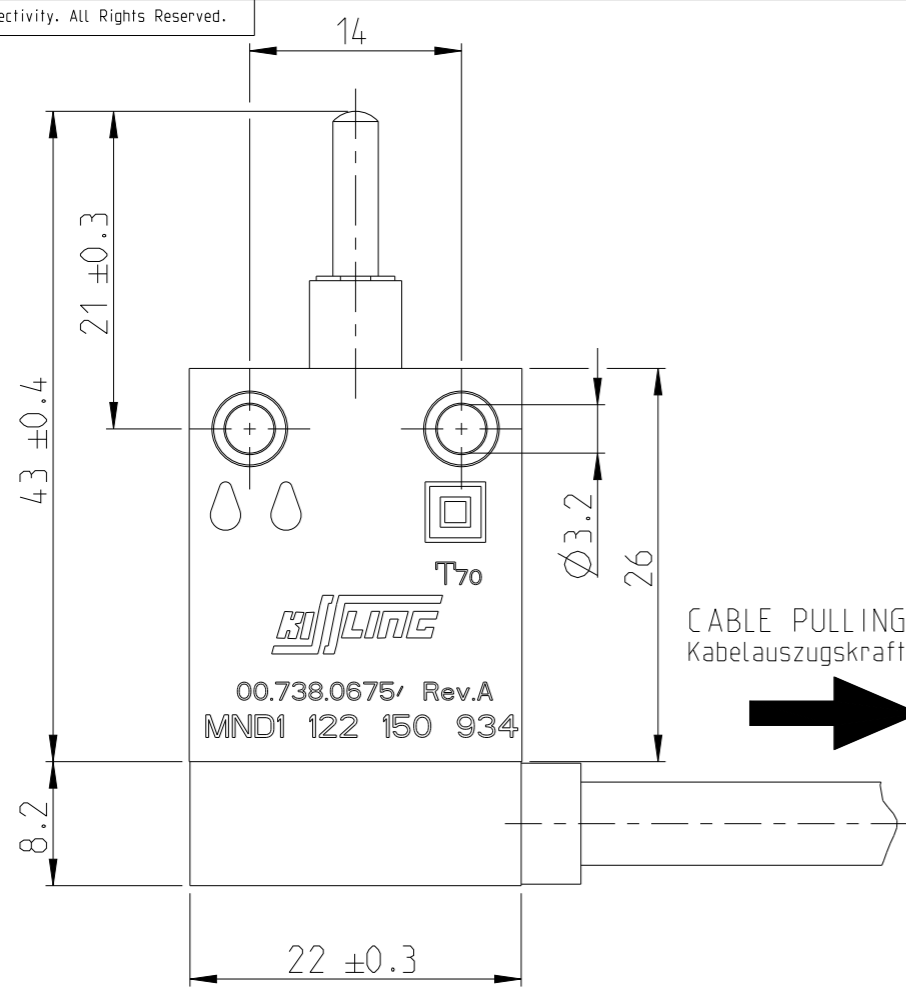

CABLE PULLING FORCE MAX. 10 N  
Kabelauszugskraft max.10 N

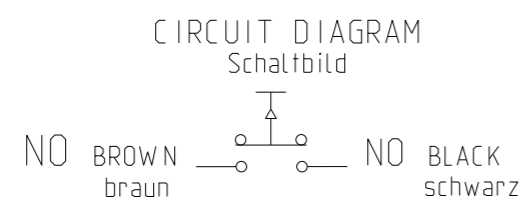
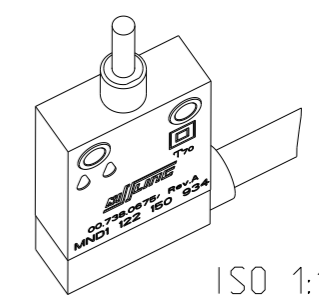
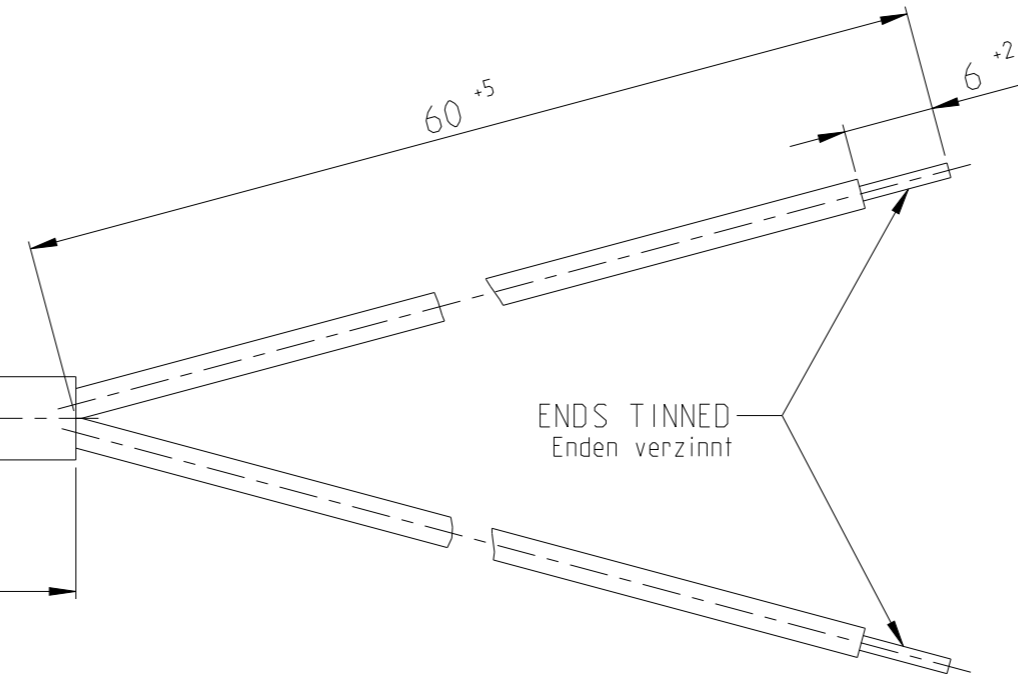
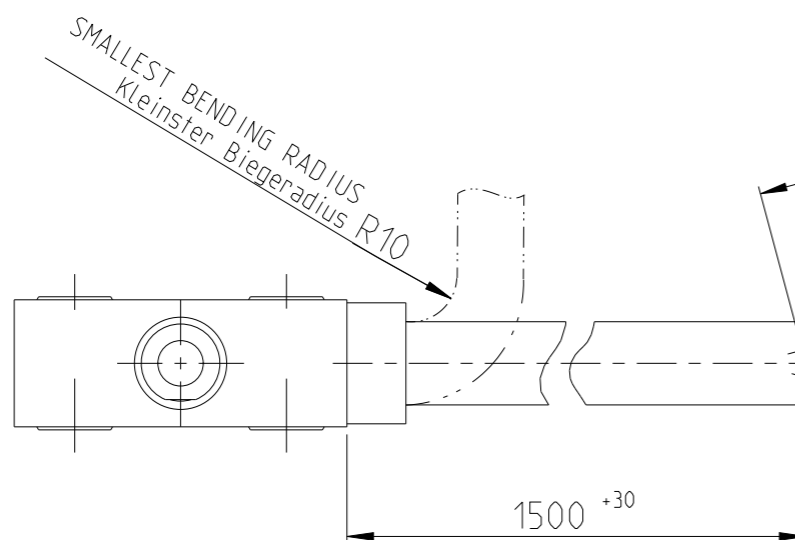
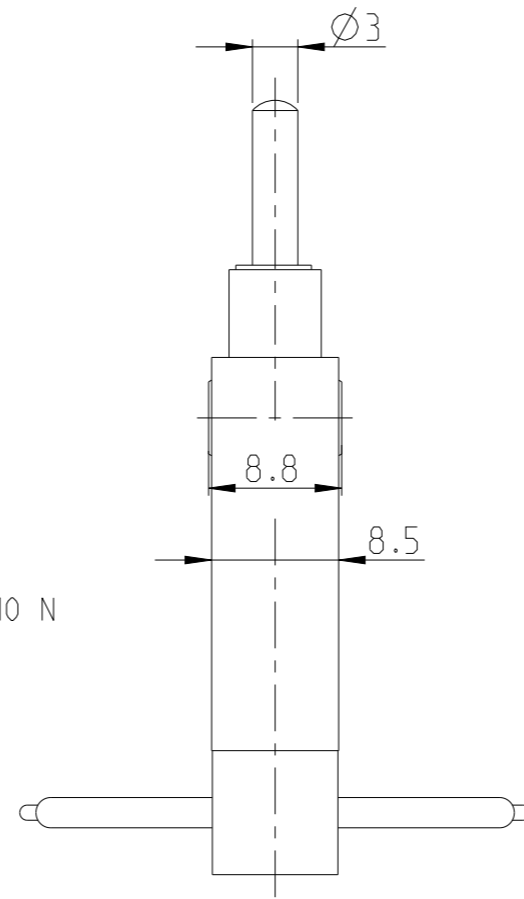
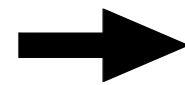

K1120031	1	A	MICRO SWITCH Mikroschalter	80	1
PART/TCPN NO.	REV.	DESCRIPTION	WEIGHT [g]	ITEM NO.	
PARTS LIST					

THIS DRAWING IS A CONTROLLED DOCUMENT.		DWN K.Braun 21OCT2003
DIMENSIONS: mm		CHK K.Braun 21OCT2003
TOLERANCES UNLESS OTHERWISE SPECIFIED: DIN ISO 2768 cL		APVD K.Seeger 19FEB2008
0 PLC ±		PRODUCT SPEC
1 PLC ±		APPLICATION SPEC
2 PLC ±		WEIGHT
3 PLC ±		CUSTOMER DRAWING
4 PLC ±		
ANGLES ±		
FINISH		
MATERIAL		

<b>TE</b> TE Connectivity		NAME MICRO SWITCH Mikroschalter	
SIZE A3	CAGE CODE 00779	DRAWING NO MND1-122-150-934	RESTRICTED TO -
SCALE 2:1		SHEET 1 OF 2	REV A

REVISIONS

P	LTR	DESCRIPTION	DATE	DWN	APVD
	-	SEE SHEET 1	-	-	-

CONSTRUCTION

HOUSING MATERIAL.....PA6 GF30  
COVER MATERIAL.....PA6 GF30  
CONNECTION.....CABLE H03VV-F 2X0.75 qmm  
PROTECTION.....IP 67 IEC 60 529  
PROTECTIVE INSULATION.....0 0

Aufbau

Gehäusewerkstoff.....PA6 GF30  
Deckelwerkstoff.....PA6 GF30  
Anschluß.....Kabel H03VV-F 2x0,75 qmm  
Schutzart.....IP 67 IEC 60 529  
Schutzisolierung.....0 0

MECHANICAL DATA

PRE-TRAVEL.....0.6 TO 1.5 mm  
OVERTRAVEL.....MIN 2 mm  
MOVEMENT DIFFERENTIAL.....0.2 TO 0.7 mm  
OPERATING FORCE.....MAX. 10N  
RELEASE FORCE.....> 1 N  
MAX. OPERATING FORCE.....< 20 N  
CURRENT CARRYING PARTS.....Cu-ALLOYS  
CONTACT MATERIAL.....Ag GAL. Au  
LIFE CYCLE MECHANICAL .....10 MILLION  
FREQUENCY.....MAX. 100 PER MINUTE  
OPERATING SPEED IN DIRECTION OF PLUNGER.....MIN. 0.1 mm/s  
.....MAX. 10 mm/s  
AMBIENT TEMPERATURE.....-10°C TO +85°C

Mechanische Daten

Vorlauf.....0,6 bis 1,5 mm  
Nachlauf.....min. 2 mm  
Differenzweg.....0,2 bis 0,7 mm  
Schaltkraft.....max. 10 N  
Rückschaltkraft.....> 1 N  
Betaetigungskraft max.....< 20 N  
Stromführende Teile.....Cu-Legierungen  
Kontaktwerkstoff.....Ag gal. Au  
Lebensdauer mechanisch.....10 Mio.  
Schalthäufigkeit.....max. 100 pro Minute  
Betätigungsgeschwindigkeit in Stoßrichtung.....min. 0,1 mm/s  
.....max. 10 mm/s  
Umgebungstemperatur.....-10°C bis +85°C

ELECTRICAL DATA

SWITCHING CAPACITY MAX.....60 V DC, 50 mA  
.....24 V DC, 100 mA  
.....12 V DC, 100 mA  
.....6 V DC, 100 mA  
.....5 V DC, 2 mA

Elektrische Daten

Schaltleistung max.....60 V DC, 50 mA  
.....24 V DC, 100 mA  
.....12 V DC, 100 mA  
.....6 V DC, 100 mA  
.....5 V DC, 2 mA

THE SWITCHING OF HIGHER VOLTAGES LEADS TO THE DESTRUCTION OF THE GOLD LAYER

Das Schalten groesserer Leistungen fuehrt zur Zerstörung der Goldschicht.

THIS DRAWING IS A CONTROLLED DOCUMENT.		DWN K.Braun 21OCT2003	TE Connectivity	
		CHK K.Braun 21OCT2003		
DIMENSIONS: mm	TOLERANCES UNLESS OTHERWISE SPECIFIED: DIN ISO 2768 cL	APVD K.Seeger 19FEB2008	NAME MICRO SWITCH Mikroschalter	
	0 PLC ± 1 PLC ± 2 PLC ± 3 PLC ± 4 PLC ± ANGLES ±	PRODUCT SPEC	RESTRICTED TO	
MATERIAL	FINISH	APPLICATION SPEC	SIZE A3	CAGE CODE 00779
		WEIGHT	DRAWING NO MND1-122-150-934	
		CUSTOMER DRAWING	SCALE 2:1	SHEET 2 OF 2
			REV A	