

4

3

2

1

THIS DRAWING IS UNPUBLISHED. RELEASED FOR PUBLICATION
 © COPYRIGHT - TE Connectivity Ltd. ALL RIGHTS RESERVED.

REVISIONS				
P	LTR	DESCRIPTION	DATE	APVD
B		PRELIMINARY NOTE ADDED PER ECO-20-010436	08/20	AS KP

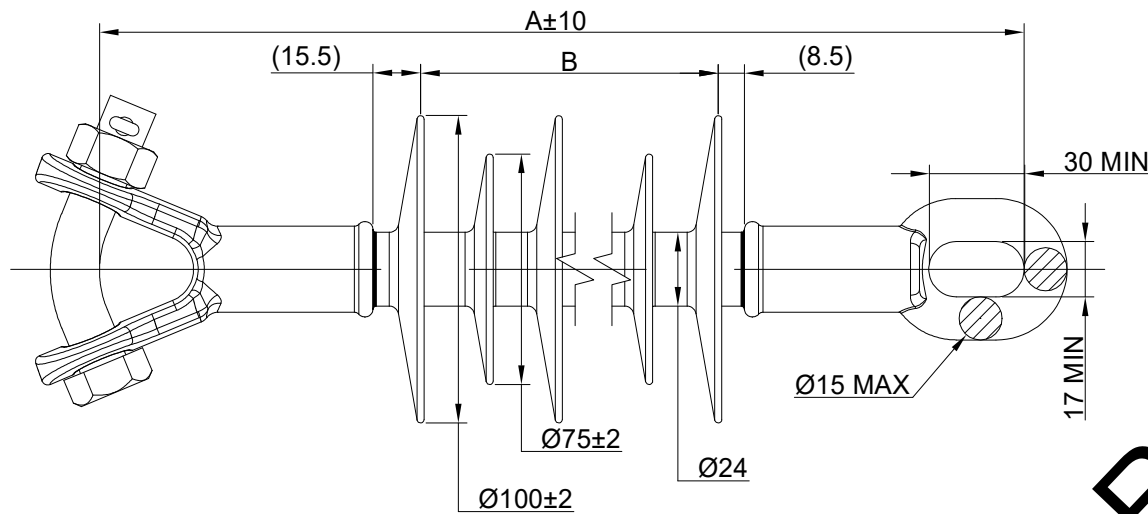

- MATERIALS:**
- CORE : ECR FIBERGLASS REINFORCED POLYMER
 - HOUSING : SILICONE RUBBER
 - END FITTINGS : Y-CLEVIS CONFORMS TO IEC 61466-1-16
EYE CONFORMS TO IEC 61466-1-17
 - HARDWARE : GALVANIZED STEEL
 - SPLIT PIN : STAINLESS STEEL
 - TEST STANDARDS : IEC 61109 & IEC 62217

- MECHANICAL PROPERTIES:**
- SPECIFIC MECHANICAL LOAD (SML) : 70 kN
 - ROUTINE TENSILE LOAD (RTL) : 35 kN

- PRODUCT MARKINGS:**
- TE LOGO
 - SML 70kN
 - YEAR & MONTH
 - BATCH NO #

TCPN	DESCRIPTION	NO. OF BIG SHED (#)	NO. OF SMALL SHED (#)	NOMINAL CREEPAGE (mm)	NOMINAL DRY ARCING (mm)	DRY AC WITHSTAND (kV)	WET AC WITHSTAND (kV)	DRY AC FLASHOVER (kV)	WET AC FLASHOVER (kV)	LIGHTNING IMPULSE WITHSTAND (kV)	LIGHTNING IMPULSE FLASHOVER (kV)	A (mm)	B (mm)	APPROX. WEIGHT (Kg)
EP1100-000	CS-70-YE-120-0415-M-11	3	2	415	165	80	65	85	80	120	130	294	90	1.06
EP1101-000	CS-70-YE-145-0580-M-11	4	3	580	210	95	80	100	95	145	155	339	135	1.14
EP1102-000	CS-70-YE-170-0740-M-11	5	4	740	255	110	95	115	105	170	180	384	180	1.22
EP1103-000	CS-70-YE-195-0900-M-11	6	5	900	300	125	110	130	120	195	200	429	225	1.30
EP1104-000	CS-70-YE-215-1065-M-11	7	6	1065	345	140	125	145	135	215	225	474	270	1.38
EP1105-000	CS-70-YE-240-1225-M-11	8	7	1225	390	155	140	160	150	240	250	519	315	1.46
EP1106-000	CS-70-YE-265-1390-M-11	9	8	1390	435	170	155	175	165	265	275	564	360	1.54
EP1107-000	CS-70-YE-290-1550-M-11	10	9	1550	480	185	170	190	175	290	300	609	405	1.62
EP1108-000	CS-70-YE-310-1710-M-11	11	10	1710	525	200	185	205	190	310	325	654	450	1.70
EP1109-000	CS-70-YE-335-1875-M-11	12	11	1875	570	215	195	220	205	335	350	699	495	1.78
EP1110-000	CS-70-YE-360-2035-M-11	13	12	2035	615	230	210	235	220	360	375	744	540	1.86
EP1111-000	CS-70-YE-380-2200-M-11	14	13	2200	660	245	225	250	235	380	400	789	585	1.94
EP1112-000	CS-70-YE-405-2360-M-11	15	14	2360	705	260	240	265	250	405	425	834	630	2.02
EP1113-000	CS-70-YE-430-2520-M-11	16	15	2520	750	275	255	280	260	430	450	879	675	2.10
EP1114-000	CS-70-YE-455-2685-M-11	17	16	2685	795	290	270	295	275	455	475	924	720	2.18
EP1115-000	CS-70-YE-475-2845-M-11	18	17	2845	840	305	285	310	290	475	500	969	765	2.26
EP1116-000	CS-70-YE-500-3010-M-11	19	18	3010	885	320	300	325	305	500	525	1014	810	2.34

NOTES:
 UNSPECIFIED TOLERANCE
 1) ±(0.04 x d + 1.5)mm WHEN d < 300mm
 2) ±(0.025 x d + 6)mm WHEN d > 300mm
 WITH MAX. TOLERANCE OF ±50mm

THIS DRAWING IS A CONTROLLED DOCUMENT.		DWN GHANSHYAM 10-10-2019	TE Connectivity EXTRA HIGH CREEP TENSION DISTRIBUTION INSULATOR-Y&E	
DIMENSIONS: mm		CHK A. SABARAD 09-08-2020		
TOLERANCES UNLESS OTHERWISE SPECIFIED:		APVD K. PUSTHAY 09-08-2020	NAME	
0 PLC ±- 1 PLC ±- 2 PLC ±- 3 PLC ±- 4 PLC ±- ANGLES ±-		PRODUCT SPEC	SIZE	
MATERIAL		APPLICATION SPEC	CAGE CODE	
FINISH		WEIGHT	DRAWING NO	
		CUSTOMER DRAWING	RESTRICTED TO	
		SCALE NTS	SHEET 1 of 1	
			REV B	