

P	LTR	DESCRIPTION	DATE	DWN	APVD
	A1	REDRAWN PER ECO-21-004571	29APR2020	RS	KP

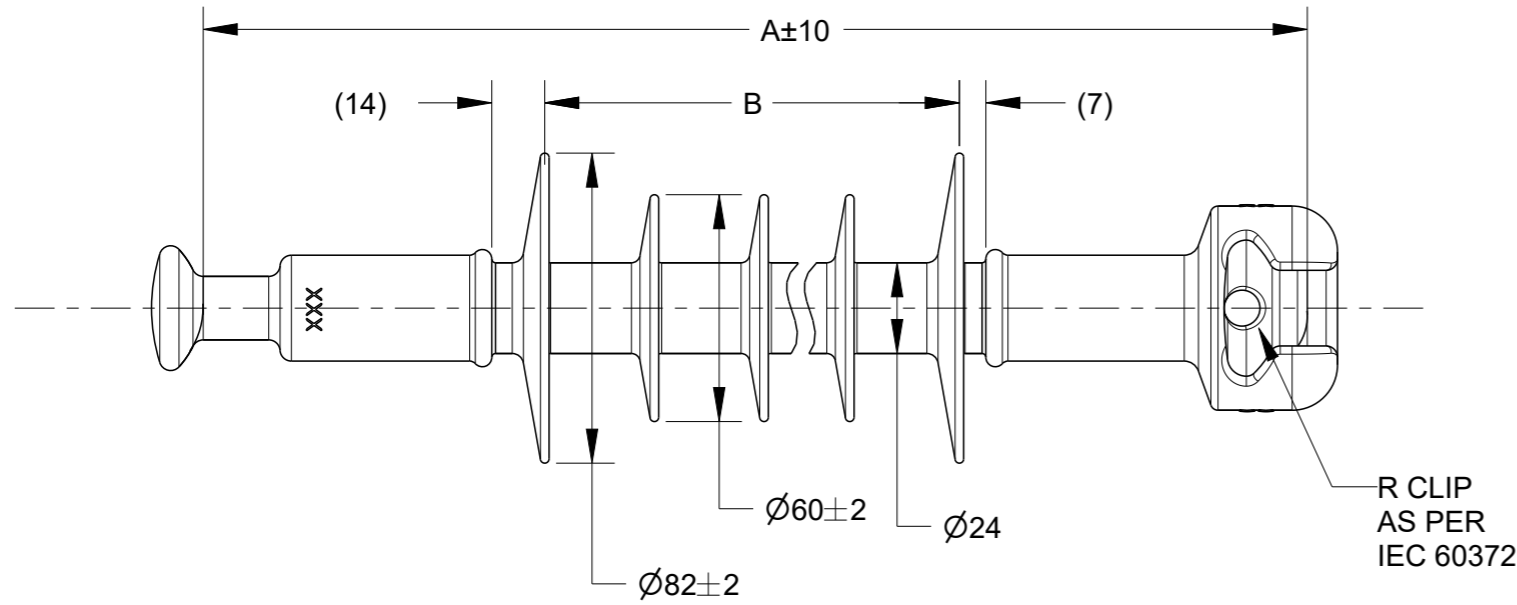

MATERIALS:

1. CORE : ECR FIBERGLASS REINFORCED POLYMER
2. HOUSING : SILICONE RUBBER
3. END FITTINGS : BALL CONFORMS TO IEC 120-16
SOCKET CONFORMS TO IEC 120-16A
4. R CLIP : STAINLESS STEEL
5. TEST STANDARDS : IEC 61109 & IEC 62217

MECHANICAL PROPERTIES:

1. SPECIFIED MECHANICAL LOAD (SML) : 70 kN
2. ROUTINE TENSILE LOAD (RTL) : 35 kN

PRODUCT MARKINGS:

1. TE LOGO
2. SML 70kN
3. YEAR & MONTH
4. BATCH NO #

TCPN	DESCRIPTION	NO. OF BIG SHED (#)	NO. OF SMALL SHED (#)	NOMINAL CREEPAGE (mm)	NOMINAL DRY ARCING (mm)	DRY AC WITHSTAND (kV)	WET AC WITHSTAND (kV)	DRY AC FLASHOVER (kV)	WET AC FLASHOVER (kV)	LIGHTNING IMPULSE WITHSTAND (kV)	LIGHTNING IMPULSE FLASHOVER (kV)	A (mm)	B (mm)	APPROX. WEIGHT (Kg)
EP0977-000	CS-70-BS-125-0340-M-01	2	3	340	173	80	60	90	75	125	130	299	116	1.07
EP0978-000	CS-70-BS-140-0400-M-01	2	4	400	202	90	75	100	90	140	150	328	145	1.1
EP0979-000	CS-70-BS-155-0460-M-01	2	5	460	231	100	90	110	90	155	165	357	174	1.13
EP0980-000	CS-70-BS-170-0520-M-01	2	6	520	260	110	90	120	105	170	180	386	203	1.16
EP0981-000	CS-70-BS-185-0585-M-01	2	7	585	289	120	105	130	120	185	195	415	232	1.19
EP0982-000	CS-70-BS-205-0645-M-01	2	8	645	318	130	120	135	120	205	210	444	261	1.22
EP0983-000	CS-70-BS-210-0705-M-01	2	9	705	347	140	120	145	135	210	220	473	290	1.25
EP0984-000	CS-70-BS-220-0765-M-01	2	10	765	376	150	135	155	150	220	230	502	319	1.28
EP0985-000	CS-70-BS-230-0830-M-01	2	11	830	405	160	150	165	155	230	245	531	348	1.31
EP0986-000	CS-70-BS-245-0890-M-01	2	12	890	434	170	160	175	165	245	260	560	377	1.34
EP0987-000	CS-70-BS-270-0950-M-01	2	13	950	463	180	165	185	180	270	275	589	406	1.37
EP0988-000	CS-70-BS-285-1010-M-01	2	14	1010	492	185	175	195	190	285	300	618	435	1.40
EP0989-000	CS-70-BS-310-1075-M-01	2	15	1075	521	195	185	205	200	310	325	647	464	1.43
EP0990-000	CS-70-BS-320-1135-M-01	2	16	1135	550	205	190	215	210	320	340	676	493	1.46
EP0991-000	CS-70-BS-335-1195-M-01	2	17	1195	579	215	195	225	210	335	355	705	522	1.49
EP0992-000	CS-70-BS-350-1255-M-01	2	18	1255	608	225	210	235	225	350	360	734	551	1.52
EP0993-000	CS-70-BS-370-1320-M-01	2	19	1320	637	235	225	245	240	370	390	763	580	1.55
EP0994-000	CS-70-BS-385-1380-M-01	2	20	1380	666	245	225	255	240	385	405	792	609	1.58
EP0995-000	CS-70-BS-400-1440-M-01	2	21	1440	695	255	240	265	255	400	420	821	638	1.61
EP0996-000	CS-70-BS-415-1500-M-01	2	22	1500	724	265	255	275	270	415	435	850	667	1.64
EP0997-000	CS-70-BS-430-1565-M-01	2	23	1565	753	275	255	285	270	430	455	879	696	1.67
EP0998-000	CS-70-BS-445-1625-M-01	2	24	1625	782	285	270	290	285	445	470	908	725	1.70
EP0999-000	CS-70-BS-460-1685-M-01	2	25	1685	811	295	280	300	295	460	485	937	754	1.73
EP1000-000	CS-70-BS-475-1745-M-01	2	26	1745	840	305	285	310	300	475	500	966	783	1.76

NOTES:
 UNSPECIFIED TOLERANCE
 1) ±(0.04 x d + 1.5)mm WHEN d ≤ 300mm
 2) ±(0.025 x d + 6)mm WHEN d > 300mm
 WITH MAX. TOLERANCE OF ±50mm

THIS DRAWING IS A CONTROLLED DOCUMENT.

DIMENSIONS: mm	TOLERANCES UNLESS OTHERWISE SPECIFIED:
	0 PLC ±-
	1 PLC ±-
	2 PLC ±-
	3 PLC ±-
	4 PLC ±-
	ANGLES ±-
MATERIAL	FINISH
-	-

DWN	29APR2020
RAVI.S	
CHK	29APR2020
K.PUSTHAY	
APVD	29APR2020
K.PUSTHAY	
PRODUCT SPEC	-
APPLICATION SPEC	-
WEIGHT	-
CUSTOMER DRAWING	

TE TE Connectivity

TENSION DISTRIBUTION INSULATOR-B&S

NAME	TENSION DISTRIBUTION INSULATOR-B&S		
SIZE	CAGE CODE	DRAWING NO	RESTRICTED TO
A3	00779	INS1611	-
SCALE		SHEET	REV
NTS		1 OF 1	A1