

PROPRIÉTÉS MÉCANIQUES

CHARGE DE RUPTURE MINIMALE EN FLEXION DANS LA ZONE DE COUPLAGE: 2.45kNm SELON ZC13/EC#0307189 SNCF RAPPORT. MDCL = 1kNm

CHARGE DE RUPTURE MINIMALE EN TRACTION DANS LA ZONE DE COUPLAGE: 80KN

PROPRIÉTÉS ÉLECTRIQUES

TENSION DE CONTOURNEMENT à FRÉQUENCE INDUSTRIELLE à SEC: 191 kV
 TENSION DE CONTOURNEMENT à FRÉQUENCE INDUSTRIELLE SOUS PLUIE: 163 kV
 TENSION DE TENUE à FRÉQUENCE INDUSTRIELLE à SEC: 143 kV (30 min.)
 TENSION DE TENUE à FRÉQUENCE INDUSTRIELLE SOUS PLUIE: 141 kV (1 Min.)
 TENUE AU CHOC DE Foudre: 299 kV

PROPRIÉTÉS PHYSIQUES

LONGUEUR NOMINALE DE LA LIGNE DE FUITE 1290 mm
 DISTANCE D'ARC NOMINALE A : SEC 474 MM

MATIÈRES

FRONTE 80-55-06 (ASTM A536-84)
 GALVANISÉE SELON EN-ISO-1461/14713 CLASS S - ST137
 ISOLANT : (EVA) RAYCHEM HV GRIS
 NOYAU : Ø45 RBGF
 RONDELLE D'APPUI (EF0710-000) EN ACIER INDOXYDABLE EST FIXÉE PAR UN COLLIER PLASTIQUE

MARQUAGE:

LDT AA/MM
 2 derniers chiffres de l'année / MOIS
 IDENTIFICATION: RAYCHEM
 INS1126
 SNCF REF : 200499
 0.883.0316

SHEET 1 OF 2

SCD

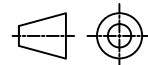

Raychem Insulators

International Science Centre, Block 1, University Of Limerick, Castletroy, Co. Limerick Ireland

DRN	HMF	11/09
CHECK	PK	11/09
APP	MB	11/09
SCALE	NTS	

TOLERANCES UNLESS OTHERWISE SPECIFIED:	
0 PLC	± 1
1 PLC	± 0.1
2 PLC	± 0.01
3 PLC	± 0.001
4 PLC	± 0.0001
ANGLES	± 1°

THIS DRAWING AND THE INFORMATION SET FORTH HEREIN ARE THE PROPERTY OF TE CONNECTIVITY AND ARE TO BE HELD IN TRUST AND CONFIDENCE. PUBLICATION, DUPLICATION, DISCLOSURE OR USE FOR ANY OTHER PURPOSE NOT EXPRESSLY AUTHORISED IN WRITING BY TE CONNECTIVITY LTD IS PROHIBITED.

TITLE	RRA-52G-UUG-690 SALES DRAWING
PCN	CR2701-000
DRG NO	INS1126
REV	4

DOCUMENT REVISION CONTROL

REVISION	DATE	ECO #	REQUESTED BY	CHANGE DETAILS	SIGN
0	11/09	-	-	ORIGINAL ISSUE	HMF
1	10/11	-	-	PRODUCT MARKING DETAIL UPDATED	JH
2	03/12	ECO-12-00 5700	TB	SNCF REF ADDED TO MARKING (B2), SNCF SPECIFICATION REMOVED FROM PHYSICAL PROPERTIES (B3), END FITTING MATERIAL UPDATED (B3), NO OF PIECES PER PALLET REMOVED FROM DRG (B2)- TO BE INCLUDED IN PD. LOT MARKING DETAILS UPDATED (B1)	JH
3	07/13	ECO-13-01 2369	TB	ADDITION OF M12 WASHER AND CABLE TIE TO PRODUCT ASSEMBLY (C1, C4), UPDATE FROM MINIMALE TO NOMINALE (CREEPAGE)	JH
4	09/13	ECO-13-01 3945	TB	UPDATE OF M12 WASHER TO ALIGN WITH CUSTOMER REQUIREMENTS (C1, C4, D1, D4), TEXT M12 CHANGED TO M10 (A3), TEXT UPDATED TO INCLUDE CLAMP WASHER RPN (EF0710-000), CENTRE HOLE LOCATION ADDED (D4).	JH

D

C

B

A

CR2701-000

RRA-52G-UUG-690

INS1126

SCD



4

3

2

1