

© 2020 TE Connectivity. All Rights Reserved.

REVISIONS					
P	LTR	DESCRIPTION	DATE	DWN	APVD
5		REDRAWN PER ECO-21-004049	06OCT2020	MR	KP

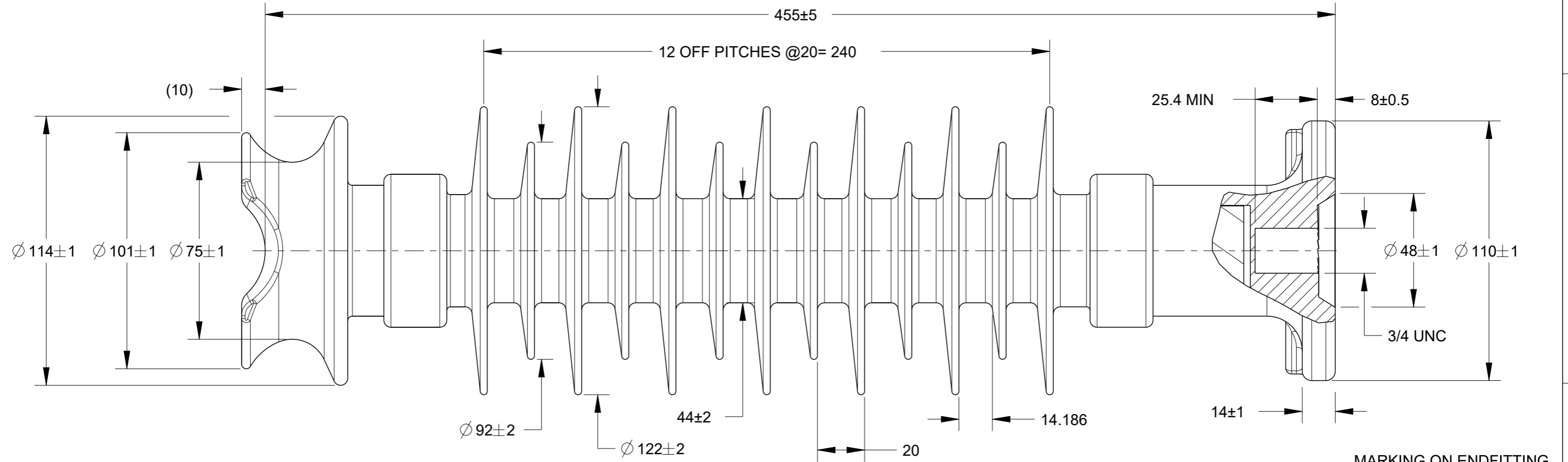

MARKING ON ENDFITTING
 1. INS0859
 2. MDCL : 5.5kN
 3. RYC

ELECTRICAL PROPERTIES :

DRY AC FLASHOVER : 176 kV
 WET AC FLASHOVER : 129 kV
 DRY AC WITHSTAND : 159 kV
 WET AC WITHSTAND : 112 kV
 IMPULSE WITHSTAND VOLTAGE : 244 kV

MECHANICAL PROPERTIES :

SCL : 12.5 kN
 MDCL : 5.5 kN
 STL : 25 kN
 SML : NONE

PHYSICAL PROPERTIES :

NOMINAL CREEPAGE : 1074 MM
 NOMINAL DRY ARC : 340 MM
 END FITTING DESIGN : STANDARD ANSI 29.7 & IEC60720 DESIGN

MATERIAL :

END FITTING : STEEL GALVANISED
 HOUSING : RAYCHEM HV RED (EVA)
 CORE : RBGF

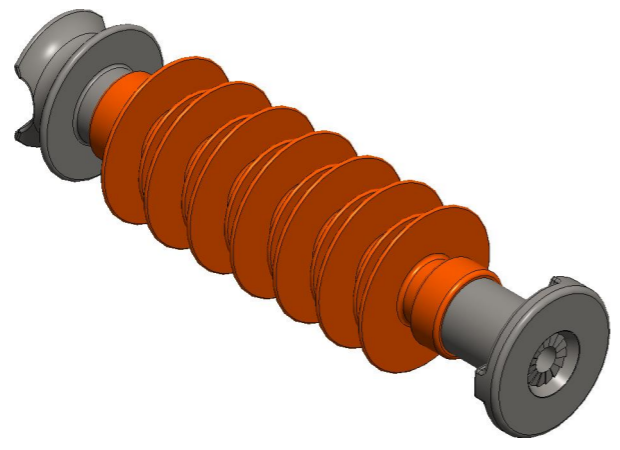

CL0439-000
 PART NO.

THIS DRAWING IS A CONTROLLED DOCUMENT.		DWN M.RAJ 06OCT2020												
DIMENSIONS: mm		CHK K.PUSTHAY 06OCT2020												
TOLERANCES UNLESS OTHERWISE SPECIFIED:		APVD K.PUSTHAY 06OCT2020												
<table border="1"> <tr><td>0 PLC</td><td>±</td></tr> <tr><td>1 PLC</td><td>±</td></tr> <tr><td>2 PLC</td><td>±</td></tr> <tr><td>3 PLC</td><td>±</td></tr> <tr><td>4 PLC</td><td>±</td></tr> <tr><td>ANGLES</td><td>±</td></tr> </table>		0 PLC				±	1 PLC	±	2 PLC	±	3 PLC	±	4 PLC	±
0 PLC	±													
1 PLC	±													
2 PLC	±													
3 PLC	±													
4 PLC	±													
ANGLES	±													
MATERIAL SEE NOTES		FINISH N/A	NAME RLP-43R-FG-3/4UNC-NPG-M											
CUSTOMER DRAWING		SCALE NTS	SIZE A3	CAGE CODE 00779	DRAWING NO C-INS0859									
			RESTRICTED TO	SHEET 1 OF 1	REV 5									