

Project NR		REVISIONS			
P	LTR	DESCRIPTION	DATE	ENV	APPRO
C		Ajout pas et profondeur sertissage + couples serrage et tableau outillage sertissage - Dif 285205	21FEB2008	SCT	
D		S15752-0004 devient Y00000-S15752-0004 DM350039 - Diffusion 331453	02DEC2015	EL	MV
E		Ajout item 8 + ajout nota 5 DM16-120 - Diffusion 331939	30SEP2016	EL	MV

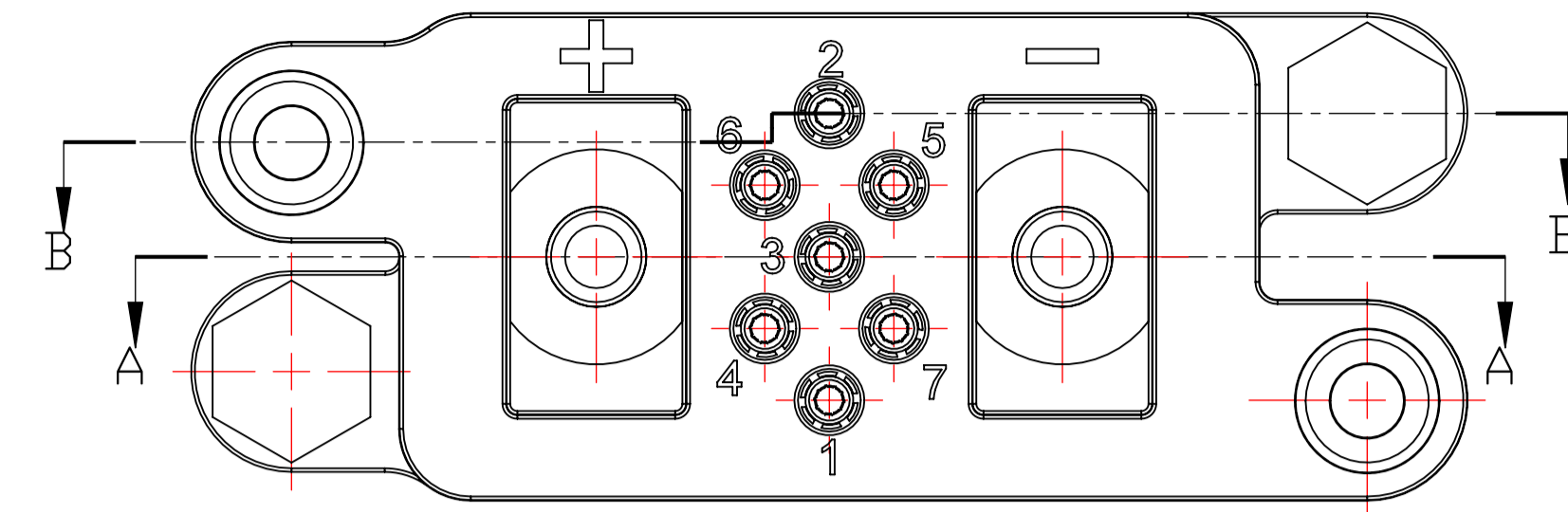
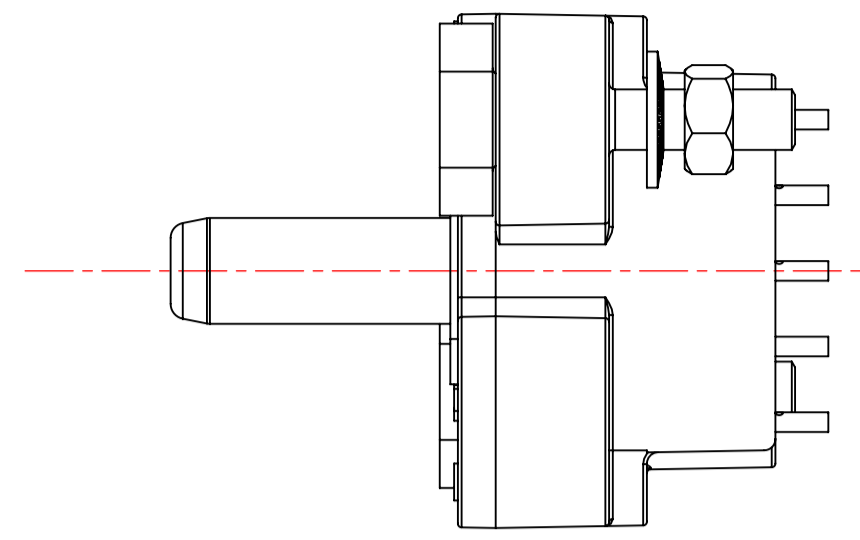
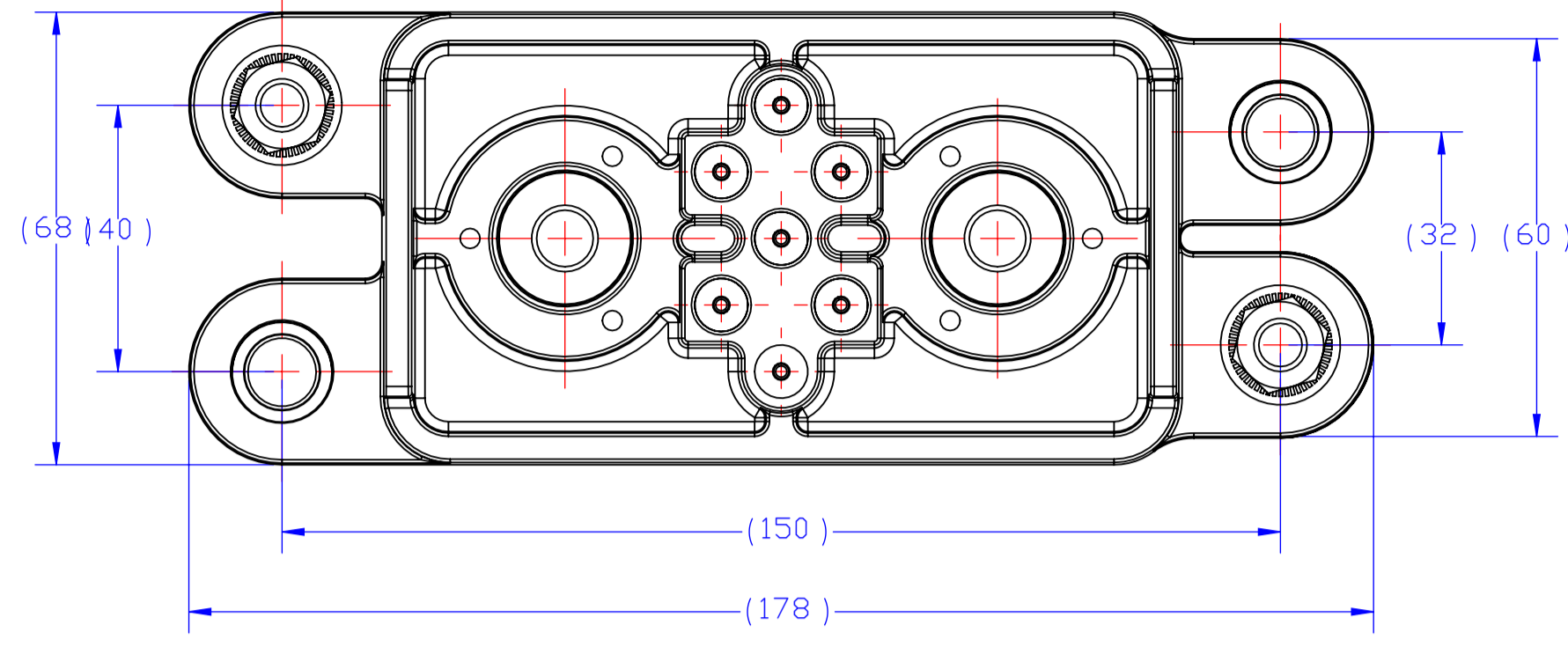

- () : cotes pour information / dimensions for information
 () : cotes de controle / inspection dimensions
- Instructions de mise en oeuvre à appliquer par le client
 Customer instructions to be applied by the customer
- Couple de serrage vis / contact de puissance = 25N.m
 (Tightening torque of screw / power contact)

4 Outillage sertissage et extraction
 Crimping and extraction tool

Numéro / Numbre	Calibre / Caliber	Réf commerciale / Commercial ref	Section admissible / Acceptable	outillage sertissage / Crimping tool
4	4	DAM S18267-0004	0,5 to 1,5mm ²	Pince / Plier : OCETA M317 Tourelle / locator : sans / without Sélecteur / Selector : 1 / 2

5 Spécification de conditionnement 107-157002
 Packaging Specification 107-157002

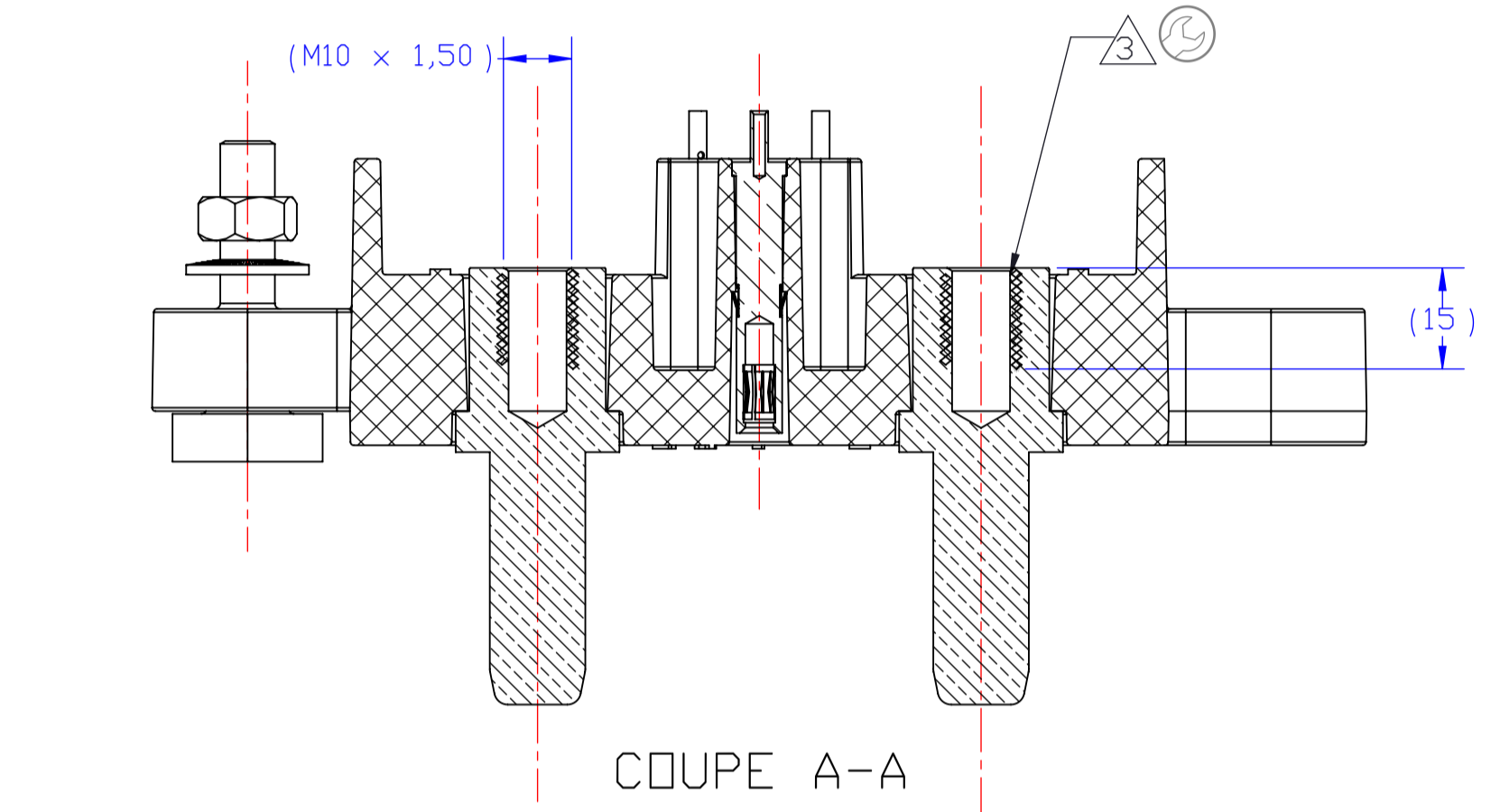
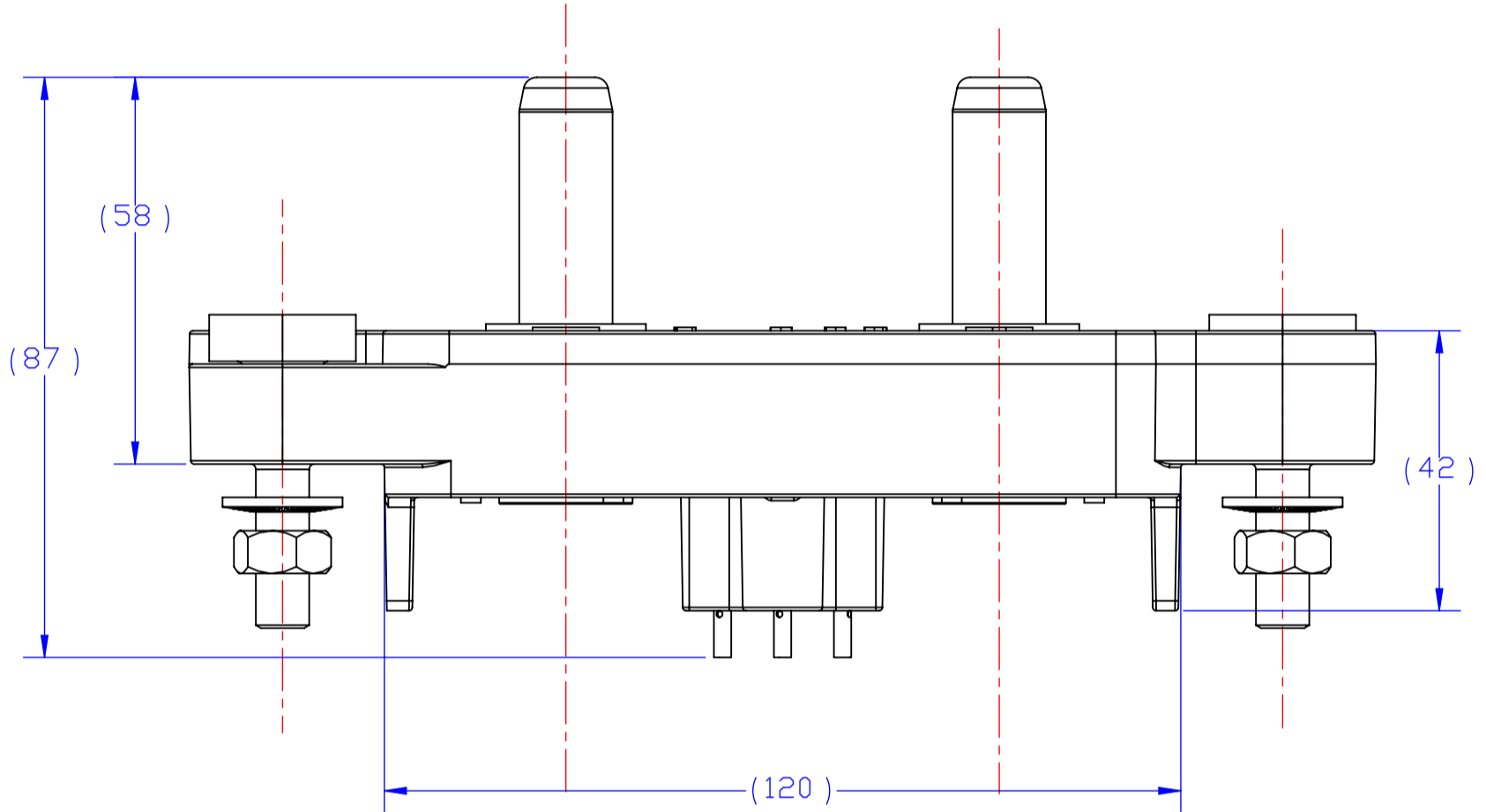

DECOUPE PAROI POUR PARTIE FLOTTANTE
 PANEL CUTTING FOR FLOATING PART

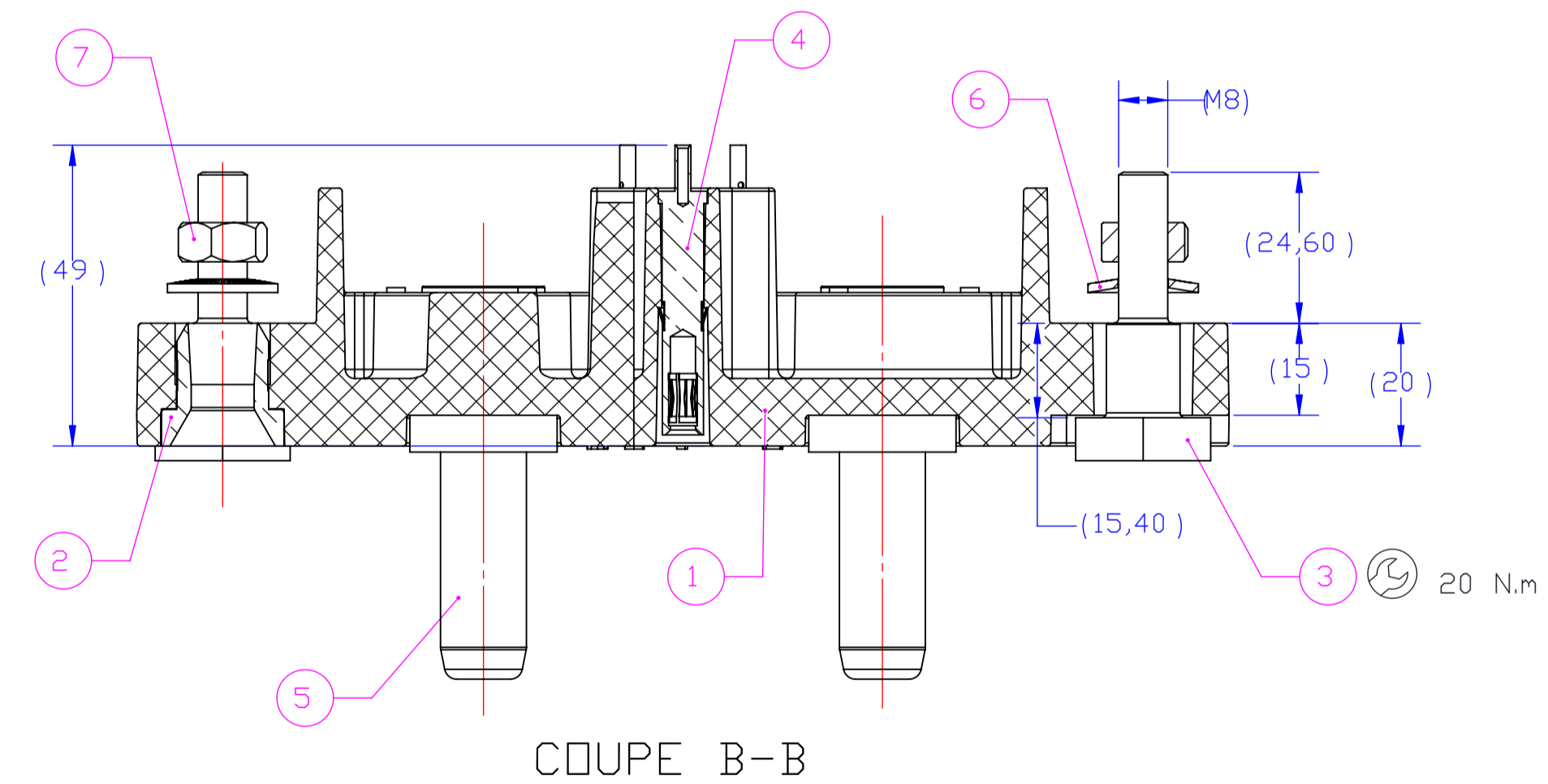
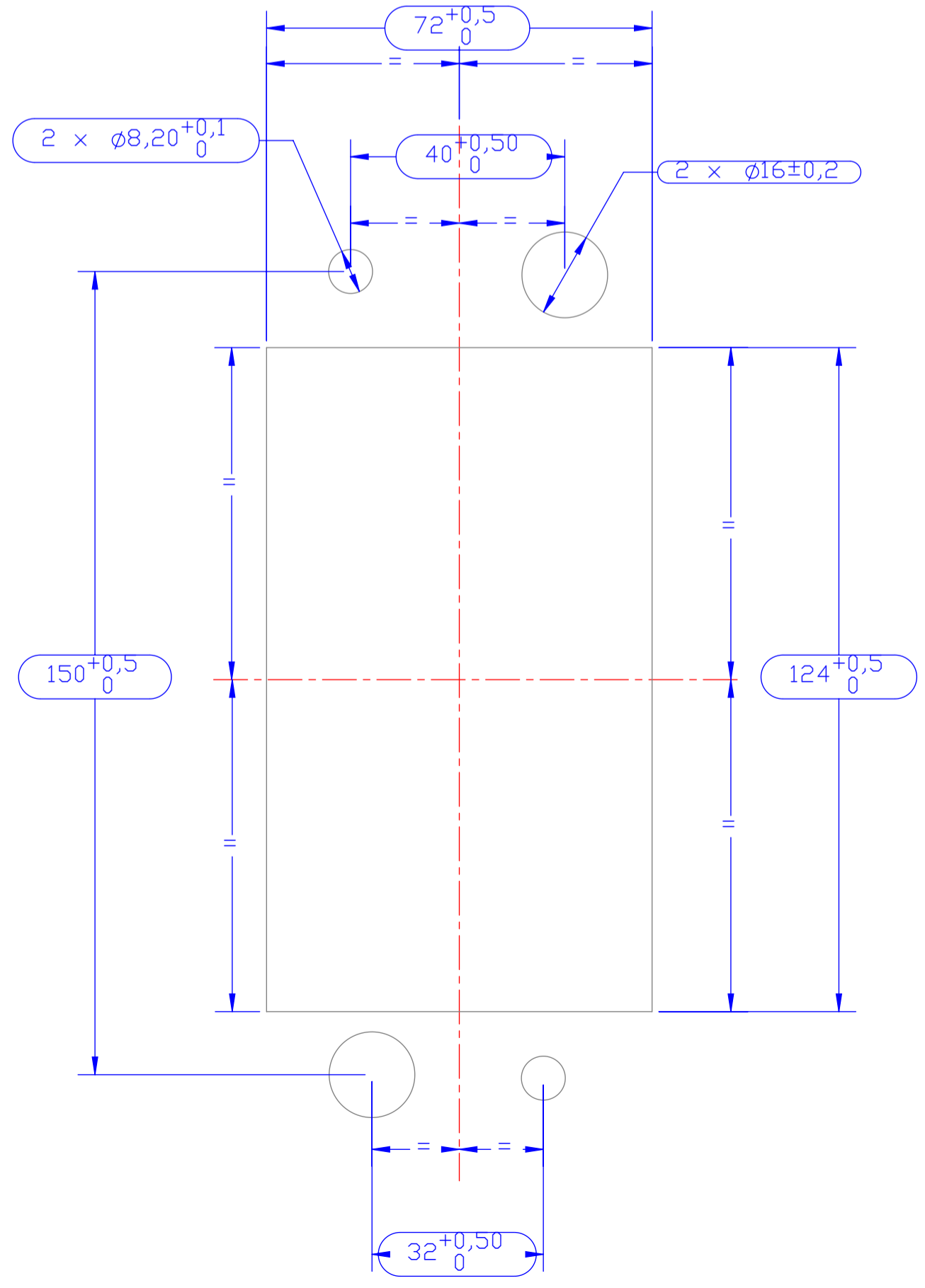
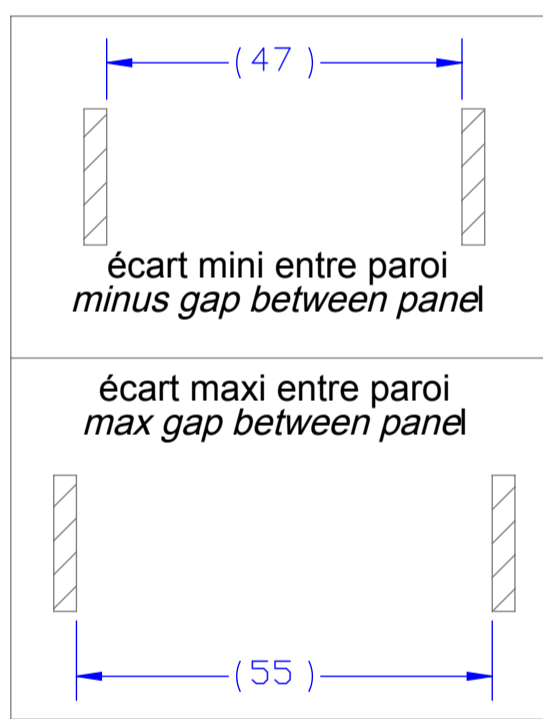

Observations / Remarks	Protection / Plating	Fiche matière / Data sheet	Matière / Material	Masse (g) / Weight (g)	Nbr / Qty	Codification / Part number	Désignation / Designation	REP / Item
-	-	-	Carton / Carton	18,9	1	Y00000-0206-0341AS	Boite 180x100x50 / Box 180x100x50	8
-	-	-	Inox / Stainless steel	5,53	2	HM08-I	Ecrou HM8 / Nut H	7
-	-	-	Inox / Stainless steel	2,24	2	0436-0008-M-I	Rondelle contact / Spring washer	6
-	Argenture / Silver plating	FMME 2003	Cuivre / Copper	134,20	2	Y00000-S15752-0004	S/E Broche cal. 14 / S/A pin caliber 14	5
-	Argenture / Silver plating	-	Laiton / Brass	11,60	7	S18267-0004	S/E douille pilotte / Contact socket pilot	4
-	-	FMME 3018	Inox / stainless steel	46,74	2	23610-000A3	Vis de fixation flottante / Screw	3
-	-	FMME 1019	Bronze / bronze	2,07	2	23609-000A3	Douille de guidage / Centering bushing	2
-	-	FTMP 446	Polyamide / Polyamide	304,21	1	31344-000A1	Bloc isolant / insulating block	1

Référence commerciale / Commercial reference : CSR31343-0001-00000

Y00000-0001-00000
 PART NO

THIS DRAWING IS A CONTROLLED DOCUMENT.
 DIMENSIONS: mm
 TOLERANCES UNLESS OTHERWISE SPECIFIED:
 3 PLC -
 2 PLC -
 1 PLC -
 4 PLC -
 5 PLCS -
 MATERIAL -
 FINISH -

DATE: 02DEC2015
 CHK: GLEMOINE
 DATE: 02DEC2015
 APPR: M. VIMARD

NAME: S/E Connecteur rackable male partie flottante cal. 14
 S/A Male rack connector floating part cal. 14

WEIGHT: 766,99 g
 CUSTOMER DRAWING

SCALE: 1:1
 SHEET: 1 OF 1
 REV: E

TE Connectivity