

P	LTR	DESCRIPTION	DATE	DWN	APVD
A		INITIAL RELEASE	28FEB2020	AS	LH
B		TYPO CORRECTION	24NOV2022	HM	LH

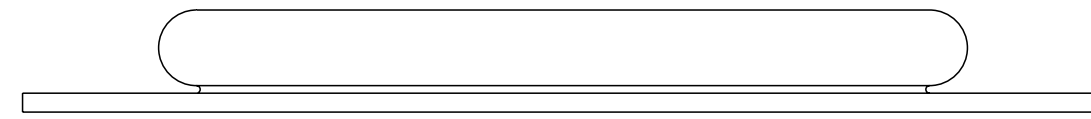

TYPICAL CROSS SECTION OF HVCE

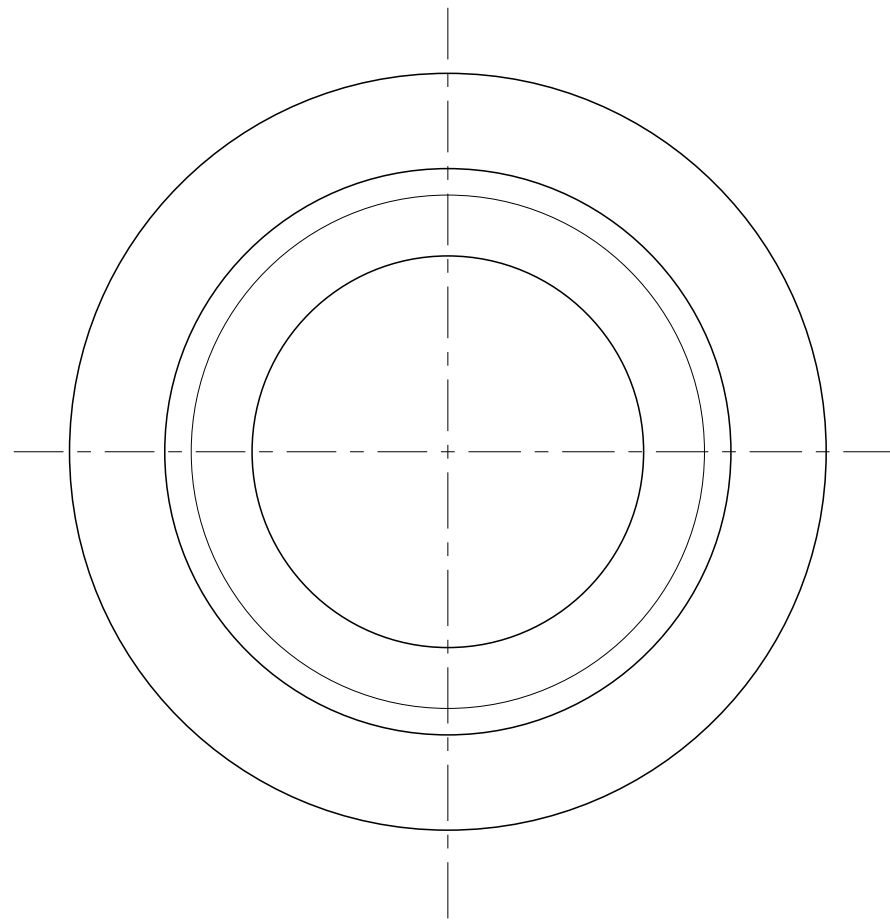
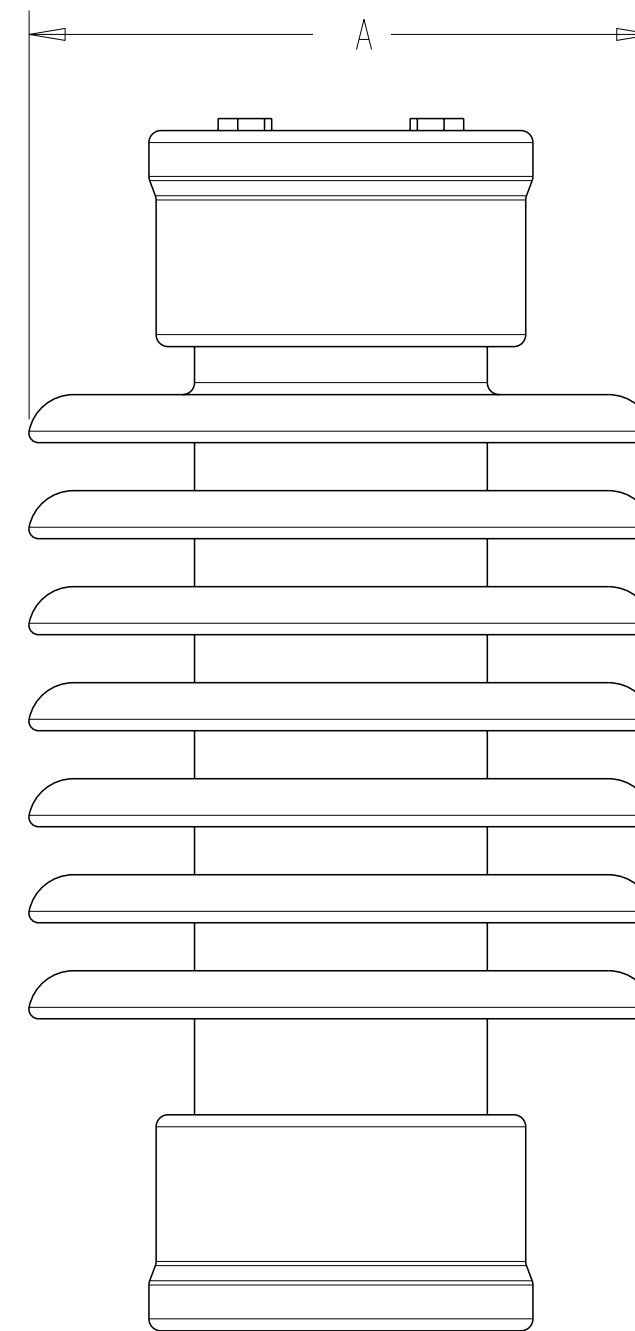

CATALOG NUMBER	SKIRT DIAMETER OF INSULATOR (MIN-MAX) (A)	MINIMUM INTERNAL DIAMETER OF HVCE (AS SUPPLIED)	CREEPAGE EXTENSION PER EXTENDER (MM)	STANDARD PACK (PCS/BOX)
HVCE 100/80-01 (B-6)	3.20-3.90 (81-99)	4.50 (114)	101.6	6
HVCE 120/100-01 (B-6)	3.90-4.70 (99-119)	5.30 (135)	101.6	6
HVCE 140/120-01 (B-6)	4.70-5.50 (119-140)	6.10 (155)	101.6	6
HVCE 160/140-01 (B-6)	5.50-6.30 (140-160)	7.00 (178)	101.6	6
HVCE 183/161-01 (B-6)	6.30-7.20 (160-183)	8.00 (203)	101.6	6
HVCE 205/184-01 (B-6)	7.20-8.10 (183-206)	9.00 (229)	101.6	6
HVCE 226/206-11 (B3)	8.10-8.90 (206-226)	9.40 (239)	101.6	3
HVCE 247/227-11 (B3)	8.90-9.70 (226-246)	10.30 (262)	101.6	3
HVCE 268/248-11 (B3)	9.70-10.50 (246-267)	11.10 (282)	101.6	3
HVCE 289/269-11 (B3)	10.50-11.40 (267-290)	11.90 (302)	101.6	3
HVCE 310/290-11 (B3)	11.40-12.20 (290-310)	12.70 (323)	101.6	3
HVCE 331/311-11 (B3)	12.20-13.00 (310-330)	13.60 (345)	101.6	3
HVCE 352/332-11 (B3)	13.00-13.90 (330-353)	14.40 (366)	101.6	3
HVCE 373/353-11 (B3)	13.90-14.70 (353-373)	15.20 (386)	101.6	3
HVCE 394/374-11 (B3)	14.70-15.50 (373-393)	16.10 (409)	101.6	3

NOTES:

1. EACH HVCE EXTENDER ADDS A NOMINAL 4 INCHES TO THE CREEPAGE LENGTH
2. HVCE DOES NOT UPGRADE THE VOLTAGE CLASS OF THE INSULATOR

THIS DRAWING IS A CONTROLLED DOCUMENT.

DWN	28FEB2020	A. SABARAD
CHK	28FEB2020	S. LIGHT
APVD	28FEB2020	L. HILLER

STE TE Connectivity

NAME: HVCE-268/248-11(B3)

SIZE	CAGE CODE	DRAWING NO	RESTRICTED TO
A2	00779	C-E00000816	

CUSTOMER DRAWING SCALE NTS SHEET 1 OF 1 REV B

Printed on 24 Nov 2022 17:00 (India Standard Time) from TE397707