

**PROPERTY OF DEUTSCH E. G. D.**

This drawing contains proprietary information that shall not be disclosed, duplicated, nor used in whole or in part for any purpose other than to evaluate this drawing.

A CTJ420E044

REVISIONS			
REV	DESCRIPTION	DATE	APPROVED
A	REVISED AND REDRAWN PER E.O. C10B	11-22-44	JP

INDEX (REF.)

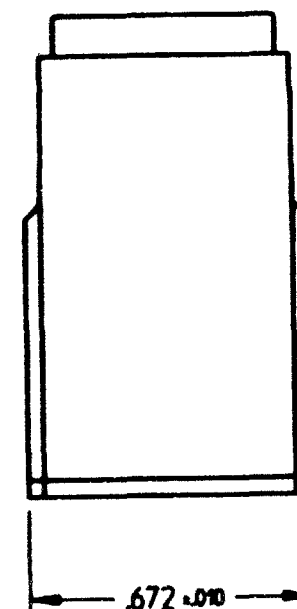
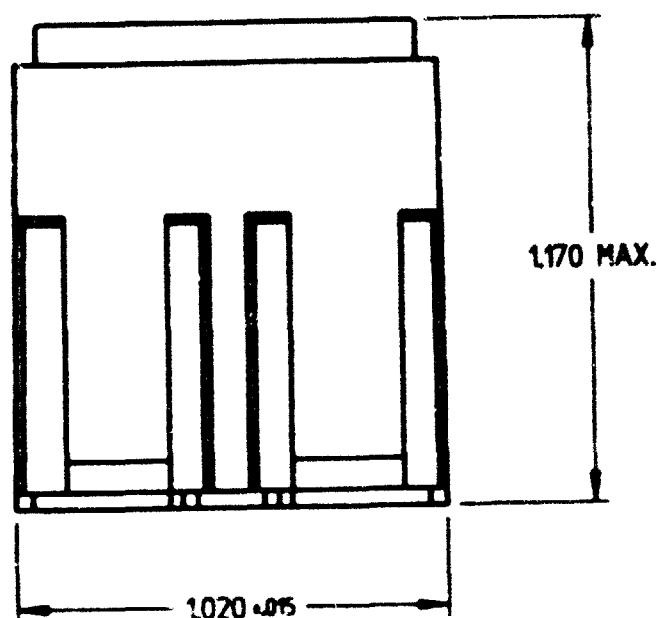
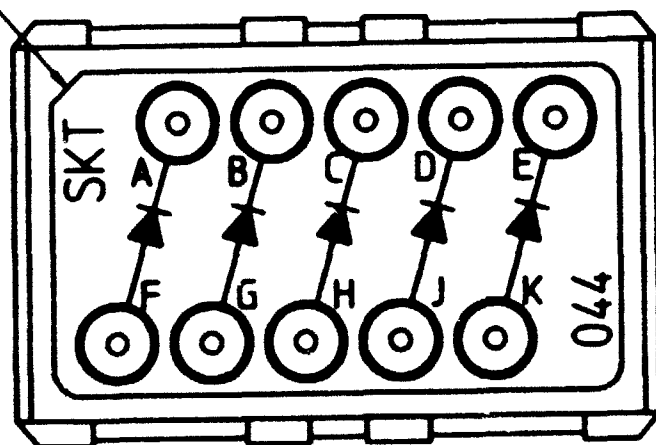

11. ELECTRONIC COMPONENTS FIVE (5) JAN1X IN5552 DIODES  
 PRV - 600V  
 VFM - 1.2V  
 IF - 9.0 Adc  
 trr - 2.0u SEC

- 10. THIS ASSEMBLY CONFORMS TO MIL-C-81714, SERIES B.
- 9. SOCKET CONTACTS MEET MIL-C-39029/22-192 REQUIREMENTS.
- 8. JUNCTION ELECTRONIC COMPONENT TEMPERATURE RANGE -67°F TO +257°F (-55°C TO 125°C).
- 7. MATERIAL AND FINISHES HOUSING - THERMOPLASTIC  
 GROMMET - SILICONE ELASTOMER  
 PIN CONTACTS - COPPER ALLOY PLATED GOLD.
- 6. CONTACT INSERTION/REMOVAL TOOL NUMBER MB9169/14-10 IS REQUIRED.
- 5. SEE ENVELOPE DRAWINGS CTJ-3a-00 AND DCR-1a-00 FOR SUITABLE RAIL ASSEMBLIES.
- 4. SEE ENVELOPE DRAWING 1625-1-0000 FOR CONTACT DATA.
- 3. CTJ420E00X-000  
 ———— MODIFICATION  
 ———— CIRCUIT ARRANGEMENT  
 ———— BASIC IDENTIFIER
- 2. THE CIRCUIT IDENTIFICATION WILL BE SCREENED ON JUNCTION.
- 1. DIMENSIONS ARE IN INCHES UNLESS OTHERWISE SPECIFIED.

SIGNATURE & DATE	
DR	LASHWAY 10-3-80
DM	L. STOLLE 10-30-80
PE	MAC DONALD 10-27-80
APPD	
SCALE	1:1

**JUNCTION ASSEMBLY**  
 ELECTRONIC COMPONENT  
 SIZE 12  
 SIZE 20 CONTACTS  
 044 ARRANGEMENT  
 ENVELOPE

CP	PARTS LIST	
	 DEUTSCH ENGINEERED CONNECTING DEVICES 36033 Whittier Ave. Newark California	
A	CTJ420E044	
	CODE	SHEET 1 OF 1

CTJ420E044\_001