

N/C		CTJ420E017		REVISIONS		
SYM	DESCRIPTION		DATE	APPROVED		
N/C	NEW RELEASE PER E.O. 90228		10/15/80	<i>[Signature]</i>		

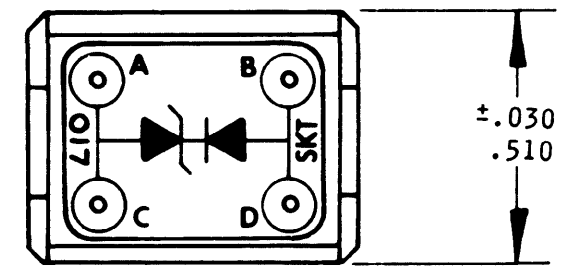

TOP VIEW

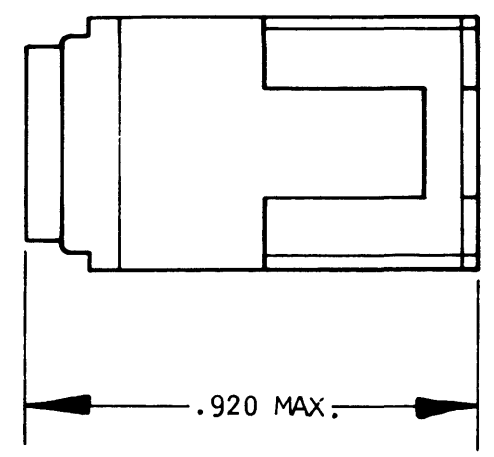

END VIEW

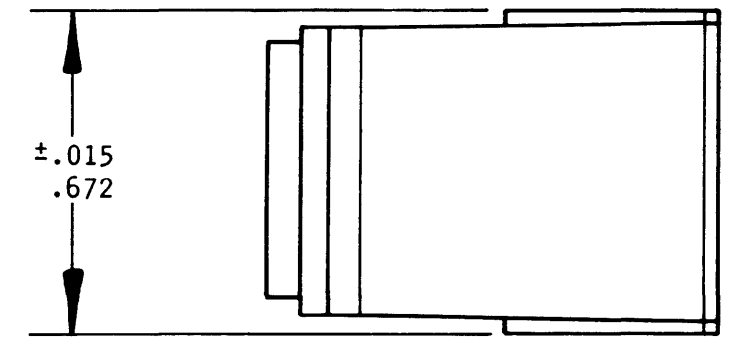

SIDE VIEW

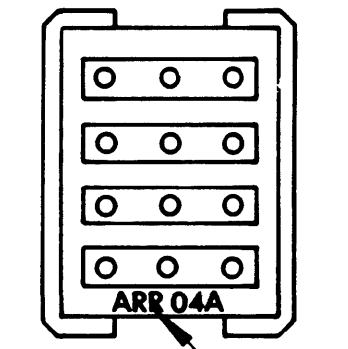

BOTTOM VIEW

11. ARR. 04A BUSING DESIGNATION IS INSIGNIFICANT AND HAS NO RELATIONSHIP TO WIRING SCHEMATIC.

- 10. ZENER DIODE (JANTX 1N4478) TEST CURRENT 7.0 mA
NOM. VOLTS 36.
- 9. DIODE (JANTX 1N5618)
PRV 600V
trr 2.0 μ SEC.
IF 3.0 A
Vf 1.3 V
- 8. TEMPERATURE RANGE: -67°F TO 257°F (-55°C TO 125°C).
- 7. MATERIALS & FINISHES:
HOUSING - THERMO PLASTIC
GROMMET - SILICONE ELASTOMER
PIN CONTACT - COPPER ALLOY PLATED GOLD
- 6. REQUIRES CONTACT TOOL NO. M15570-20.
- 5. SEE ENVELOPE DRAWING NO CTJ-33-XXXX FOR SUITABLE RAIL ASSY.
- 4. FOR CONTACT DATA SEE ENVELOPE DRAWING 1625-1-0000.

3. CTJ420E 017
 └──┬── CIRCUIT ARRANGEMENT
 └──┴── BASIC IDENTIFIER

- 2. THE CIRCUIT IDENTIFICATION WILL BE SCREENED ON JUNCTION.
- 1. DIMENSIONS ARE IN INCHES UNLESS OTHERWISE SPECIFIED.

SIGNATURE & DATE		JUNCTION ASSEMBLY ELECTRONIC COMPONENT SIZE 20 SIZE 20 CONTACTS 017 ARRANGEMENT ENVELOPE	CP	MATL. CODE	
DR	<i>[Signature]</i> 10-16-80		The Deutsch Company ELECTRONIC COMPONENTS DIVISION Municipal Airport Banning, California		
CHK	<i>[Signature]</i> 11-5-80		B	CTJ420E017	
PE	<i>[Signature]</i> 10-21-80			DWG SIZE	CODE 11139
APPD				SHEET 1 OF 1	
SCALE NONE WT					