

REVISION		
REV	DESCRIPTION	DATE
A	INITIAL RELEASE PER DCR NUMBER C040785	09JUL2004
B	REVISE PER DCR# C050016	JAN-17-05
C	REVISED PER ECO-19-009004	JUL-15-19

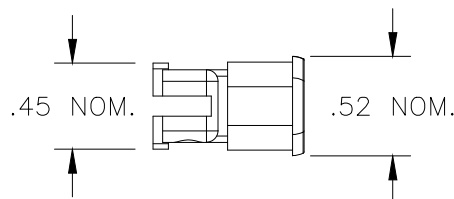
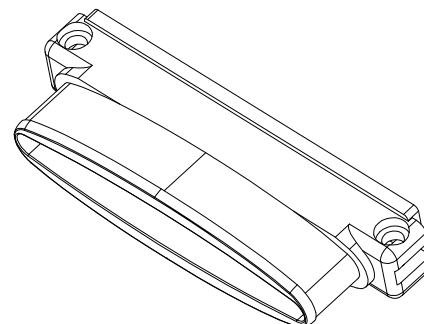
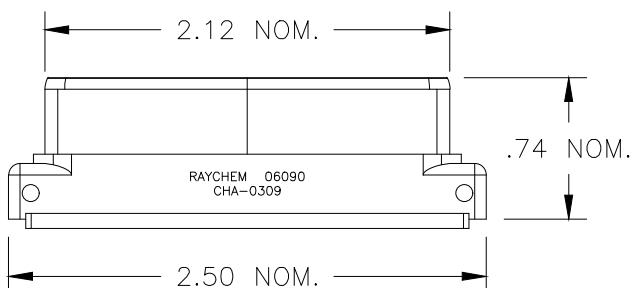

NOTES:

1. APPLICATION: FOR USE ON 2" MTC SHELLS, ELECTROLESS NICKEL PLATED.
2. BODY: ALUMINUM, ELECTROLESS NICKEL PLATE PER RAYCHEM ES 61400/16.
3. BANDSTRAP (NOT SHOWN): CRES-Lock BND-1225, CRES, PASSIVATED.
4. SCREWS (NOT SHOWN): 4-40 SOCKET HEAD CAP SCREW, CRES, PASSIVATED, SELF-LOCKING.
5. MARKINGS: BLACK INK.
6. MEETS APPLICABLE REQUIREMENTS OF RAYCHEM SPECIFICATION C-6114.
7. WEIGHTS:
BACKSHELL: 10.2gm (NOM)
SCREWS (2): 1.2gm (NOM), TOTAL
BANDSTRAP (INSTALLED): 7.5gm (NOM)

© 2004-2005 TYCO ELECTRONICS CORPORATION. ALL RIGHTS RESERVED.

IF THIS DOCUMENT IS PRINTED IT BECOMES UNCONTROLLED.
CHECK FOR THE LATEST REVISION.

UNLESS OTHERWISE SPECIFIED DIMENSIONS ARE INCHES. METRIC DIMENSIONS ARE IN BRACKETS.		SPECIFICATION CONTROL DRAWING	
DECIMAL TOLERANCES .XXX ± 0.005 [0.13 mm] .XX ± 0.010 [0.25 mm] .X ± 0.020 [0.50 mm] ANGLE TOLERANCE .X ± 0.5 DEG. WEIGHT, INSTALLED (NOM) LBS. 0.0417 [18.9 gm]	DRAWN T RATZLAFF MATERIAL SEE NOTES FINISH SEE NOTES	DATE 09JUL2004 tyco Electronics	TYCO ELECTRONICS 300 CONSTITUTION DRIVE MENLO PARK, CA 94025 Raychem
THIRD ANGLE PROJECTION		TITLE 2" MTC BACKSHELL ADAPTER, CRES-Lock BAND	SIZE A
CAD FILE C050016.DWG		CAGE CODE 06090	DWG. NO. CHA-0309
© 2004-2005 TYCO ELECTRONICS CORPORATION. ALL RIGHTS RESERVED.		DO NOT SCALE THIS DRAWING	SHEET 1 OF 1