

REVISIONS		
LTR	DESCRIPTION	DATE
B	REVISED PER ECO-08-021113	08/26/2008

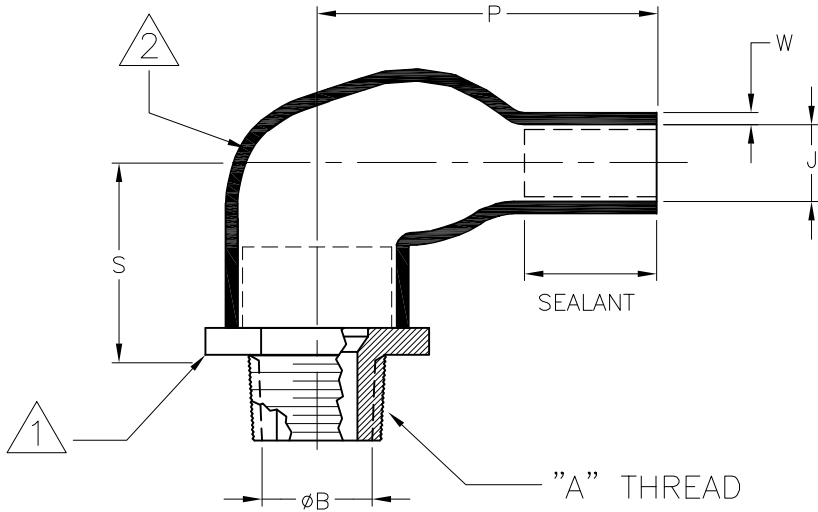

PART DESCRIPTION	A NATIONAL PIPE THREAD	ϕB MIN	ϕJ		P REC'D REF.	S REC'D REF.	W REF.	SEALANT AREA REF.
			EXP MIN	REC'D MAX				
CES-2R-A50-X	1/2 - 14	.50 [12,70]	.50 [12,70]	.28 [7,11]	1.40 [35,56]	1.00 [25,40]	.07 [1,77]	.40
CES-2R-A75-X	3/4 - 14	.75 [19,05]	.71 [18,03]	.33 [8,38]	1.70 [43,18]	1.10 [27,94]	.07 [1,77]	.50
CES-3R-A100-X	1 - 11 1/2	1.00 [25,40]	1.10 [25,94]	.38 [9,65]	2.10 [53,34]	1.33 [33,78]	.08 [2,03]	.65
CES-3R-A150-X	1 1/2 - 11 1/2	1.10 [27,94]	1.60 [40,64]	.62 [15,75]	3.10 [78,74]	1.56 [39,62]	.13 [3,30]	1.25

NOTES:

1. THE LAST "X" IN THE PART DESCRIPTION DESIGNATES MATERIAL AS SHOWN BELOW:
 "A": ALUMINUM 6061-T6 WITH FINISH OF HARD ANODIZE PER MIL-A-8625F, TYPE III, CLASS 2, DYED BLACK.
 "B": STAINLESS STEEL TYPE 316, WITH FINISH OF PASSIVATE PER ASTM-A967.
 NONE: STANDARD BLACK NYLON MATERIAL (e.g. CES-3R-A100).
2. BOOT MATERIAL: HEAT SHRINKABLE MATERIAL IN ACCORDANCE WITH -3 POLYOLEFIN
3. FACTORY APPLIED HOT MELT ADHESIVE IS STANDARD

If this document is printed it becomes uncontrolled. Check for the latest revision

CUSTOMER DRAWING

UNLESS OTHERWISE SPECIFIED DIMENSIONS ARE INCHES. METRIC DIMENSIONS ARE IN BRACKETS. DECIMAL TOLERANCES .XXX ± 0.005 [0.13 mm] .XX ± 0.01 [0.25 mm] .X ± 0.1 [0.50 mm] ANGLE TOLERANCE .X ± 1 DEG. TYCO ELECTRONICS RESERVES THE RIGHT TO AMEND THIS DRAWING AT ANY TIME. USERS SHOULD EVALUATE THE SUITABILITY OF THE PRODUCT FOR THEIR APPLICATION. © 2003-2008 Tyco Electronics Corporation, All rights reserved.	DRAWN UNGUYEN	DATE 08/26/2008	 Raychem Molded Parts 305 Constitution Dr Menlo Park, CA 94025
	RPN N/A	TITLE CABLE ENTRY SEALS, RIGHT ANGLE, NPT THREADED	
THIRD ANGLE PROJECTION 	SIZE B	CODE IDENT. NO. 06090	DWG. NO. CES-XR-AXXX-X
DO NOT SCALE THIS DRAWING			SHEET 1 OF 1