

THIS DRAWING IS UNPUBLISHED.

RELEASED FOR PUBLICATION

REVISIONS

© COPYRIGHT - TE Connectivity Ltd.

ALL RIGHTS RESERVED.

P	LTR	DESCRIPTION	DATE	DWN	APVD
	A	INITIAL RELEASE	26NOV2019	RV	MB

General Specifications

Temperature Rating —

-70°C TO + 125°C

Altitude — 300,000 Feet

Shock* —

Z, Y, & X Enclosures —

200 g for 6 mS

W & M Enclosures (Stud Mtg.) —

100 g for 6 mS

Vibration, Sinusoidal* —

Z, Y, & X Enclosures —

30 g 33-3000Hz

W Enclosure —

20 g 33-3000Hz

Vibration, Random* —

Z, Y, & X Enclosures —

0.4 g²/Hz 50-2000Hz

W & M Enclosures (Stud Mtg.) —

0.2 g²/Hz 50-2000Hz

Dielectric Strength —

At Sea Level —

All circuits to ground and circuit to circuit — 1250 V rms

Coil to ground — 1000 V rms

At 80,000 Feet — 350 V rms

Insulation Resistance —

Initial (500 VDC) — 100 MΩ Min.

After Life or Environmental Tests —

50 MΩ Min.

Operate Time at Nominal Voltage —

DC Relays — 10 ms or less

AC Relays — 15 ms or less

Release Time at Nominal Voltage —

DC Relays — 10 ms or less

AC Relays — 50 ms or less

* Max. contact opening under vibration

or shock 10 microseconds

Contact Rating — Amperes Ratings Are Continuous Duty

Type of Load	Life (Min.) Cycles x 10 ³	28 VDC	115VAC 400Hz	115/200VAC 3Ø	
				400Hz	60Hz*
Resistive	100	12	12	12	2.5
Inductive	20	8	8	8	2.5
Motor	100	4	4	4	2.0
Lamp	100	2	2	2	1

*60 Hz loads rated for 10,000 operations

Overload Current — 40 AMPS DC, 60 AMPS 400Hz

Rupture Current — 50 AMPS DC, 80 AMPS 400Hz

Contact Make Bounce — 1 MILLISECOND AT NOMINAL VOLTAGE

Max. Contact Drop at 12 Amps — INITIAL 0.150 VOLTS

End of Life — 0.175 VOLTS

Coil Data

Coil Code	Nominal Voltages	Freq. Hz	DC Res. AC Amps (B)	Over Temperature Range		
				Pickup or Below Volts	Dropout or Above Volts	Must Hold Voltage (C)
1	6	DC	20 Ω	4.5	0.3	2.5
2	12	DC	80 Ω	9.0	0.75	4.5
3	28	DC	320 Ω	18.0	1.5	7.0
4 (A)	28	DC	320 Ω	18.0	1.5	7.0
5	48	DC	920 Ω	32.0	2.5	14.0
6	28	400Hz	180 mA	22.0	1.25	10.0
7	28	50/400Hz	100 mA	22.0	1.25	10.0
8	115	400 Hz	40 mA	90.0	5.0	40.0
9	115	50/400 Hz	30 mA	95.0	5.0	40.0

A. CODE 4 COILS HAVE BACK EMF SUPPRESSION TO 42 VOLTS MAX.

B. DC COIL RESISTANCE ± 10% AT 25°C; AC COIL MAX. CURRENT AT NOMINAL VOLTAGE.

C. RELAY WILL STAY IN PICKED-UP STATE DOWN TO MUST HOLD VOLTAGES SHOWN.

D. MAX. OVERVOLTAGE: 6 & 12 VDC COILS 120% OF NOMINAL; ALL OTHERS 110% OF NOMINAL.

E. COILS AVAILABLE FOR OTHER VOLTAGES AND FOR AC 50/60HZ.

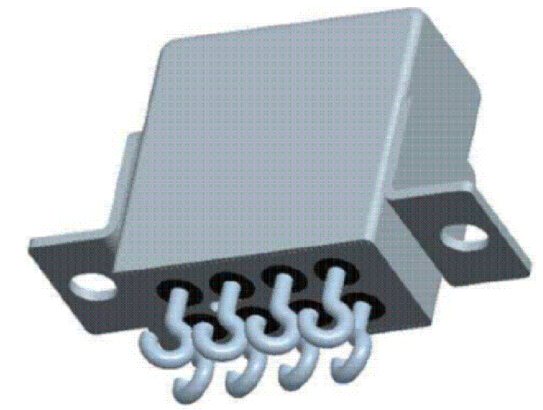

Product Facts

- Hermetically Sealed
- All Welded Construction
- Balanced Force
- Permanent Magnet Drive
- Contacts — Silver Cadmium Oxide with Gold Plating
- Coils for DC, 50 to 400Hz and 400Hz AC
- Weight 1.6 ounces max. (45.4 grams)

THIS DRAWING IS A CONTROLLED DOCUMENT.		DWN RV 26NOV2019	TE Connectivity		
		CHK RV 26NOV2019			
DIMENSIONS: INCHES		APVD MB 26NOV2019	NAME		
		TOLERANCES UNLESS OTHERWISE SPECIFIED:		C-FCA-212-SERIES	
		0 PLC ± -	1 PLC ± -	-	
MATERIAL		2 PLC ± -	APPLICATION SPEC		SIZE
		3 PLC ± -	-		CAGE CODE
		4 PLC ± -	WEIGHT		DRAWING NO
		ANGLES ± -	-		RESTRICTED TO
		FINISH	CUSTOMER DRAWING		SCALE
			A3		NTS
			G-FCA-212-SERIES		SHEET
			-		1 OF 2
			-		REV
			-		A

P	LTR	DESCRIPTION	DATE	DWN	APVD
-	-	SEE SHEET 1	-	-	-

Enclosures

All Enclosures have Cupro-Nickel Cans bright acid tin/lead plated after assembly to terminal headers.
 Dimensions: Inches ± .010 (mm ± .25)

"A" AC Coils 1.125 in. (28.57) Max.
 DC Coils 1.010 in. (25.65) Max.

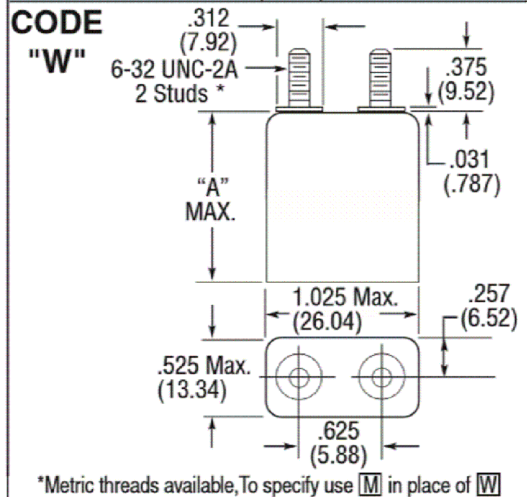
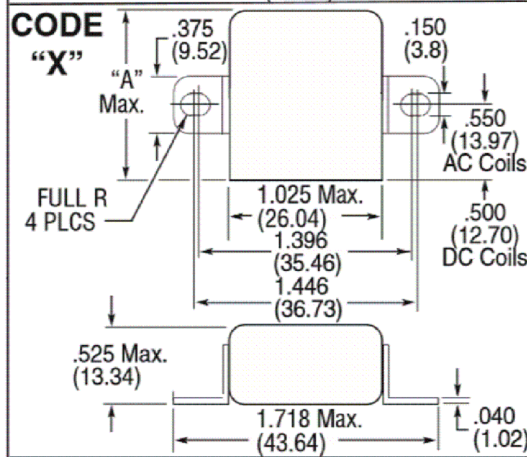
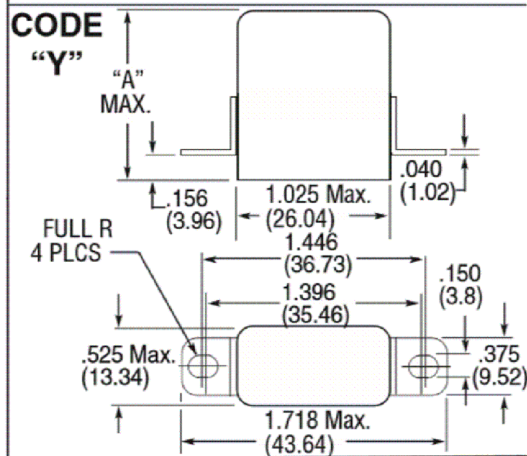
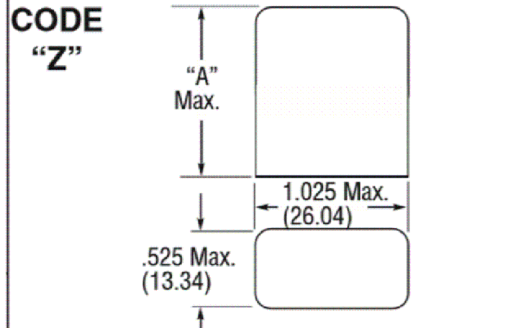

Terminal Wiring
DC Coils with Transient Suppression

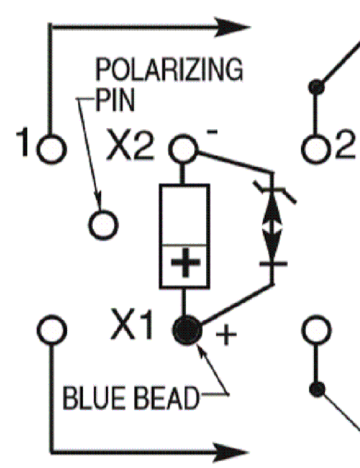

DC Coils

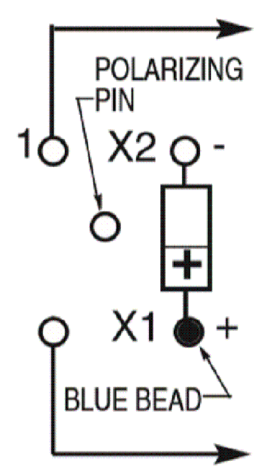

AC Coils
115 VAC

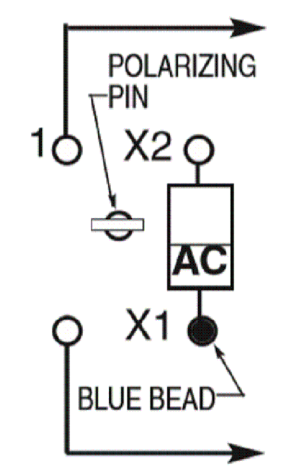

AC Coils
28 VAC

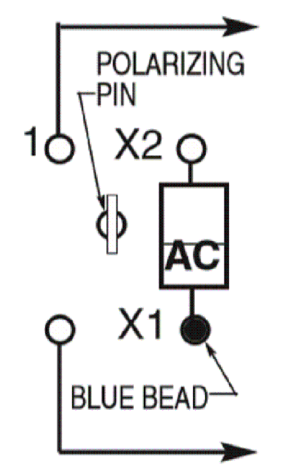

NOTE: Polarity must be observed with DC coil supply. Relay is polarized with a permanent magnet and will not operate or be damaged by reverse polarity.

Diodes used in transient suppression and in AC rectifier circuits have peak inverse voltage rating of 600 VDC minimum. Zener diodes have a minimum rating of 1 watt.

Terminal designations are for reference only and do not appear on the header.

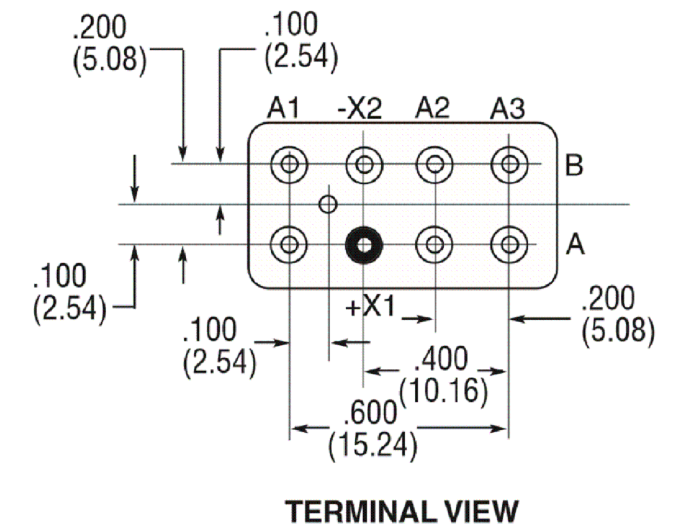

HOW TO ORDER

RELAY TYPE

TERMINALS (Socket Pins, DC Coil)

ENCLOSURE (With Flanges)

COIL (28 VDC With Transient Suppression).

FCA-212-A Y 4

ALL DIMENSIONS ARE IN INCHES(MM)

CODE "C" Solder Hook

HOOK TERMINALS TIN/LEAD PLATED

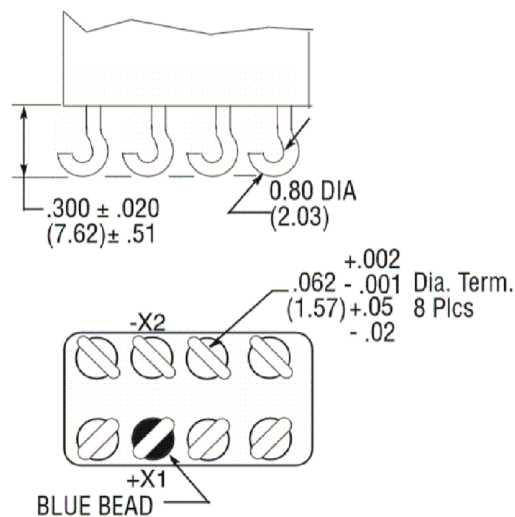

THIS DRAWING IS A CONTROLLED DOCUMENT.		DWN RV 26NOV2019	TE Connectivity		
DIMENSIONS: INCHES		CHK RV 26NOV2019			
TOLERANCES UNLESS OTHERWISE SPECIFIED:		APVD MB 26NOV2019	PRODUCT SPEC -		
INCHES		PRODUCT SPEC	APPLICATION SPEC -		
0 PLC ± -		APVD MB 26NOV2019	RESTRICTED TO -		
1 PLC ± -		PRODUCT SPEC	SIZE A3	CAGE CODE -	DRAWING NO C-FCA-212-SERIES
2 PLC ± -		APPLICATION SPEC	WEIGHT -		
3 PLC ± -		RESTRICTED TO	SCALE NTS		
4 PLC ± -		WEIGHT	SHEET 2 OF 2		
ANGLES ± -		FINISH	REV A		
MATERIAL -		FINISH -	CUSTOMER DRAWING		