

REVISIONS			
REV	DESCRIPTION	DATE	APPV
A	PRODUCTION RELEASE	JHAGER 8/10/2021	

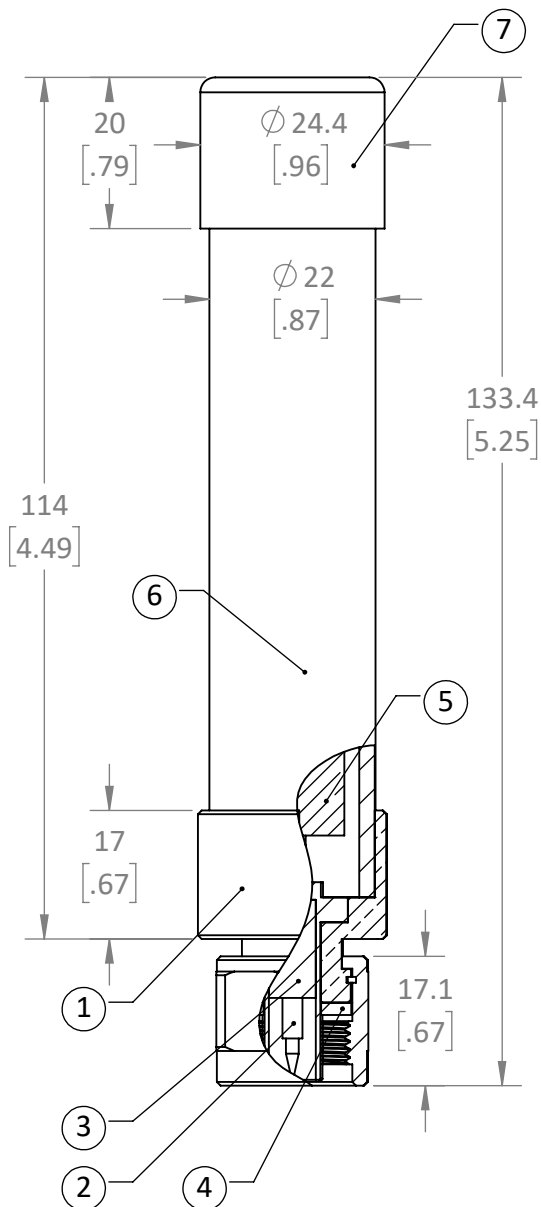

# NOTES: (UNLESS OTHERWISE SPECIFIED)

1. ALL DIMENSIONS ARE IN MILLIMETERS [IN].
2. DIMENSIONS APPLY AFTER FINISHING.
3. MANUFACTURE TO BE COMPLIANT WITH EU RoHS DIRECTIVE, USE MATERIALS THAT DO NOT CONTAIN REACH SUBSTANCES OF VERY HIGH CONCERN >1000ppm, AND USE DRC CONFLICT-FREE SOURCED MATERIALS.
4. MARK PACKAGING [BAG/BOX] WITH THE FOLLOWING INFORMATION:
  1. LOT#
  2. LINX PART NUMBER
  3. QUANTITY IN BAG/BOX
  4. COUNTRY OF ORIGIN
5. FREQUENCY: 617-960/1452-1496/1710-2690/3300-5000
6. IMPEDANCE: 50Ω
7. VSWR: 3.5dBm
8. OMNI-DIRECTIONAL
9. OPERATING TEMP: -30°C - +70°C
10. STORAGE TEMP: -40°C - +85°C
11. IP67 SEALED HOUSING
12. INTERCONNECT N-TYPE IAW MIL-STD-348B
13. COVER TUBE IS INSERTED INTO CAP AND BASE USING HIGH STRENGTH UV RATED EPOXY AS ADHESIVE AND SEAL.
14. ANTENNA COVER TO BE CONCENTRIC WITH BASE AFTER INSTALLATION.

ITEM	DESCRIPTION
1	CON, BODY, N, PLUG, Ni/BRASS
2	PIN, N-TYPE, GOLD/BeCu
3	DIELECT, PTFE
4	GASKE, SIL, N-TYPE, RED
5	ELEMENT, RPC, BLAC
6	COVE, FRP, WHITE
7	CAP, ASA, COVER, WHITE

**WARNING:** THIS DRAWING CONTAINS PROPRIETARY INFORMATION THAT IS THE SOLE PROPERTY OF LINX TECHNOLOGIES, AND SHALL BE TREATED AS SUCH. NO DISCLOSURE OR REPRODUCTION OF THIS DOCUMENT IS PERMITTED, IN WHOLE OR IN PART, WITHOUT THE EXPRESS WRITTEN PERMISSION OF LINX TECHNOLOGIES OR ITS DESIGNATED AGENTS.

MATERIAL:  
FRP, ASA, PCB  
BRASS, BeCu

FINISH:  
NATURAL  
GOLD

INTERPRET DIMENSIONS AND  
TOLERANCES PER ASME Y14.5.

.X ±2.0 ANGLES: ±1°  
.XX ±1.00 SURFACE: 32/  
.XXX ±.500

PROJECTION:



DRAWN: JHAGER

ENGR: DASARATHAN

DT: 8/10/21

DT: 10-JUL-08



159 ORT LANE  
MERLIN, OR 97532

TITLE:

**ANTENNA, MULTI-BAND  
IP-67 RATED OUTDOOR**

SIZE DWG. NO.

**A** C-ANT-8\_9-IPW2-NP

REV

**A**

SCALE: 1:1

DO NOT SCALE DRAWING

SHEET 1 OF 1