

868MHz TYPICAL VSWR

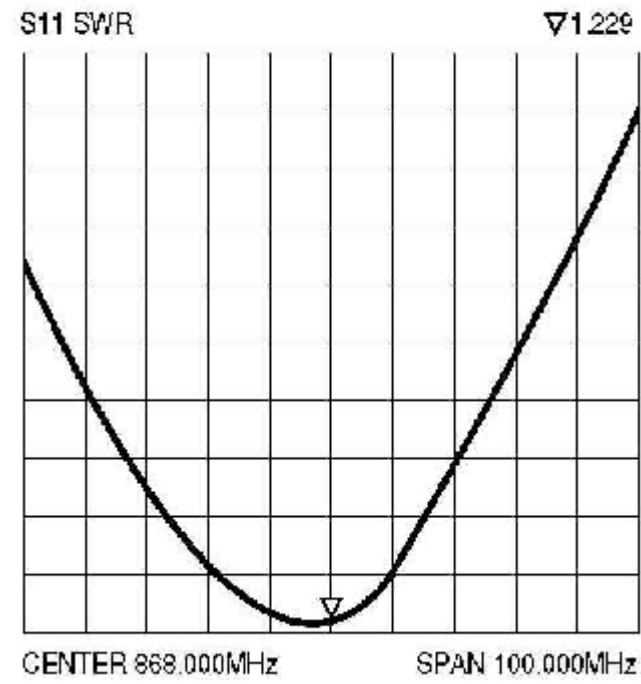

868MHz H-Plane

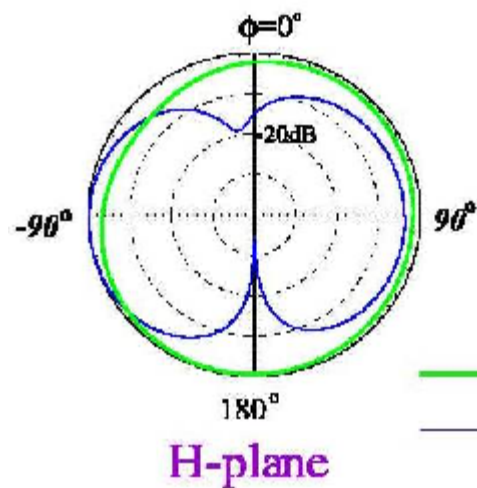

868MHz E-Plane

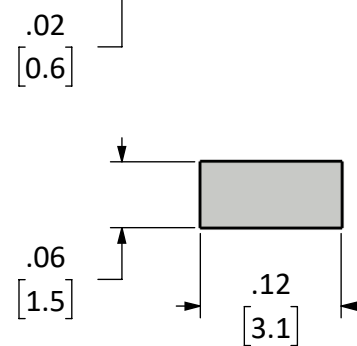
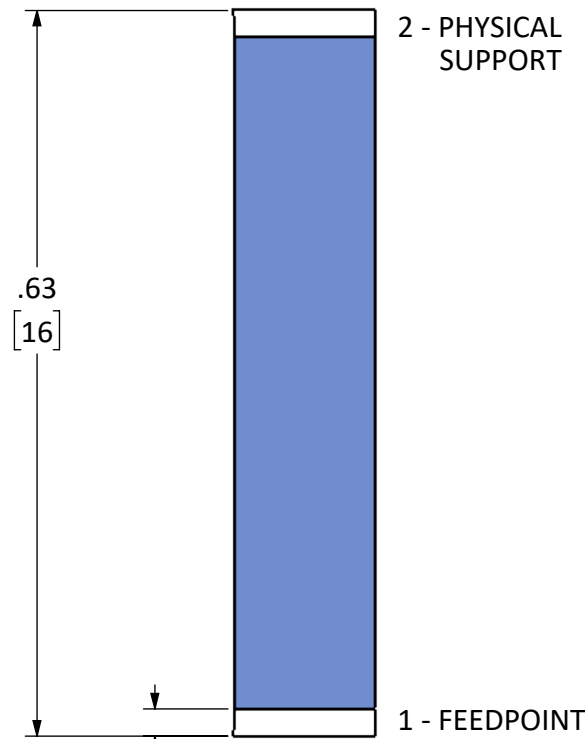
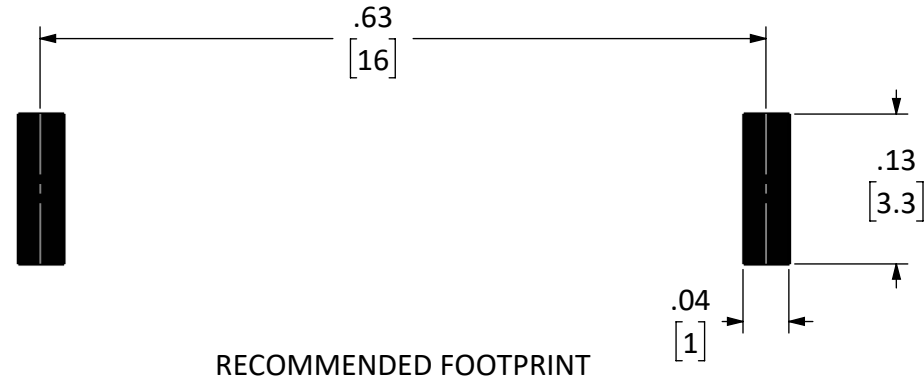
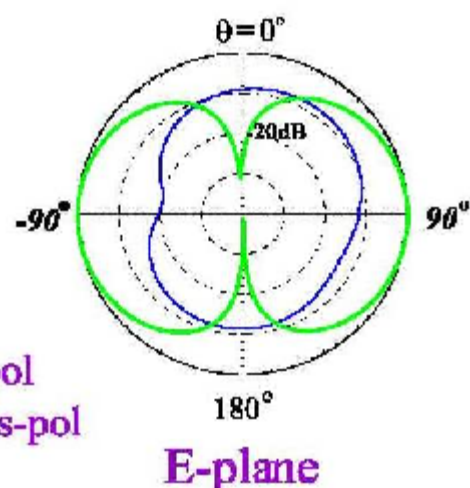

REVISIONS			
REV	DESCRIPTION	DATE	APPV
1	INITIAL RELEASE	7/8/2008	SAH
B	RELEASE PER ECO-ANT-xxx-CHP-B	2/2/2010	SAH
C	UPDATED TO ADD 2ND SHEET AND PACKAGING INSTRUCTIONS (FLAG NOTE 8)	21-NOV-17	SAH

NOTES: (UNLESS OTHERWISE SPECIFIED)

- ALL DIMENSIONS ARE IN INCHES [mm].
- DIMENSIONS APPLY AFTER FINISHING.
- SAFETY BREAK ALL SHARP CORNERS AND EDGES .02 MAXIMUM.
- PERFORMANCE REQUIREMENTS
 CENTER FREQUENCY: 868 MHz
 PEAK GAIN: +0.5 dBi MINIMUM
 BANDWIDTH: ≥ 10 MHz
 WAVELENGTH: 1/4-WAVE
 VSWR: < 1.5 AT CENTER
 IMPEDANCE: 50 OHMS
 CONNECTION: SURFACE MOUNT SOLDER PAD
 POWER HANDLING: ≥ 1 W CONTINUOUS
 OPERATING/STORAGE TEMPERATURE: -40 TO + 85 °C
- MATERIAL: LTCC.
- SCREEN PRINT GRAPHICS PER FILE *ANT-868-CHP.EPS*, COLOR: TBD (DEPENDING ON MATERIAL COLOR).
- FABRICATE TO BE COMPLIANT WITH EU RoHS DIRECTIVE, USE MATERIALS THAT DO NOT CONTAIN REACH SUBSTANCES OF VERY HIGH CONCERN >1000ppm, AND USE DRC CONFLICT-FREE SOURCED MATERIALS.

WARNING: THIS DRAWING CONTAINS PROPRIETARY INFORMATION THAT IS THE SOLE PROPERTY OF LINX TECHNOLOGIES, AND SHALL BE TREATED AS SUCH. NO DISCLOSURE OR REPRODUCTION OF THIS DOCUMENT IS PERMITTED, IN WHOLE OR IN PART, WITHOUT THE EXPRESS WRITTEN PERMISSION OF LINX TECHNOLOGIES OR ITS DESIGNATED AGENTS.

STE 159 ORT LANE
 MERLIN, OR 97532
 connectivity

MATERIAL:	INTERPRET DIMENSIONS AND TOLERANCES PER ASME Y14.5.	PROJECTION:
WEIGHT:	.X ±2.0 .XX ±1.00 .XXX ±.500	
FINISH:	ANGLES: ±1° SURFACE: √	
DRAWN: S.HOGAN	DT: 21-NOV-08	
ENGR:	DT:	

TITLE: CHIP ANTENNA 868 MHz		REV 1
SIZE B	DWG. NO. C-ANT-868-CHP	
SCALE: 6:1	DO NOT SCALE DRAWING	SHEET 1 OF 2

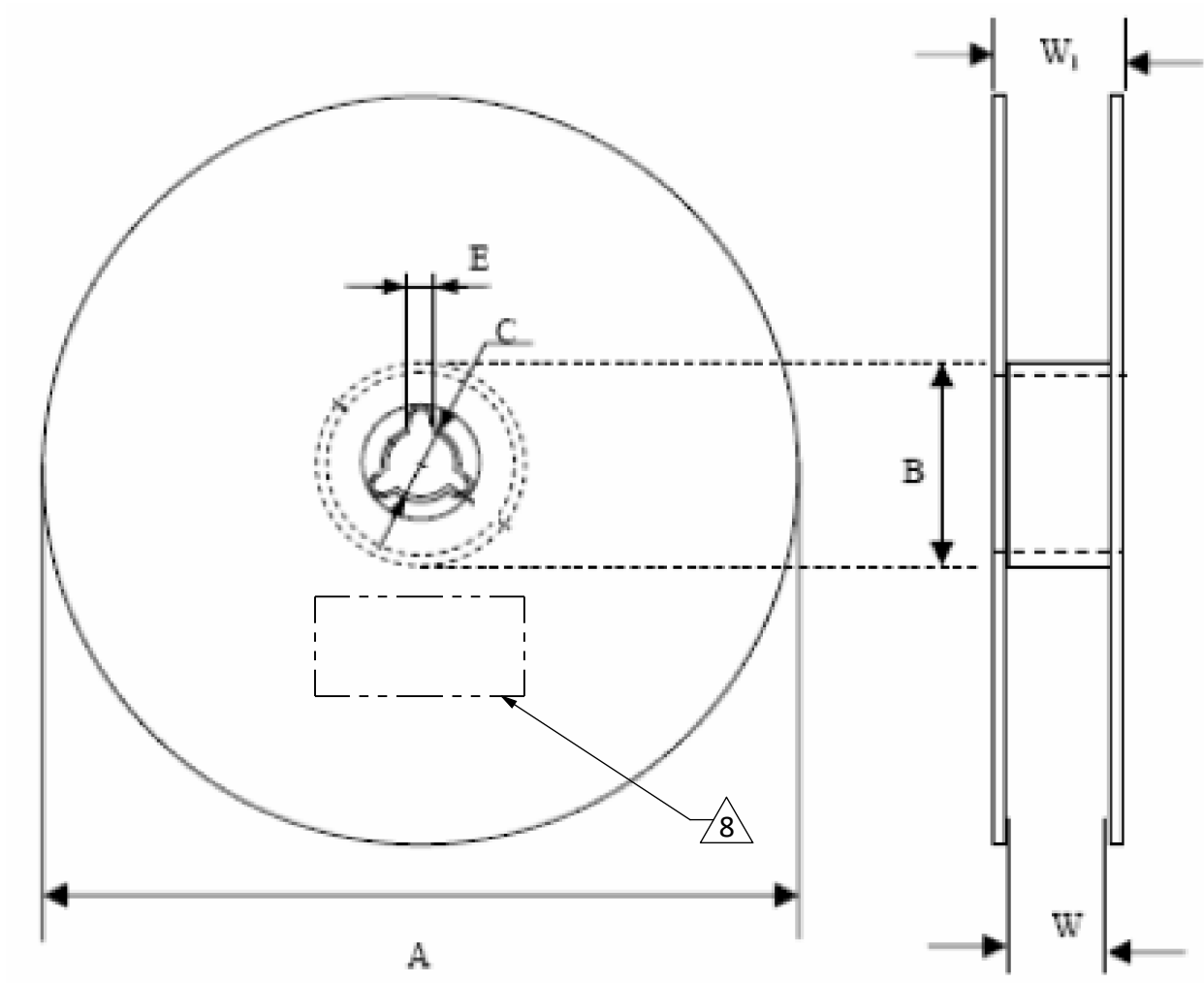
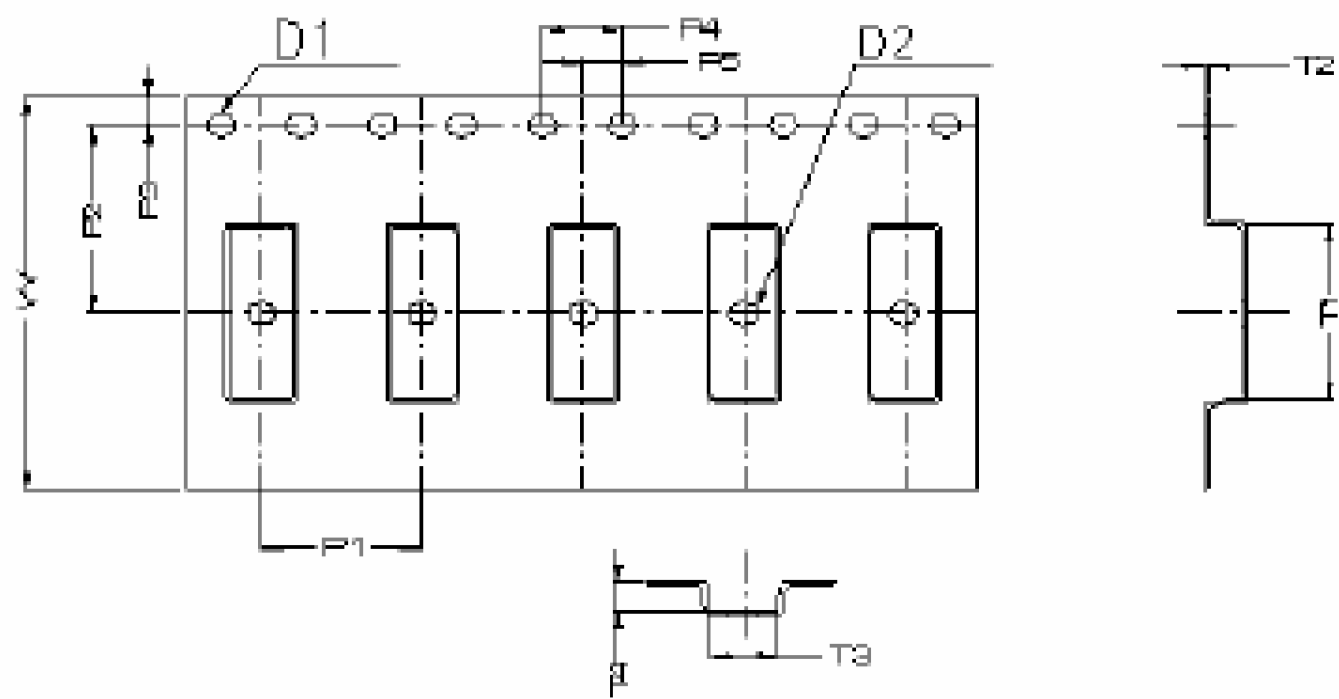

Symbol	Dimension	Tolerance	Unit
W	24.00	±0.30	mm
P1	8.00	±0.10	mm
P2	11.50	±0.10	mm
P3	1.75	±0.10	mm
P4	4.00	±0.10	mm
P5	2.00	±0.10	mm
D1	1.50	±0.10	mm
D2	1.50	±0.10	mm
T1	10.6	±0.10	mm
T2	0.30	±0.05	mm
T3	3.30	±0.10	mm
T4	1.90	±0.10	mm

TAPE DIMENSIONS

Quantity Per Reel	Tape Width (mm)	A (mm)	C (mm)	B (mm)	E (mm)	W (mm)	W ₁ (mm)
3,000	24	330±1	13.0±0.5	100.0±0.5	2.2±0.5	24.0±0.5	28.9±0.2

REEL DIMENSIONS