

| REVISIONS | | | |
|-----------|--------------------|------------------|------|
| REV | DESCRIPTION | DATE | APPV |
| A | PRODUCTION RELEASE | JHAGER 8/3/22 | |

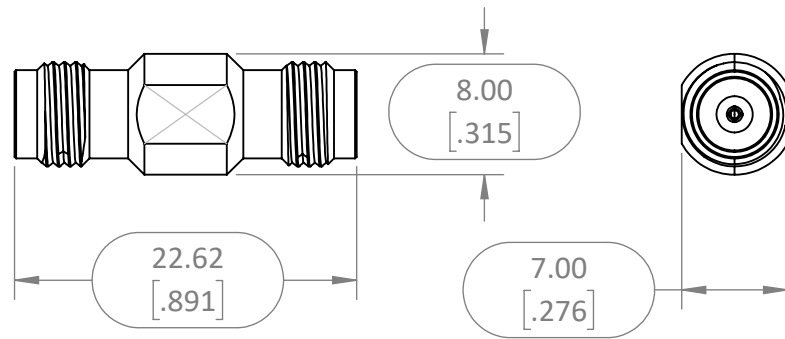

NOTES: (UNLESS OTHERWISE SPECIFIED)

- ALL DIMENSIONS ARE IN MILLIMETERS [IN].
- DIMENSIONS APPLY AFTER FINISHING.
- MANUFACTURE TO BE COMPLIANT WITH EU RoHS DIRECTIVE, USE MATERIALS THAT DO NOT CONTAIN REACH SUBSTANCES OF VERY HIGH CONCERN >1000ppm, AND USE DRC CONFLICT-FREE SOURCED MATERIALS.
- ELECTRICAL PROPERTIES LISTED ARE FOR REFERENCE ONLY. SEE LINX DATA SHEET FOR COMPLETE SPECIFICATIONS.
 - IMPEDANCE: 50Ω
 - FREQUENCY: DC - 50GHz
 - VSWR: NTE 1.2
 - INSERTION LOSS: .4dB MAX @50GHz
- TESTED IAW LINX INTERNAL TEST PLAN AT LATEST REVISION
- MECHANICAL:
 - INTERFACE: 2.4mm TYPE IAW MIL-STD-348B.
 - MAX INTERFACE TORQUE: 1.1 Nm [9.8 in/lbs]
 - TEMPERATURE RANGE: -40 - +185°C
 - CAUTION: DO NOT MANIPULATE CONNECTOR USING STEEL TOOLS.
- CONNECTOR INDIVIDUALLY BAGGED.
- LABEL LOT BAGS AND BOXES IAW LINX LABEL DRAWING [MEC-LBL-4X2.5-PAPER-ID]

WARNING: THIS DRAWING CONTAINS PROPRIETARY INFORMATION THAT IS THE SOLE PROPERTY OF LINX TECHNOLOGIES, AND SHALL BE TREATED AS SUCH. NO DISCLOSURE OR REPRODUCTION OF THIS DOCUMENT IS PERMITTED, IN WHOLE OR IN PART, WITHOUT THE EXPRESS WRITTEN PERMISSION OF LINX TECHNOLOGIES OR ITS DESIGNATED AGENTS.



159 ORT LANE
MERLIN, OR 97532

TITLE:
ADAPTER 2.4 FML TO 2.4 FML

| | | | |
|--------------------------------------|---|--|--|
| MATERIAL: CRES BeCu, ULTEM | INTERPRET DIMENSIONS AND TOLERANCES PER ASME Y14.5. .X ±2.0 .XX ±1.00 .XXX ±.500 | PROJECTION: ANGLES: ±1° SURFACE: √ | |
| FINISH: QQ-P-35 PAS GOLD; 50μ" | DRAWN: JHAGER ENGR: SHAWNH | DT: 7/29/22 DT: 7/29/22 | |

| | | |
|------------------|------------------------------------|-----------------|
| SIZE A | DWG. NO. C-ADP-2.4F-2.4F | REV A |
| SCALE: 2:1 | DO NOT SCALE DRAWING | SHEET 1 OF 1 |