

ITEM	TCPN NO	DESCRIPTION	QTY	DESCRIPTION
1	609722-000	BAH-017000082	2	M16x1.5 12.8 A/F 26.0 LONG BRASS SINGLE-SHEAR BOLT
2	928534-000	BAH-014030121	1	MV BRASS END TERMINATION BODY 31.5 O/D 16.2 I/D - CENTRE PALM OVERHEAD TYPE WITH Ø13.0 HOLES & NOTCH
3	D48140-000	BSM-35/150-E-Z	1	BSM-35/150-E-Z INSERT BSM-35/150

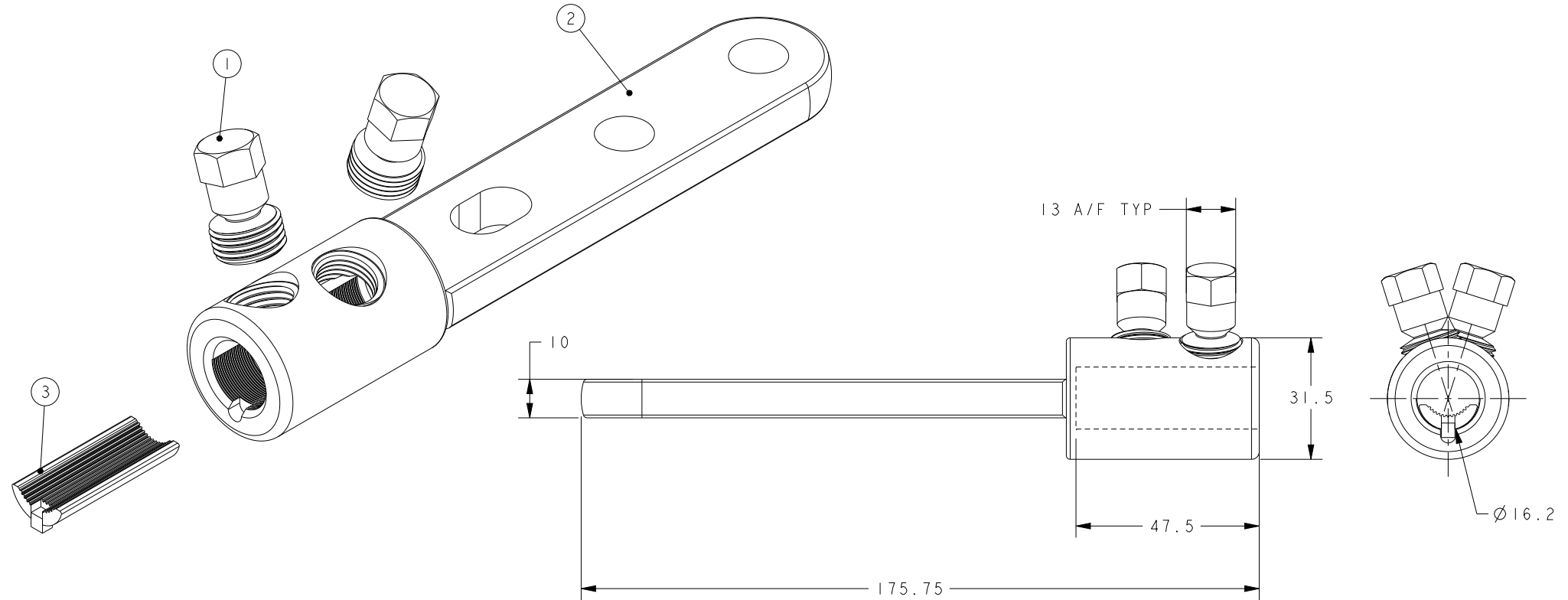

SCALE 4:5

BREAK SHARP EDGES & DEBURR, SURFACES TO BE FREE FROM SCRATCHES & DEFECTS. MACHINED SURFACES TO BE 3.2µm Ra OR BETTER (UOS). ALL OIL & GREASE etc TO BE REMOVED. ALL THREADS TO BS3643 PART 2.

MACHINED SURFACES UNLESS OTHERWISE SPECIFIED TO BE:

	0.10mm		0.05mm/cm
	0.015mm/cm		0.015mm/cm

STE
connectivity

Material	VARIES
Finish	NATURAL
Tolerances (UOS)	±
B&H Short Desc.	VETB16/32-OHSP

Part Description

MV BRASS END TERMINATION - 31.5 O/D
16.2 I/D CENTRE PALM OVERHEAD TYPE
WITH Ø13.0 HOLES & SLOT

- IF IN DOUBT ASK - DO NOT SCALE -

D	CHANGE INSERT REFERENCE	GC-00031	25/07/24
C	HEX BOLT HEAD REDUCED AS PER ECR	SD/DMR-GC-0020	21 JAN 21
B	CONNECTOR & INSERT REVISED	S.P.W	12.2.02
A	FIRST ISSUE	S.P.W	21.9.01
Revision	Description	Name/ECN	Date
Design/Drawn	S.P.WEST	Date	21 SEPT 2001
TCPN	711878-000	Scale (UOS)	1:1.5
Part Weight	495g	THIRD ANGLE PROJECTION	A4
Drawing/Part No	BAH-024030123	Drawing Type	CUSTOMER DRAWING
Rev	D		

THIS DRAWING IS COPYRIGHT AND IS ISSUED ON THE STRICT UNDERSTANDING THAT IT IS NOT REPRODUCED, COPIED OR DISCLOSED TO A THIRD PARTY WITHOUT THE CONSENT IN WRITING OF TYCO ELECTRONICS UK LTD